

San Francisco International Airport Terminal 1 Renovation Art Commission - Concept Phase

May 18, 2016

The project is a replacement terminal and concourse facility for San Francisco International Airport Terminal 1 including Boarding Area B and C. Terminal 1 and Boarding Area B were originally finished in 1961, with the addition of Boarding Area C completed in 1984. Originally designed with 29 domestic gates, the facilities have become outdated both in airport operations and passenger experience as set forth in SFO's cultural design guideline, the Revenue Enhancement and Customer Hospitality principles (The REACH document).

The new Terminal 1 and Boarding Areas B and C will operate 34 international and domestic flights, accommodating forecasted growth. Most importantly this project addresses operational efficiencies such as checked baggage screening and delivery, passenger security scanning, operational and administration connectivity to allow this airport to best support the region's air travel needs.

In addition to Airport Operations, the renovation of Terminal One is part of series of solutions that will allow SFO to meet its aspiration of becoming 'zero net energy' within 5 years. This means the total amount of energy used by the Airport on an annual basis is roughly equal to the amount of renewable energy created on the site. Many design decisions will be made with these energy goals in mind.

This project will continue a masterplan hierarchy and that allows the International Terminal to remain as the "Jewel" of the Airport, primary in Architectural importance. It's features and materials create the context that the domestic terminals respond to. Terminal 1, as with the Airport's previous capital improvements, will be designed "inside-out" to improve the passenger experience and will feature a Bay Area airport journey.



TERMINAL 1

TERMINAL 2

TERMINAL 3

INTERNATIONAL
TERMINAL

BART
STATION

US 101

ORIENTATION

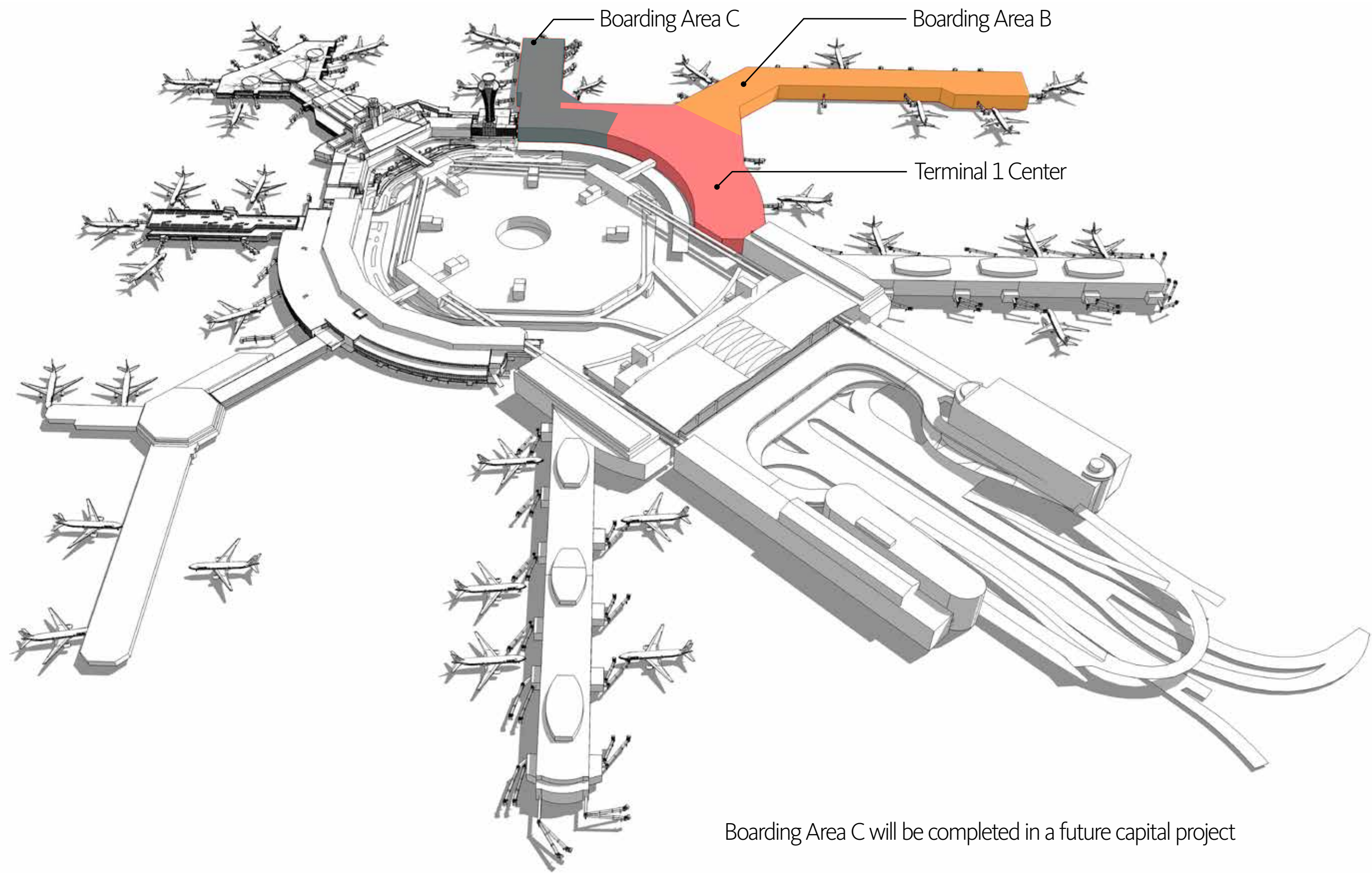

Boarding Area C will be completed in a future capital project

T1 OVERVIEW: DEPARTURES

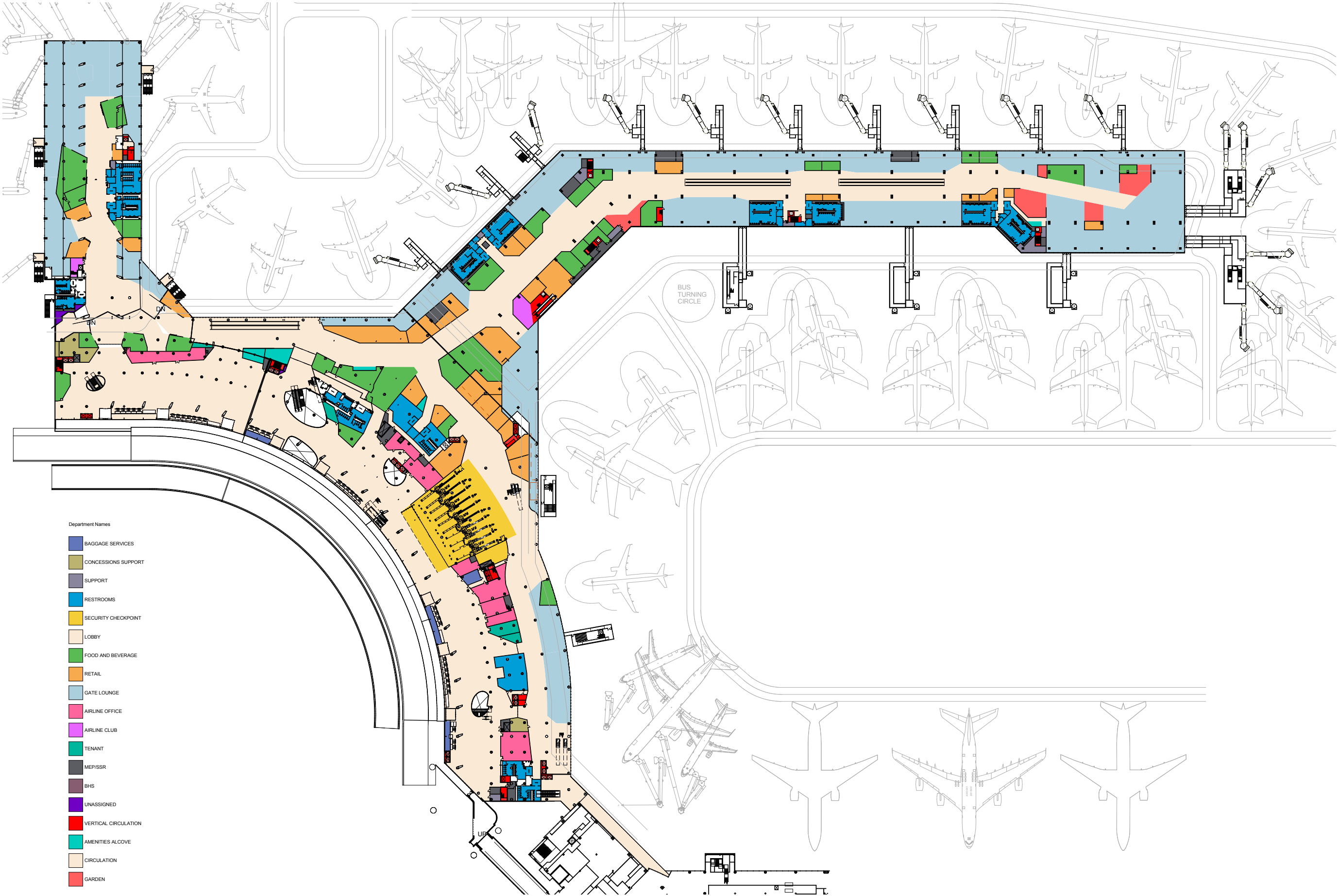

T1 OVERVIEW: MEZZANINE

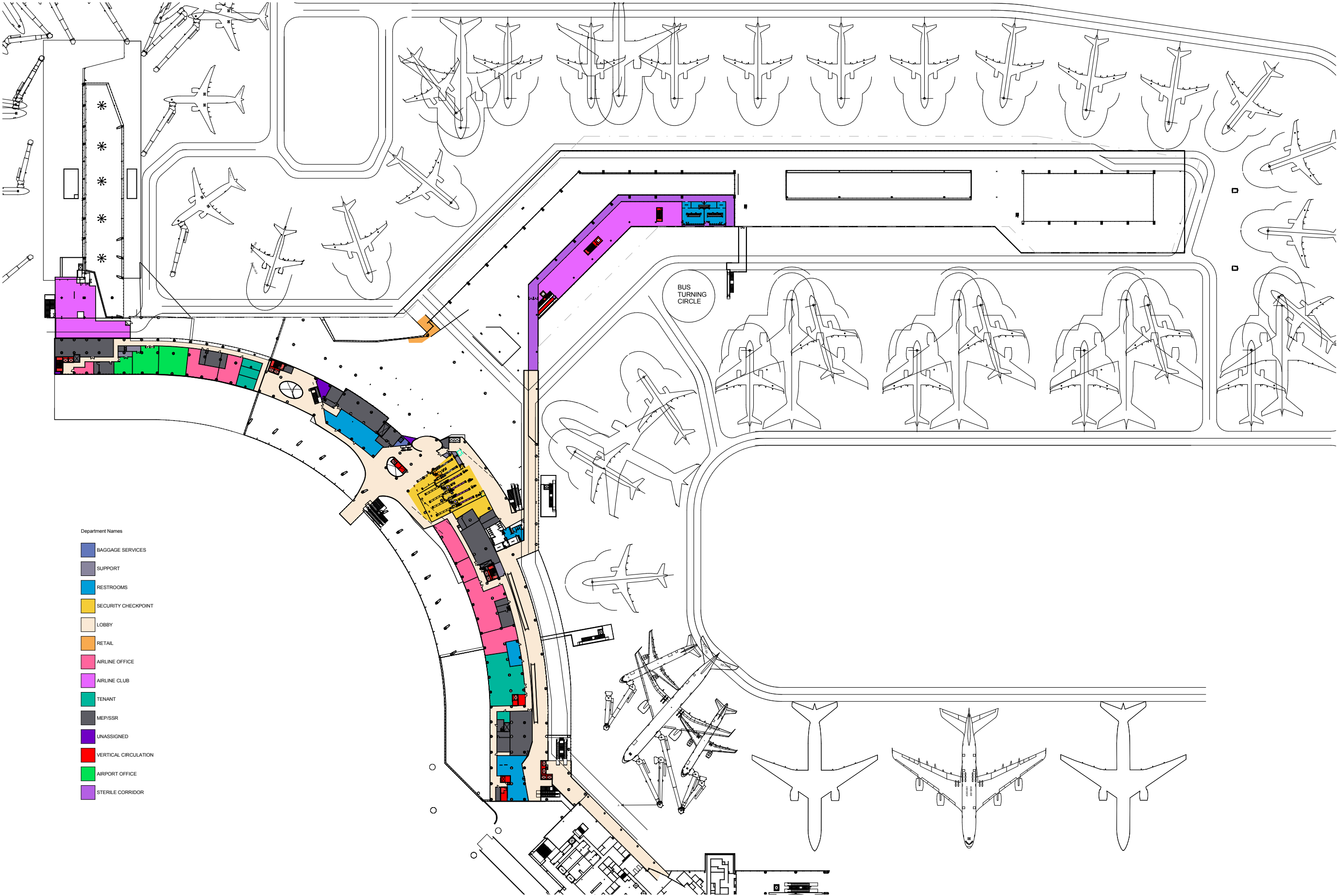

T1 OVERVIEW: ARRIVALS

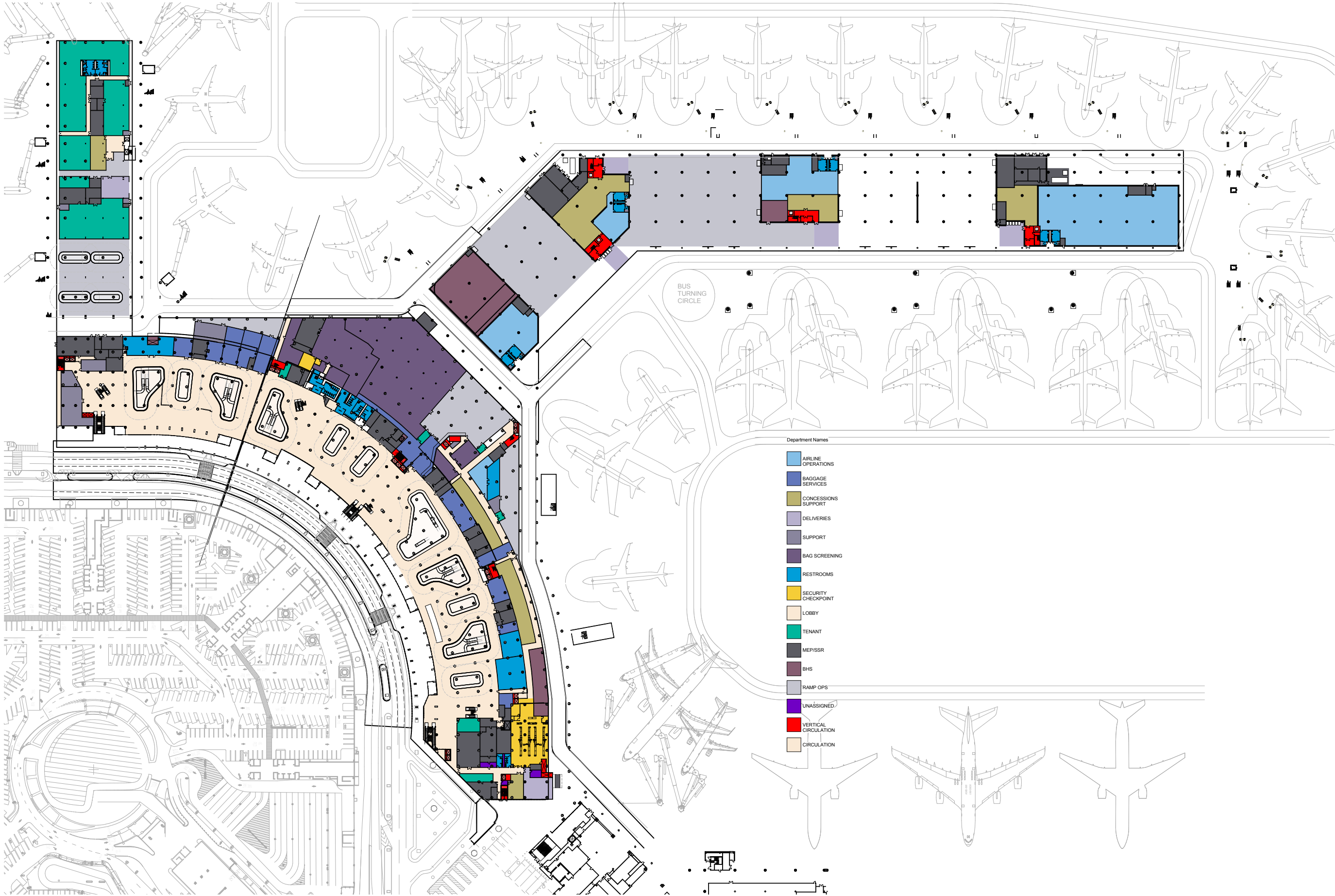

DESIGN CONCEPT

BAY AREA NATURALISM

*Celebrating the environment of
Northern California: a **VARIETY** of curated
ENVIRONMENTS that foster
EXPLORATION and **DISCOVERY**.*

*Some of these experiences are based on
SPEED and **EFFICIENCY**, others encourage
QUIETUDE and **RELAXATION**.*

***LIGHT** is a prime mover in the journey,
as is **CRAFT**, expressed through **NATURAL
MATERIALS** like **WOOD** and **STONE**.*

***HARD LINES** co-exist with **SOFT EDGES**:
a **DUALITY** that captures the **SOCIAL ETHOS**
of the **BAY AREA** community.*

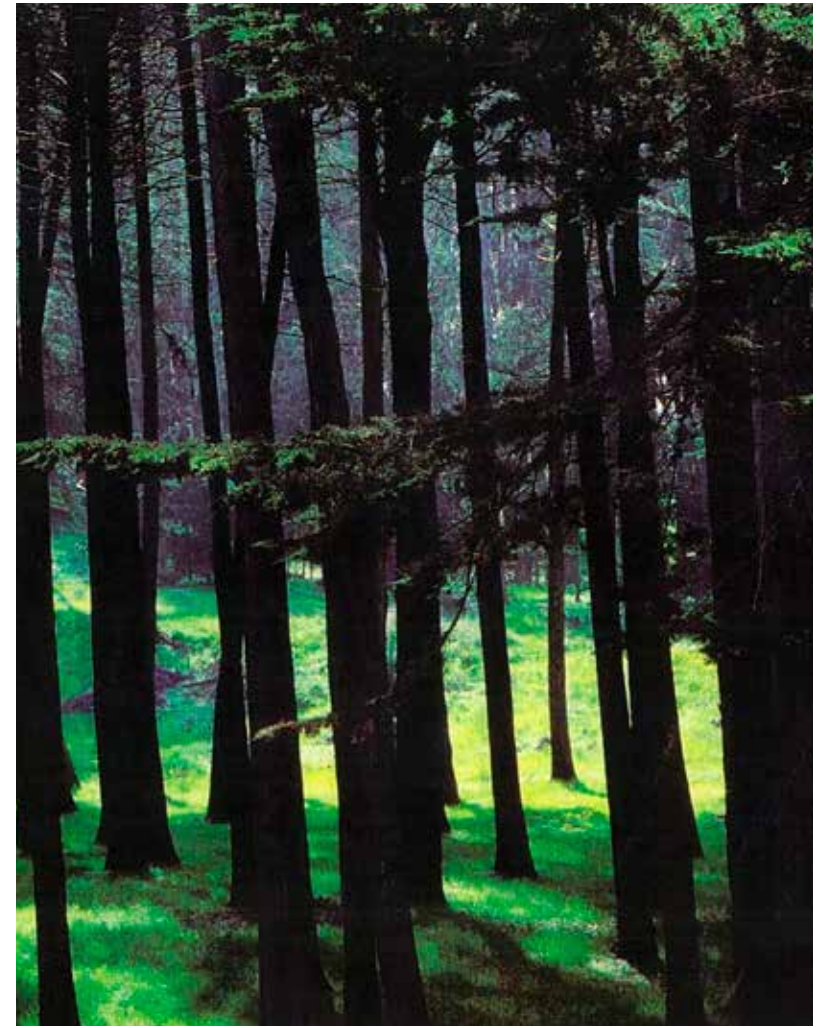

VISION FOR TERMINAL 1



POINTS OF VIEW



GUIDING PRINCIPLES

CONCEPT PLAN

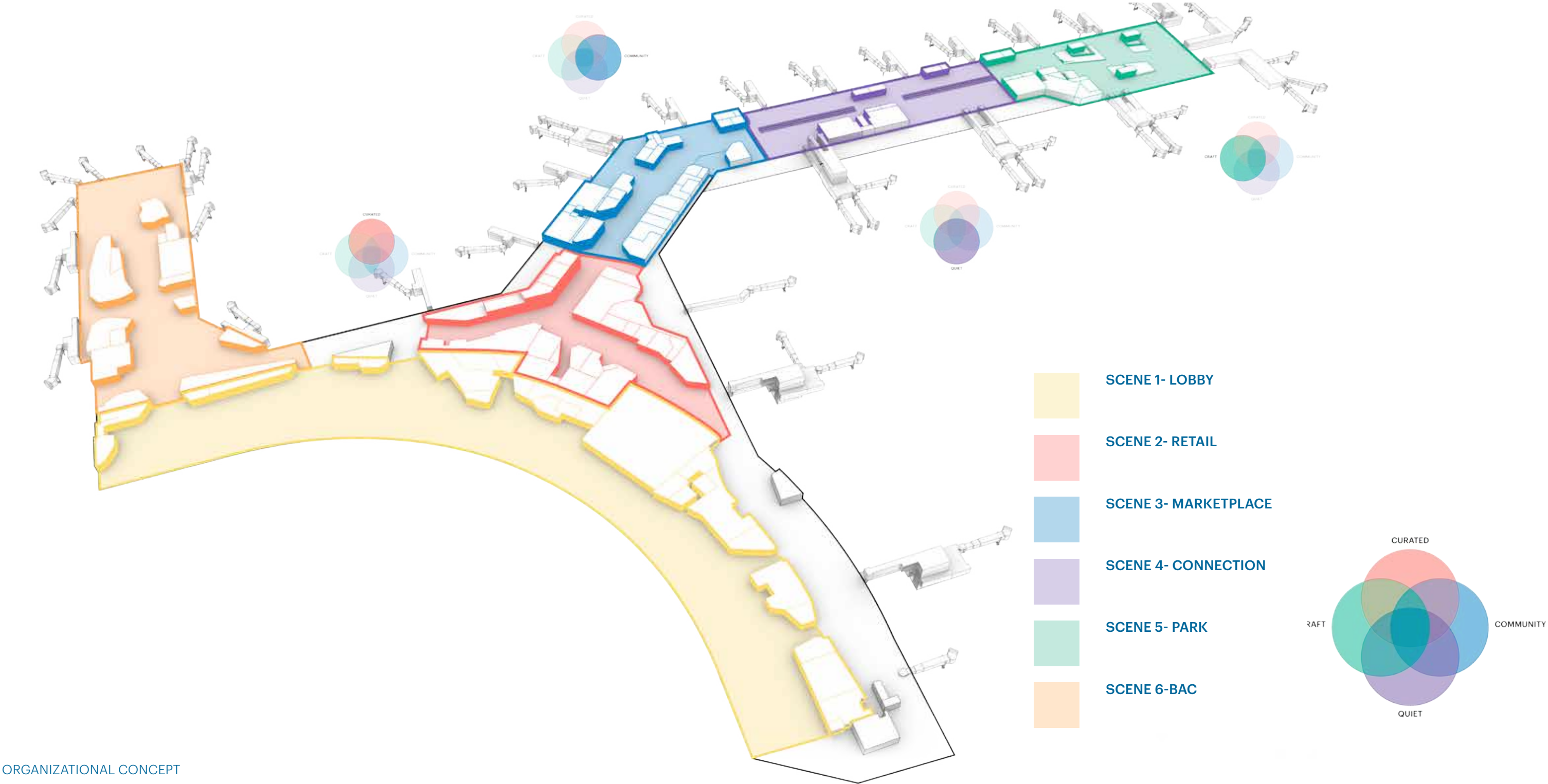

TRANSPARENCY TO AIRFIELD: INGLENOOK CONCEPT

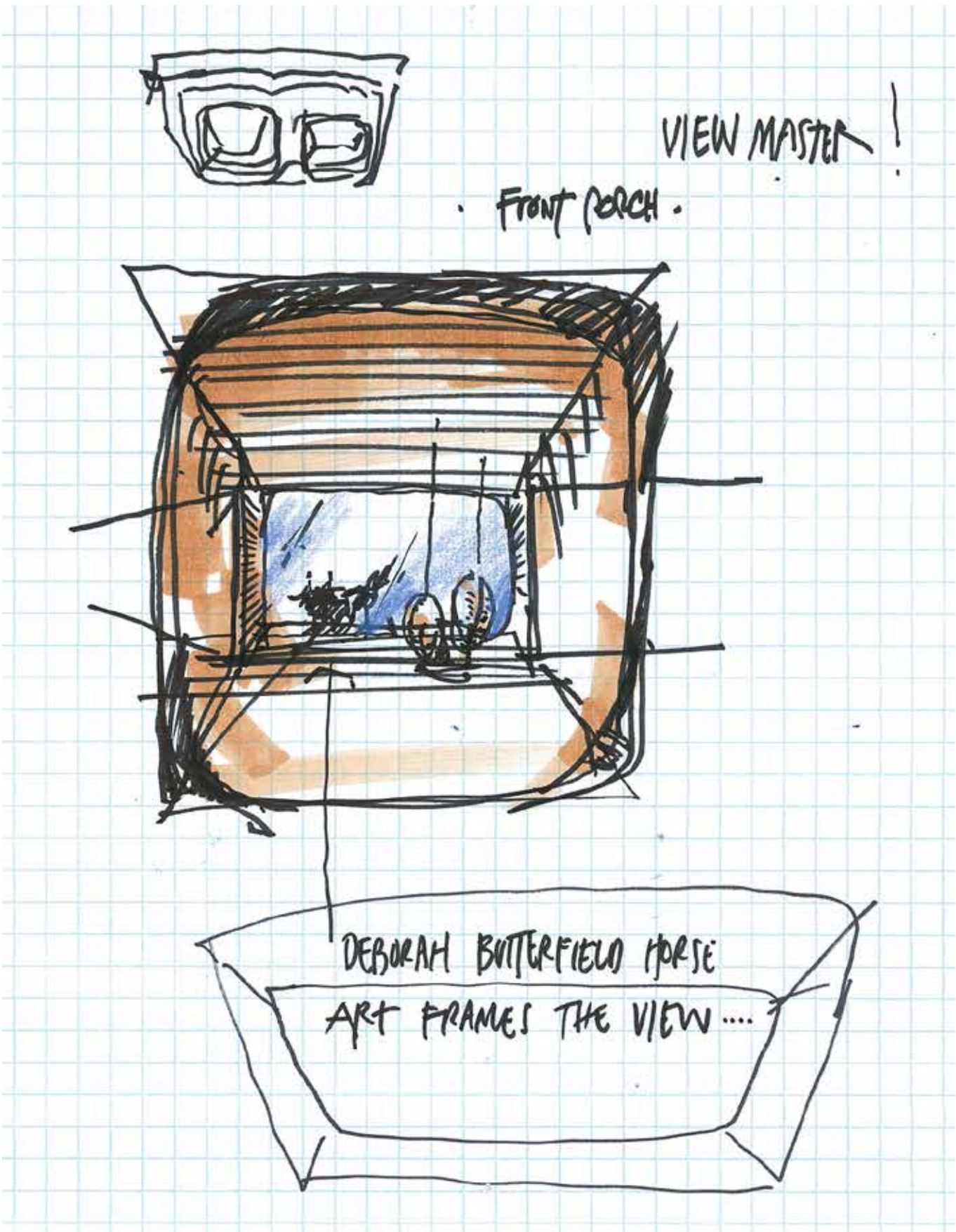
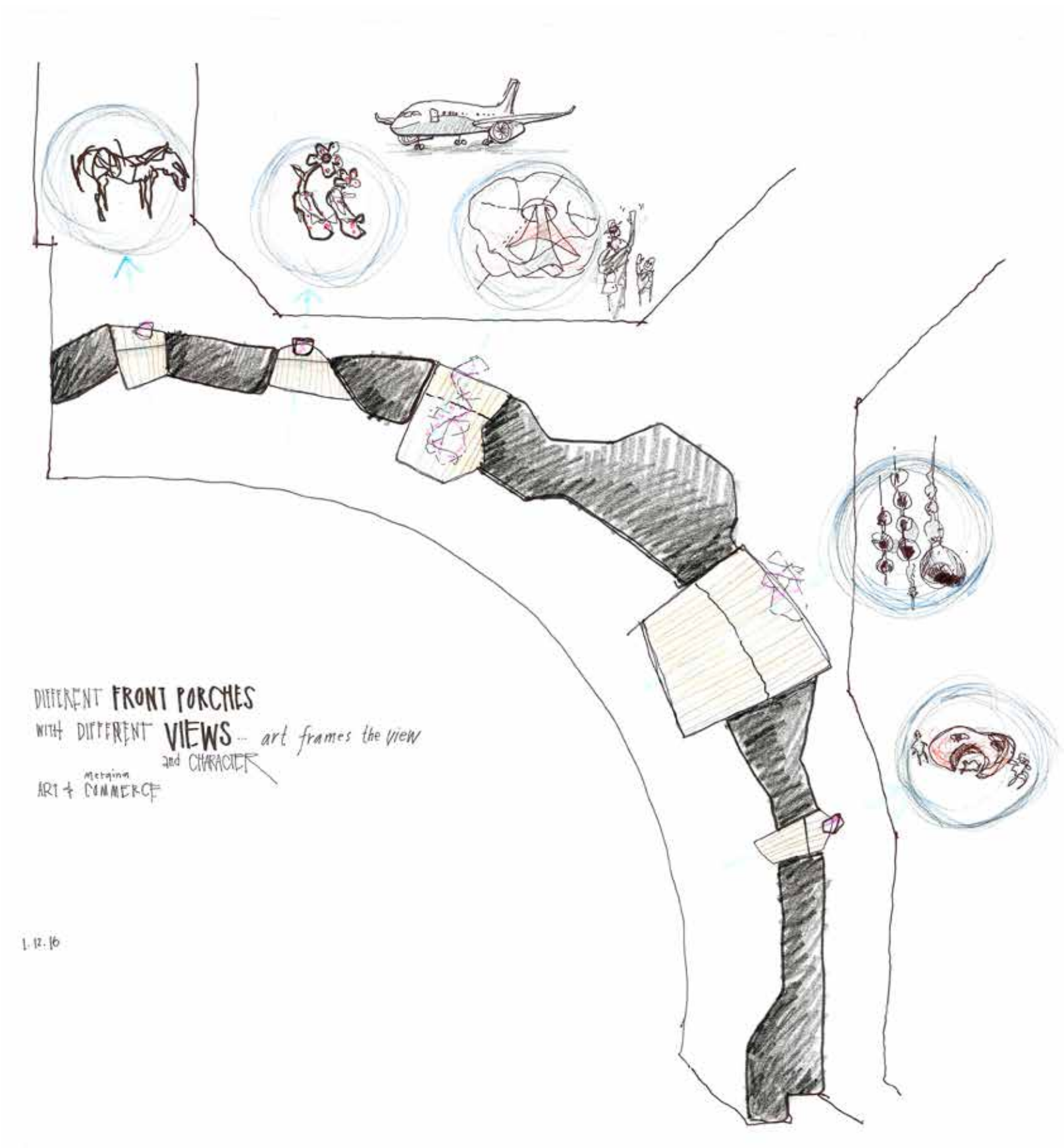

VERTICAL CONNECTIONS BETWEEN LEVELS



BOARDING AREA B END OF PIER DESIGN

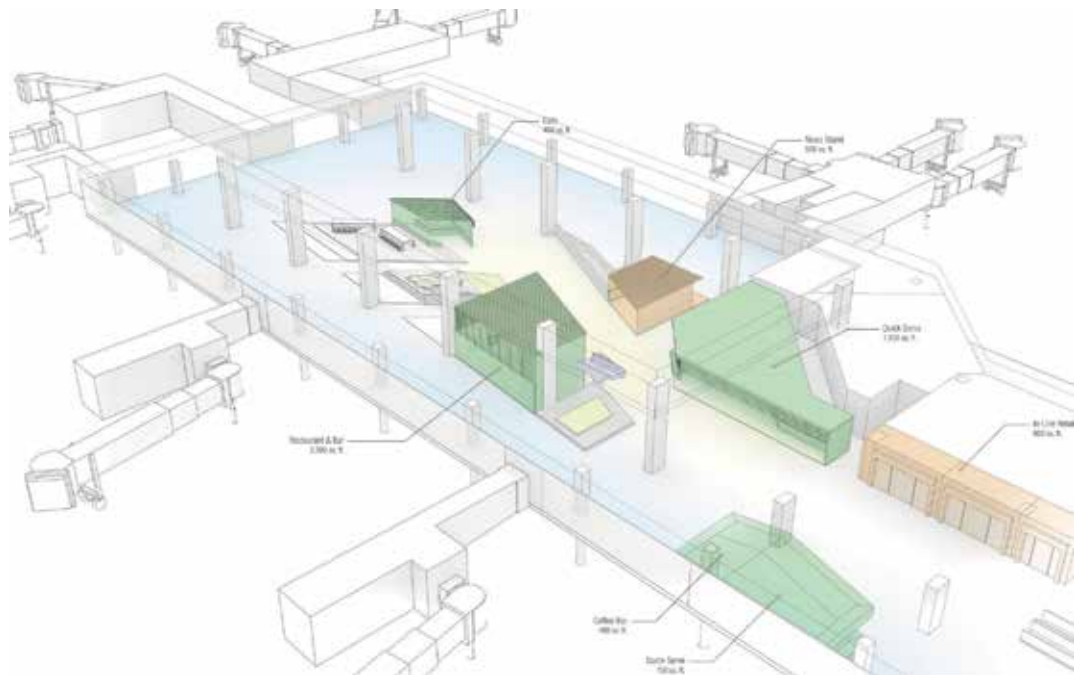

SCHEME 1 DIAGRAM



SCHEME 1 INTERIOR PERSPECTIVE

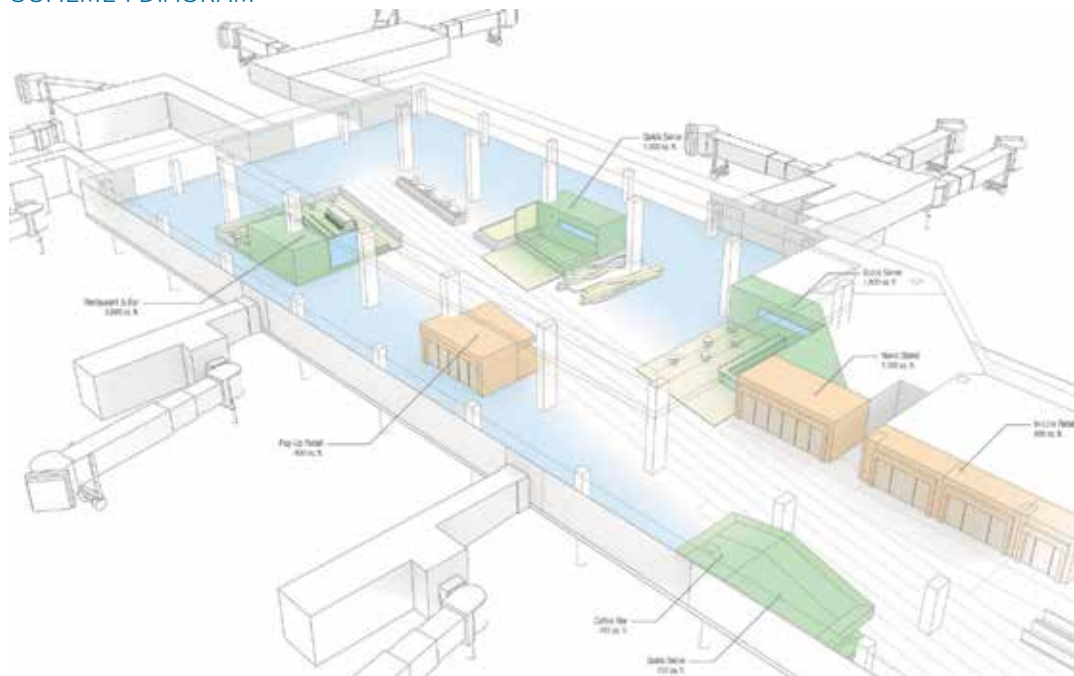

SCHEME 2 DIAGRAM



SCHEME 2 INTERIOR PERSPECTIVE

TERMINAL 1 TICKETING AREA LOW HEIGHT

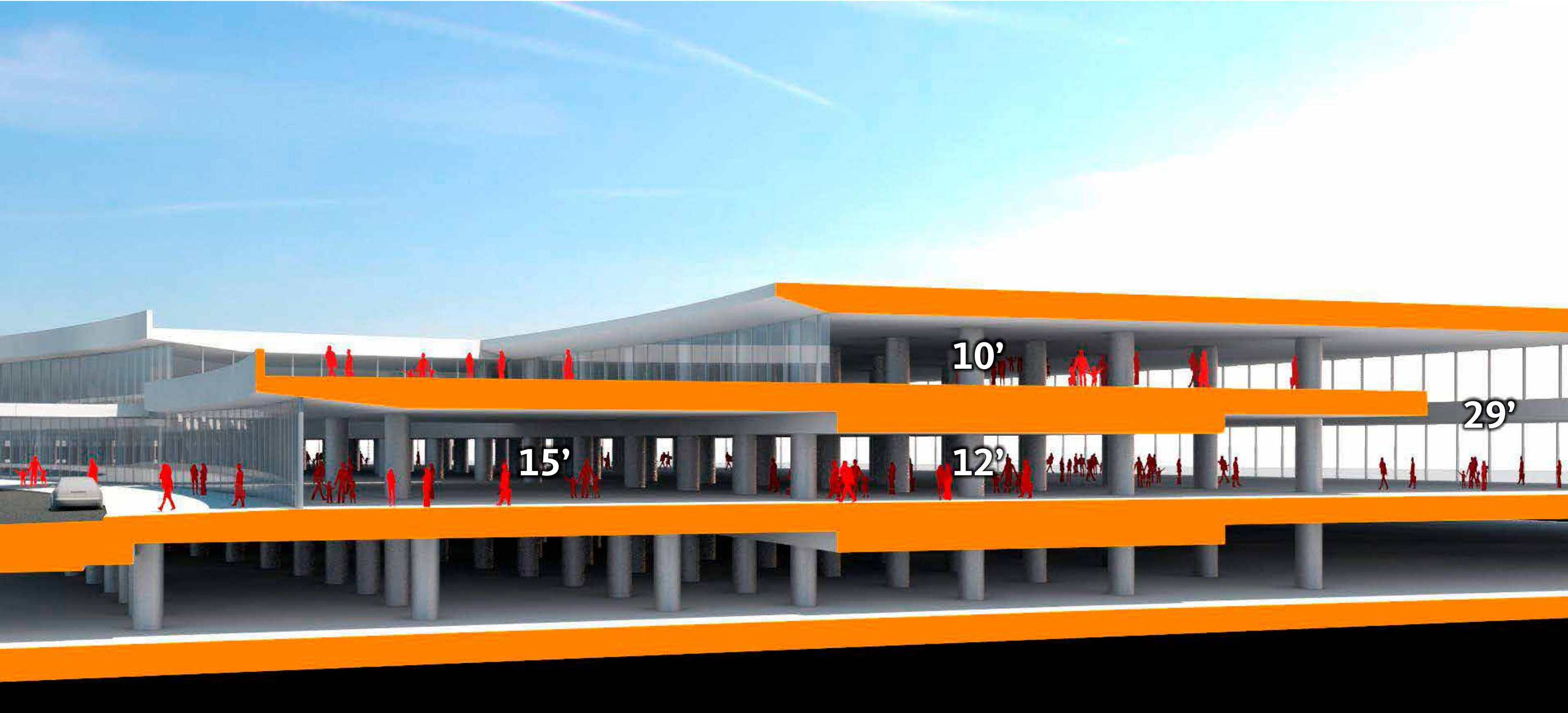

TERMINAL 1 TICKETING AREA HIGH HEIGHT

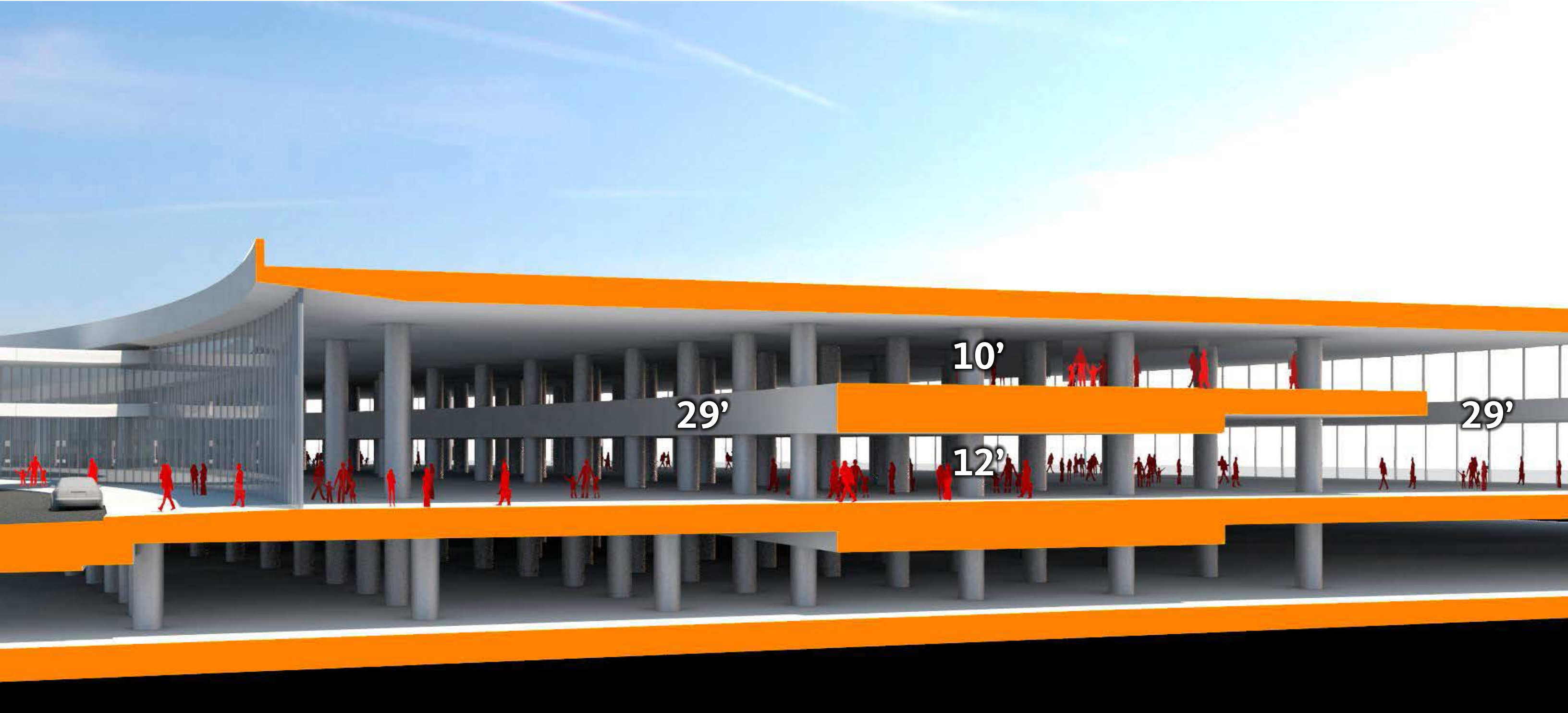

BOARDING AREA B RETAIL MARKET / CONCESSIONS



BOARDING AREA B CONCOURSE HIGH CEILING

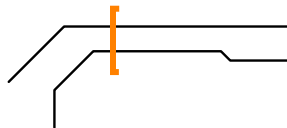

BOARDING AREA B LOW CONCOURSE



BOARDING AREA B END OF PIER HIGH CEILING



F+B

RETAIL

LOUNGE

MECHANICAL

PLAN WITH HEIGHT OVERLAYS

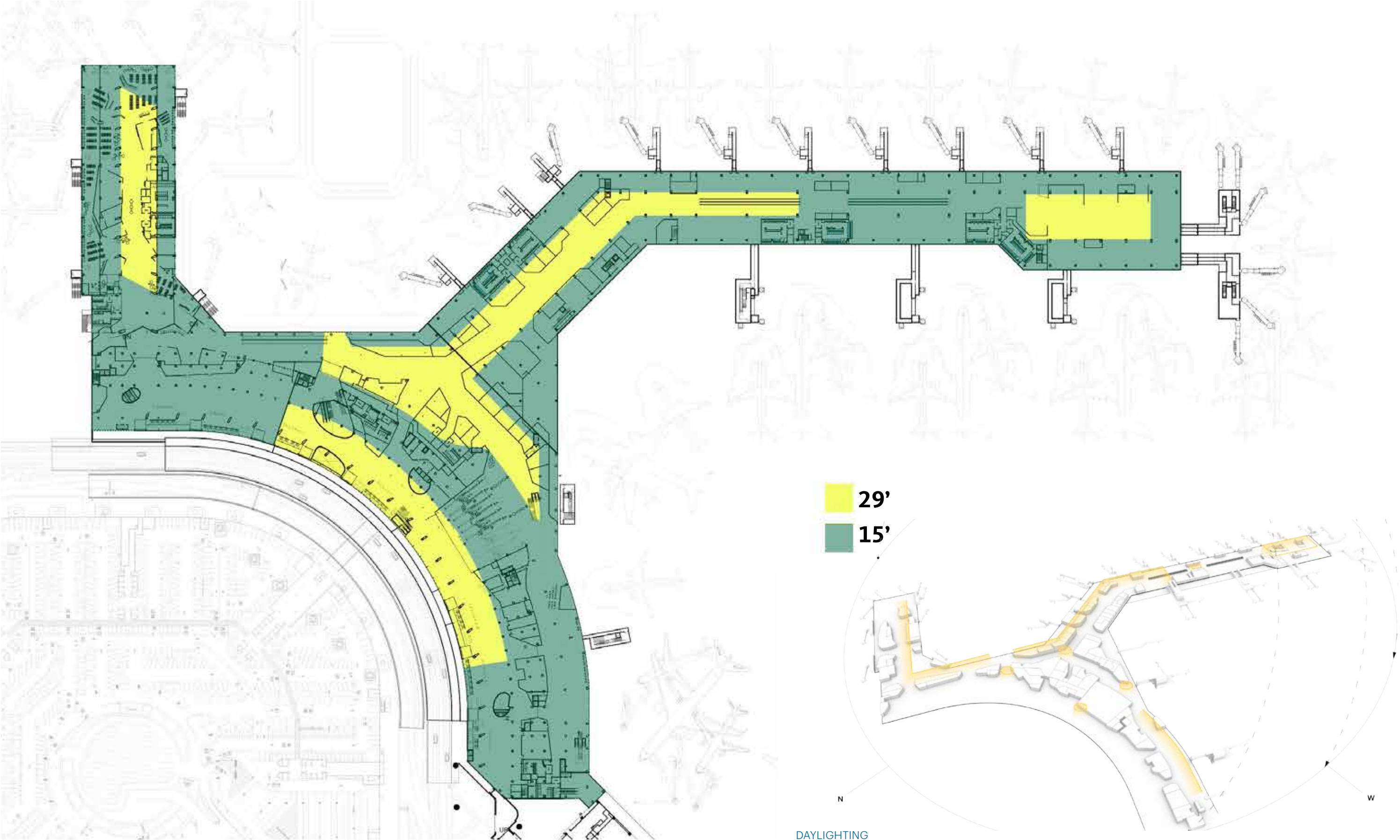

ART OPPORTUNITIES: DEPARTURES

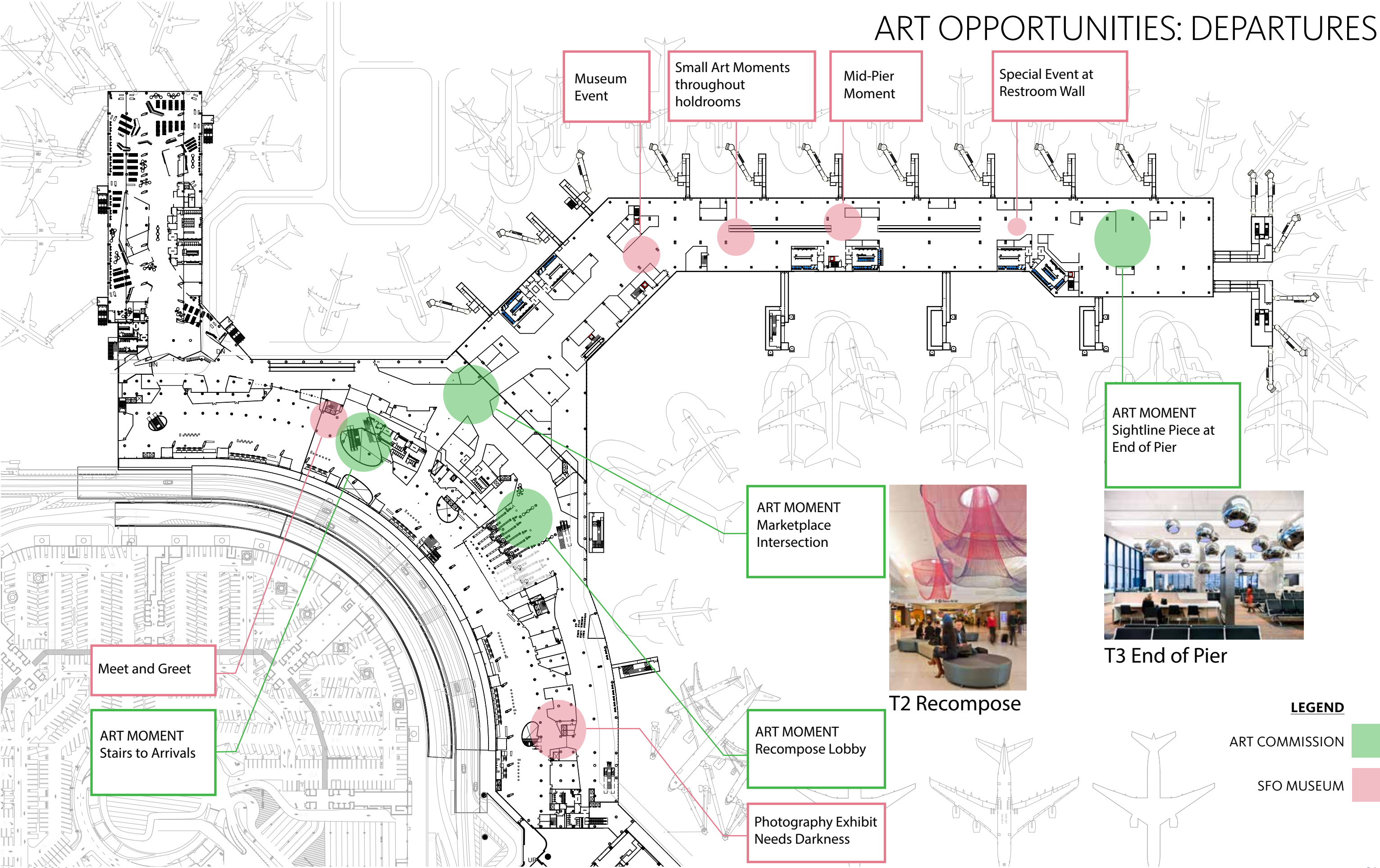

T2 Recompose



T3 End of Pier

ART OPPORTUNITIES: MEZZANINE

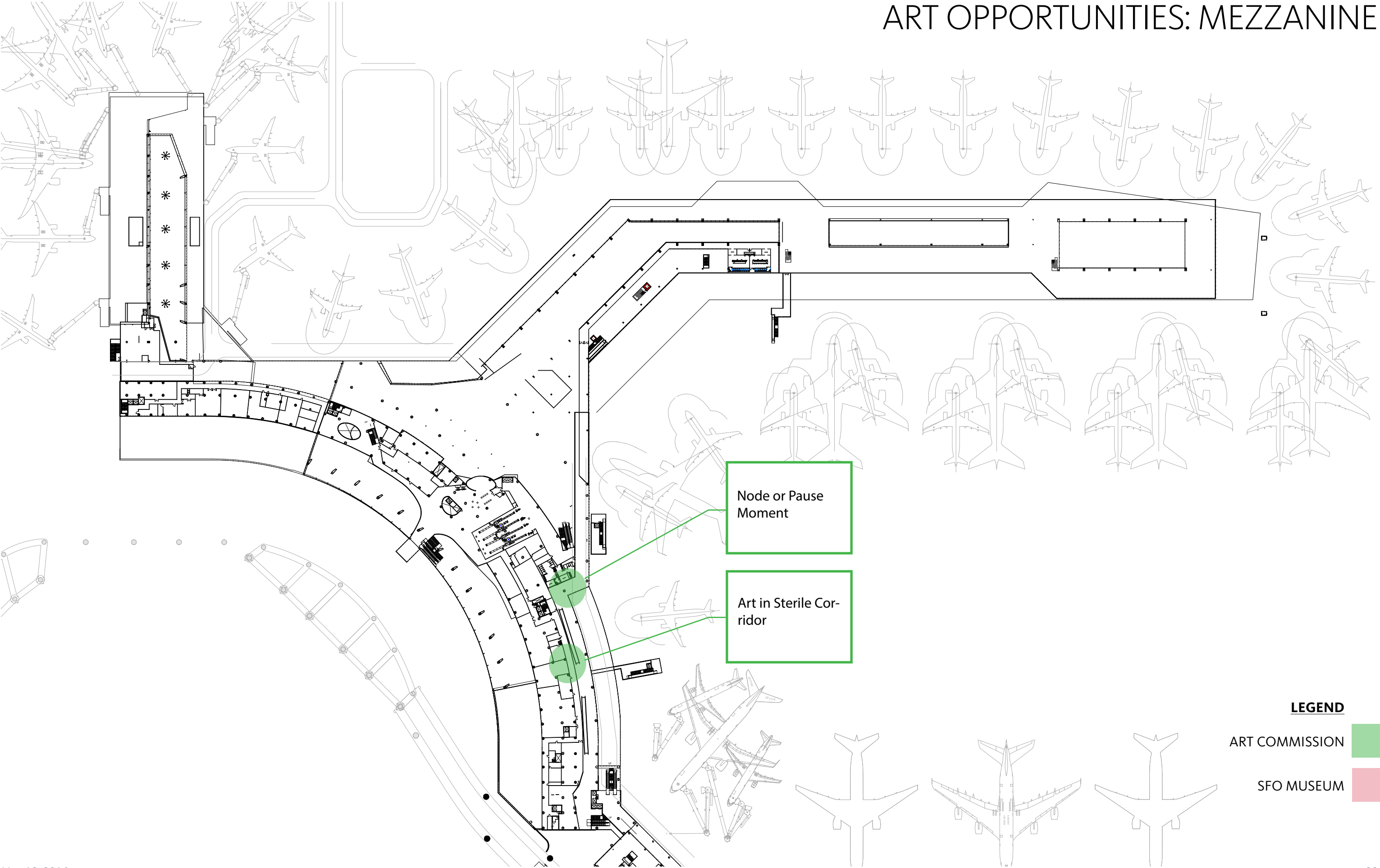

ART OPPORTUNITIES: ARRIVALS

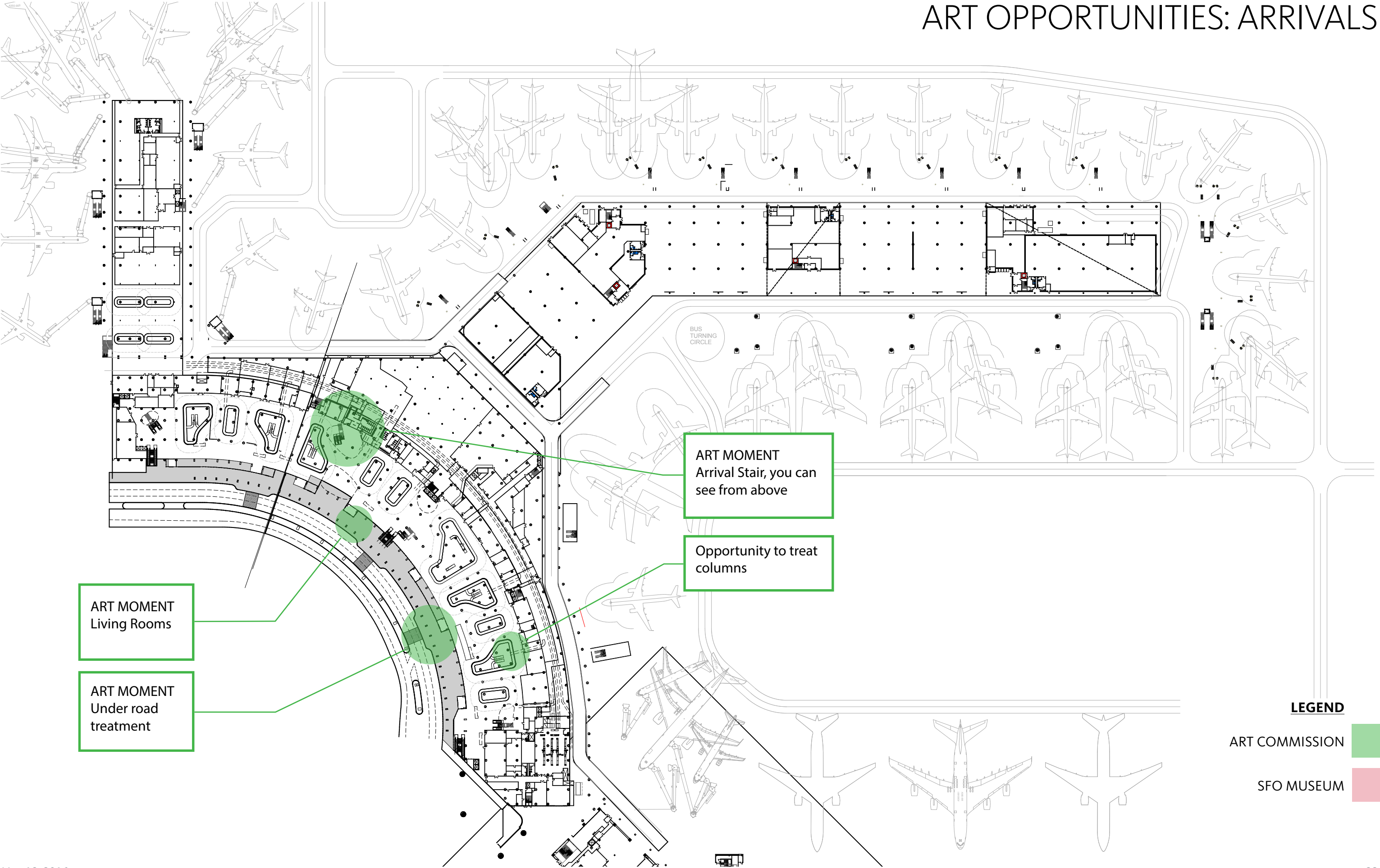

WORKS TO BE REINSTALLED

Tony Berlant
Dancing on the Brink of the World
1987



PROJECT STAGING

PROJECT TEAM ORGANIZATION

Terminal 1 Center (T1C)

General Contractor **Hensel Phelps**

Design Team **Gensler**
Kuth / Ranieri
Hamilton + Aitken

Boarding Area B (BAB)

General Contractor **Austin / Webcor**

Design Team **HKS**
Woods Bagot
ED2
KYA



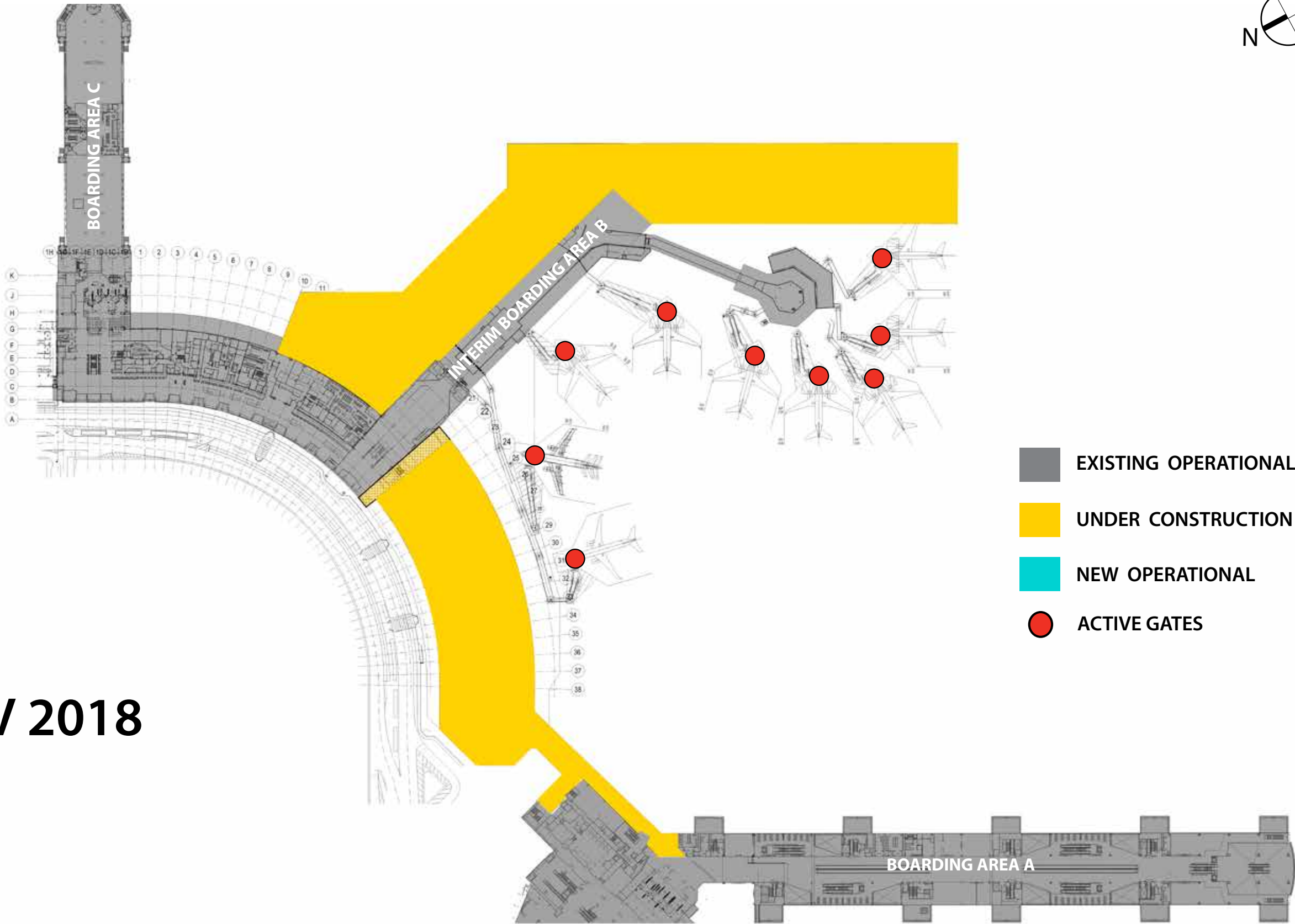
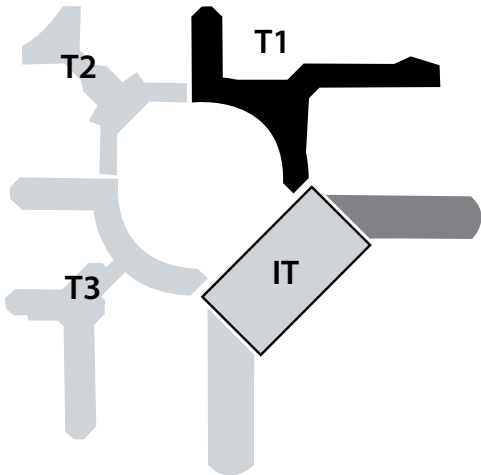

STAGE 1
SEP 2016 - NOV 2018

9
ACTIVE GATES

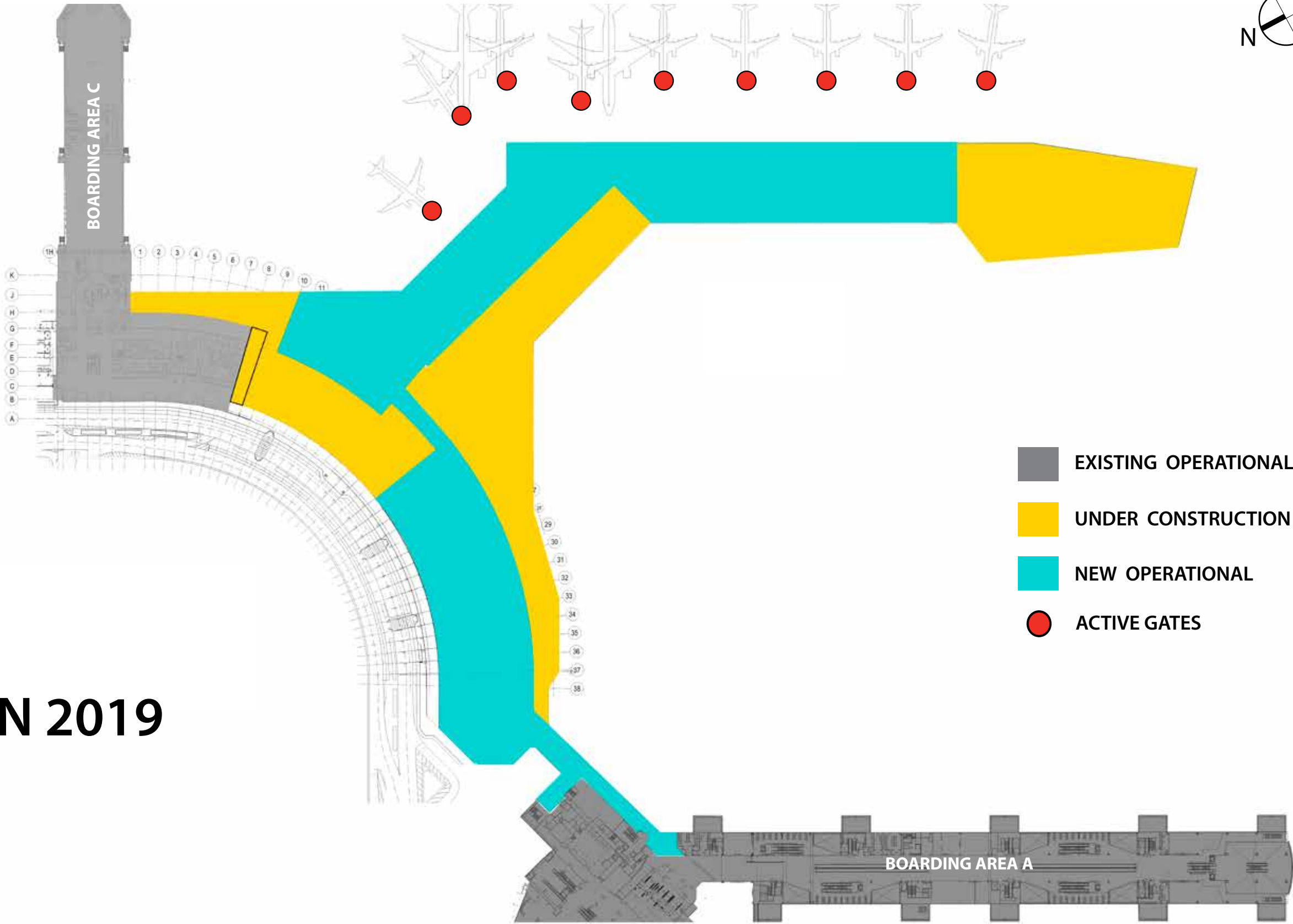
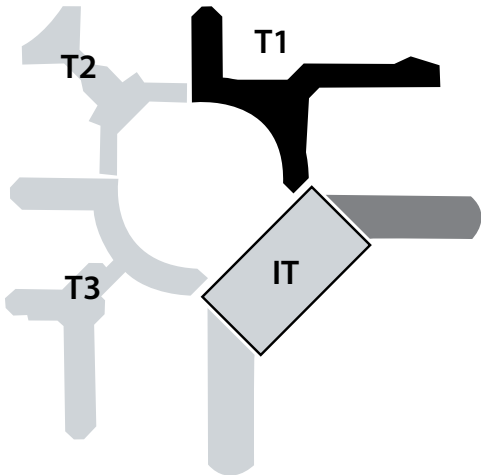

STAGE 2A
NOV 2018 - JUN 2019

9
ACTIVE GATES

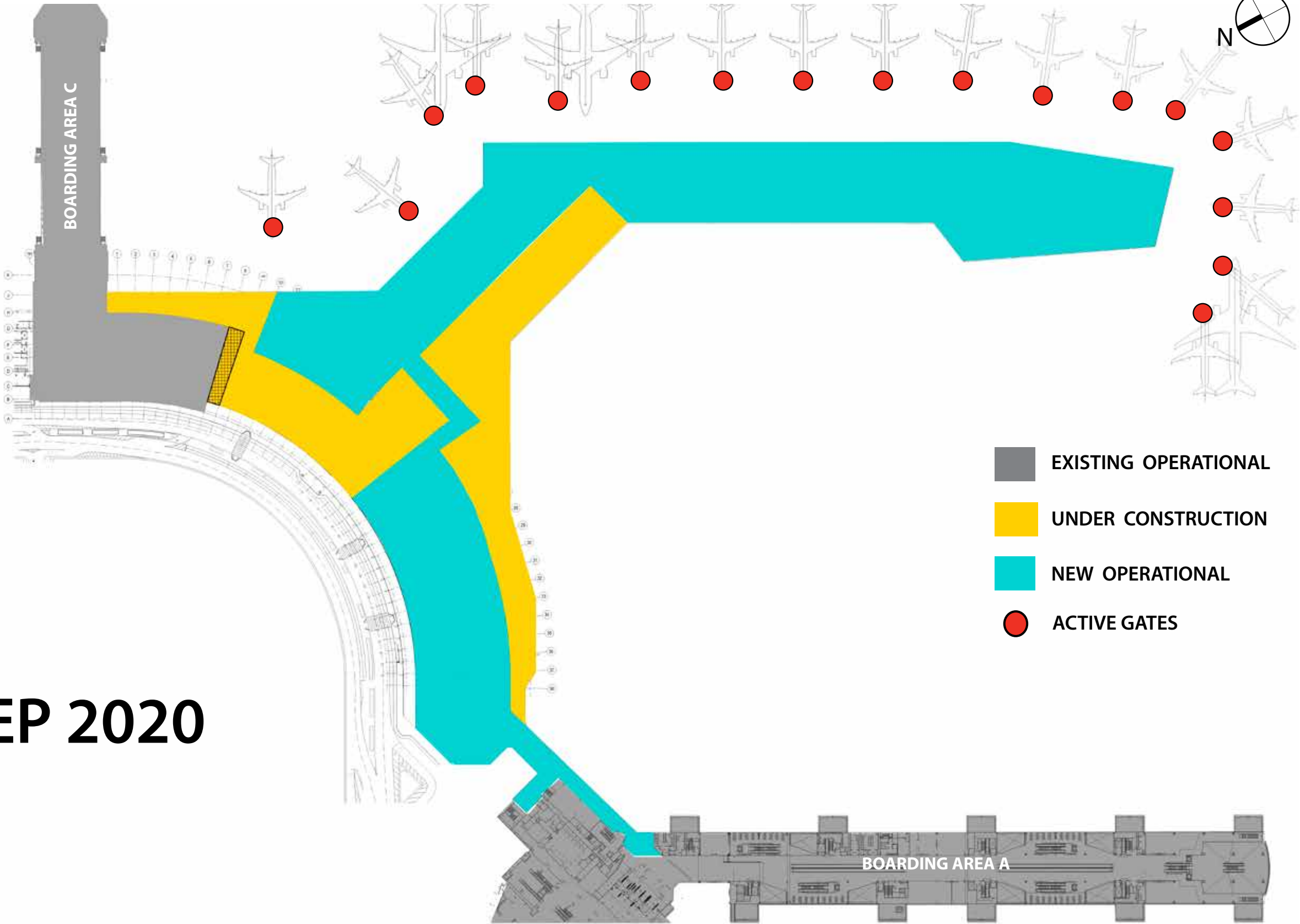
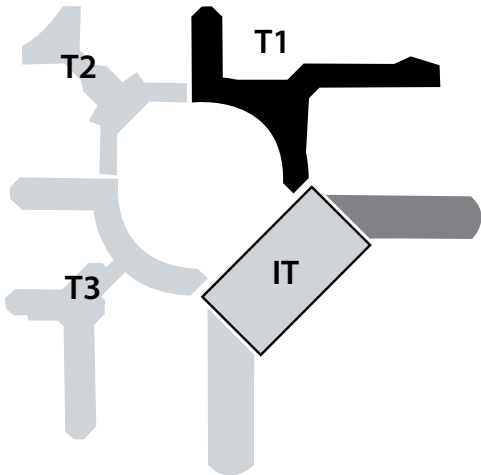

STAGE 2B
JUN 2019 - SEP 2020
17
ACTIVE GATES

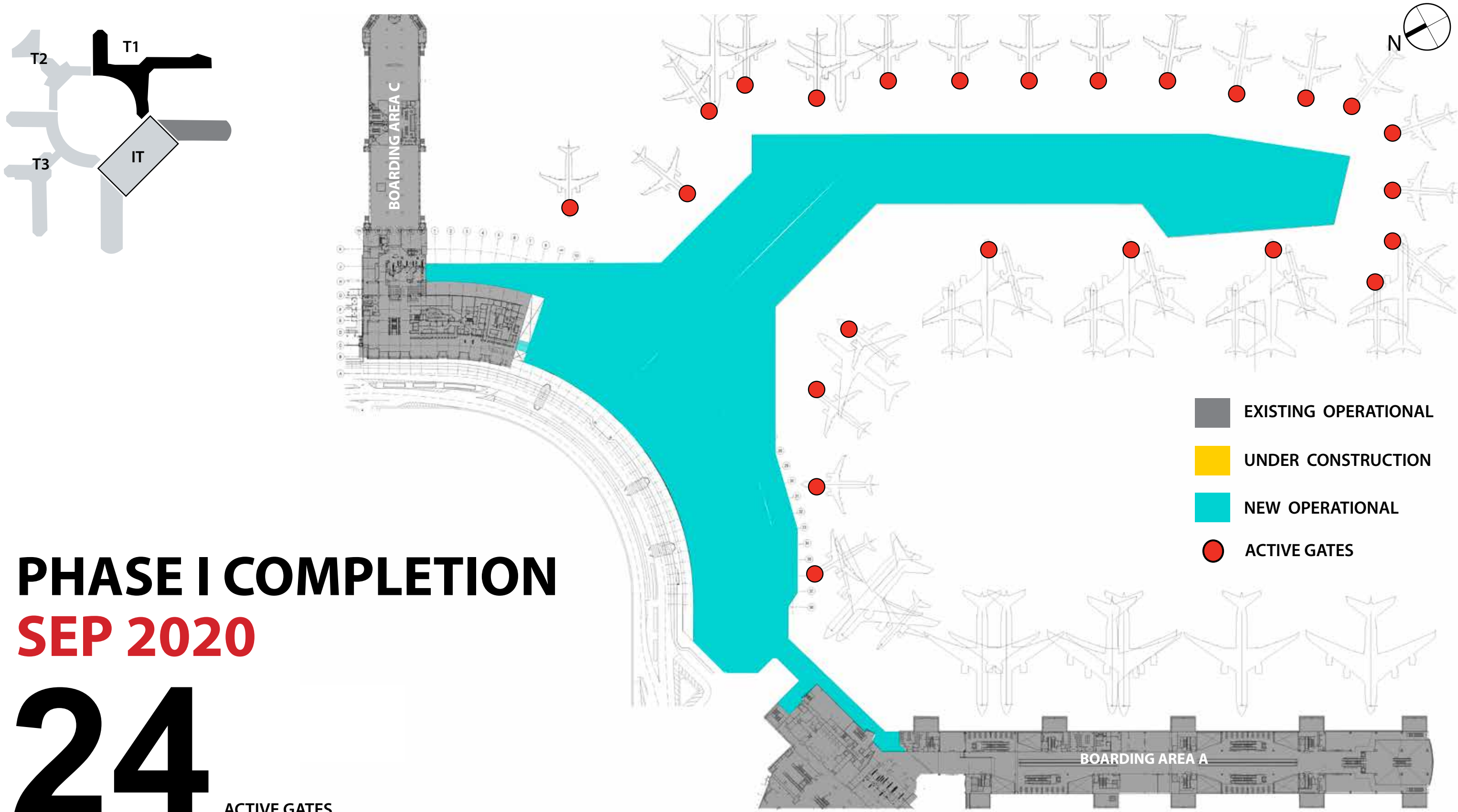

THANK YOU