

“Comfort Women” San Francisco Memorial

CALL FOR ARTISTS

Gift of Public Art for the City of San Francisco

“Comfort Women” Justice Coalition

July 2016



“COMFORT WOMEN”
JUSTICE COALITION

**COMFORT WOMEN
MEMORIAL
SAN FRANCISCO, 2015**

RESOLUTION, urging the City and County of San Francisco to establish a memorial for “Comfort Women” and to educate the community about stopping global human trafficking of women and girls.

RESOLVED, That appropriate City and County agencies will work with the community organizations to design and establish the memorial; and, be it

FURTHER RESOLVED, That the Board of Supervisors of the City and County of San Francisco during the 70th anniversary of the end of World War II expresses its strong support of creating a public memorial in memory of those girls and women who suffered immeasurable pain and humiliation as sex slaves and as a sacred place for remembrance, reflection, remorsefulness, and atonement for generations to come.

***“To build new understanding, unity
and alliance around the common spirit
of justice and peace for everyone.”***

***-Supervisor Eric Mar
San Francisco, CA 2015***

TABLE OF CONTENTS

1. Project Summary
2. Partnerships and Public Outreach
3. St. Mary's Square Extension
4. Call for Artists
5. Public Art Selection Considerations + Procedure
6. Budget and Timeline
7. Examples

1. PROJECT SUMMARY

Upon unanimous resolution by the San Francisco Board of Supervisors in 2015, a memorial to the “Comfort Women” shall be designed and established in cooperation with community organizations and with the collaboration of the various city agencies. The site location of the memorial is St. Mary’s Square, situated at the crossroads of Chinatown and the Financial District.

With the Support of the Mayor’s Office, the Board of Supervisors, as well as the consultation of lead Architects Heller Manus, the Developer of the 500 Pine Site has agreed to provide a slab for and installation of the “Comfort Women” Memorial. This pre-existing agreement specifies a 4’x 9” footprint with an approximate height of 10’ to be located in the SW corner of the extension within a complimentary relationship to the CCC-commissioned sculpture by artist Sarah Sze. The location, orientation and size are pursuant to the already approved public space parameters and vision for the site identified in public meetings and with the guidance of the City Agencies.

The “Comfort Women” Justice Coalition (CWJC) is collaborating with the City of San Francisco Recreation and Parks Department and the San Francisco Arts Commission to obtain the requisite approvals for this gift of public art to the City. CWJC is further working with Chinatown Community Development Center, the Committee for Better Parks and Recreation in Chinatown, many other organizations and the public to bring an art installation into the Chinatown neighborhood, which will increase the quality of open space and community engagement in Chinatown and the Financial District.

The CWJC will request proposals for a permanent public art piece to be installed in St. Mary’s Square Extension, at 500 Pine Street. The public art is expected to be completed by early 2018. The proposal for a new a memorial will be pursuant to and in accord with the goals and objectives presented in the San Francisco Planning Department’s Chinatown General Area Plan, and current community needs and desires for better use and quality of experience in the currently underused St. Mary’s Square.

2. PARTNERSHIPS & OUTREACH

The building of this Memorial in San Francisco will not be divisive but rather a great act of Unity. The making of a new memorial and dedication to the human rights and justice of women and girls in the public realm of the City will like urban acupuncture causing rippling waves of healing in the community, the city, the nation and around the world.

The “Comfort Women” Justice Coalition is a multi-ethnic, multi-interest human rights coalition. Its members include dozens of organizations committed to remembering the history and paying tribute to the courage of the “Comfort Women”. The CWJC has broad community support.

Mobile Studio will serve as the Project Managers for the Comfort Women Memorial Project. The interdisciplinary community-based art and design studio specializes in co-creative public process and public places that provide opportunities for peace and reconciliation.



Kevin Lu of REDEFINE presents a gift to Grandmother Lee on the occasion of her recent visit to San Francisco and the Comfort Women Justice Coalition Public Meeting March 28, 2016.

“No, this is not a political or diplomatic issue. It’s a human rights issue. An examination of past facts has to be done clearly so there won’t be any more women and children suffering from the same damage in the future.”

- Minister of Gender Equality and Family, South Korea, Kim Hee- Jung

3. ST. MARY'S SQUARE EXTENSION

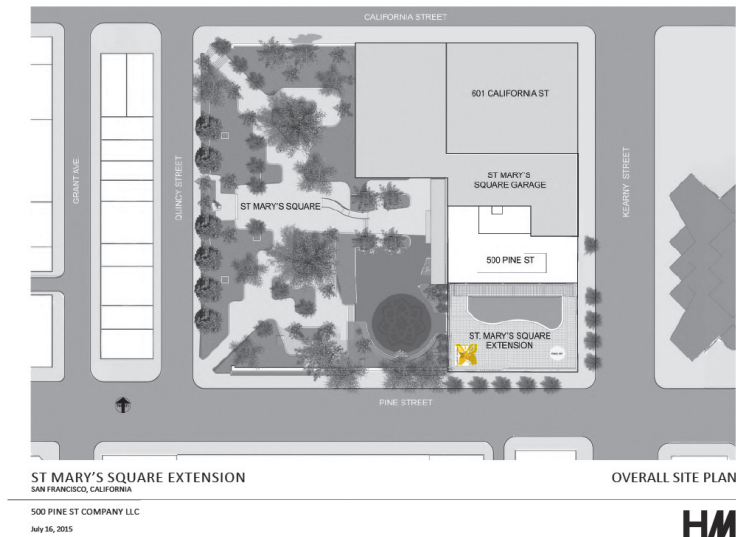

Saint Mary's Square is a culturally and historically significant public space in the greater Chinatown community and within the heart of Downtown San Francisco. With mature trees, many benches and a small children's playground it serves as a respite from the bustle of the street.

The new addition to the park under construction at 500 Pine will enhance the quality and expand the usership of the St. Mary's Square. Public art will help revitalize St. Mary's as an international destination. The recently commissioned Chinese Cultural Center sponsored sculpture designed by artist Sarah Sze as well as the "Comfort Women" memorial will add a depth of meaning, historic significance and aesthetic beauty to the park. This new space is quite open for tai chi practice, gathering and exercise and offers great views of the City.

Site Description

- 1 The memorial site is at the southwest corner of the new extension of St. Mary's Square
- 2 St. Mary's Square is a public park managed by San Francisco Recreation and Parks.
- 3 The provided footprint for the base of the memorial is 4' deep x 9' long aligned with the western edge boundary between the old and new parts of the park.
- 4 The height of the Memorial is approximately 10' tall including its base or podium.
- 5 The weight of the Memorial shall not exceed 100 lbs. per square foot.
6. The monument must be built of durable materials able to endure both weather and vandalism.

4. CALL FOR ARTISTS

Few memorials speak of women, even less their suffering, courage, endurance, and determination to achieve justice. This memorial will speak of all that and more.

This international design competition for the “Comfort Women” Memorial seeks art and design proposals for the selected site in St. Mary’s Square Park that honor and remember those who have suffered and inspire a commitment to the on-going fight for justice for the ‘Comfort Women’ and for the safety and rights of women and girls around the world.

From 1931 through 1945 during World War II, approximately 400,000 girls and women from more than 11 countries were sexually enslaved by the Imperial Japanese Armed Forces. The majority was from China, Korea, the Philippines, and Dutch Indonesia, with many from Burma, East Timor, Japan, Malaysia, Taiwan, Thailand, Vietnam, amongst others countries. These girls and women, through coercion, deceit and brutal force, were subjected to exploitation and unspeakable pain and torture every day of their short lives. They were the “Comfort Women” for the Japanese military, a euphemism for sex slaves.

More than 75 years later, their long struggle demanding justice for this unprecedented government-run system of wartime sexual enslavement is not over. Successive Japanese Administrations continue to deny the truth of that massive crime against humanity and to spend millions of dollars to hide or sanitize that war crime and other atrocities committed by the Imperial Japanese Army during World War II. Unfortunately these horrors still take place at sites of national and international conflict today.

When the former “Comfort Women” broke their silence, they changed the Human Rights landscape forever. In 1993, sexual violence as a strategy of war was declared a crime against humanity by the United Nations. At the same time people began to understand the horrors of sex trafficking and its relationship to militarism and violence against women.

For decades, the survivors have been fighting the Japanese government, demanding it to own up to its past and offer official apology, legal compensation and ongoing education to protect the next generation from the same egregious crime they went through. The last surviving victims, in their late 80s and 90s, are dying without seeing Justice. In 2015, the San Francisco Board of Supervisors unanimously passed a resolution to build a Memorial to the “Comfort Women” in San Francisco, and to educate the community about stopping human trafficking of women and girls. This clear mandate by the City of San Francisco, which has supported peace and justice through its vibrant history, will serve as an international beacon of hope around the world.

Help us design this memorial to honor and remember the suffering, struggle and courage of the so-called “Comfort Women”. Help us create this memorial as a lesson in history, as a symbol of the on-going search for justice and peace and a call to advocate for the rights and safety of women and girls around the world. We hope you will bring your ideas, visions and talent to this international public art competition and significant public space in the heart of San Francisco!

"COMFORT WOMEN" MEMORIAL, SAN FRANCISCO: SITE CONTEXT

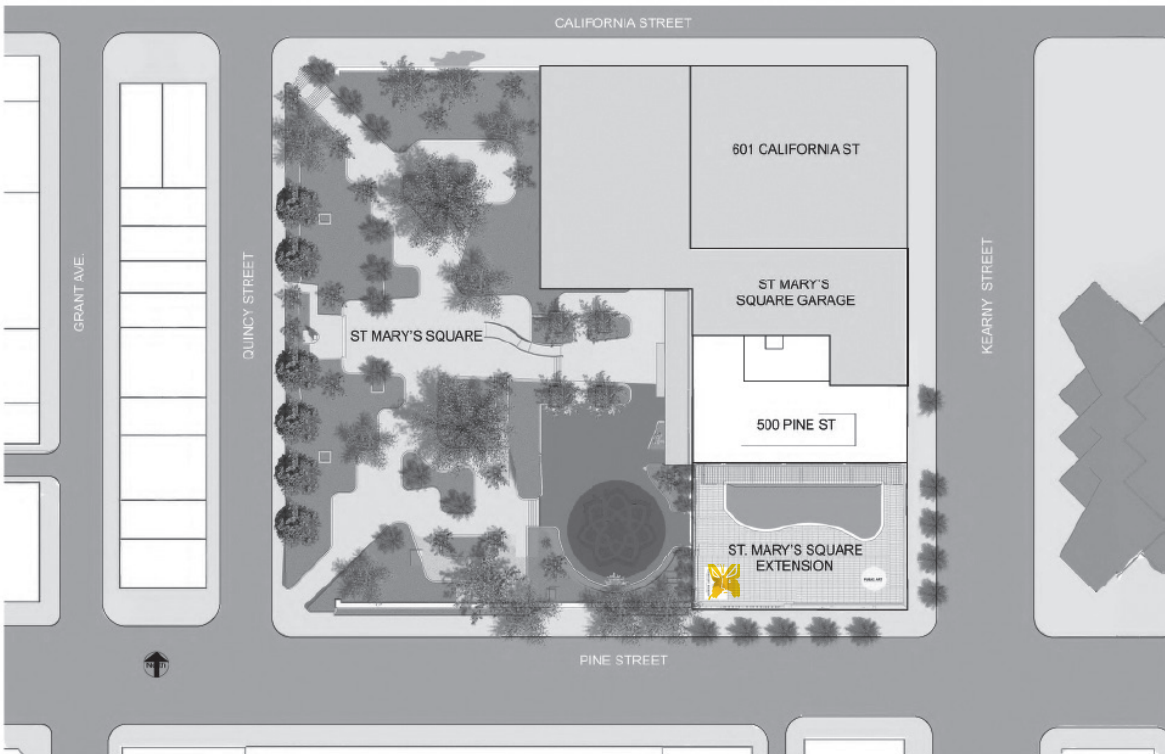

ST MARY'S SQUARE EXTENSION
SAN FRANCISCO, CALIFORNIA

OVERALL SITE PLAN

500 PINE ST COMPANY LLC

July 16, 2015

"COMFORT WOMEN" MEMORIAL SF SITE: ST. MARY'S SQUARE

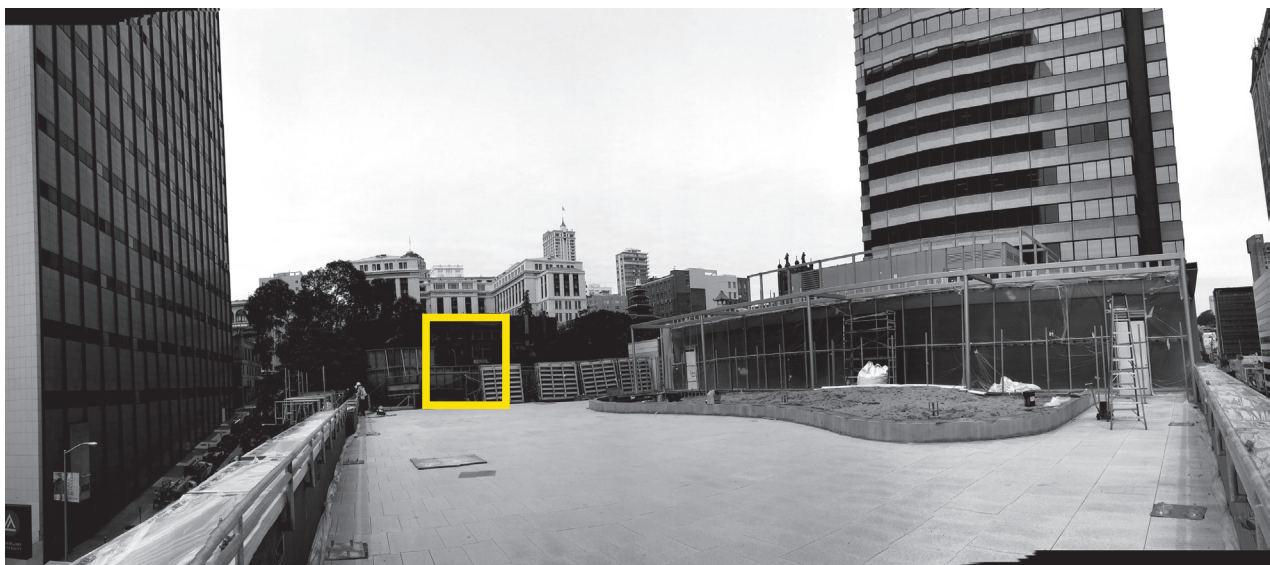

"COMFORT WOMEN" MEMORIAL SF SITE: WEST ELEVATION

5. PUBLIC ART SELECTION + PROCEEDURE

This international design competition seeks proposals from artists for the “Comfort Women” memorial that address Memory, Dialogue, Peace and Reconciliation, Transformation and Justice. The memorial will offer a place for community members and visitors to remember, grieve, learn, find peace and commit themselves to human rights, justice and safety for women and girls around the world.

An honorary jury has been empaneled to evaluate the proposals and select the finalists based on conceptual, aesthetic and material criteria. Three finalists will be identified with community input and the jury will select the Memorial artist who will participate in public meetings and community presentations, implement the project as required, overseeing the production of the work. .

Public Art Panel Bios

Henry Der was born in Chinatown (Chinese Hospital), and as a youngster, he frequently played in St. Mary’s Square, and often accompanied his mom to the Kong Chow Temple. Mr. Der worked as executive director of San Francisco Chinatown-based Chinese for Affirmative Action for more than two decades. He has served as Deputy Superintendent of Public Instruction for the California Department of Education, running programs that serve at-risk and special needs students. He currently works as Senior Program Officer at Four Freedoms Fund, a national funders’ collaborative that is supporting pro-immigrant groups across the country that advance the integration and rights of immigrants. He helped co-lead the successful, grassroots community campaign for the construction of the San Francisco City College Chinatown-North campus facility.

Jennifer Dunlop Fletcher, is the SF MOMA’s Helen Hilton Raiser Curator of Architecture and Design. She oversees the Departments acquisitions, exhibitions and publication.

<https://www.sfmoma.org/press/release/jennifer-dunlop-fletcher-to-lead-sfmomas-departme/>

Phyllis Kim is Executive Director of the Korean American Forum of California. The group is dedicated to raising awareness regarding the unresolved history of the ‘Comfort Women’ as well as to pressuring the government of Japan to formally acknowledge and apologize for its past war crime of military sexual slavery. <http://kaforumca.org>

Kelli Morgan, is the Lowe Curatorial Fellow at the Pennsylvania Academy of Fine Arts. She is a curator, writer, critical race art historian whose work focuses on African American women's art, within the context of issues of justice, race, representation. She is a strong, critical advocate for modern and contemporary art with an experienced urban eye for cutting edge work. <http://artsbma.org/meet-the-curator-kelli-morgan/>

FIFTH JUROR TBA

SELECTION CONSIDERATIONS

All application materials that meet the requirements will be reviewed and selected by the Comfort Women Justice Coalition Public Art Panel. Three finalists will be notified by CWJC staff once selection has been made. Each finalist will be given a \$1,000 stipend to prepare and submit a full project proposal in October, 2016 (date TBD) with specified requirements.

ELIGIBILITY:

This is an international competition open to all entries that meet the objectives outlined in the overview. Eligibility is open to professional, practicing artists and collaboratives. Artists who have public art experience are strongly preferred.

Submission Requirements

1. Three 20 inch by 20 inch boards (300 dpi [12,600 pixels by 900 pixels], max. file size 6mb).
2. Project title and design concept statement on the boards should not exceed 300 words.
3. One site plan of park with monument in place (1 inch = 25 feet).
4. One site plan of the monument site (1 inch = 1 foot).
5. One front and rear elevation of the monument (1 inch = 1 foot).
6. One rendering or perspective view of the monument.
Conceptual drawings, including additional plans, sections, elevations as needed.

6. PROJECT TIMELINE

The Comfort Women Justice Coalition is a non-profit organization that has fundraised contributions to finance and install artwork with an estimated value of \$145,000 within St. Mary's Square. The \$140,000 budget shall be used for the design, materials, and installation of the public art, as well as the artist's compensation.

Project Timeline (dates subject to change) will additionally include two public exhibitions of the work for review and input regarding 1. the selection of the top 3 artists and 2. the selection of the final artist and proposal.

RFP Issue	Aug 1, 2016
Info Session	Aug 20, 2016
RFP Deadline	Oct 15, 2016
First Selection	Late October, 2016
Artist Notification	Nov 1, 2016
Finalist Proposal Due	November 25, 2016
Final Selection	December 10, 2016
Rec + Parks + Art Commission Submission	December 20, 2016
Project Construction	2017



Images:

left to right

Comfort Women Memorial, Seoul South Korea, Made by Leo Shi'yong and Pan Yi -Qun

"Freedom-Corner" Sculpture/ monument, in the Pittsburgh Hill-District,
by Carlos Peterson Howard Graves



Examples of Memorials from around the World ~ a theme of Peace and Justice

Images above clockwise:

1. Bill of Rights Memorial, Sculptor Joseph Kincannon, Phoenix Arizona
2. Memorial to the missing and murdered Aboriginal Women and Girls, The Forks, Winnipeg, Manitoba
3. Battle of Tit, Monument Tunisia, Tuareg.
4. Goddess Nuva Repairs Hole in the Ozone Layer, Professor Yuan Xkun, Sculpture Times Square
5. Bourrasque-light-sculpture, Artist, Paul Cocksedge, Lyons, France
6. "Breathe", Artist Edwin Cheong, Singapore



Artists Clockwise:

1. Four Spirits, Memorial to Four Little Girls killed in the bombing of the 16th Street Baptist Church, Artist, Elizabeth Mac Queen,
2. Children's Bell Tower, Designed by Bruce Hasson
3. Gates of Violence, Monument for the end of Fascism, Vienna, Artist Alfred Hrdlicka
4. Freedom Parkway, Atlanta, Gateway to the Old Ninth Ward, Artist Xavier Medina-Campeny
5. Universal Links on Human Rights, Dublin, Artist Tony O'Malley
6. Nagasaki Monument at Nagasaki Atomic Bomb Museum, Tokyo Japan