

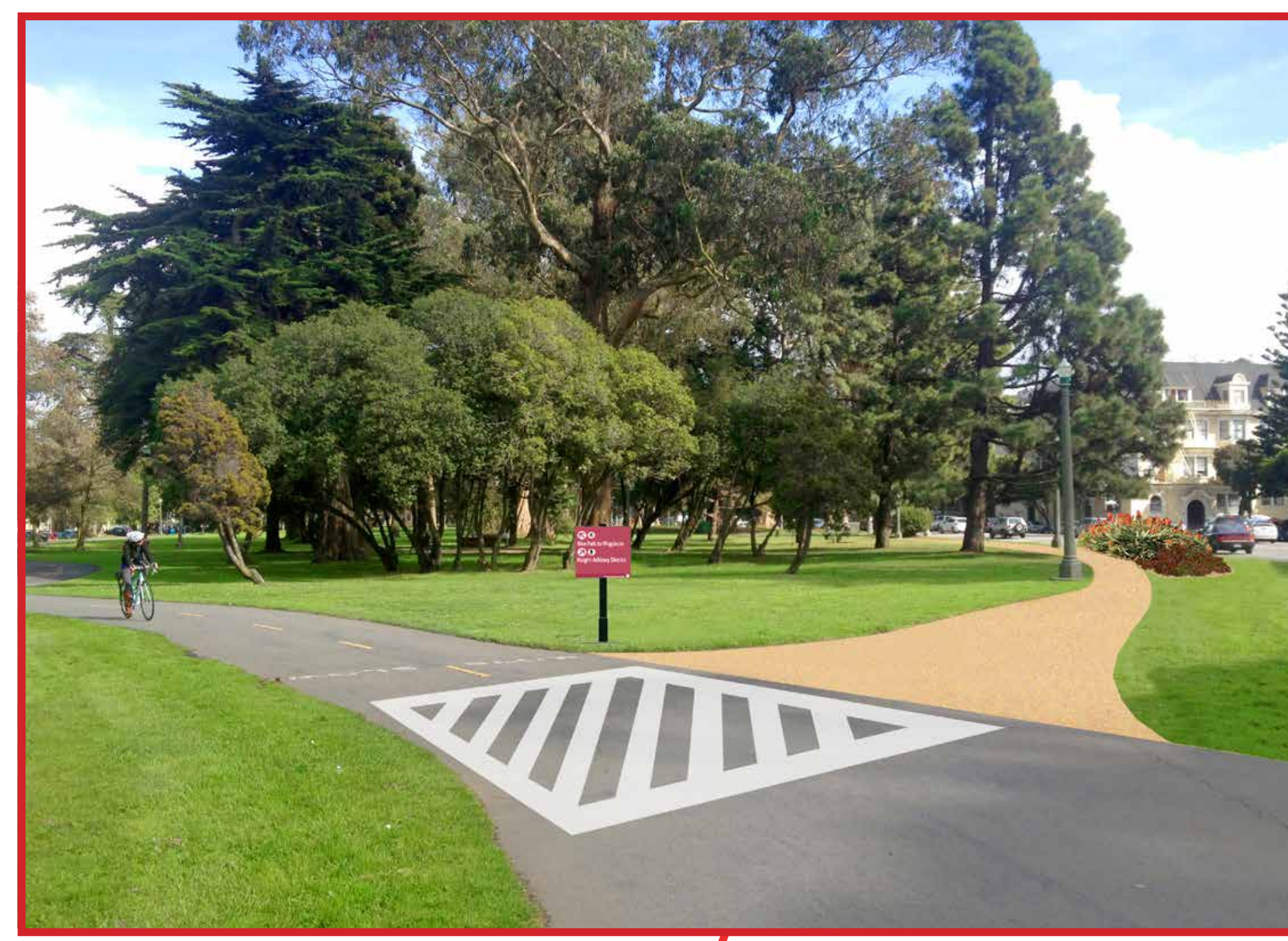

Standard GGP Map

Standard Identity Sign



Proposed View of Path Intersection



A Sharrow



Concept for Shared Path Signage intermittently on Ground

Concept for Intersection Striping

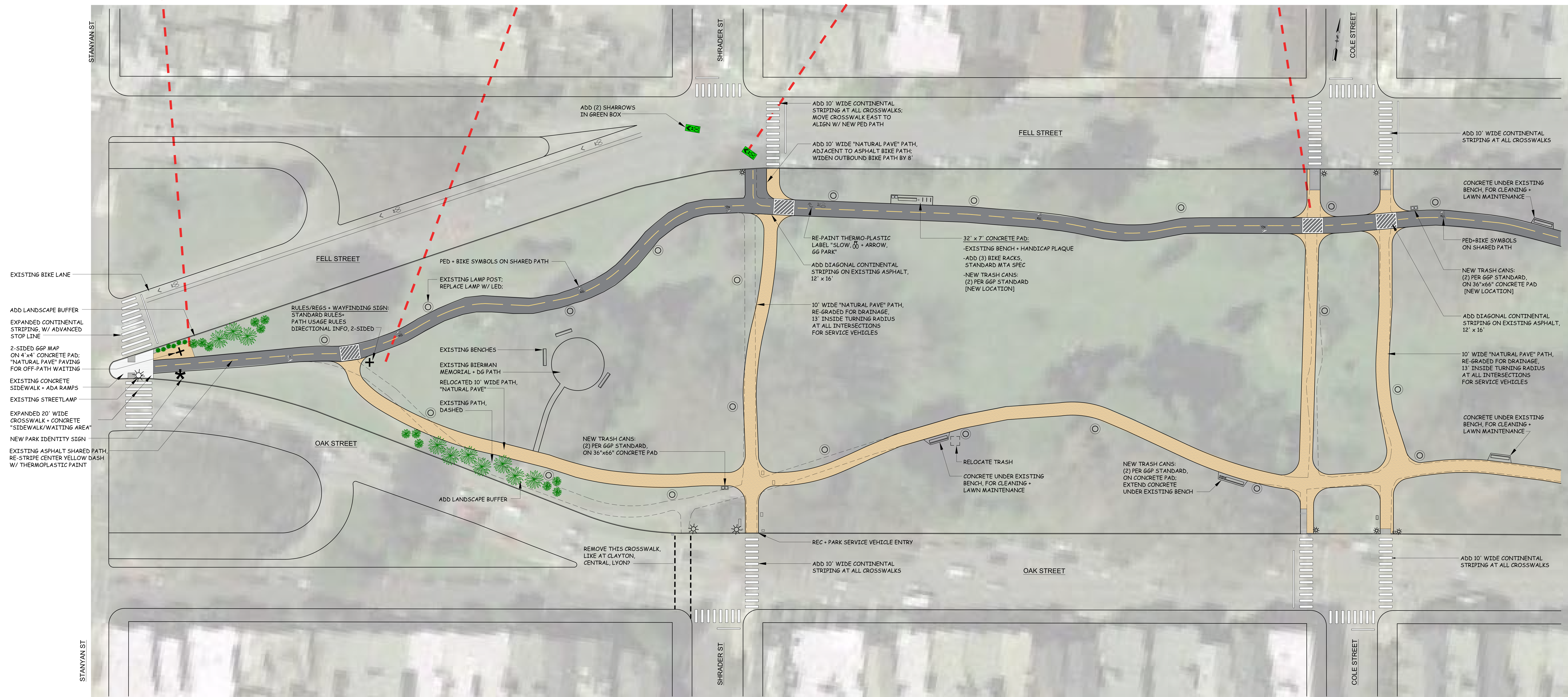

Stanyan to Cole

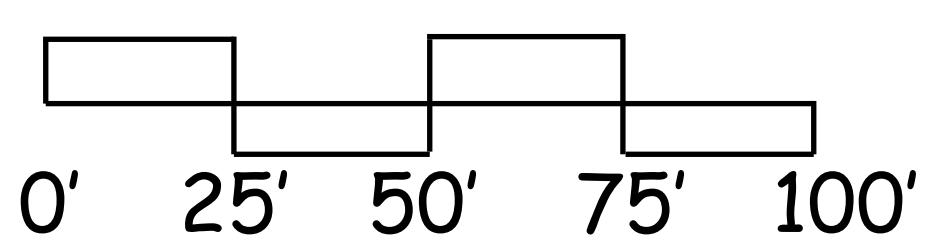

# PANHANDLE Path Improvements: A COF Grant Application to SF Rec+Park



Standard GGP Waste Bins



Paving Material Example (Natural Pave at Kezar Triangle)



Bike Rack Example



Signage Example

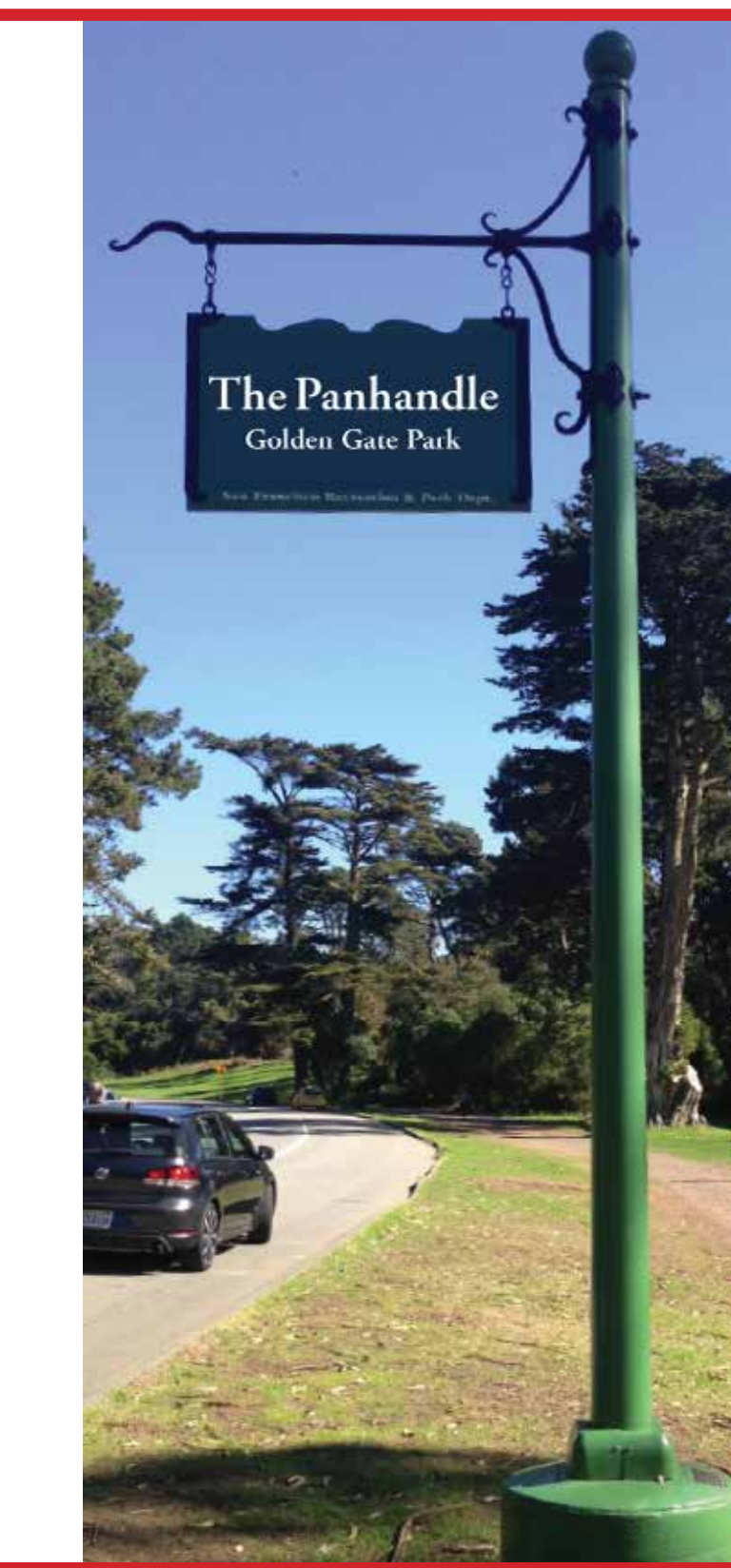

Standard Identity Sign

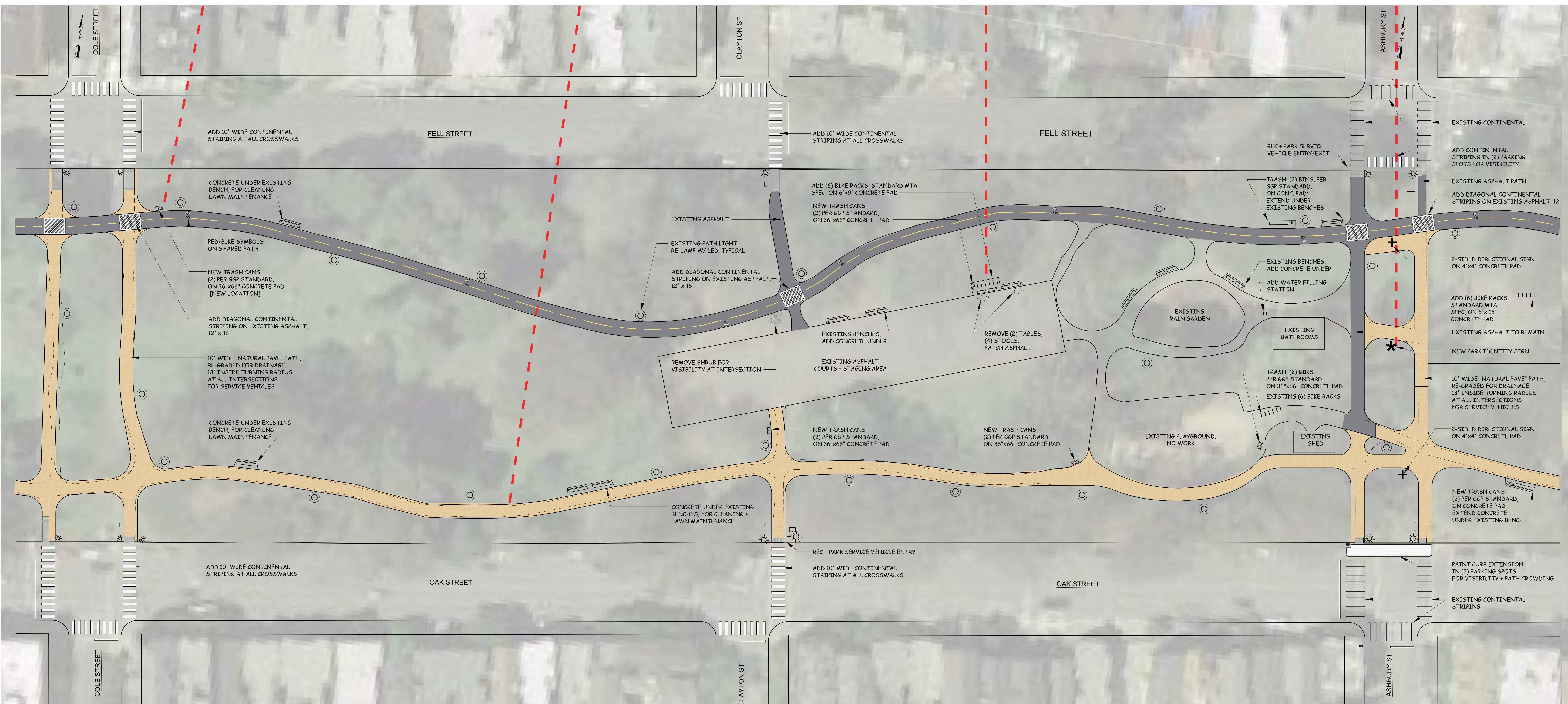

Cole to Ashbury

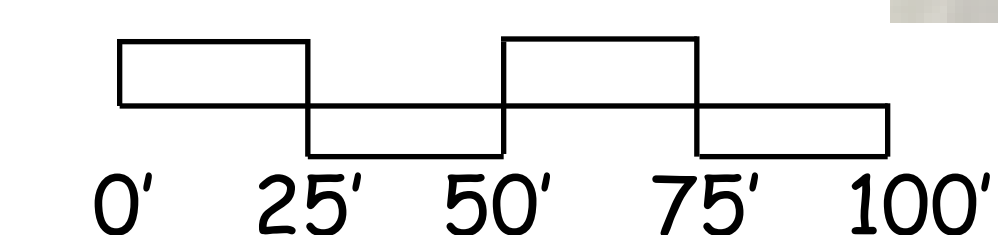

# PANHANDLE Path Improvements: A COF Grant Application to SF Rec+Park



Proposed water fountain + filling tap

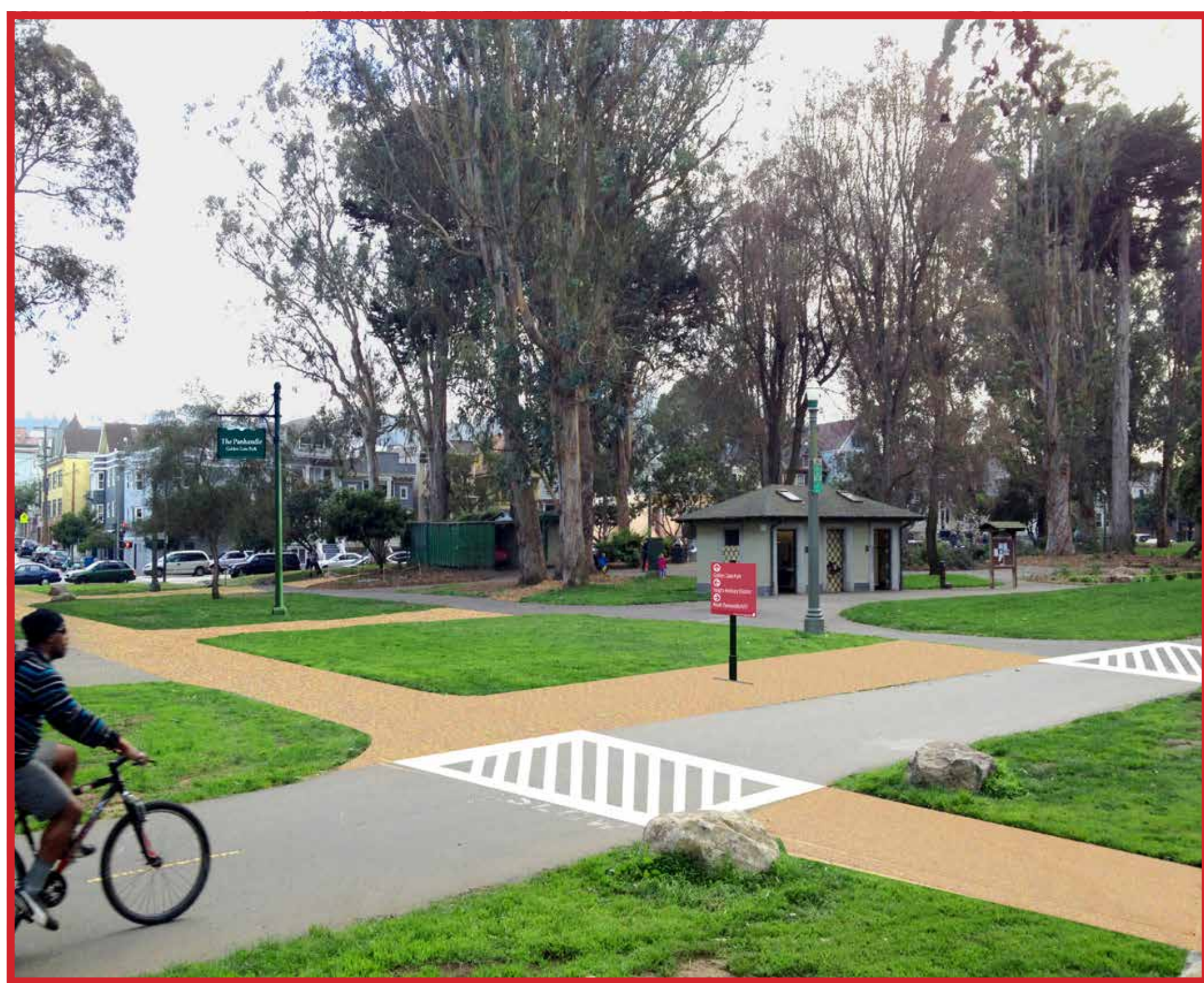

Proposed view at Ashbury



Signage Example

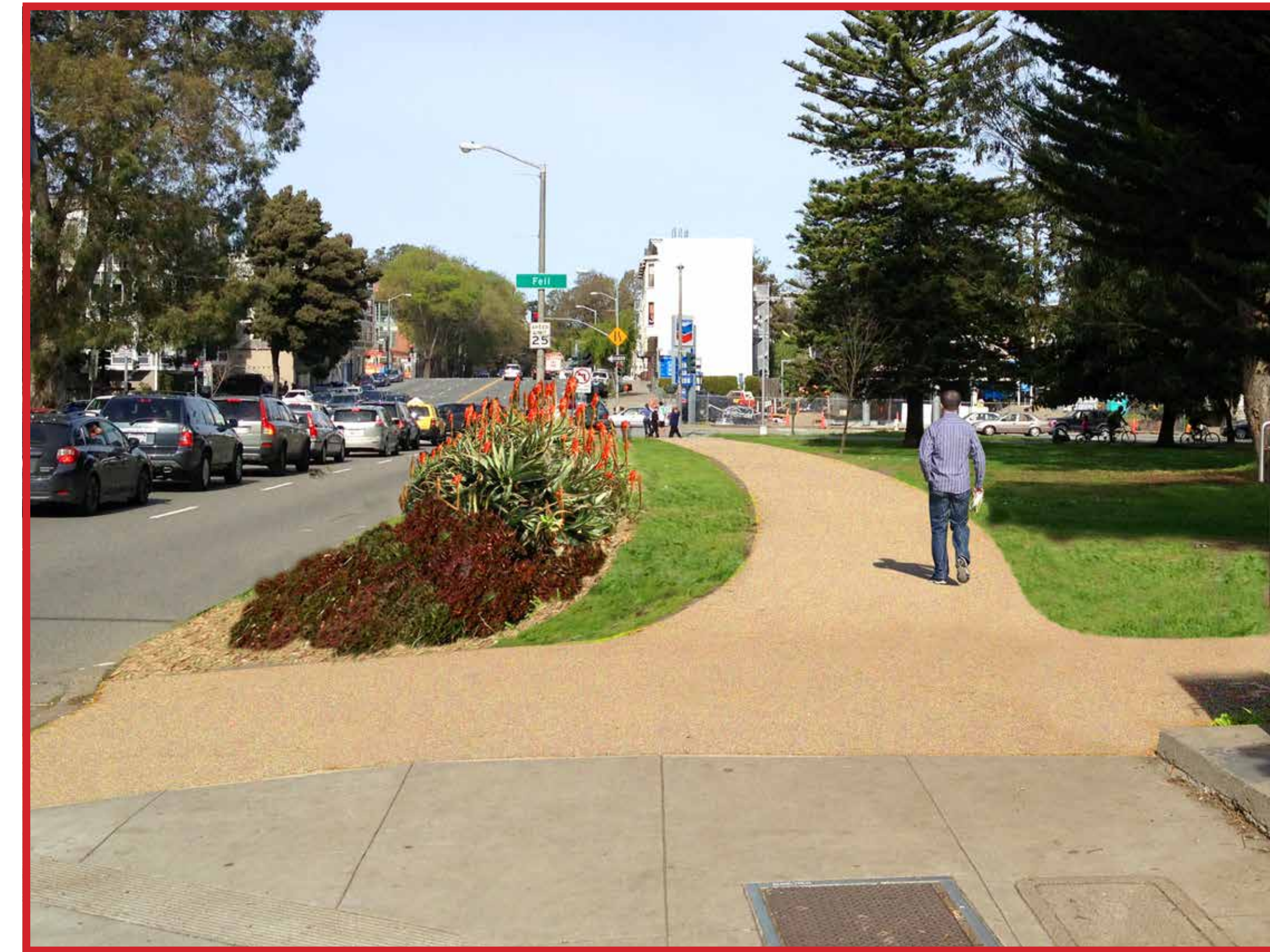

Proposed View of Masonic crossover

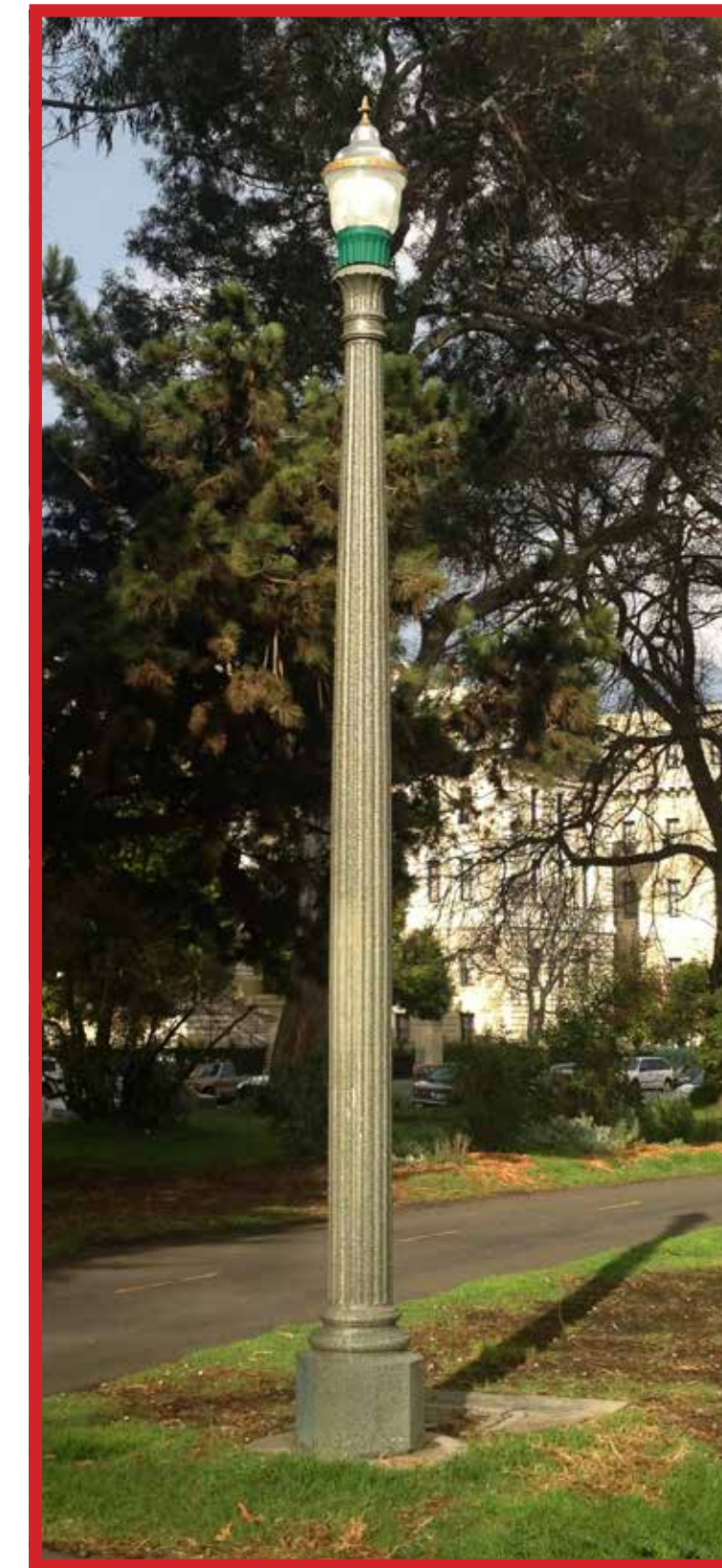

Existing Lights

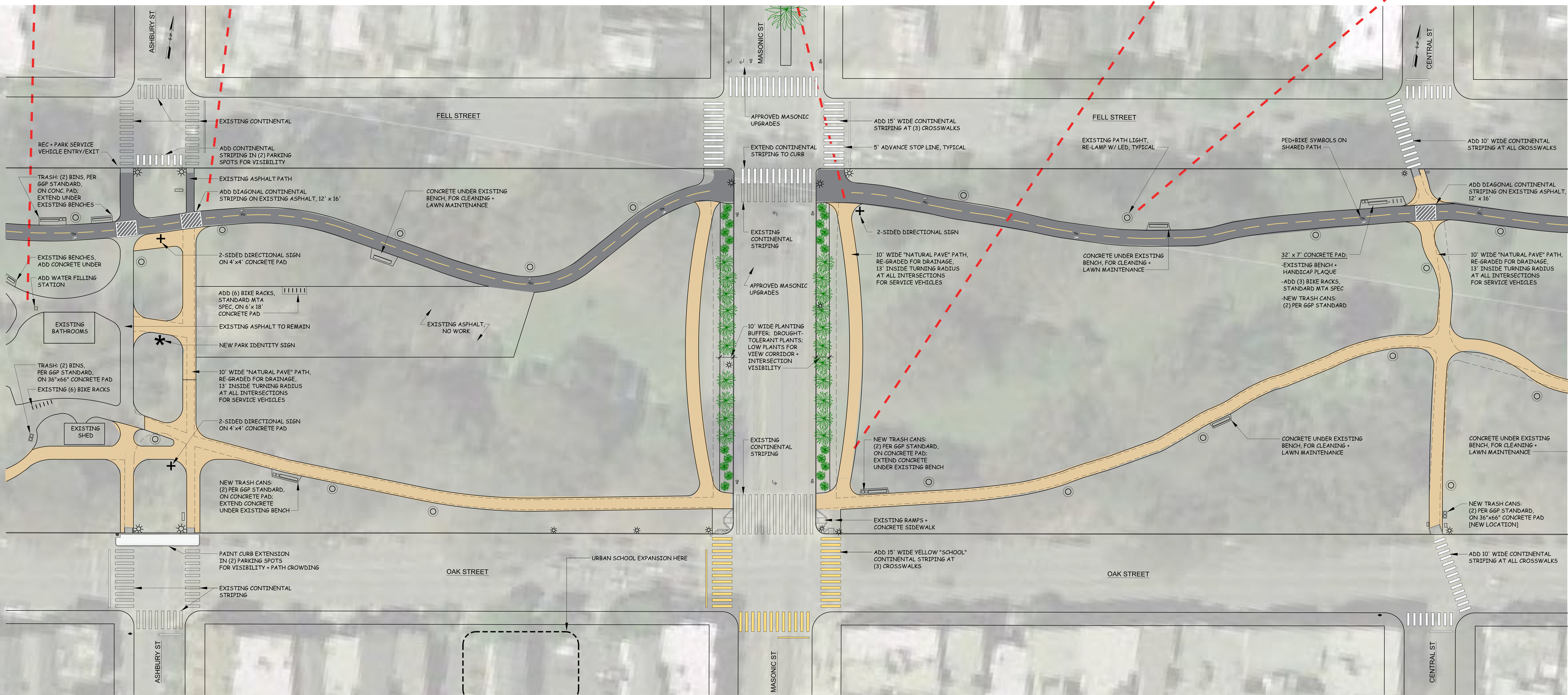

Ashbury to Central

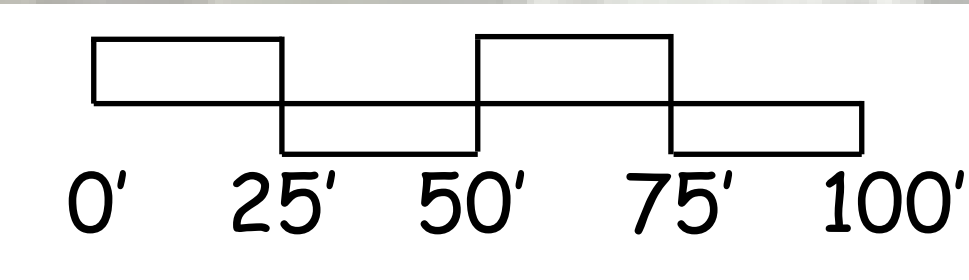

# PANHANDLE Path Improvements: A COF Grant Application to SF Rec+Park

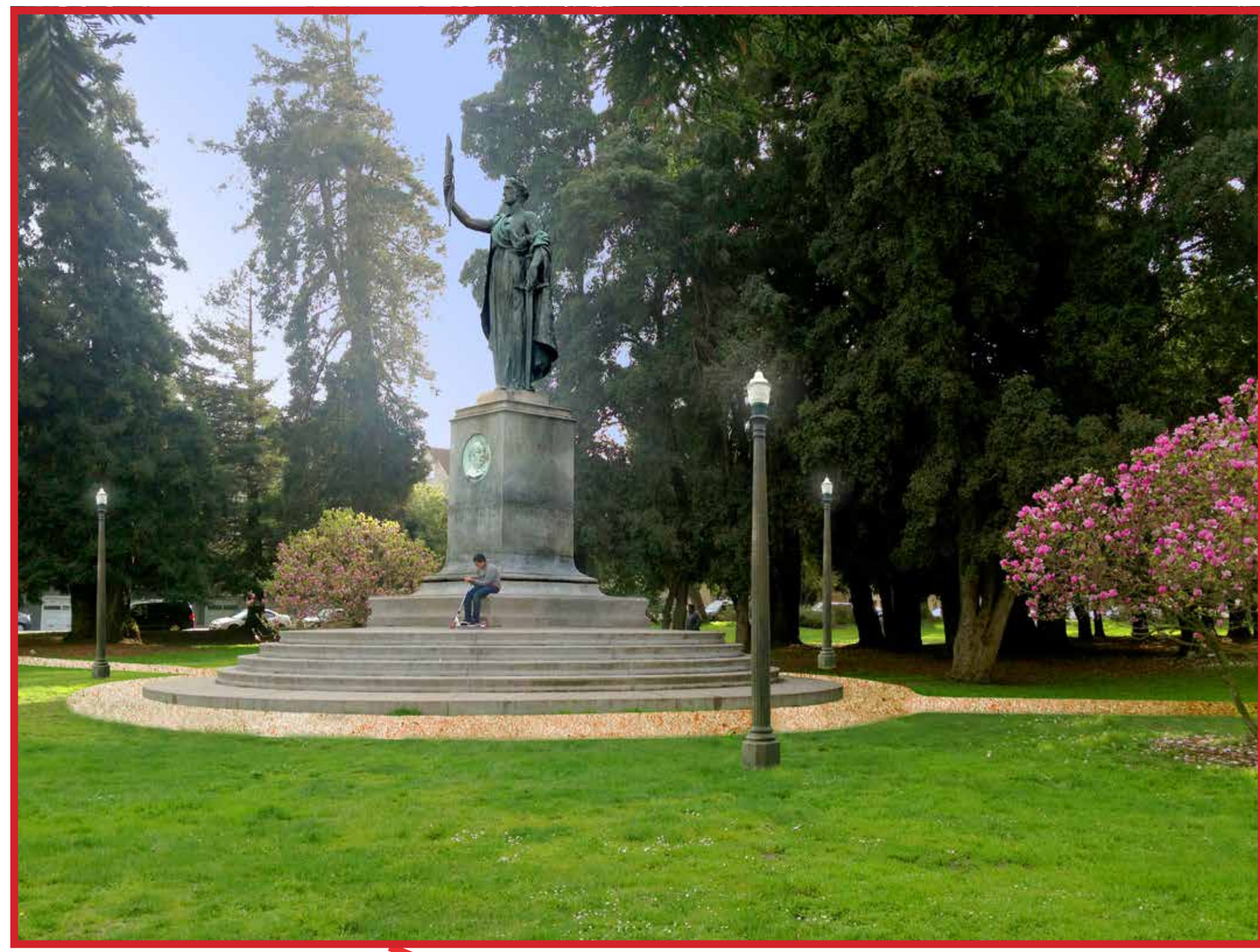

Proposed View of McKinley Monument

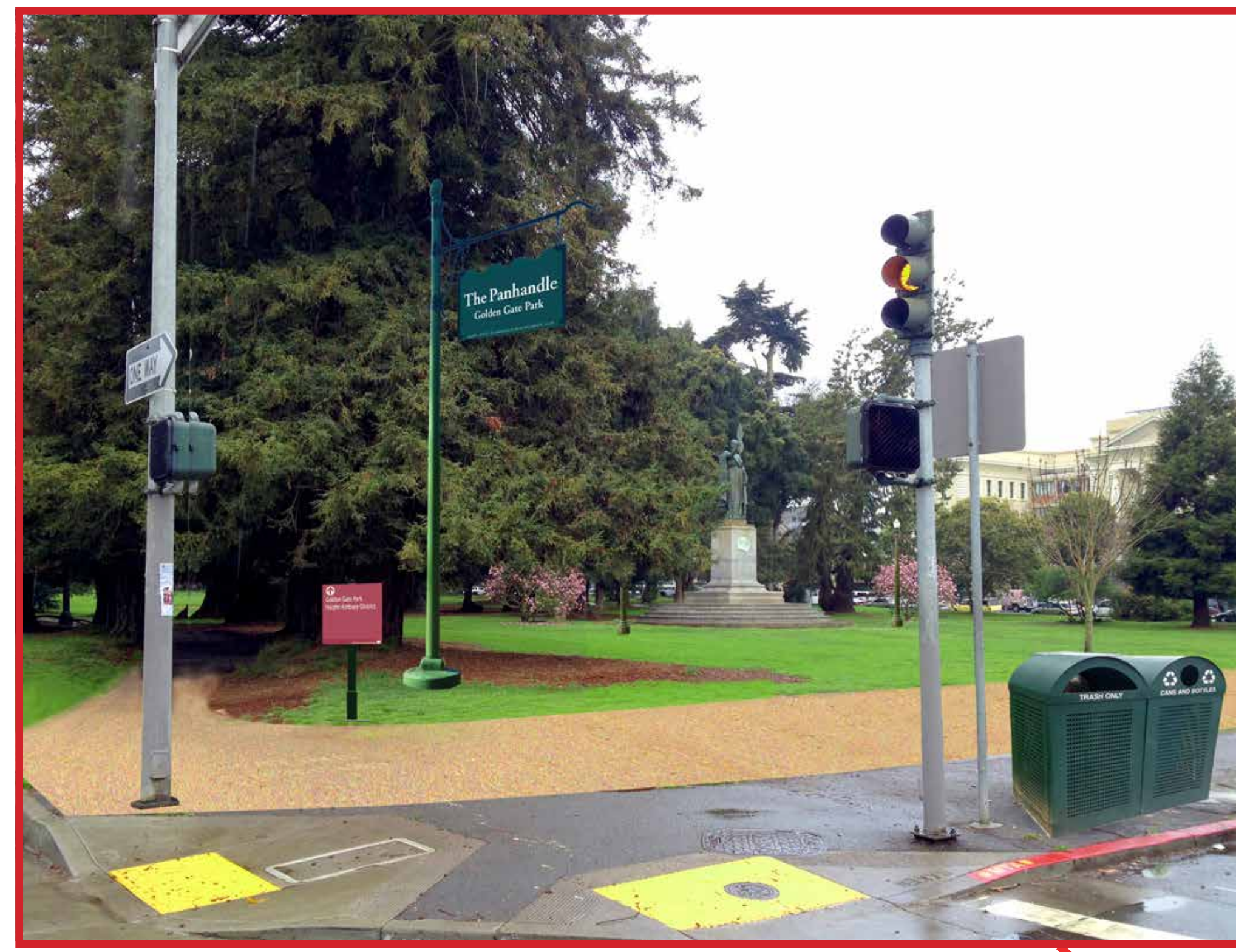

Proposed View of Oak + Baker



Signage Example

Standard Identity Sign



Example of no Curb @ Corner

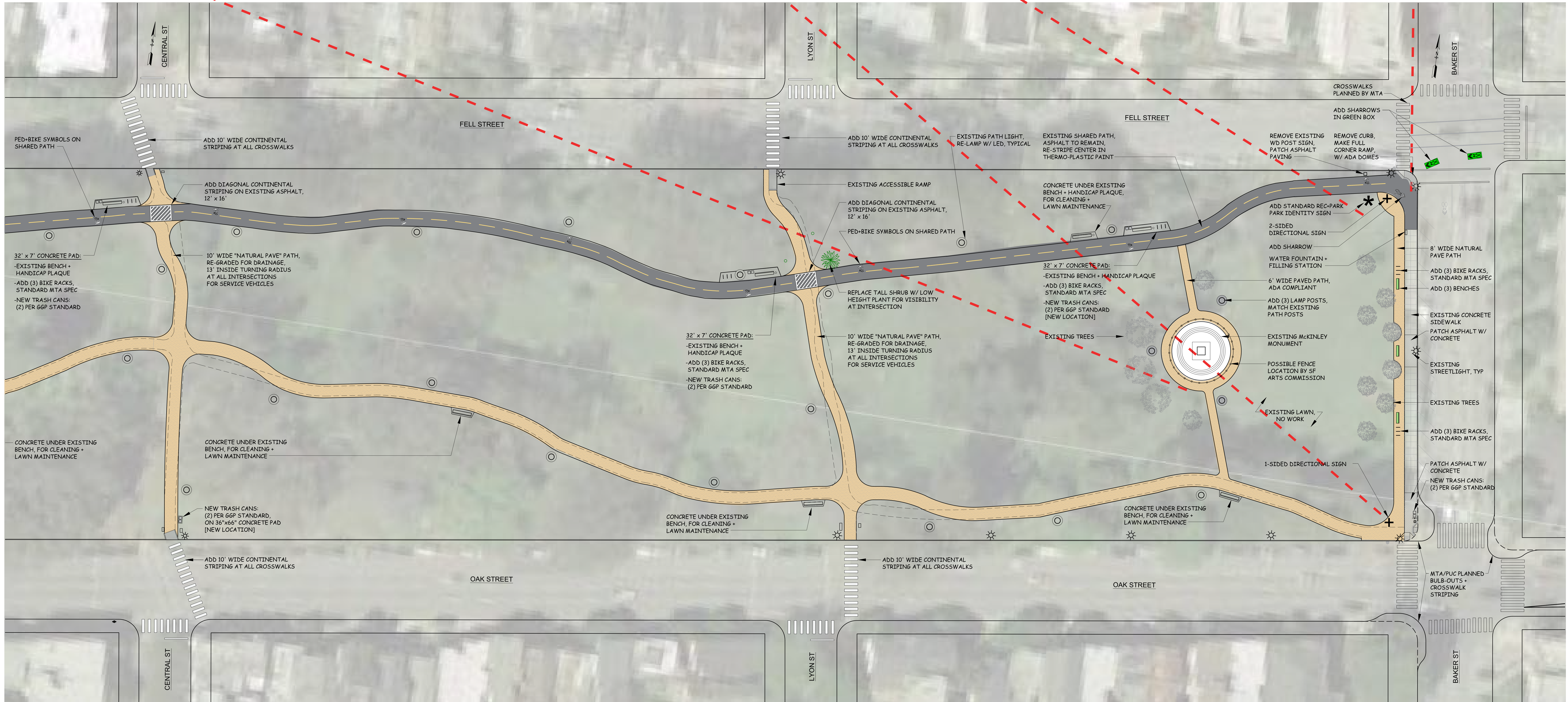

Central to Baker

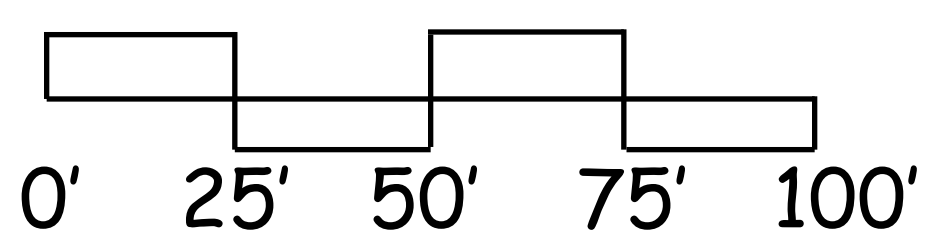

# PANHANDLE Path Improvements: A COF Grant Application to SF Rec+Park

# PANHANDLE PATH IMPROVEMENTS: PROJECT STATS

## IDENTITY AND WAYFINDING IMPROVEMENTS

- 3-4 park ID signs
- 7 wayfinding signs
- 5 bike sharrows

## PATH & SAFETY IMPROVEMENTS

- 65,700 square feet of path re-paved
- 3580 linear feet of shared path center line, re-stripped
- 9 new ped crossing stripes at path intersections (12' x 16')
- 31 street crosswalks with continental striping
- 68 existing light fixtures, re-lamped
- 3 new light fixtures
- 26 existing benches with new concrete underneath
- 3 new benches
- 30 new bicycle racks
- 12 existing trash locations with new double bins
- 4 new trash locations with double bins

## LANDSCAPE IMPROVEMENTS

- 7000 square feet planted buffer at paths near street curbs