

Conceptual Artwork Proposal – Tomie Arai  
Submitted November 3, 2014

Conceptual theme: Gate/Way (working title)

The artist proposes to tell a story about San Francisco Chinatown through a continuing visual timeline that begins on the platform level and winds across three sides of the parapet wall above the subway entrance. The working title of this artwork will be 'Gate/Way'; a double reference to the Central Subway station as a gateway to Chinatown, and the site of Chinatown as an historic gateway to America.

Incorporating traditional architectural elements such as the Chinese moongate, (the circular entranceway to Chinese gardens) Chinese latticework designs and Chinese motifs and symbols, the artwork for the station will reflect a dynamic tension between the past and present, old and new, and the natural and built environment.

On the platform level, the circle and square, traditional symbols for heaven and earth in Chinese culture will frame views of the historic past.

One wall will consist of images of the early settlement of San Francisco, the Yelamu Ohlone Indians, the gold rush, immigration to the US through Angel Island and the great earthquake. On the opposite wall, the resilience of the community of Chinatown and greater San Francisco will be celebrated through a montage of images from 1906 to the present. Historic photographs of the area will be embedded in the design, (visible to passengers at slightly above eye level).

Ascending to the surface level, images of present day Chinatown will unroll across three walls of the headhouse parapet like a scroll. As a way for the artwork to complement the design of the new plaza, the Stockton street wall closest to the plaza will begin with scenes from a garden. As a space of reflection, a garden is also symbolic of beginnings, growth, sustainability and roots in the community. At the juncture where the sides of the artwork meet, trees and foliage representing indigenous and transplanted flora will come together, suggesting that hybrid cultures are an inevitable part of the city in the 21st century. A pine tree based on a photograph of trees in Portsmouth square, indigenous California live oak and imported eucalyptus trees are an example of this hybrid mix.

Traveling across the Stockton street wall and around to the Washington Street wall, the artwork will shift from past to present, as the visual narrative becomes fragmented and more reflective of the busy pace of urban life. The request from the community at the public meeting held in August, to 'look forward, not backwards' will be evident throughout the artwork on the street level, where selected elements and motifs that appear on the platform level will be integrated into the surface level design as the viewer moves from the site specificity of a home and neighborhood, to a broader vision for the city's global future.

Proposed Designs for 'Gate/Way'  
Surface level artwork for parapet above subway entrance

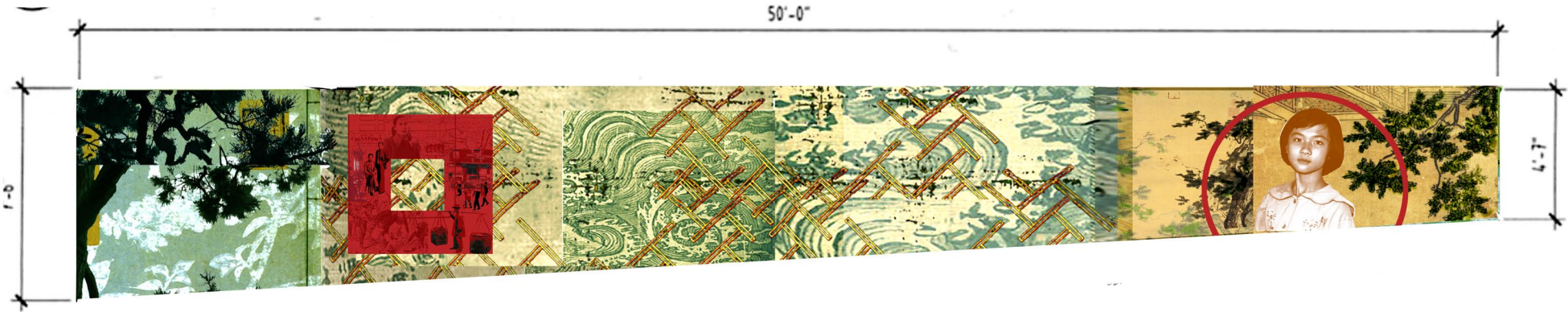

Artwork - Stockton

2  
XX-10

---

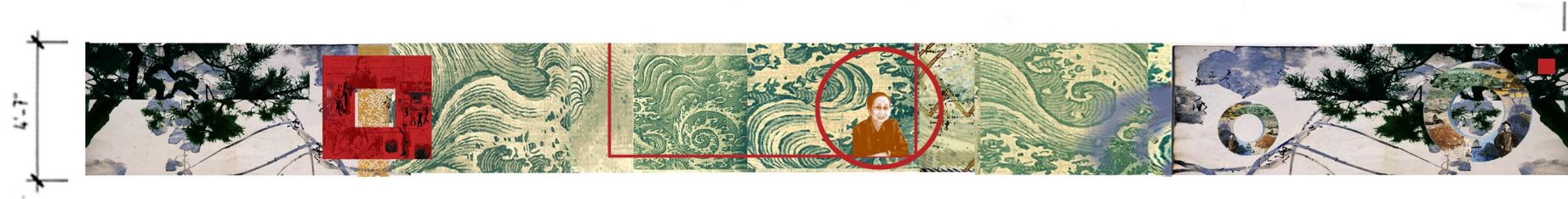

Artwork - Washington

1  
XX-10

---



Height from bottom of artwork to sidewalk

Stockton Elevation



Height from bottom of artwork to sidewalk

Washington Elevation



18 FT



blatt 7

Platform - South Wall  
Proposed design for 'Gate/Way'

18 FT

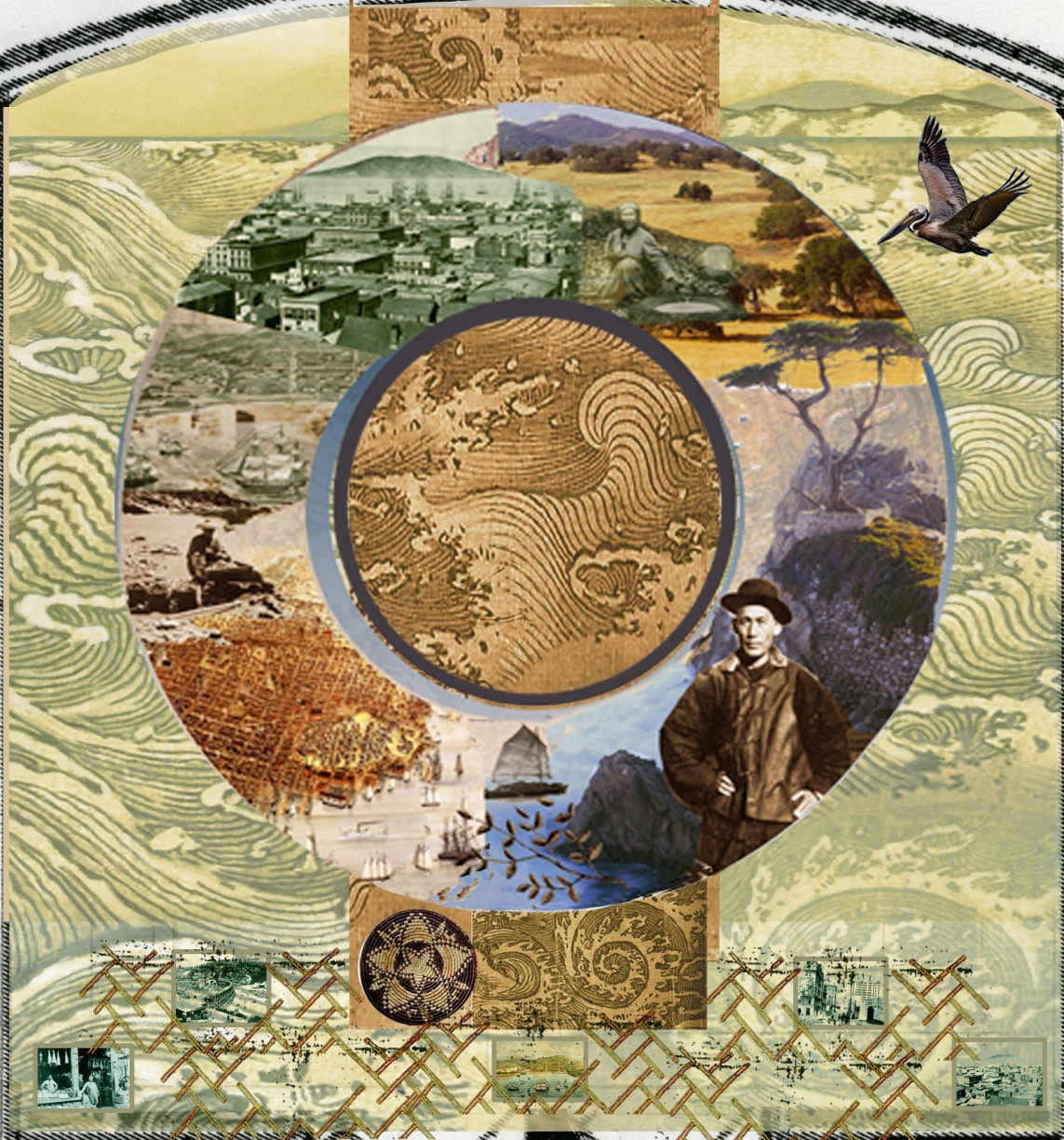

blatt 7

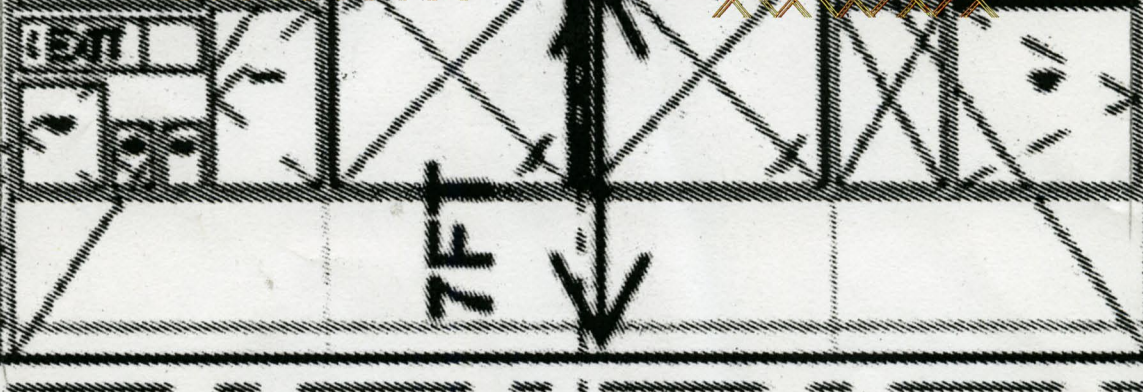

Platform - North Wall  
Proposed design for 'Gate/Way'

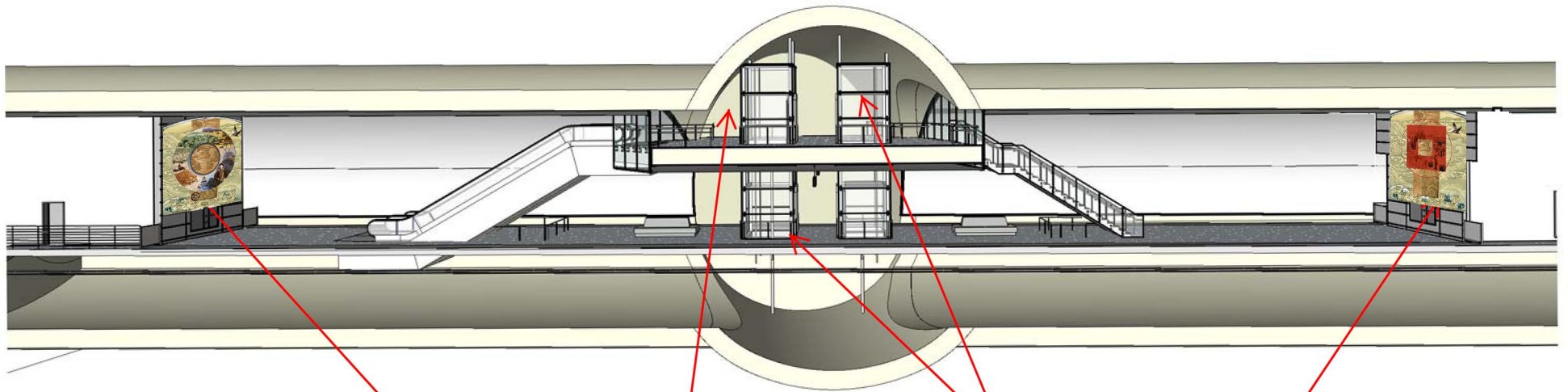

Platform North End Wall

Crossover Cavern End Wall

Platform Elevator Glass Enclosures

Platform South End Wall

**Chinatown Station**  
Summary of new potential art locations  
2011-03-17

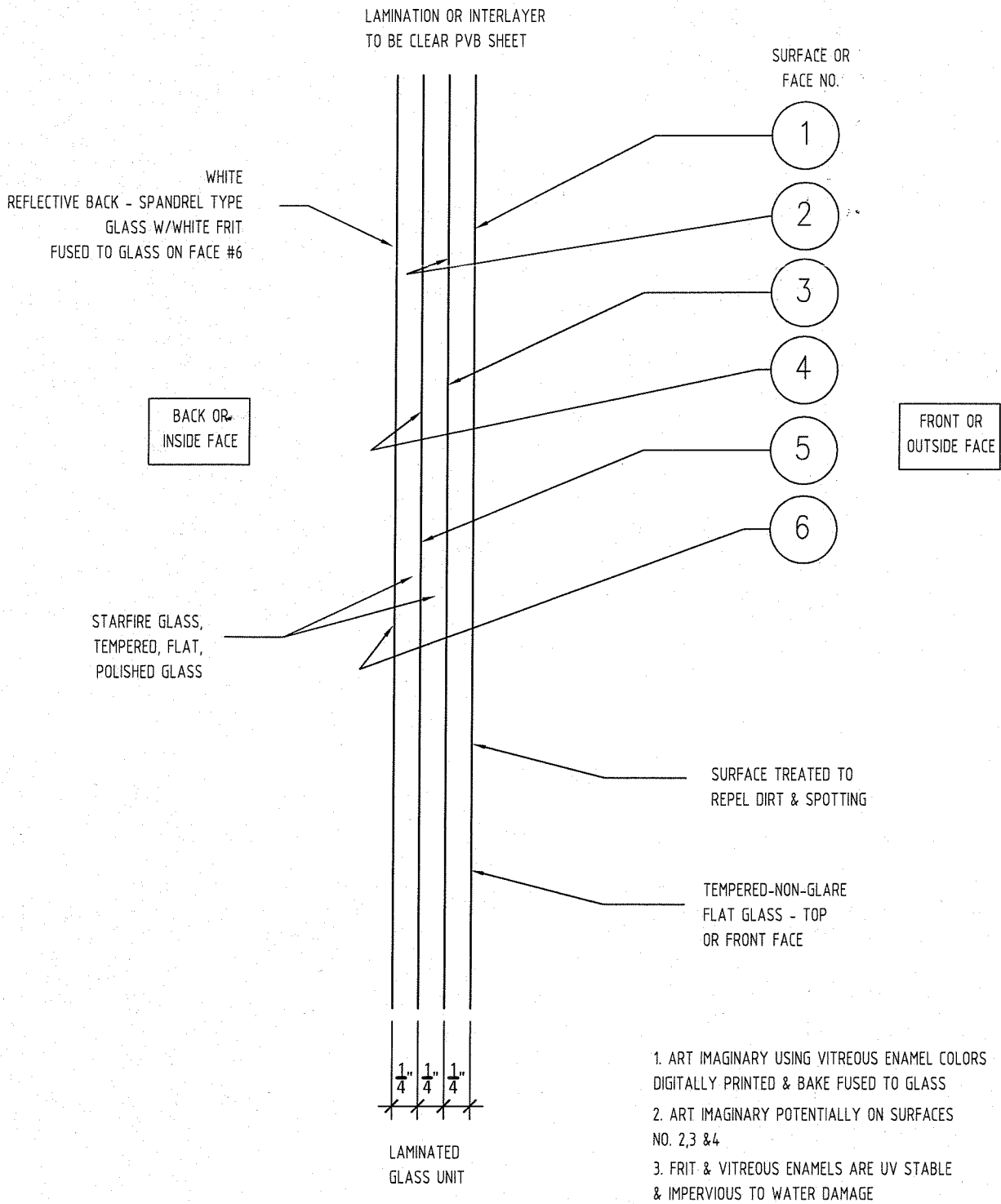

1 DETAIL OF TYPICAL GLASS ASSEMBLY FOR ART PROJECT

NOTE:  $\frac{3}{8}$ " GLASS WEIGHTS APPROX. 10 LBS/SF



# CENTRAL SUBWAY CHINATOWN STATION

SAN FRANCISCO, CA 94044  
OPTION 2 (MAX. WEIGHT)

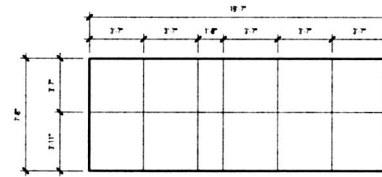

**ARTWORK ELEVATION- ANGLED**

1/4" - 1/8"

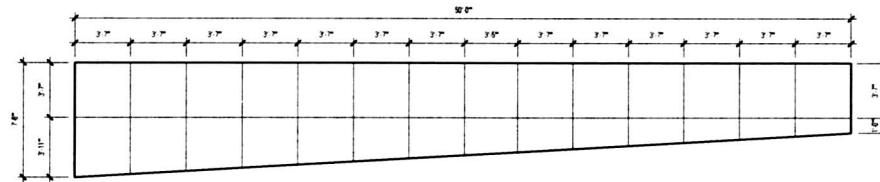

**ARTWORK ELEVATION- STOCKTON**

1/4" - 1/8"

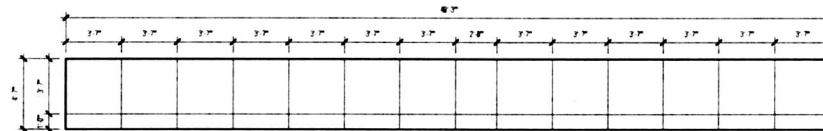

**ARTWORK ELEVATION- WASHINGTON**

1/4" - 1/8"

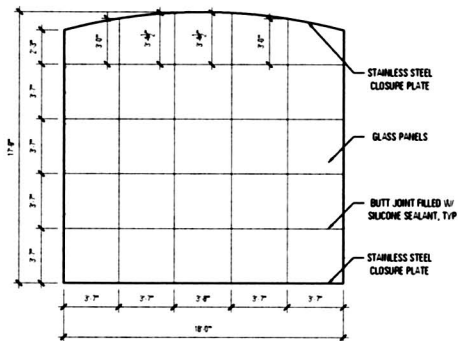

**ARTWORK ELEVATION- NORTH EOP**

1/4" - 1/8"