



Art Glass for Interior and Light Court Windows -
San Francisco General Hospital Acute Care Unit

REVIVAL
Nancy Blum Artist

Arnica and Angelica

2 Elevation
Corridor C504
San Francisco General Hospital and Trauma Center

Corridor C504 [Reference Sketch No. 373R3]

Nancy Blum, Artist

Art Glass Panel at End Opposite [Furthest Away from] the Access Door
One [1] Condition per Elevation: 4' - 2 1/4" Wide x 7' - 8 1/4" High

Art Glass Panels at Center of Opening, including Panel Directly adjacent to the Access Door
Four [4] Conditions per Elevation: 4' - 0 7/8" Wide x 7' - 8 1/4" High

At Access Door Opening: No art glass panel

The assumed dimensions for glass bite and butt-joint width have been taken directly from the Glass Association of North America's [GANA] glazing guidelines for an assumed art glass thickness of 1/2-inch. Dimensions for glass bite, butt joint width and thickness will need to be confirmed by a Structural Glazing Engineer hired by the Art Commission.

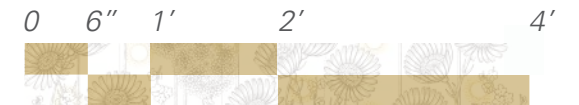
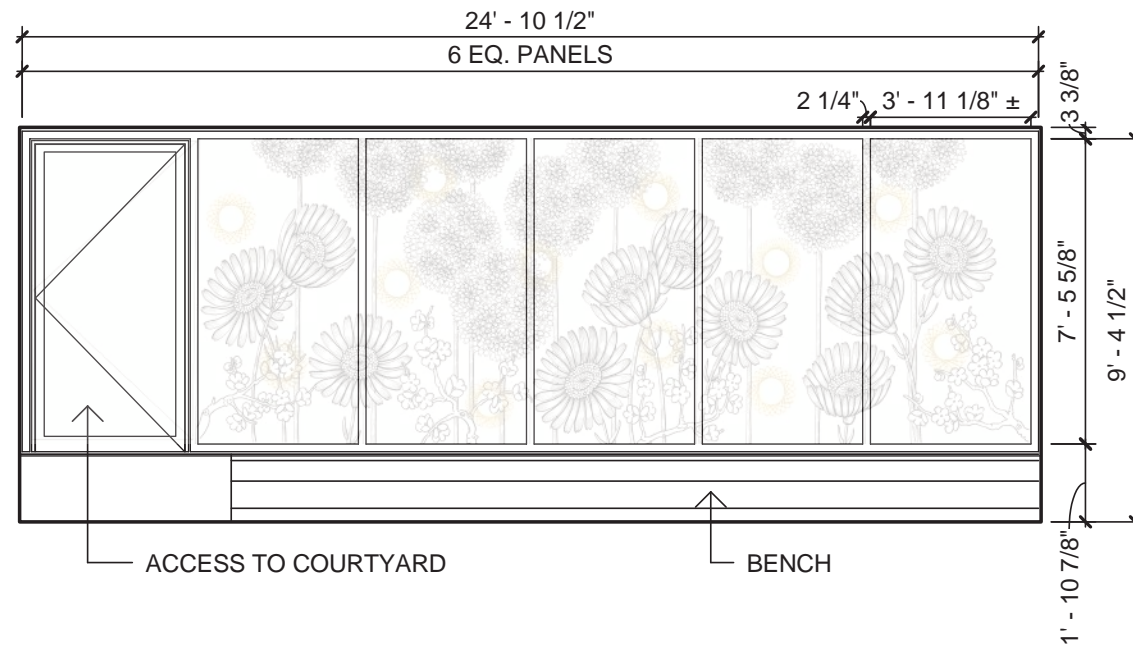

The overall dimensions of art glass panels at the interior courtyards, which incorporate an assumed glass bite dimension of 7/16-inch at both the head and the sill, and accommodate an assumed [sealant] butt-joint width of 1/2-inch between adjacent glass panels and between glass panels and building construction at the ends.

Foxglove and Aconite

4 Elevation
Corridor C504
San Francisco General Hospital and Trauma Center

Corridor C504 [Reference Sketch No. 373R3]

Nancy Blum, Artist

Art Glass Panel at End Opposite [Furthest Away from] the Access Door
One [1] Condition per Elevation: 4' - 2 1/4" Wide x 7' - 8 1/4" High

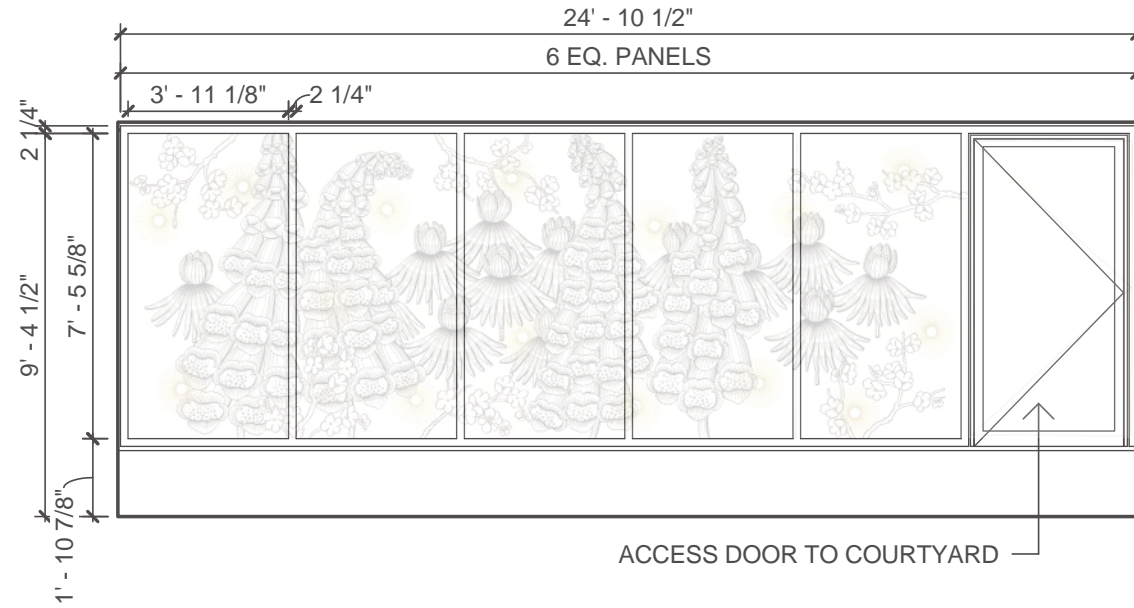

Art Glass Panels at Center of Opening, including Panel Directly adjacent to the Access Door
Four [4] Conditions per Elevation: 4' - 0 7/8" Wide x 7' - 8 1/4" High

At Access Door Opening: No art glass panel

The assumed dimensions for glass bite and butt-joint width have been taken directly from the Glass Association of North America's [GANA] glazing guidelines for an assumed art glass thickness of 1/2-inch. Dimensions for glass bite, butt joint width and thickness will need to be confirmed by a Structural Glazing Engineer hired by the Art Commission.



The overall dimensions of art glass panels at the interior courtyards, which incorporate an assumed glass bite dimension of 7/16-inch at both the head and the sill, and accommodate an assumed [sealant] butt-joint width of 1/2-inch between adjacent glass panels and between glass panels and building construction at the ends.

Passion Flower and Yarrow

2 Elevation
Corridor C401
San Francisco General Hospital and Trauma Center

Corridor C401 [Reference Sketch No. 373R1]

Nancy Blum, Artist

Art Glass Panels at Ends of Opening

Two [2] Conditions per Elevation: 4' - 2 1/4" Wide x 7' - 8 1/4" High

Art Glass Panels at Center of Opening

Four [4] Conditions per Elevation: 4' - 0 7/8" Wide x 7' - 8 1/4" High

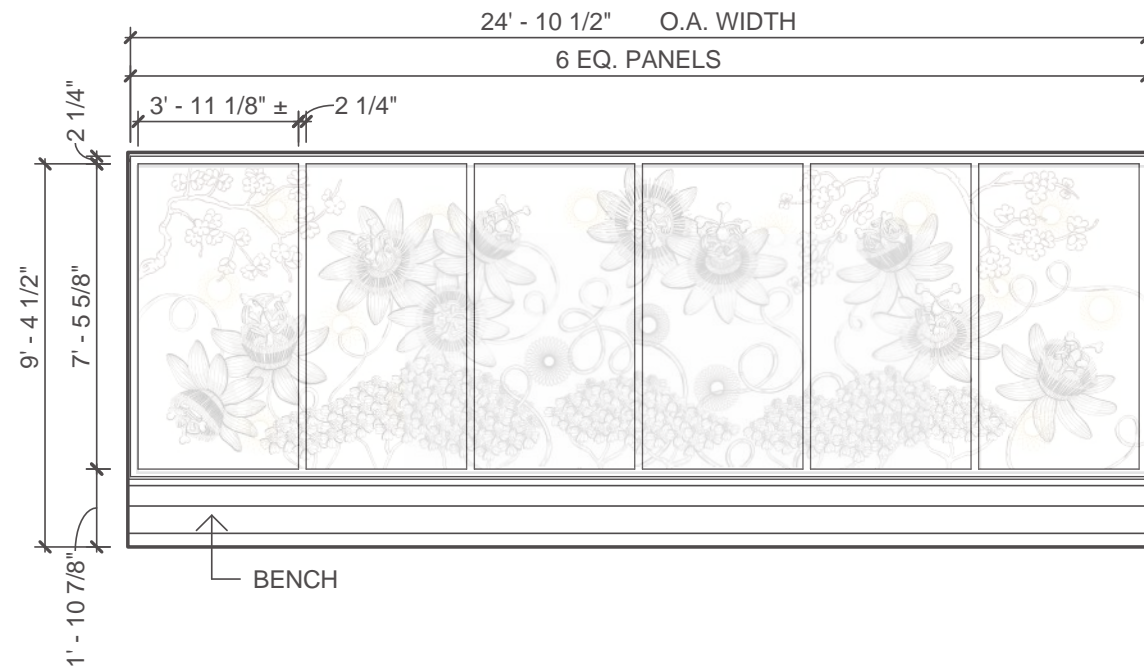

The assumed dimensions for glass bite and butt-joint width have been taken directly from the Glass Association of North America's [GANA] glazing guidelines for an assumed art glass thickness of 1/2-inch. Dimensions for glass bite, butt joint width and thickness will need to be confirmed by a Structural Glazing Engineer hired by the Art Commission.

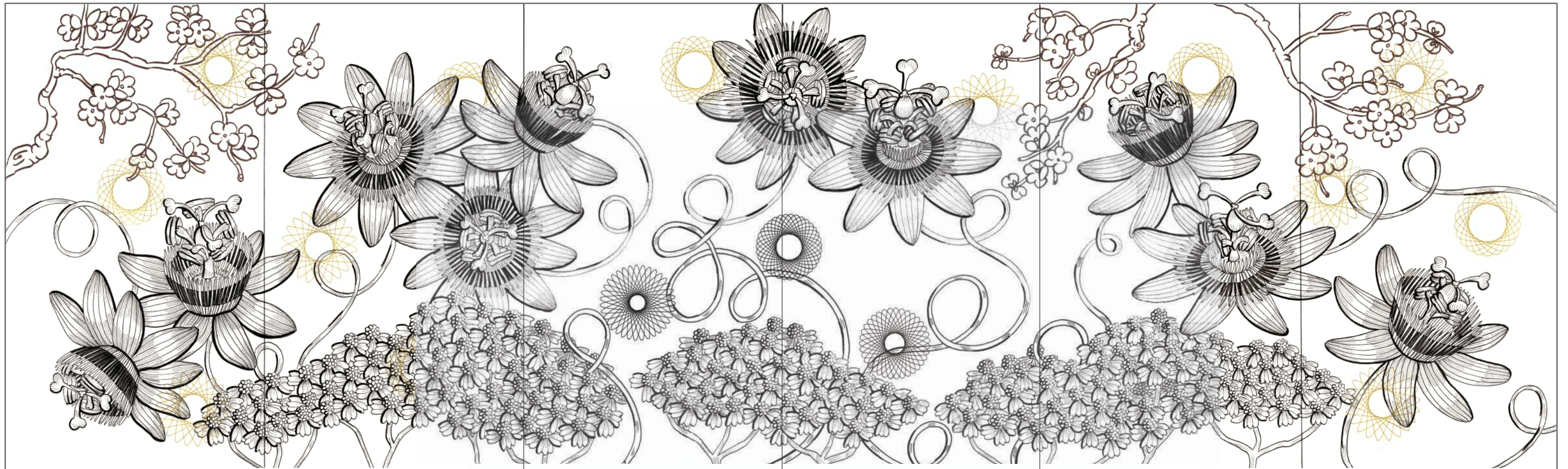
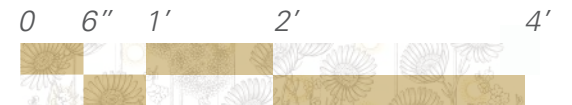

The overall dimensions of art glass panels at the interior courtyards, which incorporate an assumed glass bite dimension of 7/16-inch at both the head and the sill, and accommodate an assumed [sealant] butt-joint width of 1/2-inch between adjacent glass panels and between glass panels and building construction at the ends.

Monkshood and Echinacea

4 Elevation
Corridor C401
San Francisco General Hospital and Trauma Center

Corridor C401 [Reference Sketch No. 373R1]

Nancy Blum, Artist

Art Glass Panels at Ends of Opening

Two [2] Conditions per Elevation: 4' - 2 1/4" Wide x 7' - 8 1/4" High

Art Glass Panels at Center of Opening

Four [4] Conditions per Elevation: 4' - 0 7/8" Wide x 7' - 8 1/4" High

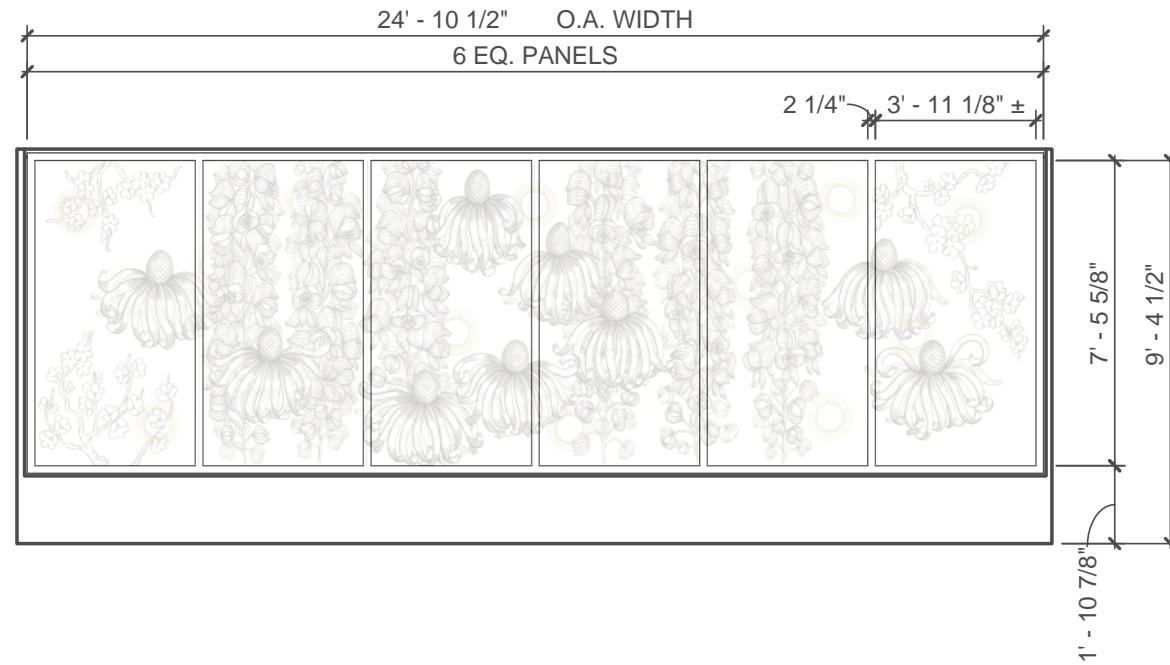

The assumed dimensions for glass bite and butt-joint width have been taken directly from the Glass Association of North America's [GANA] glazing guidelines for an assumed art glass thickness of 1/2-inch. Dimensions for glass bite, butt joint width and thickness will need to be confirmed by a Structural Glazing Engineer hired by the Art Commission.

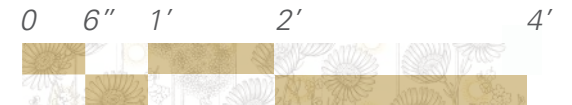

The overall dimensions of art glass panels at the interior courtyards, which incorporate an assumed glass bite dimension of 7/16-inch at both the head and the sill, and accommodate an assumed [sealant] butt-joint width of 1/2-inch between adjacent glass panels and between glass panels and building construction at the ends.

Passion Flower and Foxglove

2 Elevation UNFOLDED
 Waiting - Curved Glass
 San Francisco General Hospital and Trauma Center

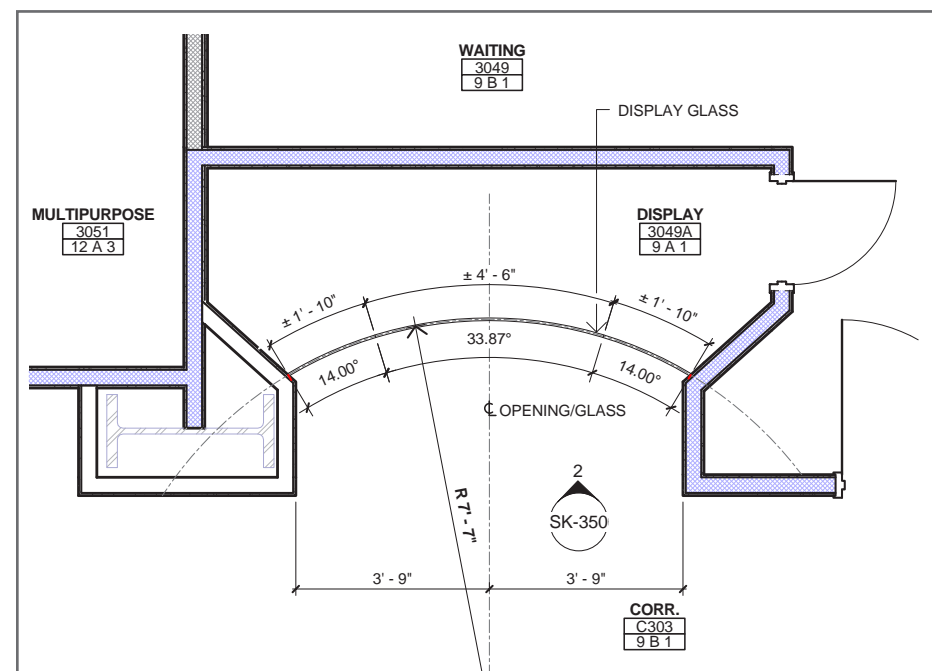
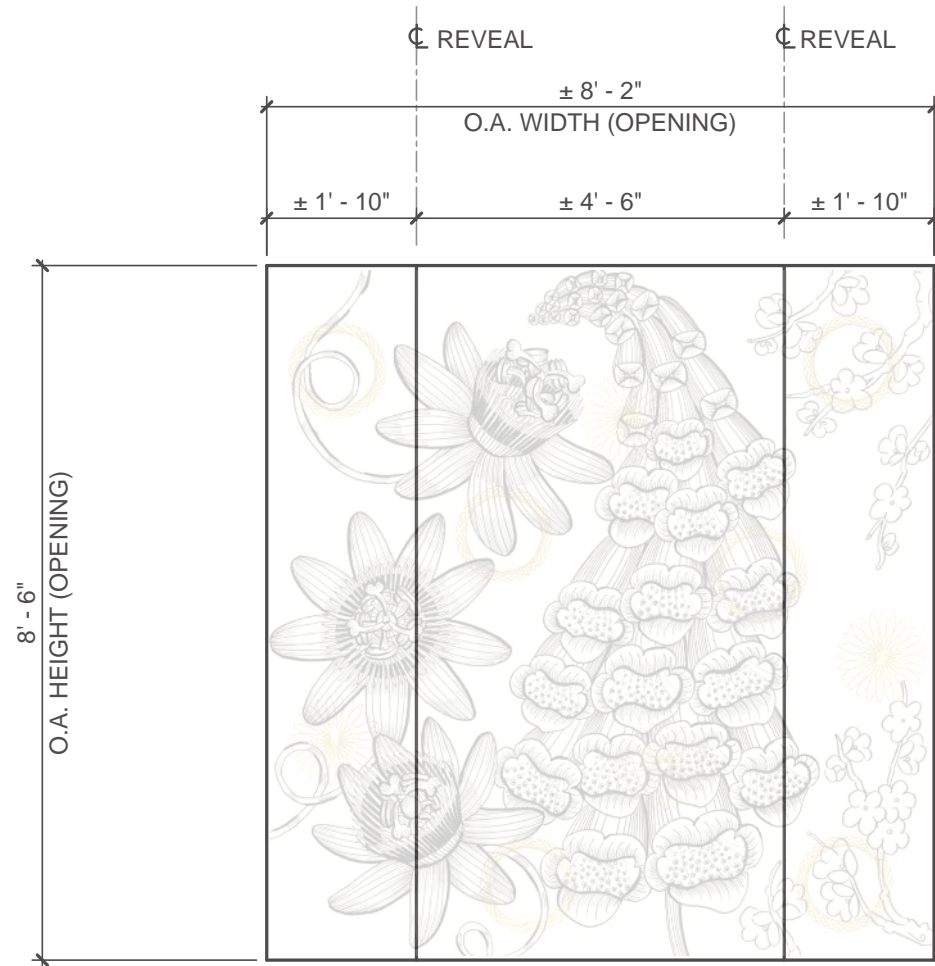

1 Floor Plan
 Waiting - Curved Glass
 San Francisco General Hospital and Trauma Center



Waiting - Curved Glass [Reference Sketch No. 350]

Nancy Blum, Artist

The widths of curved art glass panels are proposed widths only, and may be modified depending on the requirements of the Artist. Widths are also provided as plus or minus dimensions since the glass is on a curve and since slight variations in dimension will be inevitable due to the fabrications process.

Typical Panel Height: 8' - 2 7/8" High

Proposed [Unfolded] Width of Central Panel: ±4' - 5 1/2" Wide

Proposed [Unfolded] Width of Side Panels: ±1' - 9 1/4" Wide

Overall [Unfolded] Width of Opening: ±8' - 2" Wide

The assumed dimensions for glass bite and butt-joint width have been taken directly from the Glass Association of North America's [GANA] glazing guidelines for an assumed art glass thickness of 1/2-inch. Dimensions for glass bite, butt joint width and thickness will need to be confirmed by a Structural Glazing Engineer hired by the Art Commission.



The overall dimensions of art glass panels at the interior courtyards, which incorporate an assumed glass bite dimension of 7/16-inch at both the head and the sill, and accommodate an assumed [sealant] butt-joint width of 1/2-inch between adjacent glass panels and between glass panels and building construction at the ends.

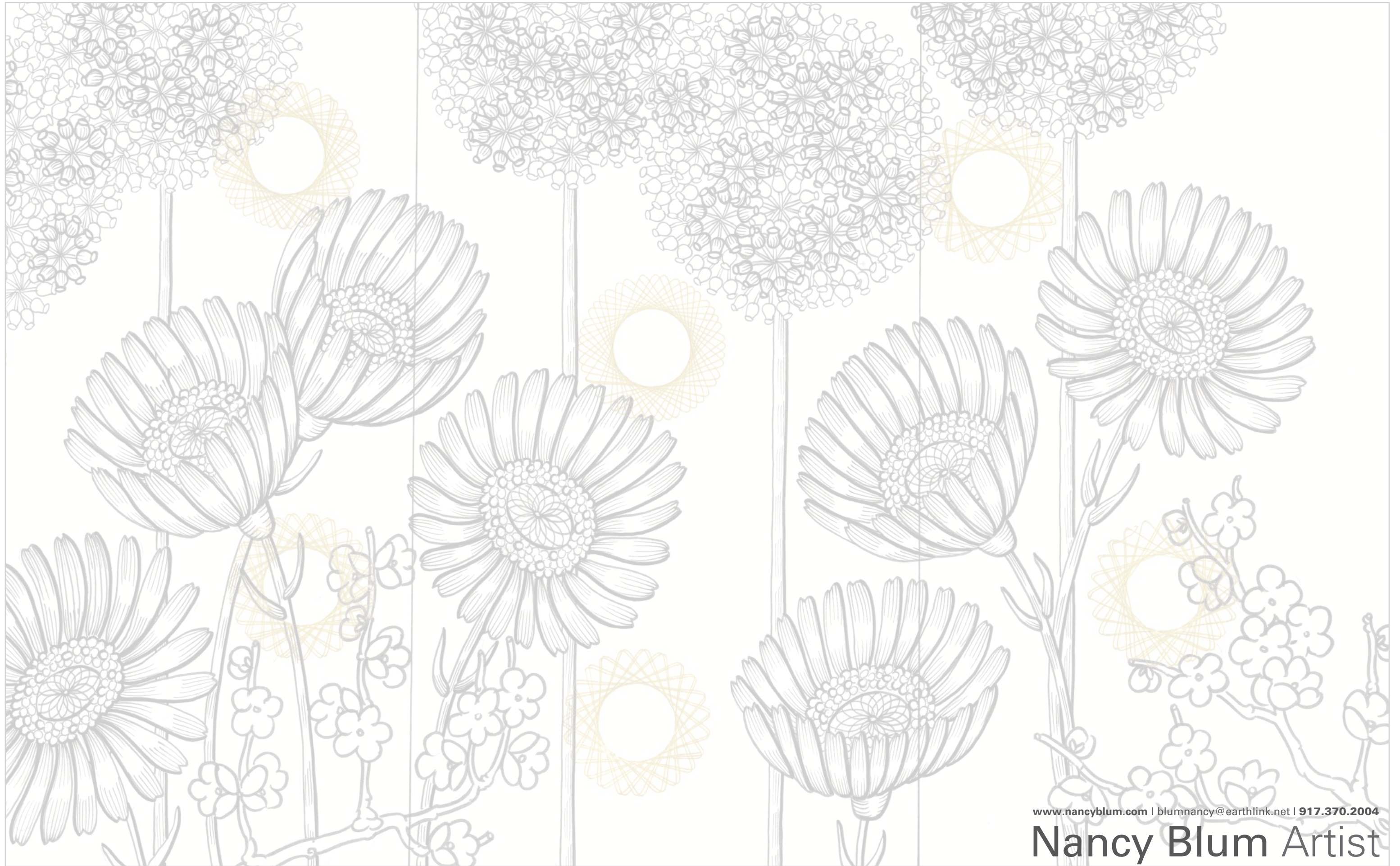

www.nancyblum.com | blumnancy@earthlink.net | 917.370.2004

Nancy Blum Artist

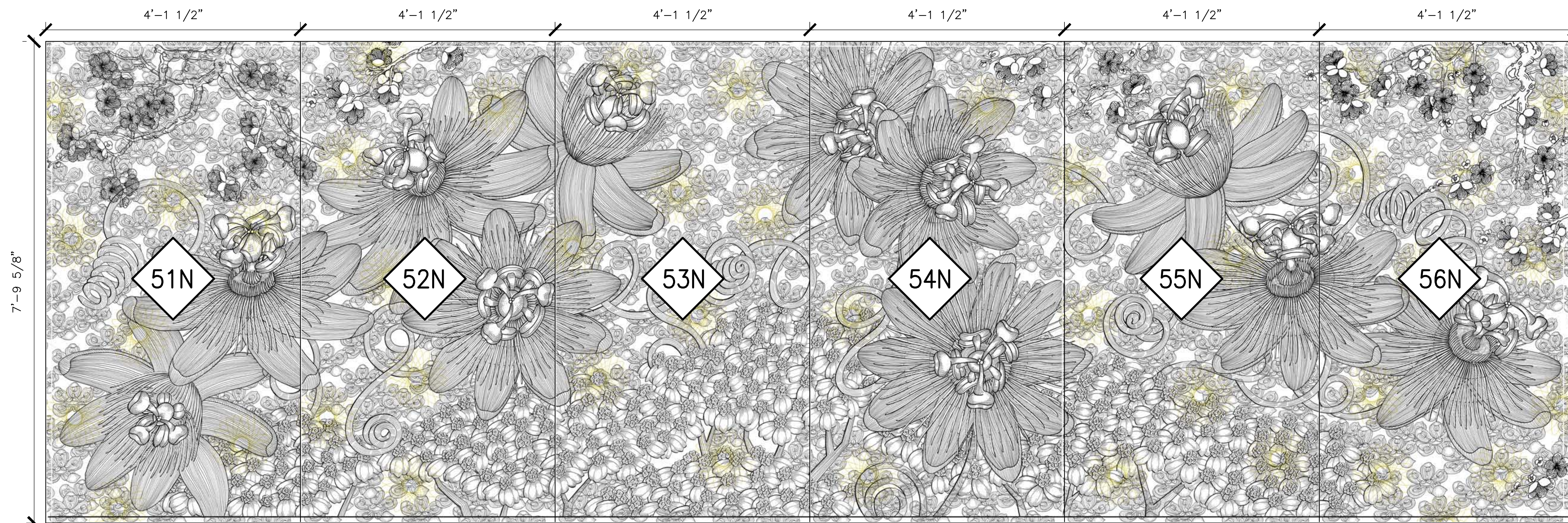

1 NORTH ELEVATION OF ART GLASS PANELS AT CORRIDOR C-501
SCALE: 1" = 1'-0"

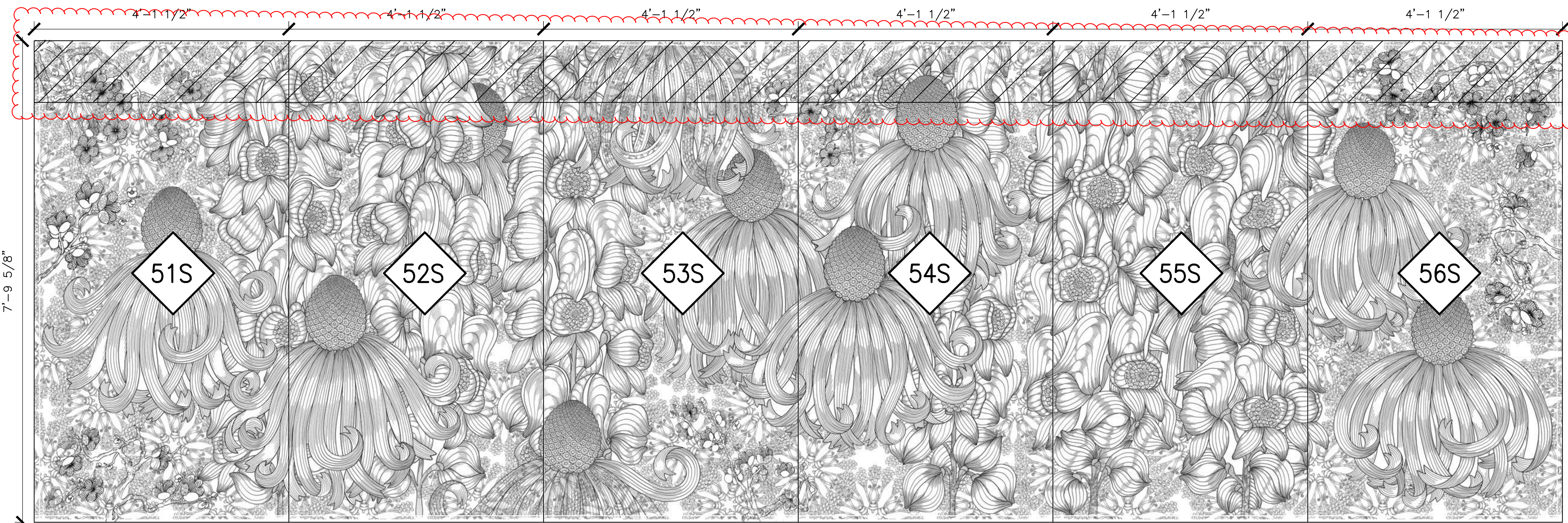

2 SOUTH ELEVATION OF ART GLASS PANELS AT CORRIDOR C-501
SCALE: 1" = 1'-0"

NOTE: ARTWORK SHOWN IN FINAL DESIGN PHASE. HATCHED AREA DENOTES VISUALLY IMPACTED BY SOFFIT ON SOUTH SIDE OF CORRIDOR.

LENEHAN
ARCHITECTURAL GLASS, INC.

2534 MAGNOLIA STREET
OAKLAND, CA 94607
TEL. 510.465.6095
INFO@LENEHAN.COM
WWW.LENEHAN.COM

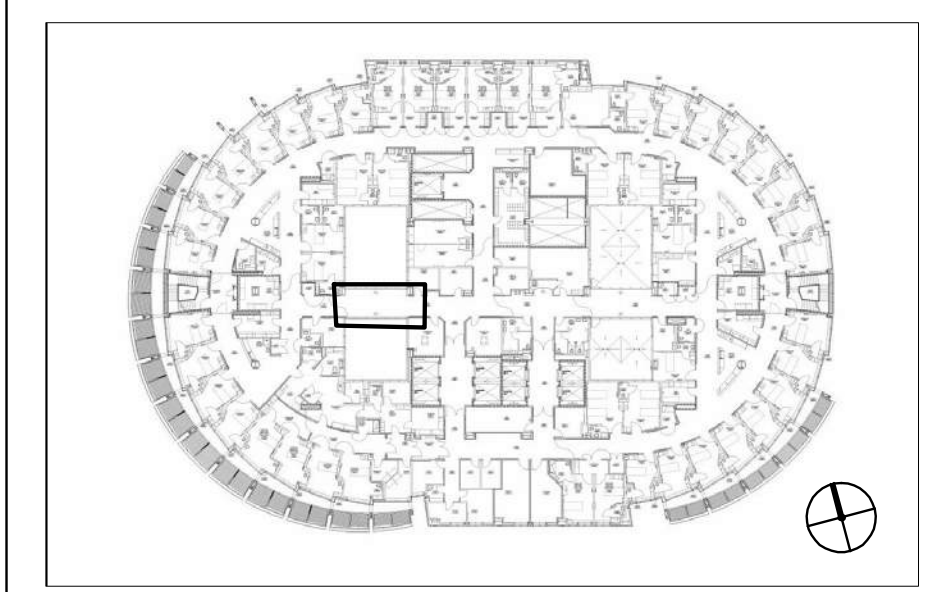

5TH FLOOR - KEY AREA PLAN
SAN FRANCISCO GENERAL HOSPITAL
1001 POTRERO AVENUE
SAN FRANCISCO, CA 94110

SAN FRANCISCO



ARTS COMMISSION
NANCY BLUM, ARTIST
JANUARY 30, 2014
REV. 4

A-1

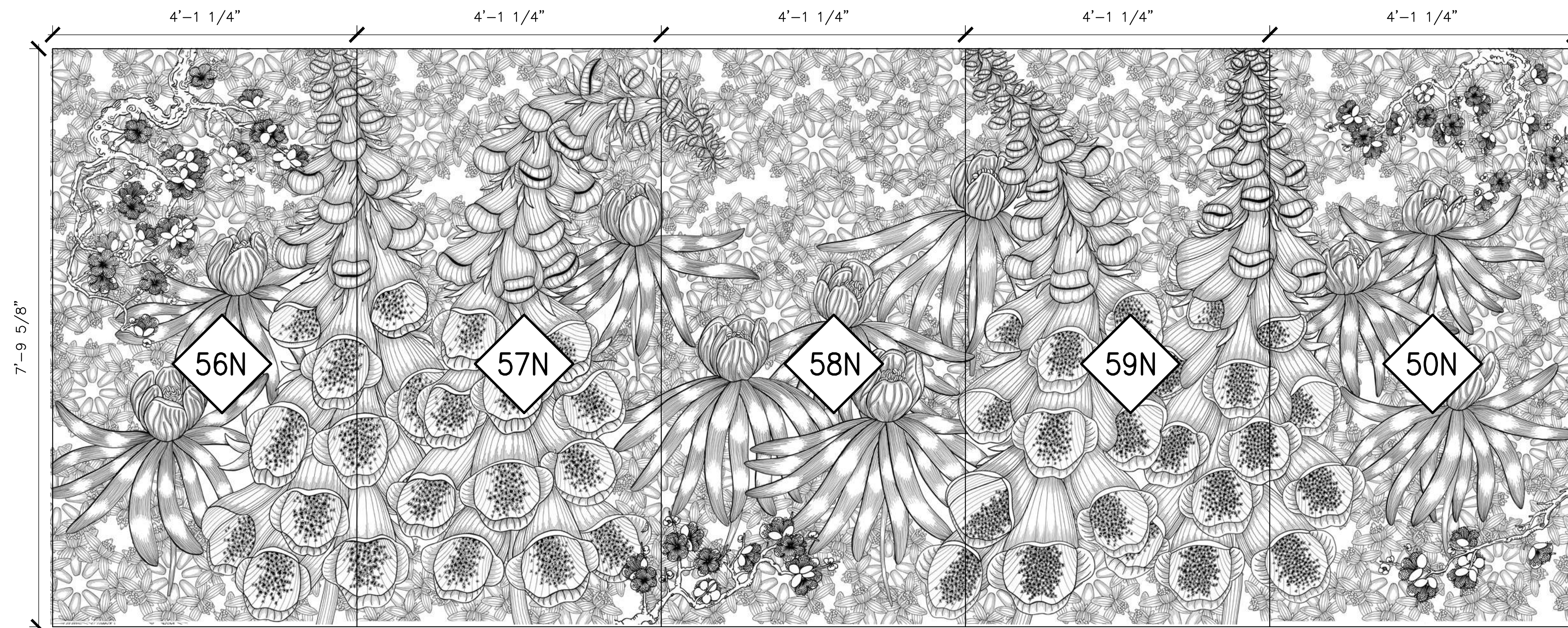

1 NORTH ELEVATION OF ART GLASS PANELS AT CORRIDOR C-504
SCALE: 1" = 1'-0"

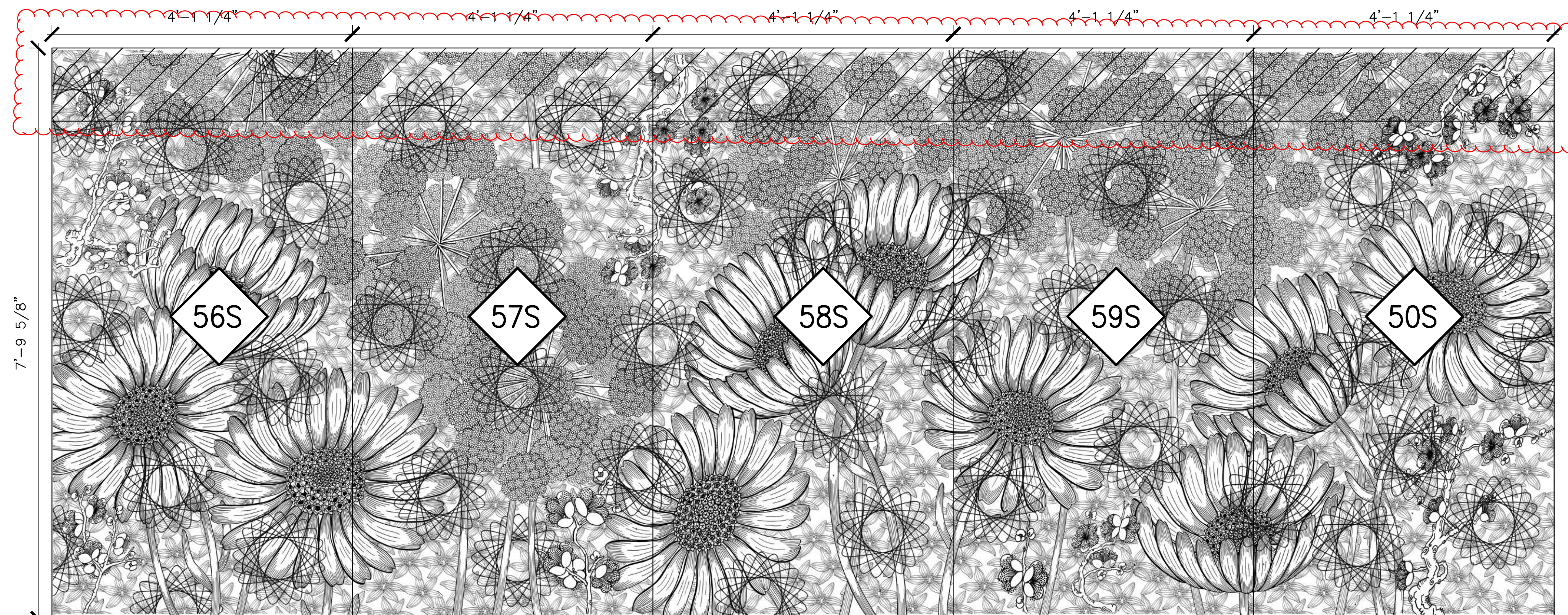

2 SOUTH ELEVATION OF ART GLASS PANELS AT CORRIDOR C-504
SCALE: 1" = 1'-0"

NOTE: ARTWORK SHOWN IN FINAL DESIGN PHASE. HATCHED AREA DENOTES VISUALLY IMPACTED BY SOFFIT ON SOUTH SIDE OF CORRIDOR.

LENEHAN
ARCHITECTURAL GLASS, INC.

2534 MAGNOLIA STREET
OAKLAND, CA 94607
TEL. 510.465.6095
INFO@LENEHAN.COM
WWW.LENEHAN.COM

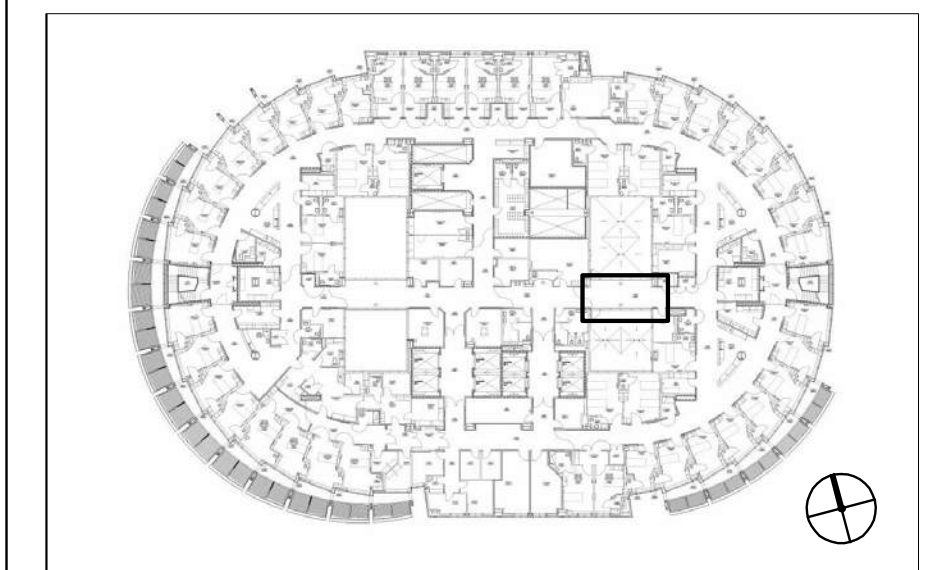

5TH FLOOR - KEY AREA PLAN
SAN FRANCISCO GENERAL HOSPITAL
1001 POTRERO AVENUE
SAN FRANCISCO, CA 94110

SAN FRANCISCO



ARTS COMMISSION

NANCY BLUM, ARTIST
JANUARY 30, 2014
REV. #4

A-2







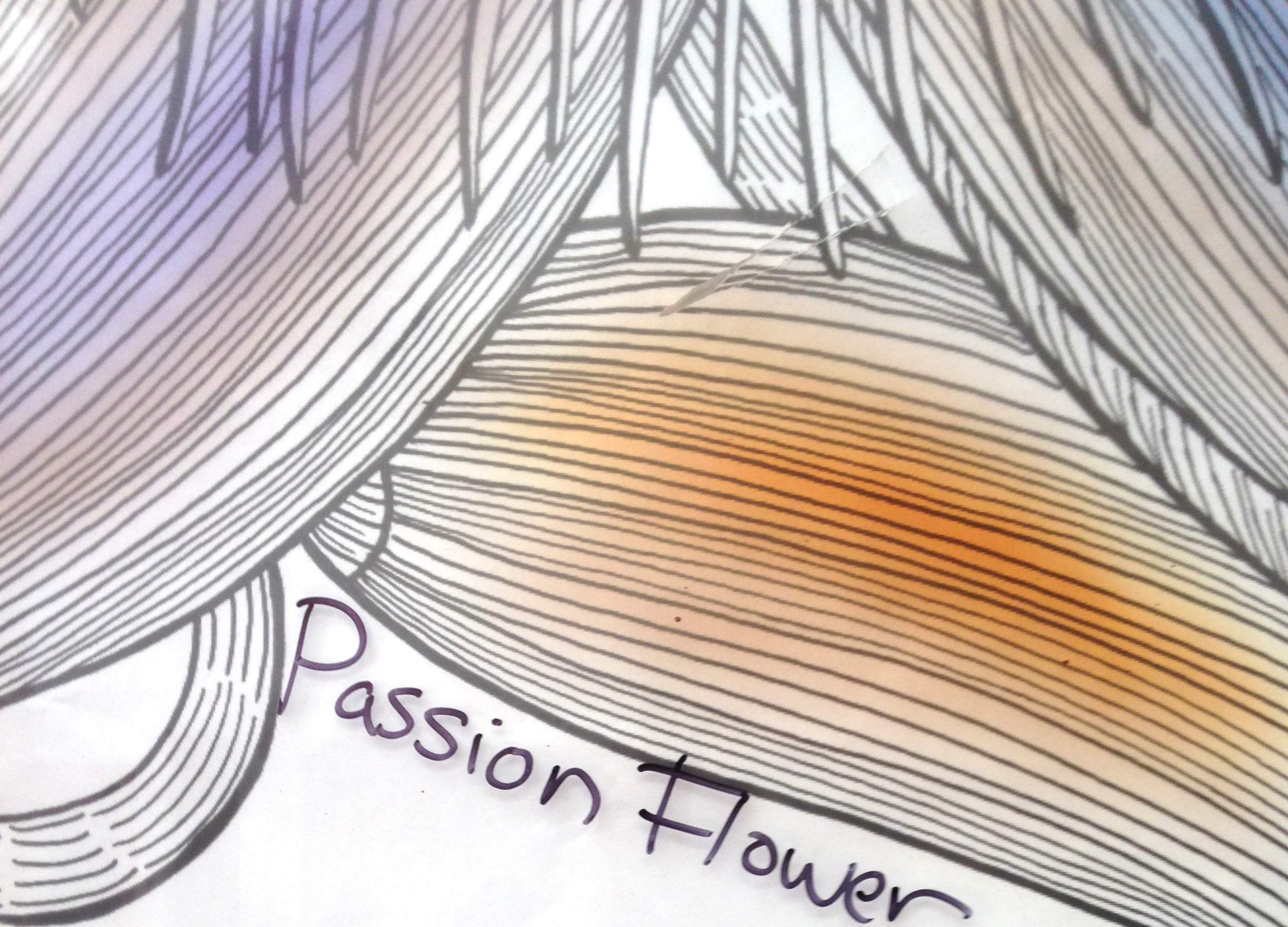

Passion Flower

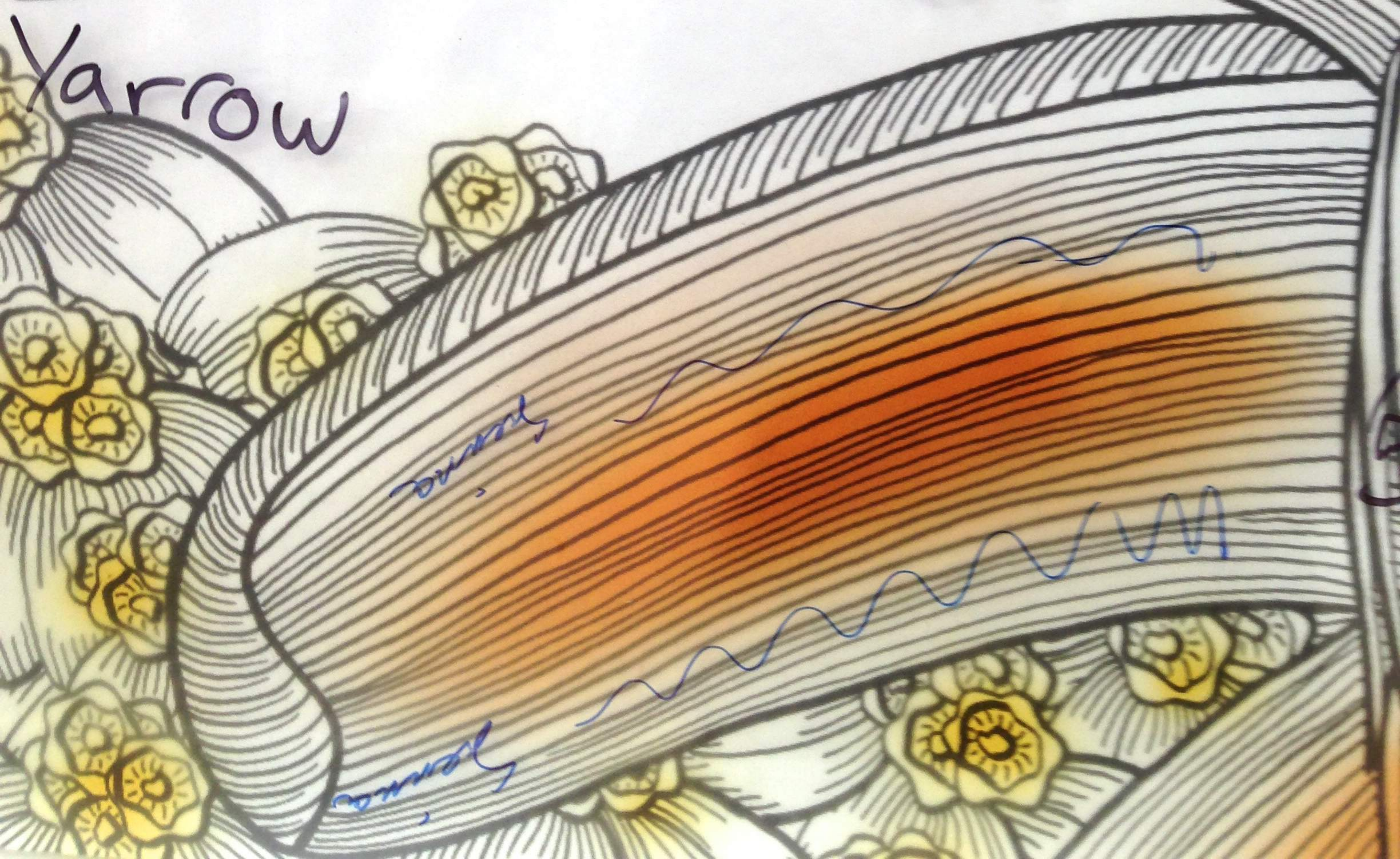

Yarrow



slight more pink

slight more pink
along edge



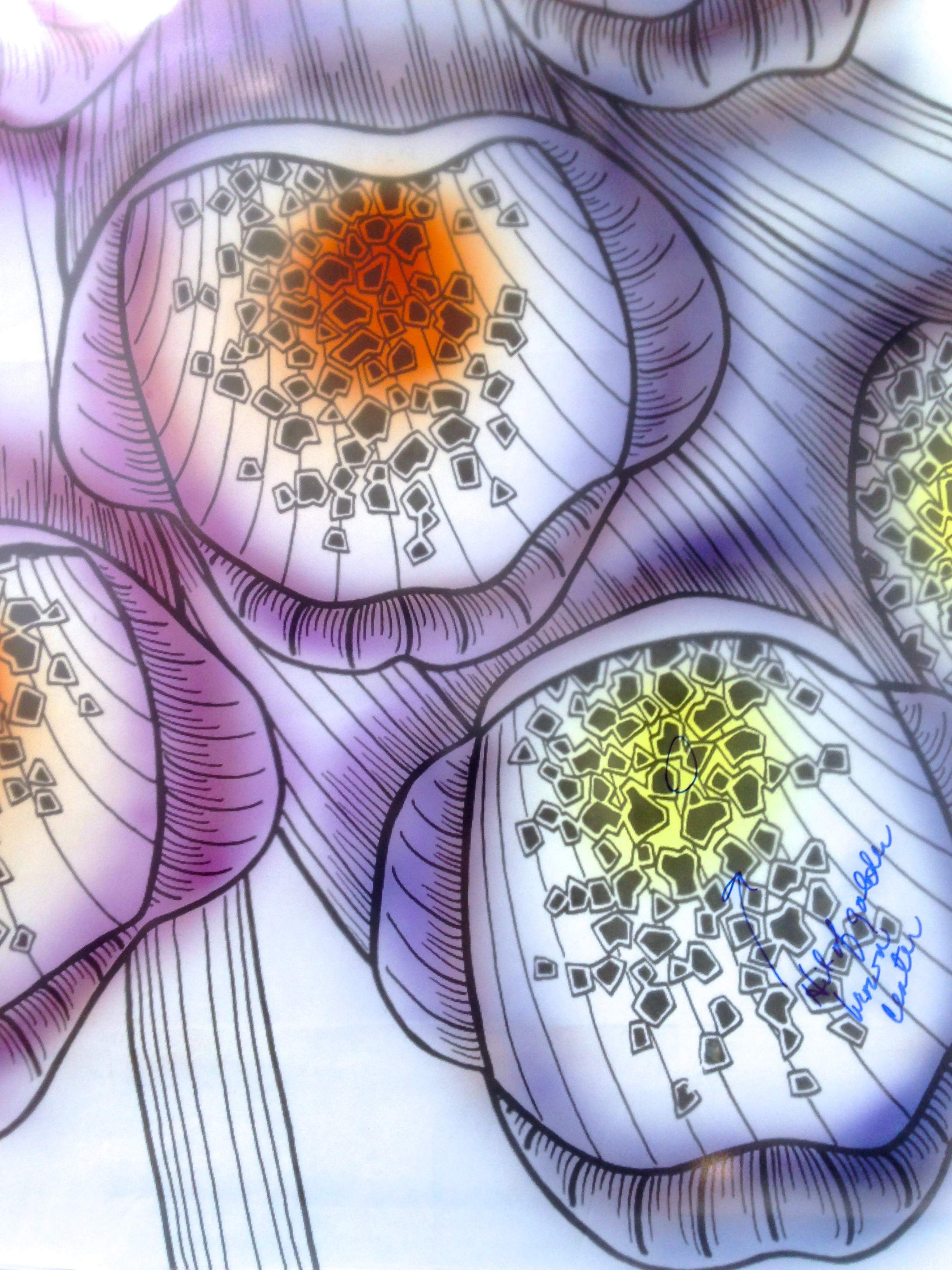

W. J. Gable
University of California
Center



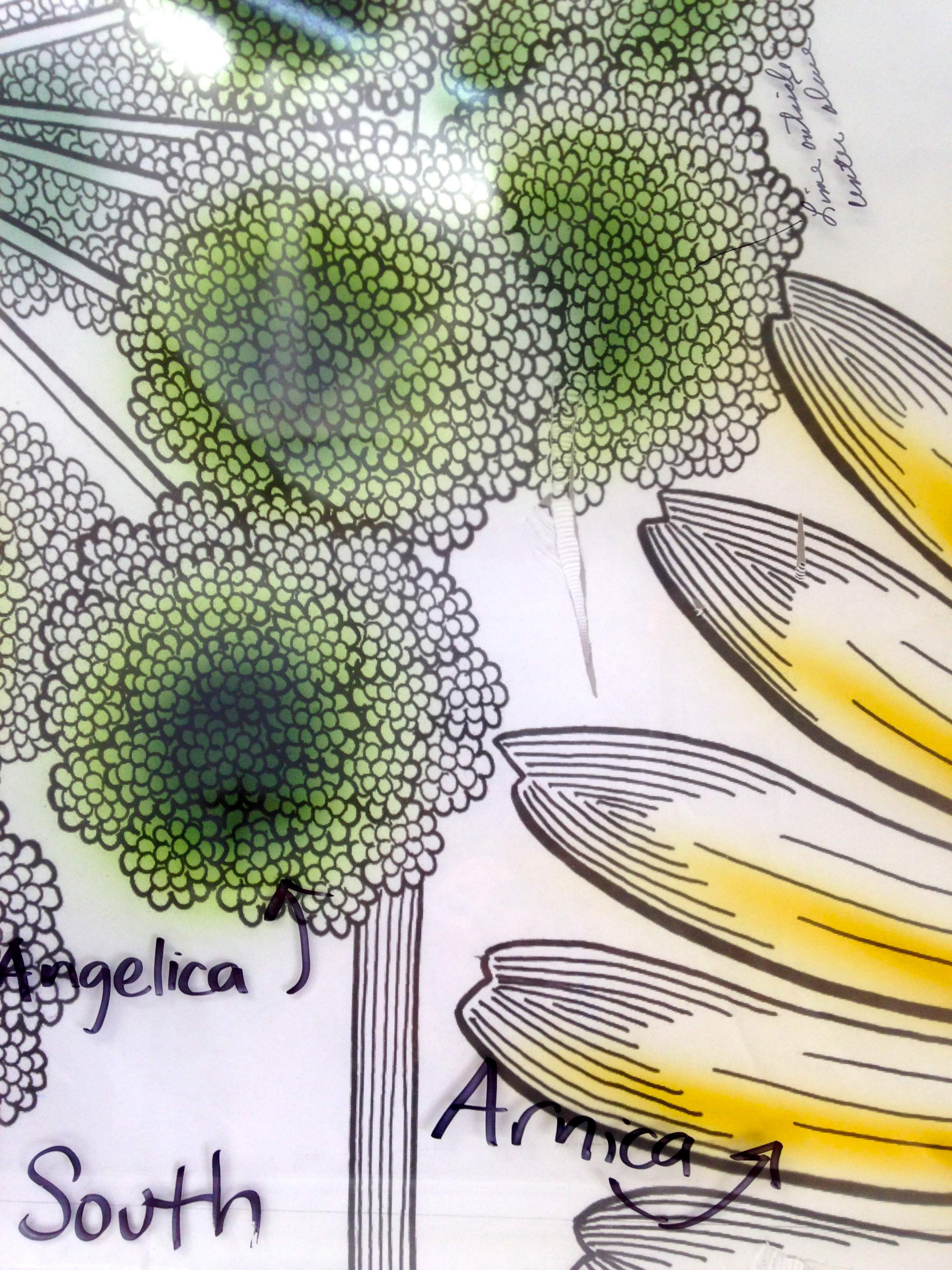

lime outside
water inside

Angelica

South

Arnicica



Some outside
water plane

Gland

Arnica ↗

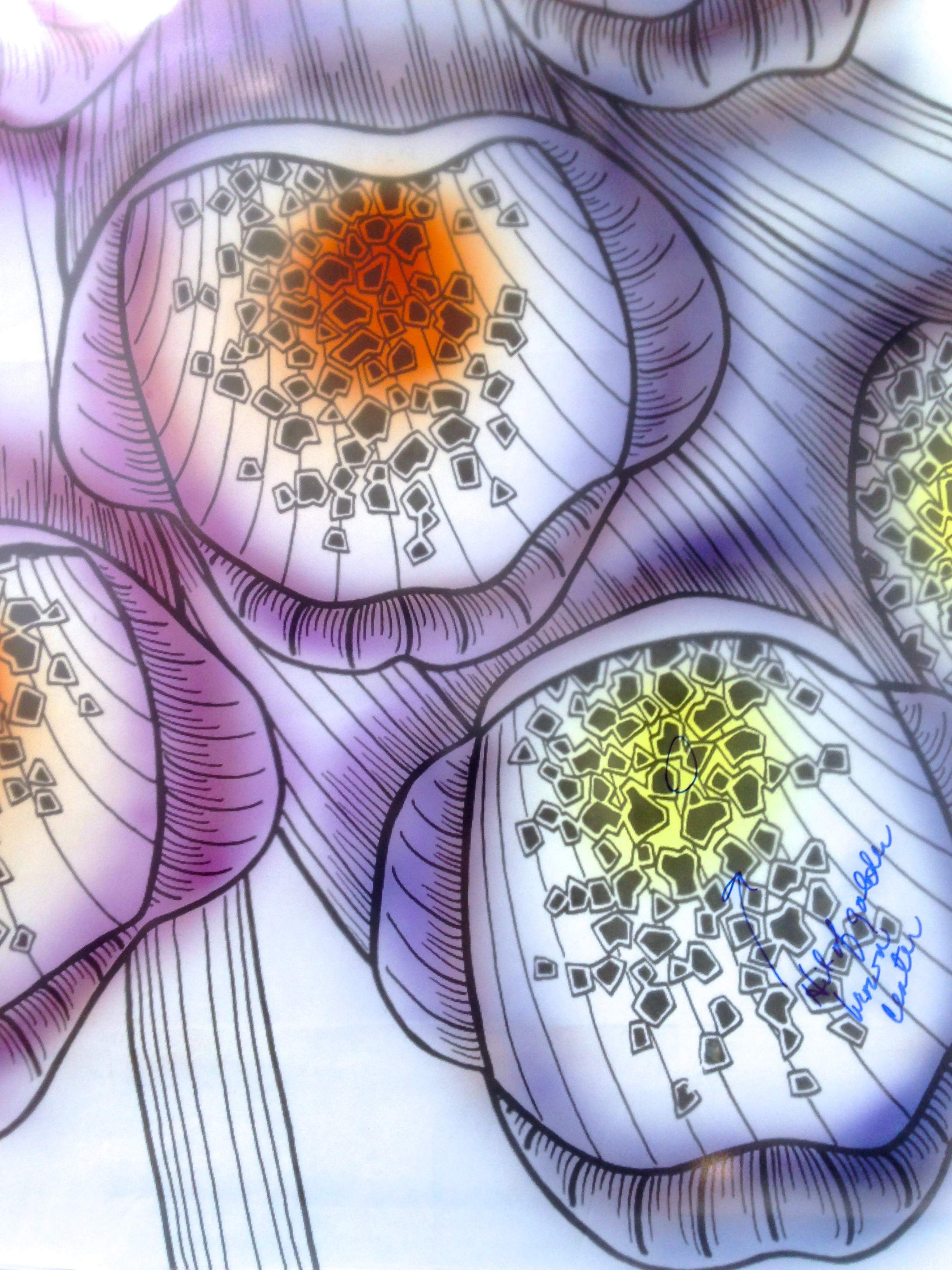

W. J. Gable
University of Gable
Center

Passion Flower

Yarrow

