

N-Judah Gateway Plaza Public Art Project Outline



BACKGROUND

The N-Judah Gateway Plaza project is a community-driven initiative to improve public safety and the quality of public space at and around the N-Judah turnaround tracks where the end of Judah Street meets La Playa and Lower Great Highway. The project is intended to be implemented as a pilot to create a new opportunity for public space at an important location in the Sunset neighborhood. The temporary installation may also help guide a long-term redesign of the space as part of an upcoming SFMTA Muni Forward project for the N-Judah line.

ART OPPORTUNITIES

Artist-designed sculptural seating made from stone, concrete, ceramic tile or other materials suitable to the site's marine environment. Artwork will be located within the project site in order to maximize functionality and achieve the greatest visual impact.

PROJECT GOAL

The project will promote use and enjoyment of the Gateway Plaza by providing functional, comfortable artist-designed seating of the highest aesthetic quality made of durable materials suitable to the demanding environment of the project site.

PROJECT BUDGET

Admin Fee	\$50,000
Selection Costs	\$6,500
Artist Contract Amount	\$138,000
Installation Allocation	\$10,500
Signage and Documentation	\$2,500
Contingency	\$17,500
Conservation	\$25,000

ARTIST RECRUITMENT APPROACH AND ELIGIBILITY

Arts Commission staff will select a short list of artists from the 2017/2018 Prequalified Artist Pool.

ARTIST SELECTION PROCESS

The short list of qualified artists will be presented to the N-Judah Gateway Plaza Artist Selection Panel consisting of one representative from Planning, one Arts Commissioner, one community representative, and two arts professionals. The panel will identify three finalists who will be invited to develop conceptual site specific proposals after attending an orientation session with the project team and key stakeholders. These finalists will be paid an honorarium of \$1,000, inclusive of travel expenses, for development of a proposal.

The N-Judah Gateway Artist Selection Panel will reconvene to consider the finalists’ proposals in an interview format and will select one artist and an alternate for the project for recommendation to the Arts Commission.

COMMUNITY INVOLVEMENT

- SFAC staff will present an overview of the public art project in conjunction with the N-Judah Gateway Plaza presentation to the community.
- A community representative will serve on the N-Judah Gateway Plaza Project Selection Panel and will participate in the Artist Orientation
- The finalists proposals will be on display for public comment near the project site and on the SFAC website for two weeks prior to the final selection panel meeting
- All selection panels, Visual Arts Committee (VAC) and Commission meetings are open to the public.

TIMELINE (Subject to change)

Project Outline Approval at VAC	February 15, 2017
Community Meeting	TBD
First Project Artist Selection Panel	Early March, 2017
Artist Finalist Orientation	Late March, 2017
Proposal Development	April, 2017
Finalist Proposals Due	Early May, 2017
Public Display of Proposals	Mid May, 2017 (on display two weeks)
Final Project Artist Selection Panel	Late May/Early June, 2017
VAC Approval	June 21, 2017
Arts Commission Approval	July 10, 2017
Artist Under Contract	July, 2017

FURTHER INFORMATION

Contact Marcus Davies, Public Art Project Manager at (415)252-2232 or by email at marcus.davies@sfgov.org.

CONCEPTUAL SHORT-TERM DESIGN
(1/18/2017)

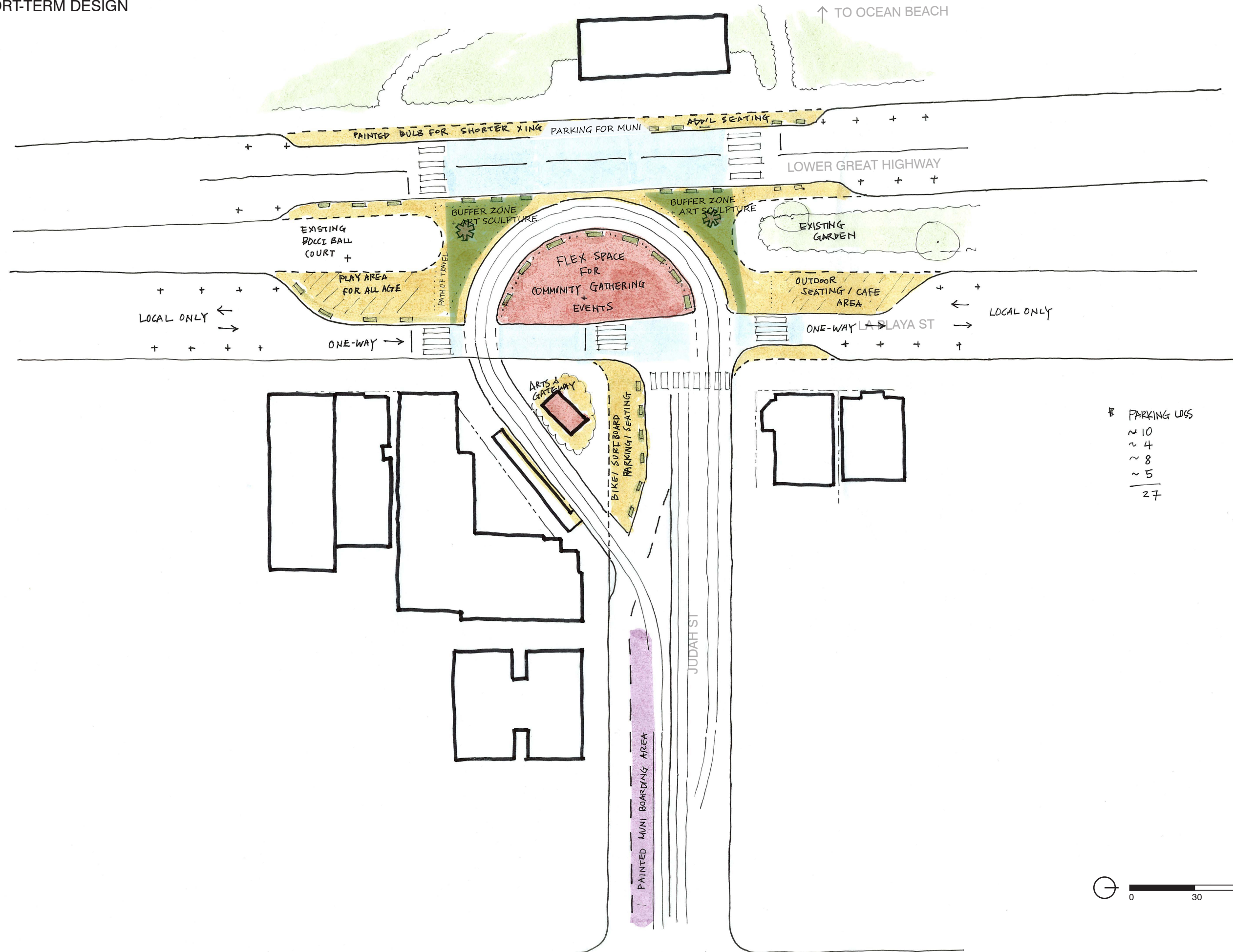

* PARKING LOS

~ 10
~ 4
~ 8
~ 5
<hr/>
27

