

OAK PLAZA ART CANOPIES

SAN FRANCISCO ARTS COMMISSION
VISUAL ARTS COMMITTEE

March 15, 2017



SITE CONTEXT

OAK
PLAZA

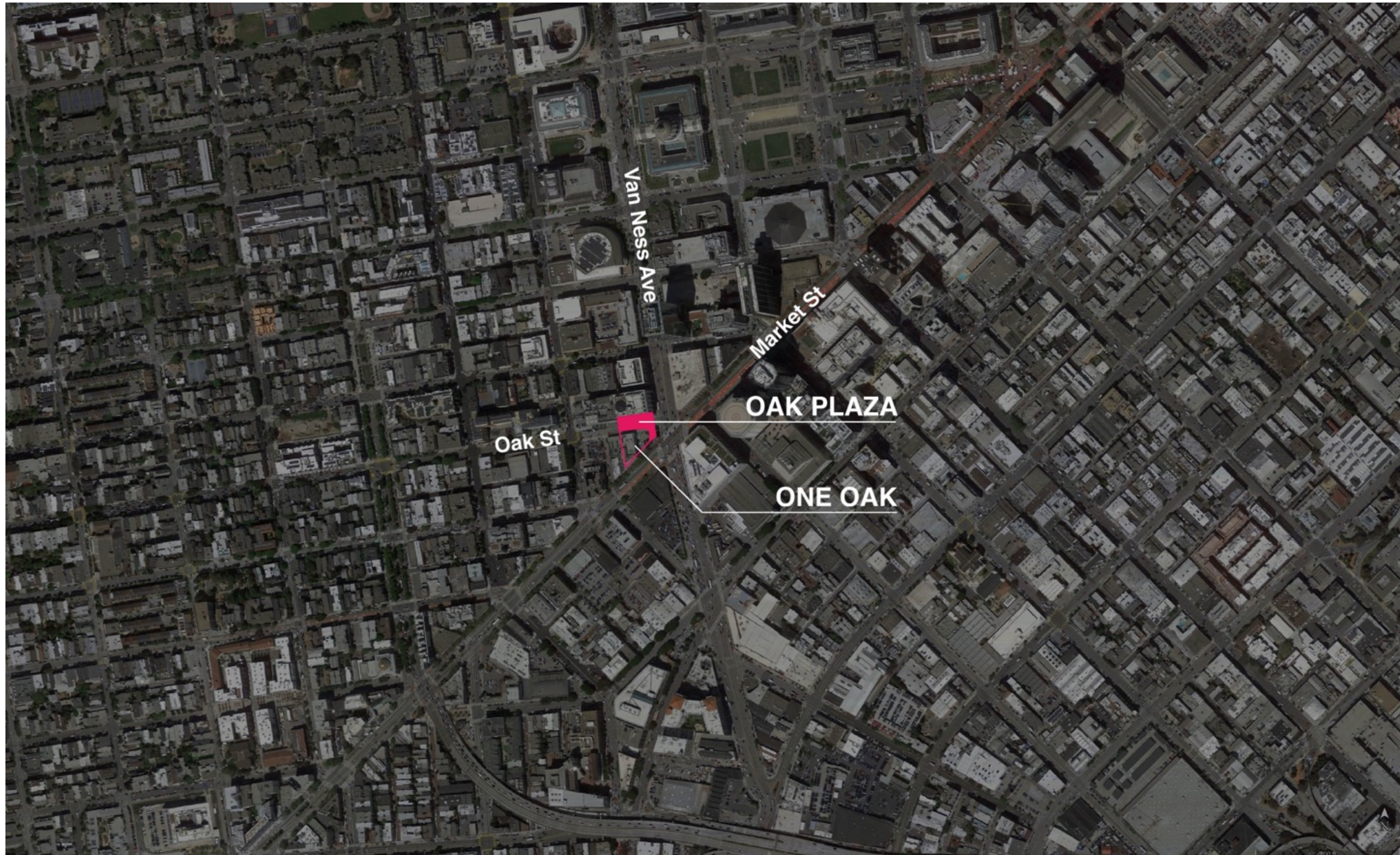



FLOWN

David Delgado / Dan Goods

*Conceptual Design
Presentation*

July 20th, 2016

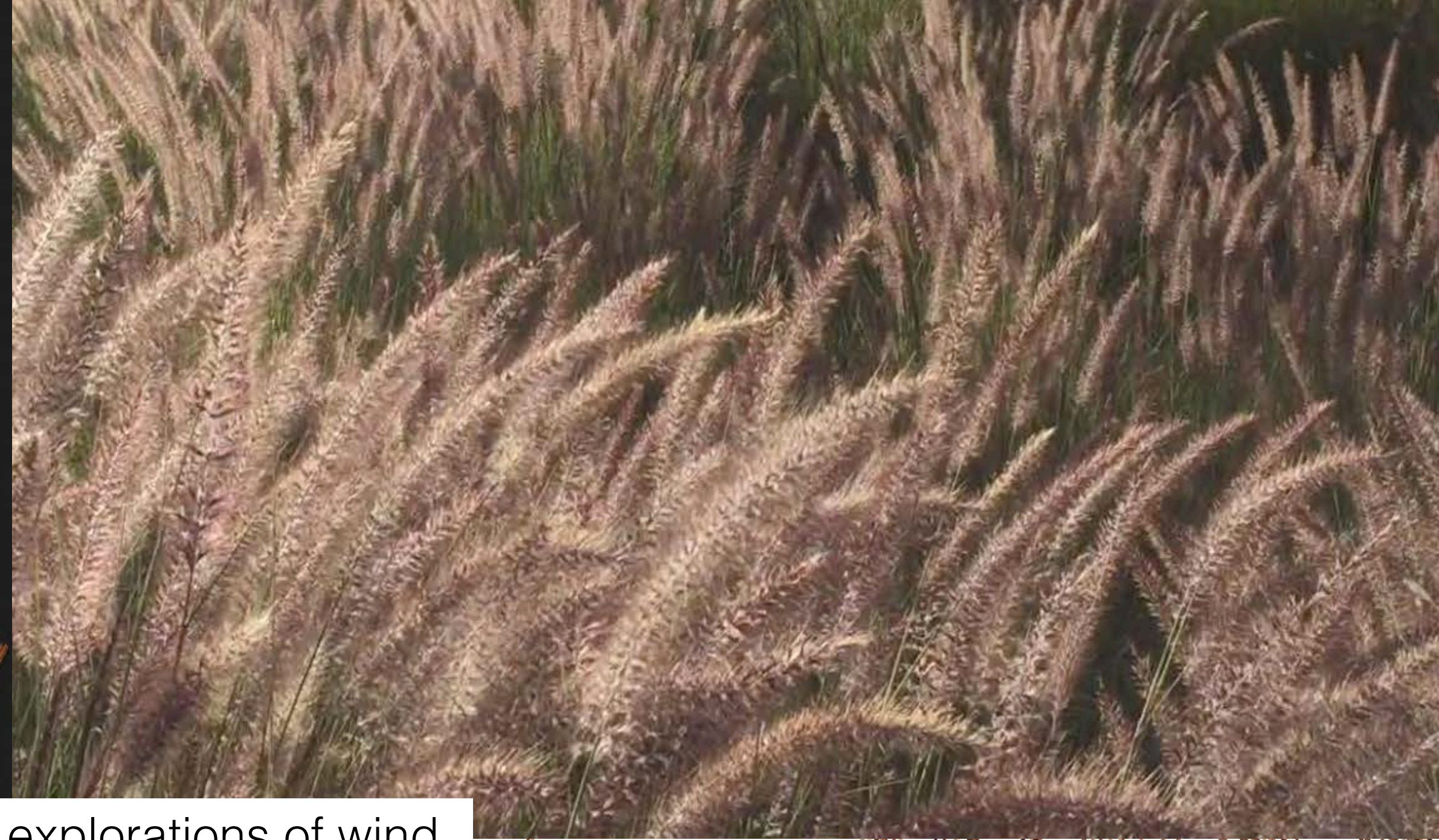

Initial inspiration and explorations of wind

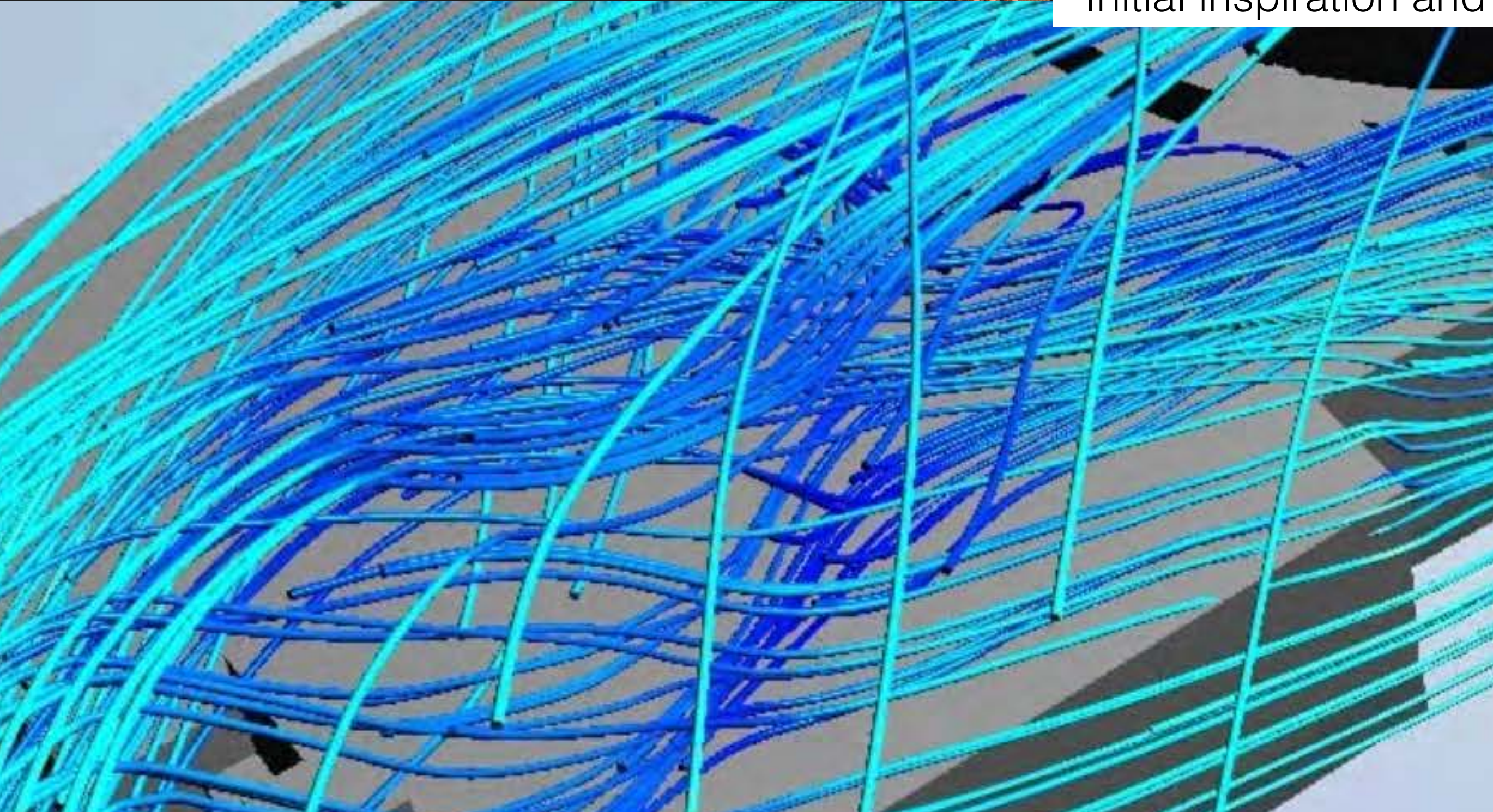

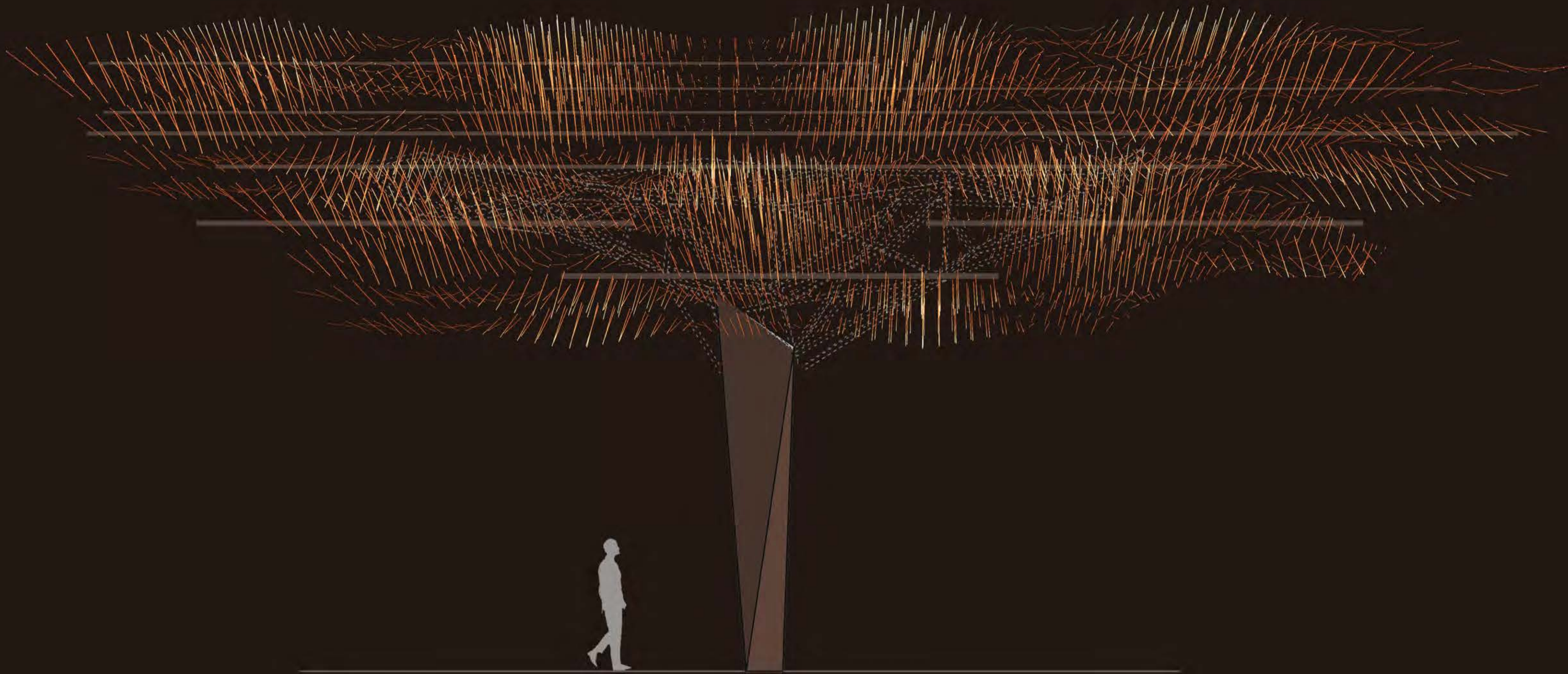

Recent Studies

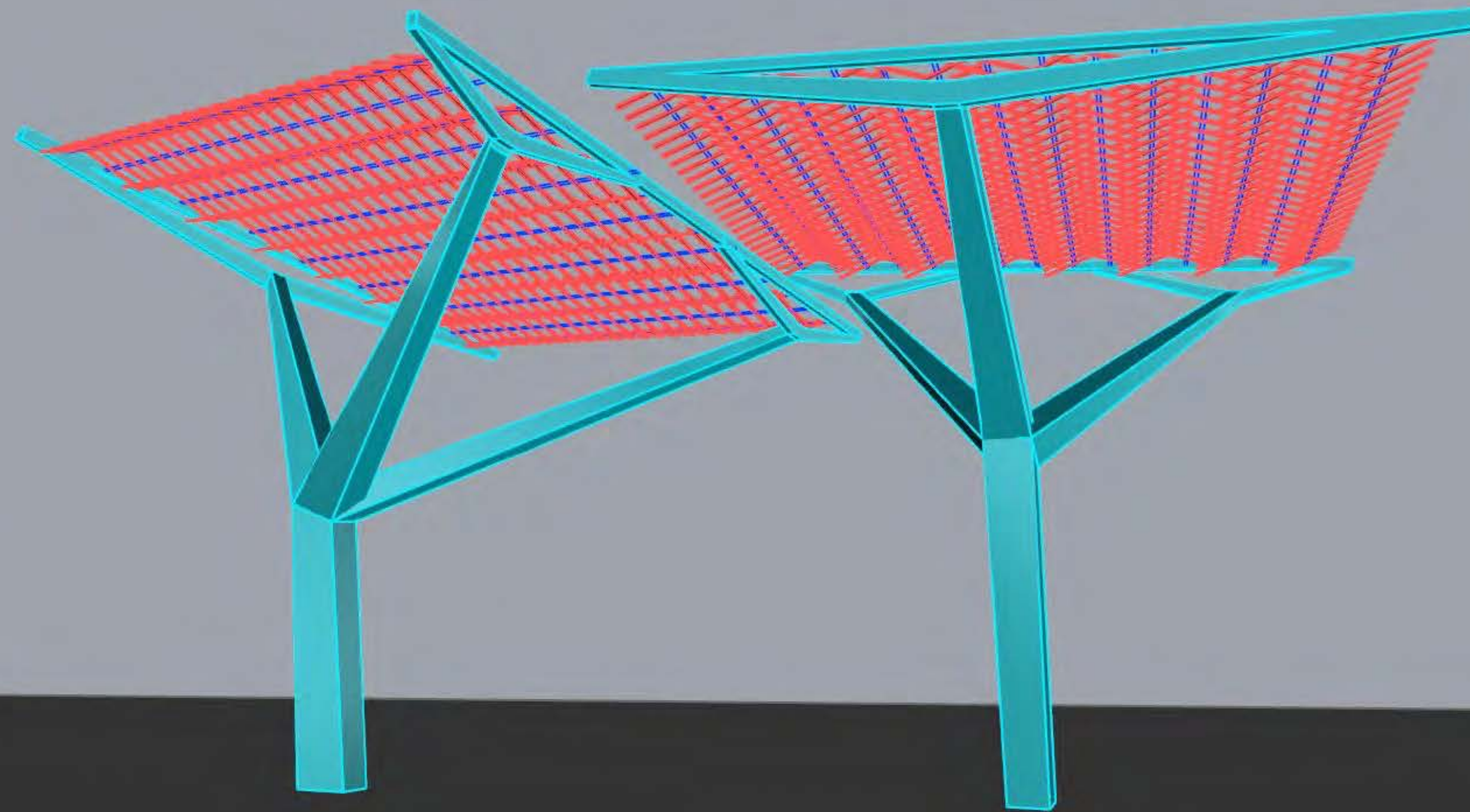

Small torsion waves required too much structure and obscured the movement

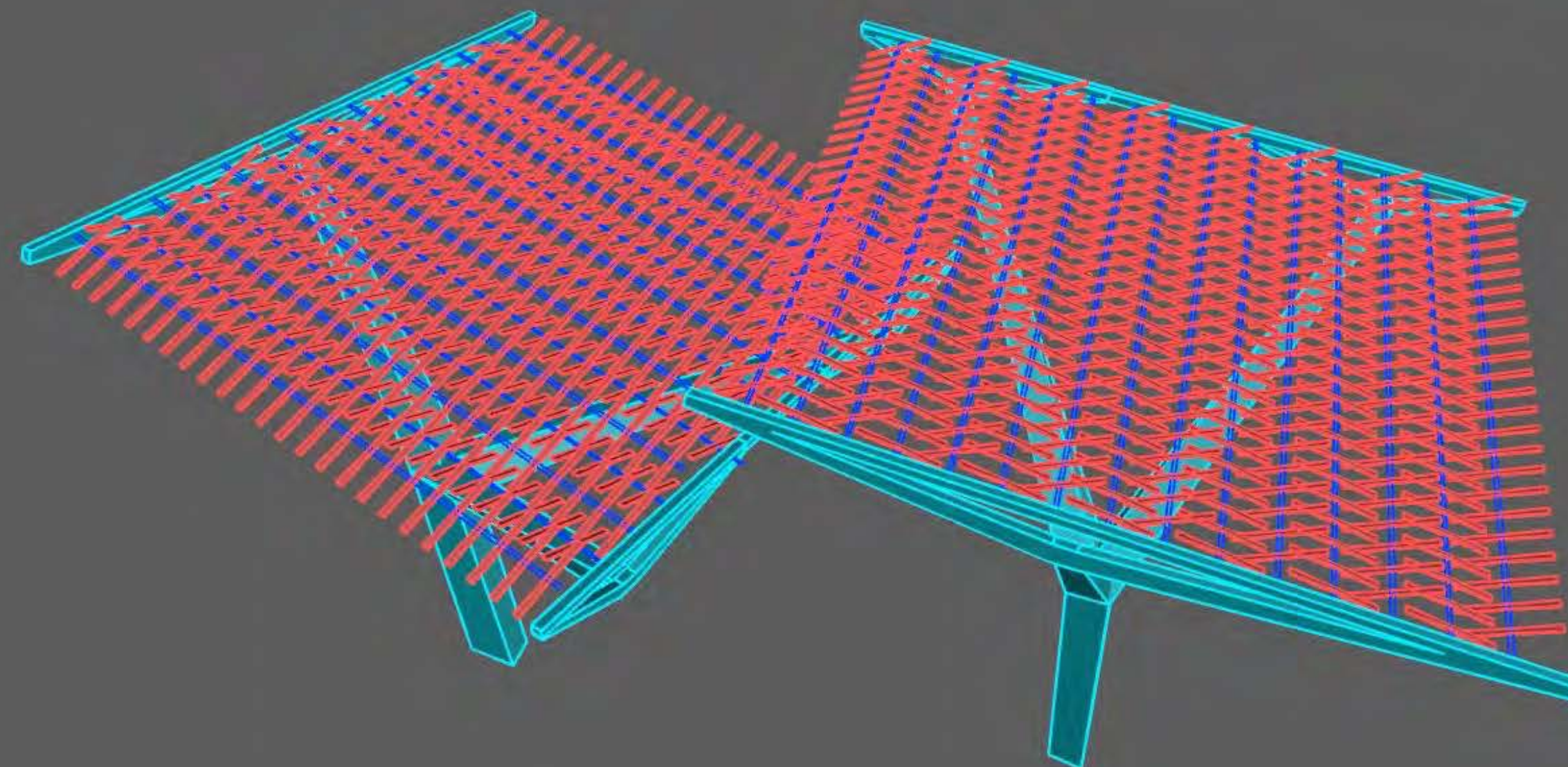

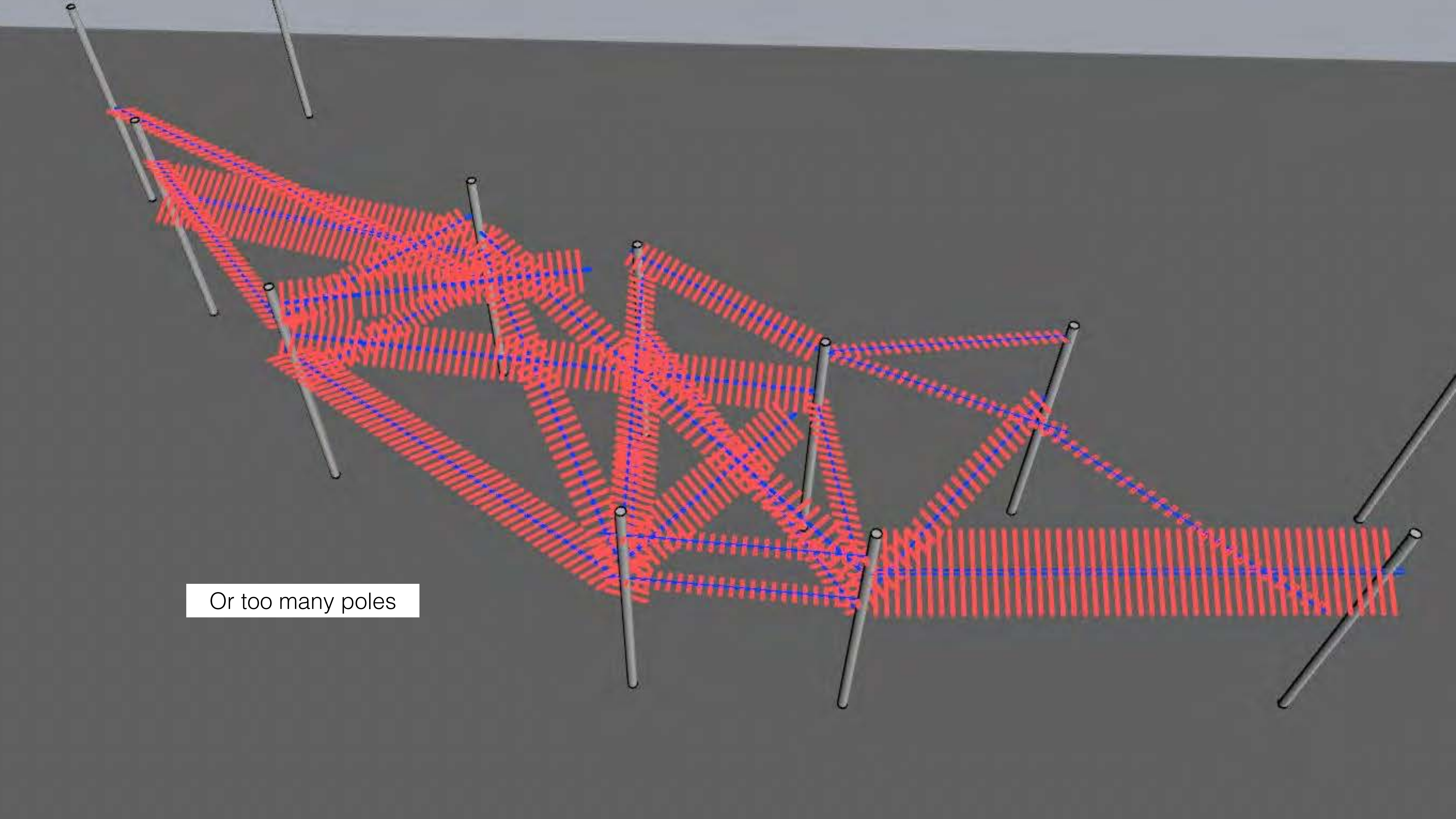

Or too many poles

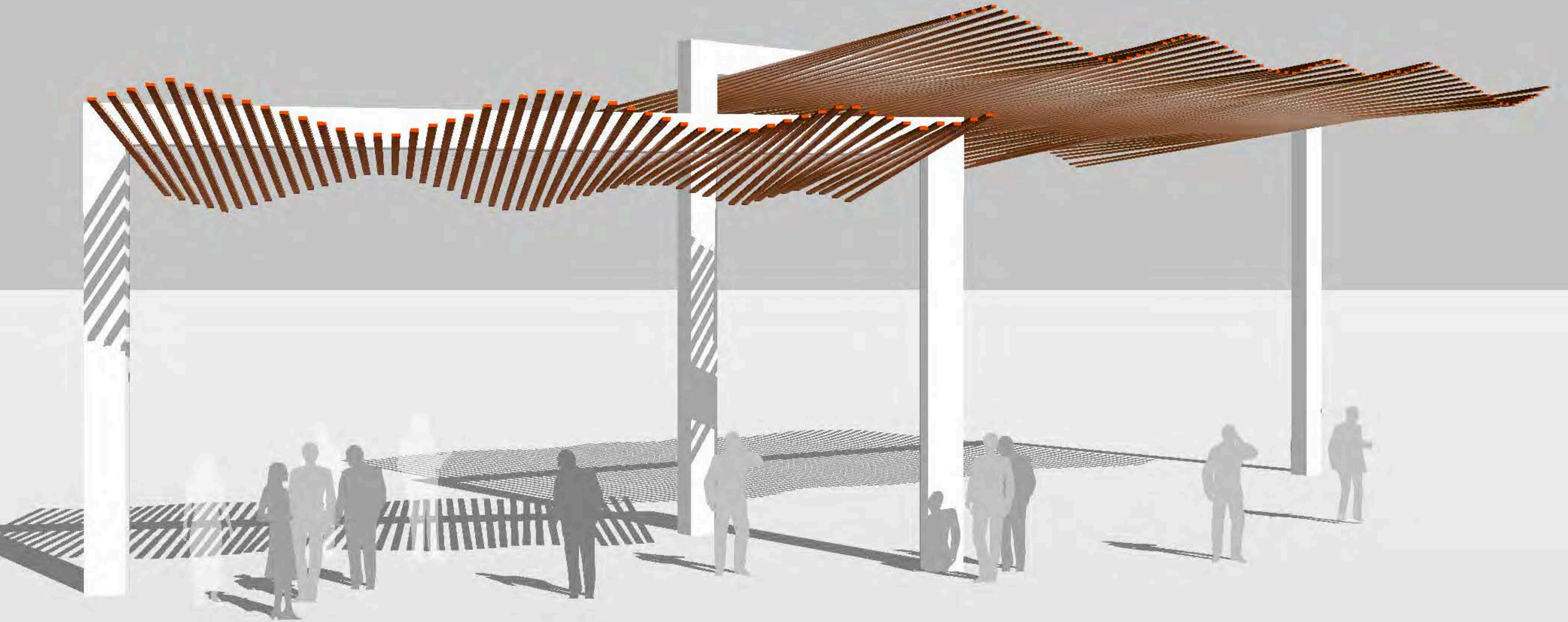

We found a new way to accomplish the torsion wave, make the elements longer and simpler, and have less visual clutter from the structure.



[Click here for 10ft torsion wave video](https://www.kepler16b.com/torsion-schematic-videos)

<https://www.kepler16b.com/torsion-schematic-videos>



[Click here for 20ft torsion wave video](https://www.kepler16b.com/torsion-schematic-videos)

<https://www.kepler16b.com/torsion-schematic-videos>

*Click here for
20ft torsion wave video*

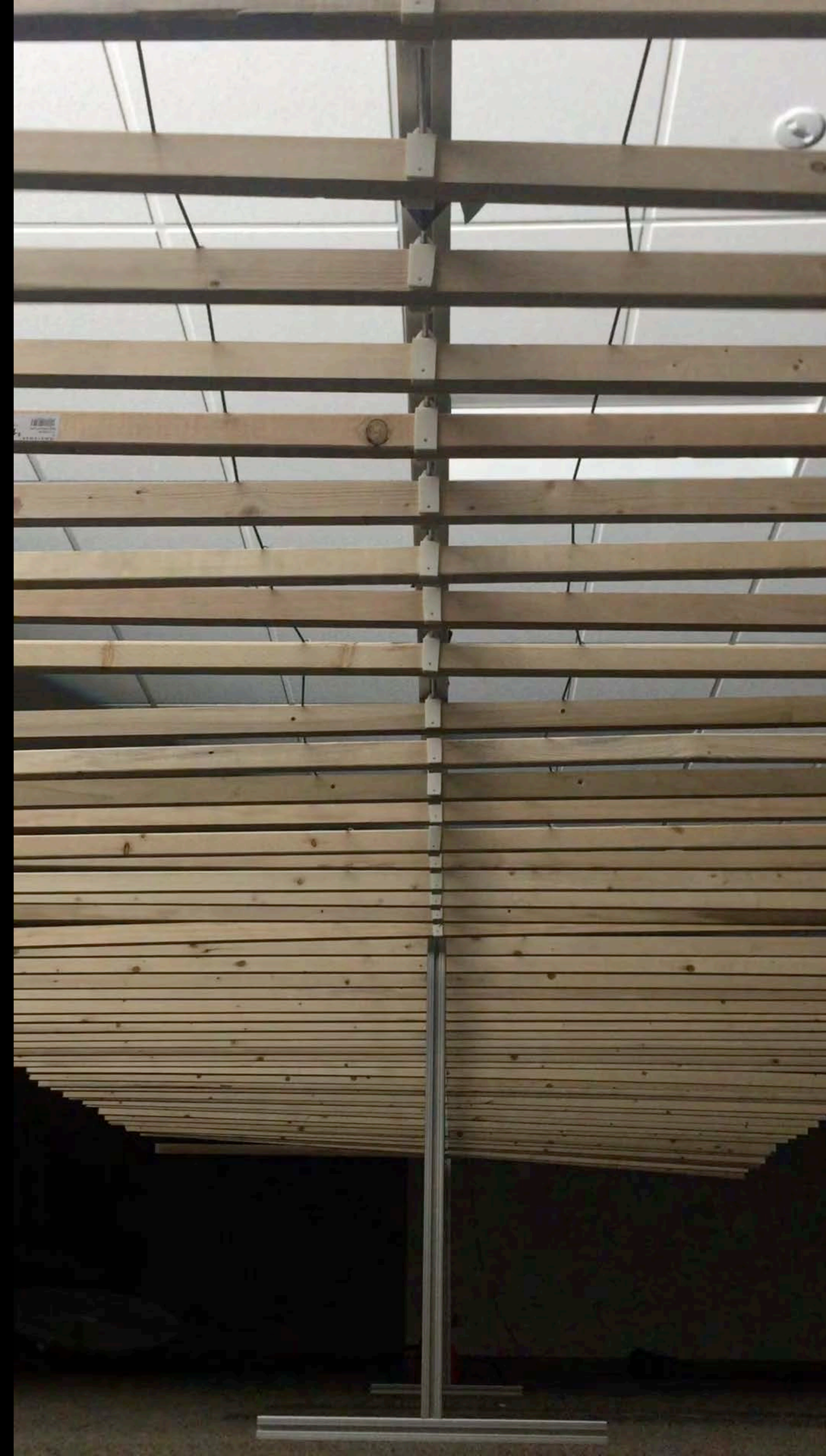



Click here for
20ft in location video
<https://www.kepler16b.com/torsion-schematic-videos>

V Shape





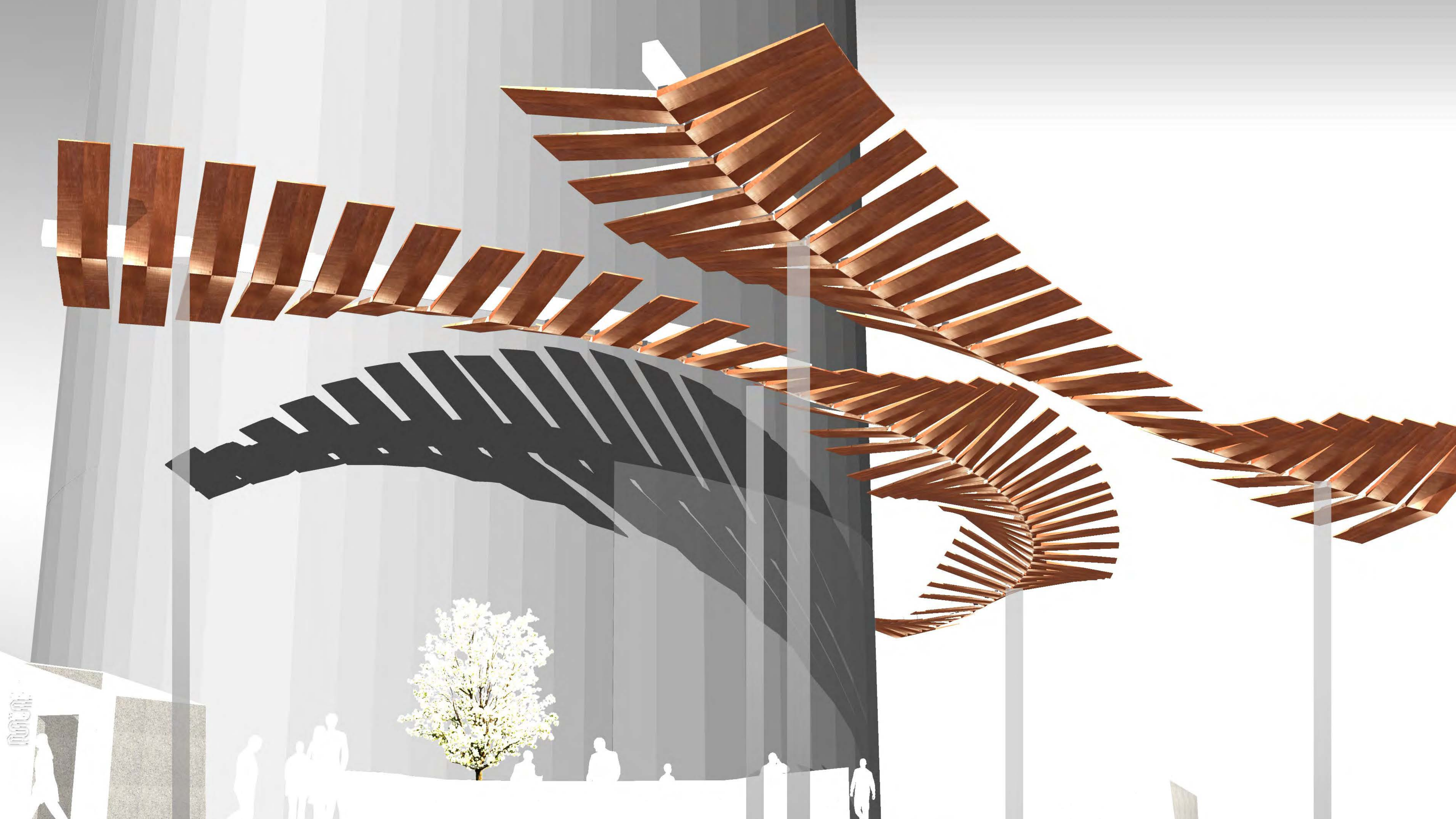

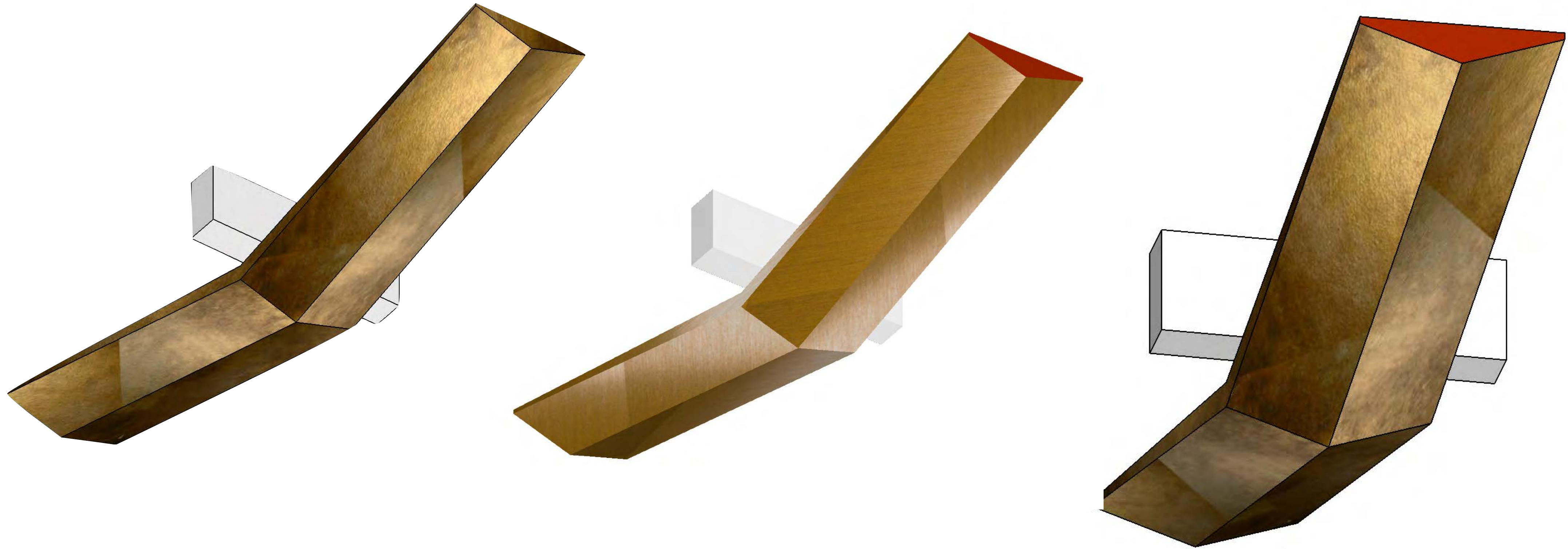

Studies on shape, volume, and coloration of the panel edge

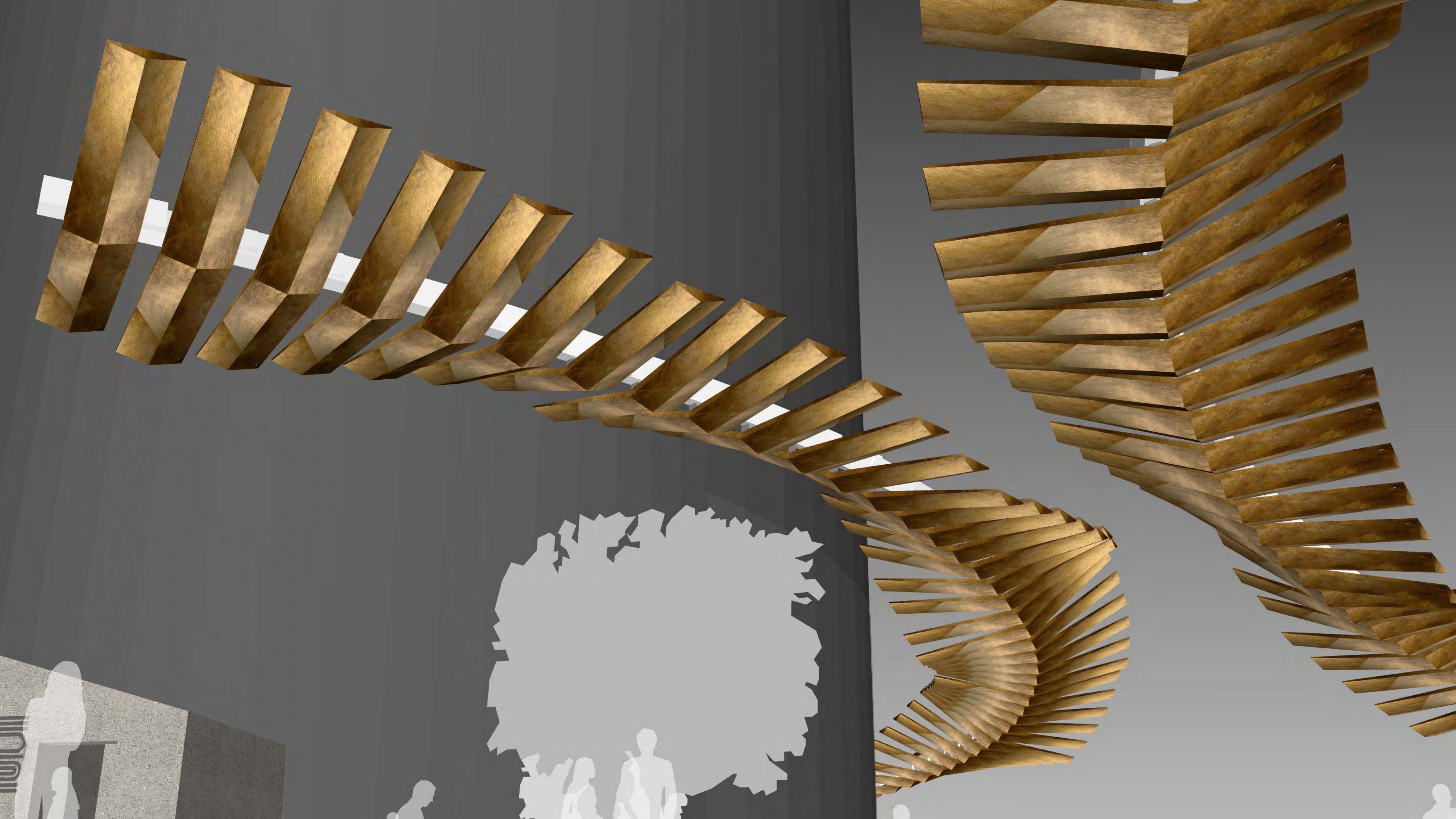

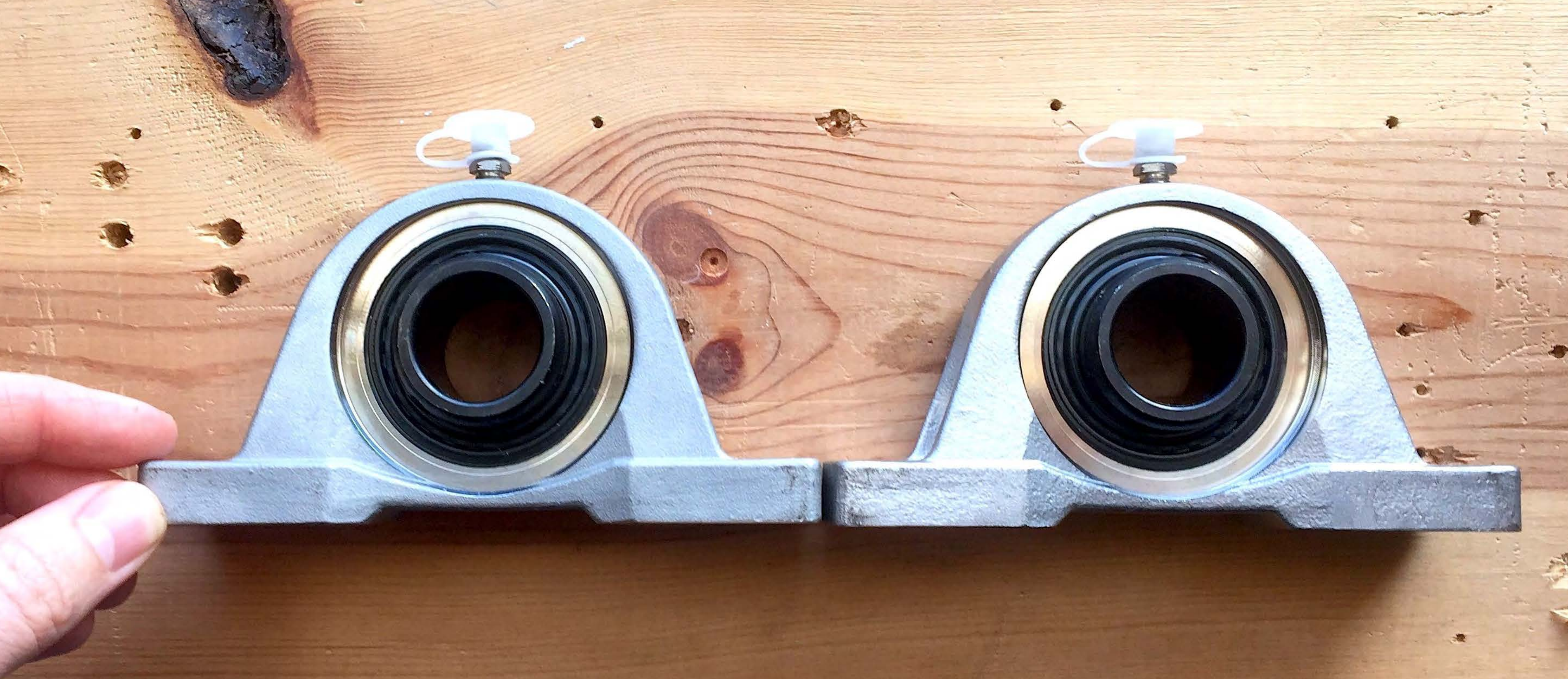

We have found connection points that are durable and enable the smooth movement of the torsion wave. These bearings are rated for wet and salty environments.

Schematic Design

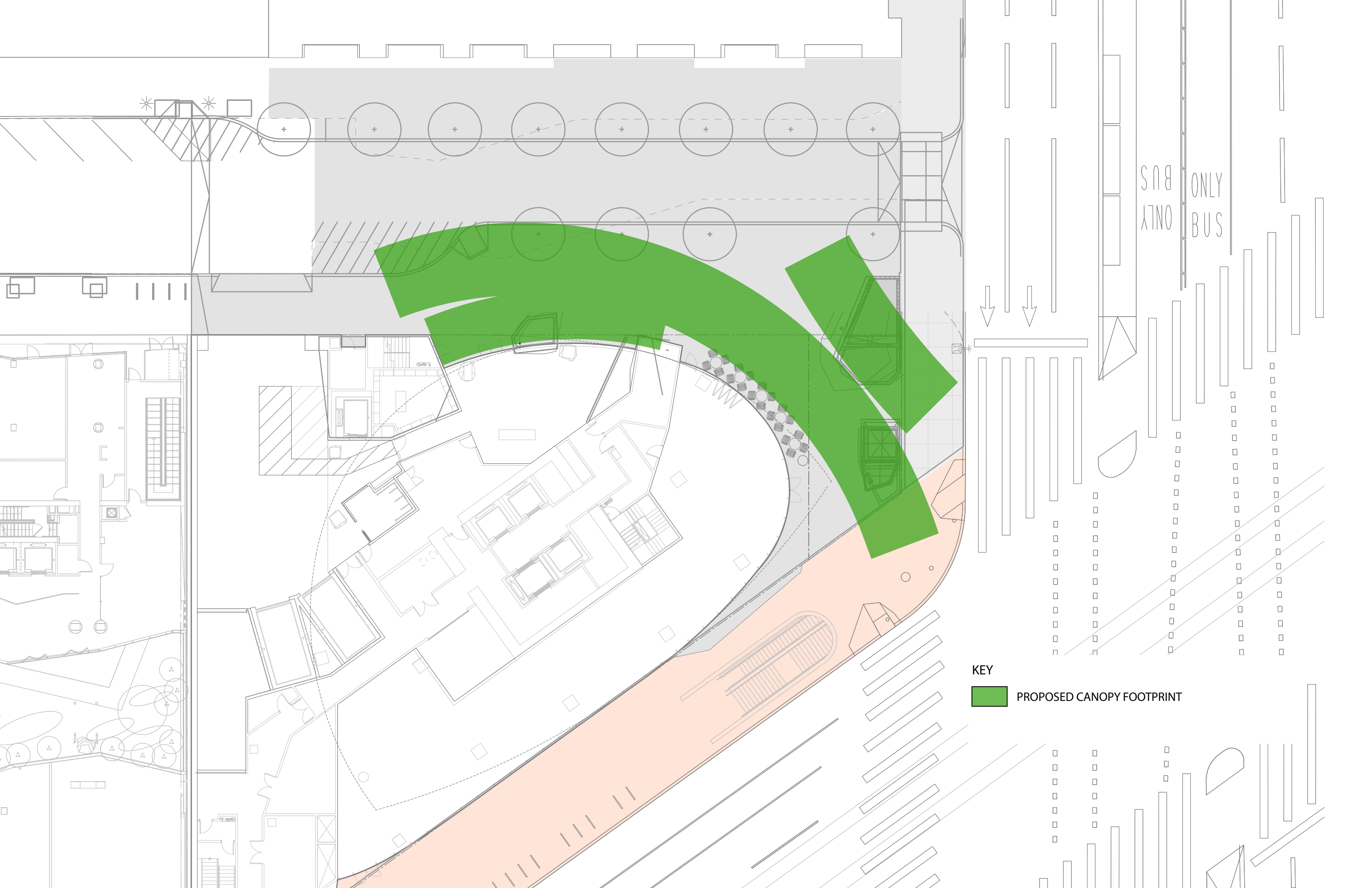

KEY

 PROPOSED CANOPY FOOTPRINT

ONLY BUS
ONLY BUS



Adding an edge to a flat V shape to give dimension and giving the edge a different tone to add interest during movement.

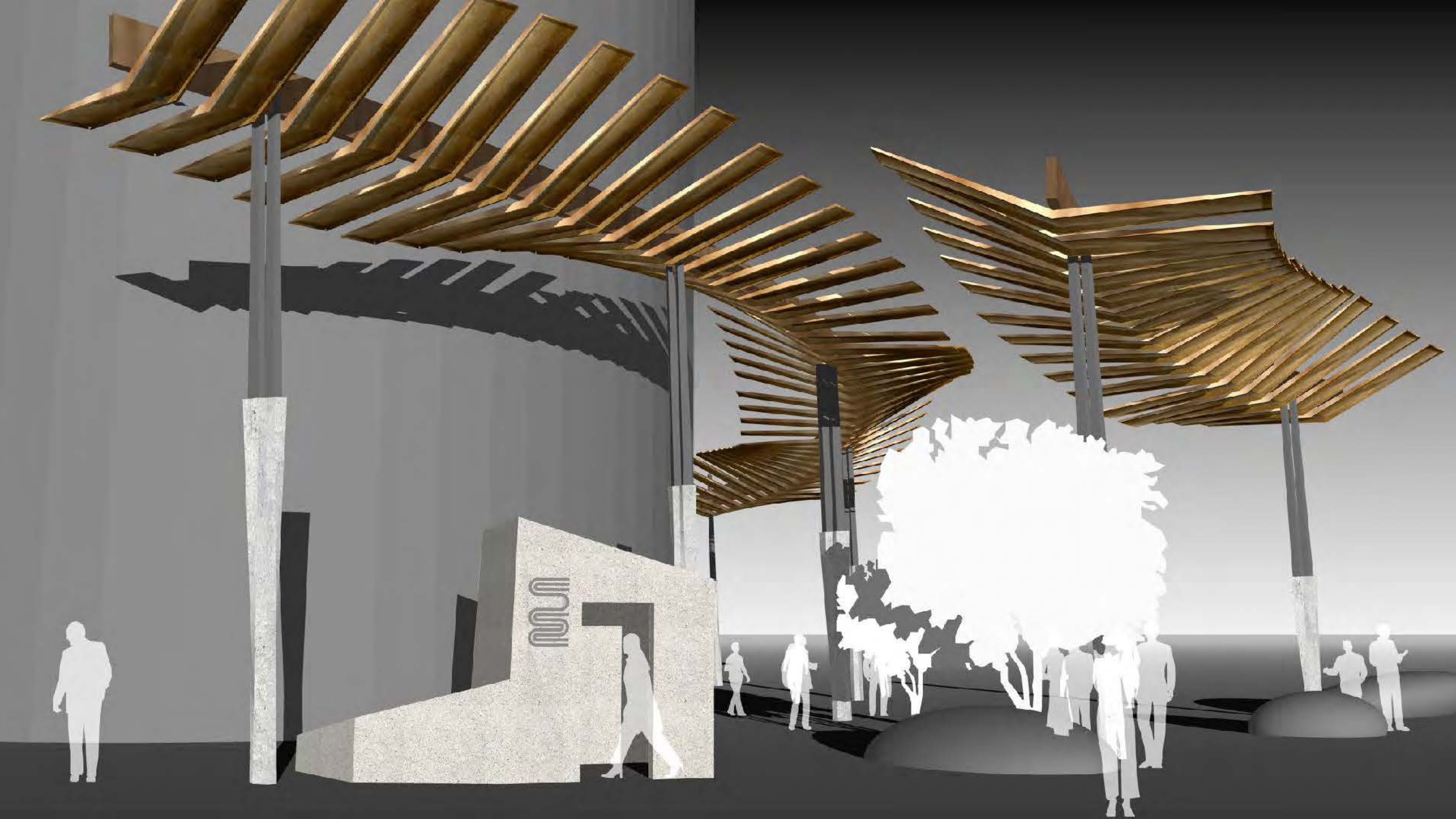

COLUMN STUDIES

Repeating column base with varied extensions for sloping canopy

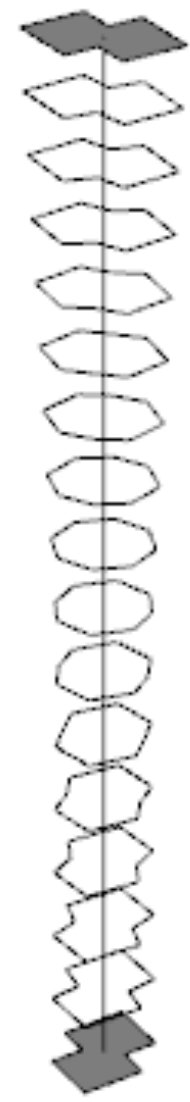

Base geometry created from a rotated double diamond shape

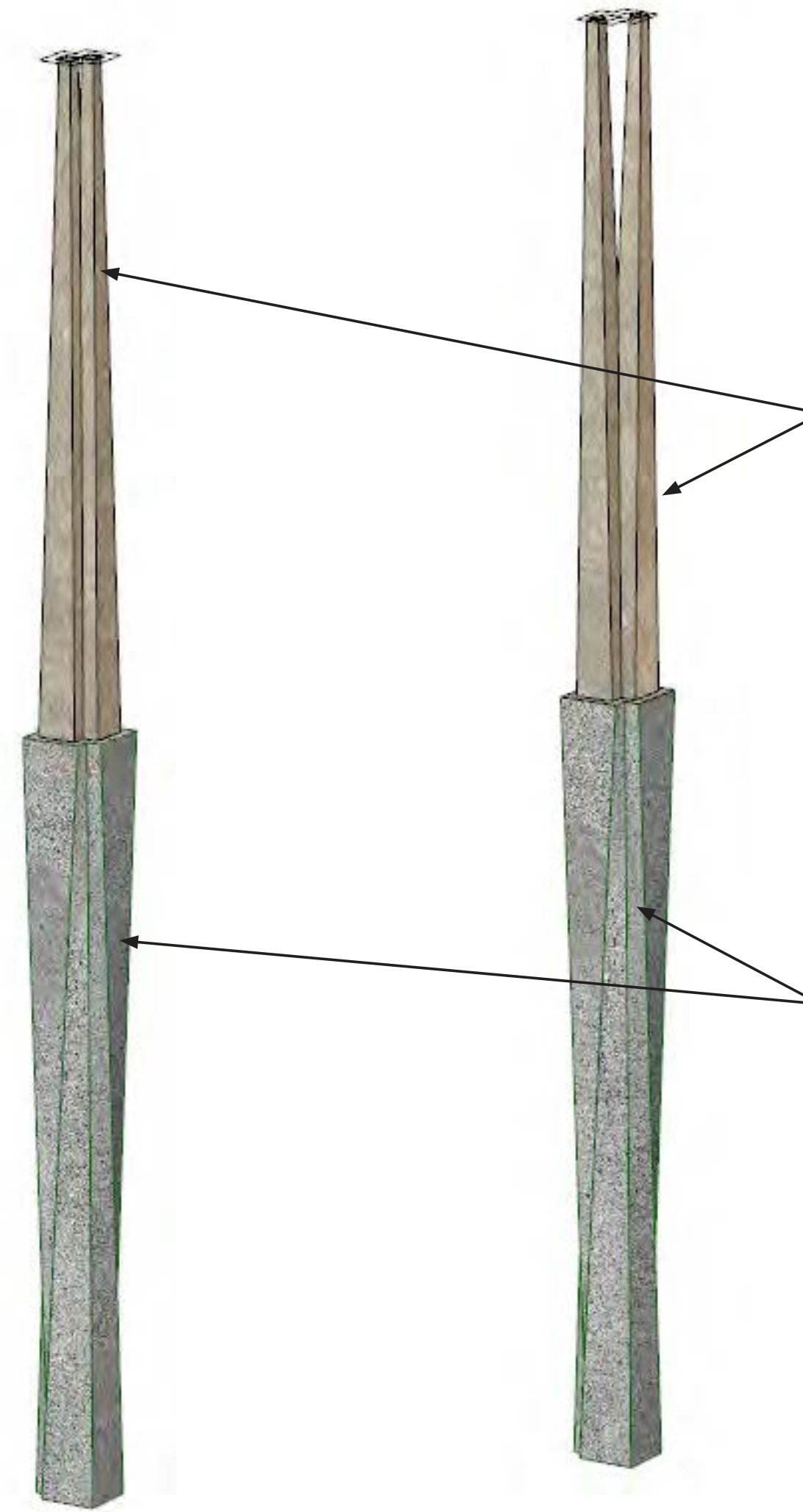

PAINTED STEEL EXTENSION VARIES

STANDARD PRECAST CONCRETE BASE



Ongoing Studies

PRECAST CONCRETE:
HONED



SPANDREL:
3MM STEEL PANEL WITH 8 LAYER LUMIFLON COATING
CUSTOM COLOR

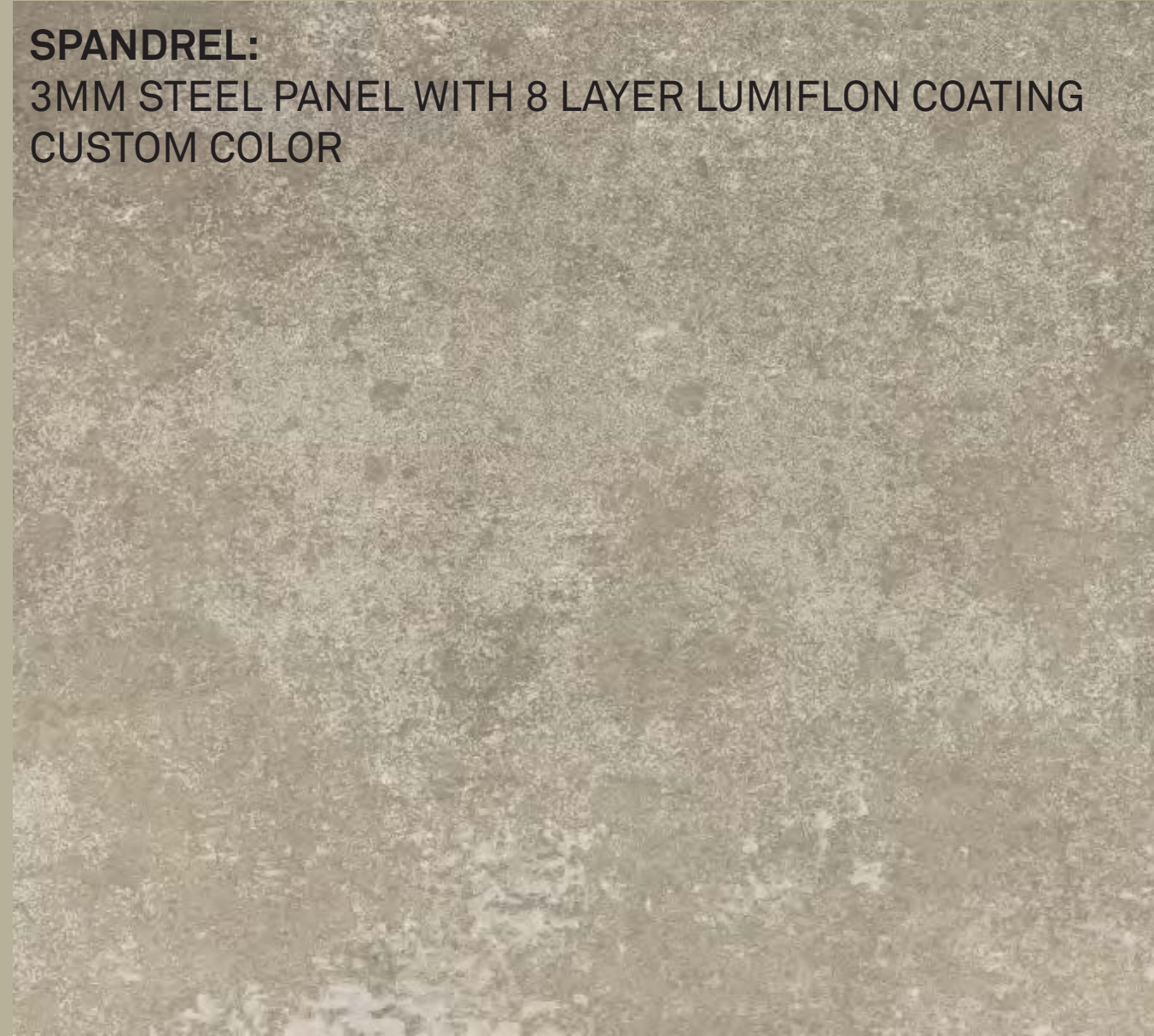

PRECAST CONCRETE:
SANDBLASTED

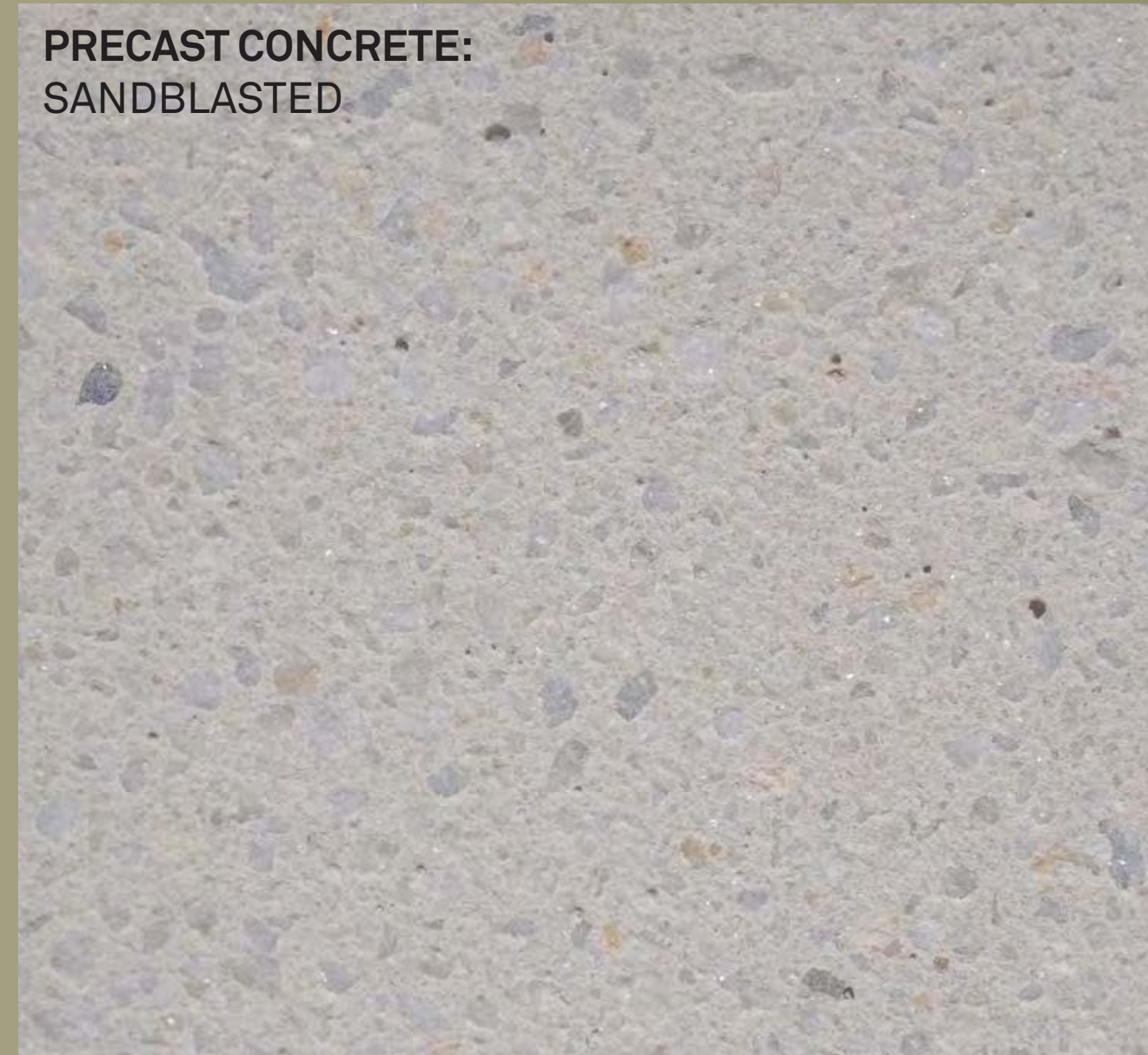

Building
pallet
gave
inspiration
to our
materials
selection

GLASS:
SOLARBAN 70 WITH OPTIGRAY COATING

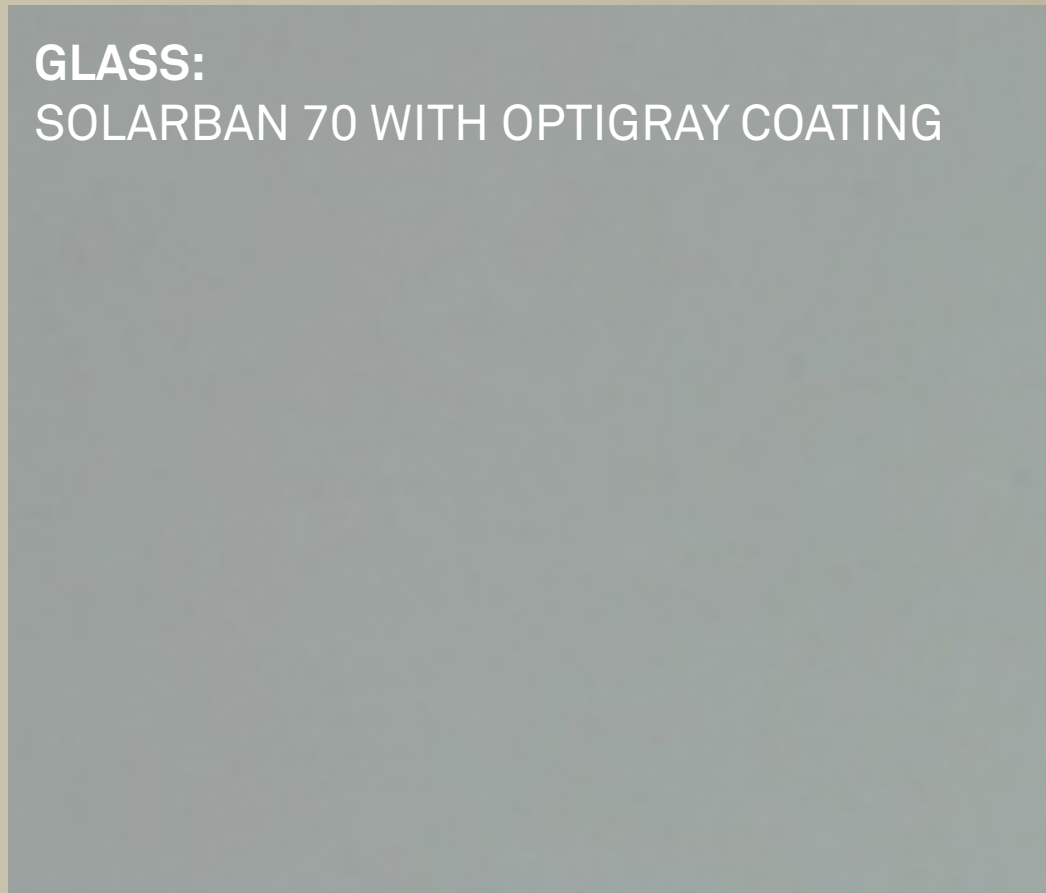

STONE OR CERAMIC TILE:
AT LOBBY INTERIOR AND EXTERIOR

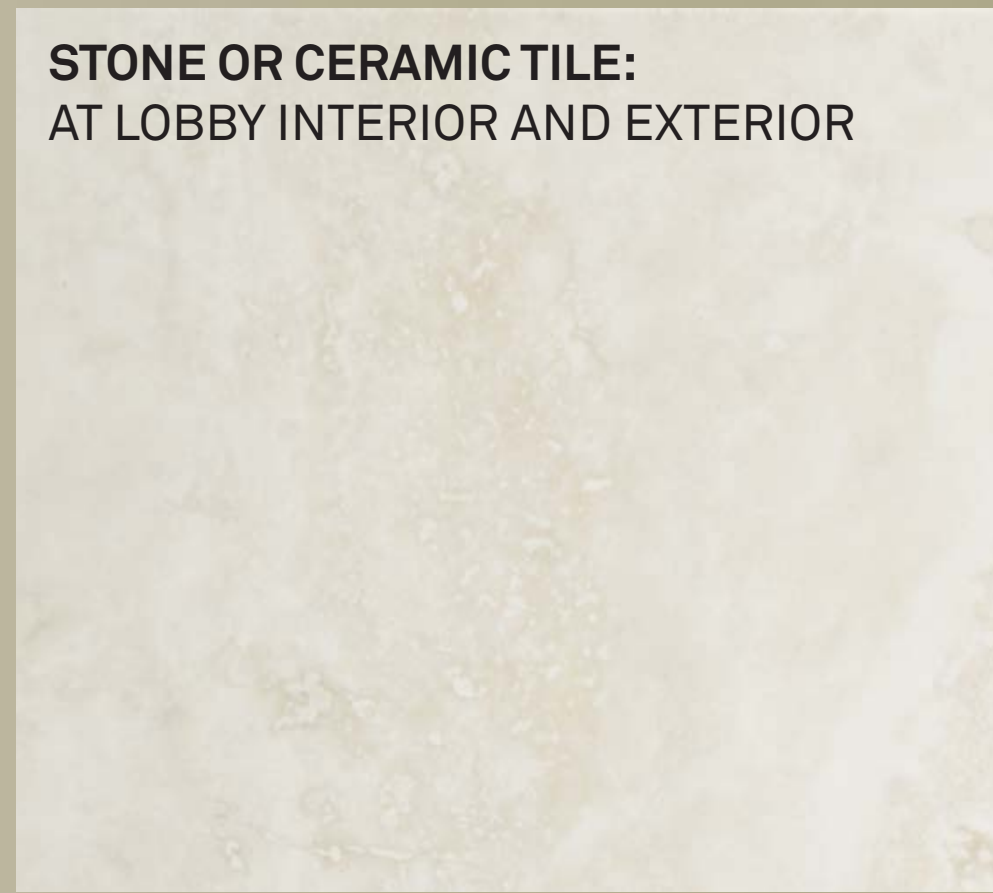

WOOD SIDING:
AT LOBBY INTERIOR

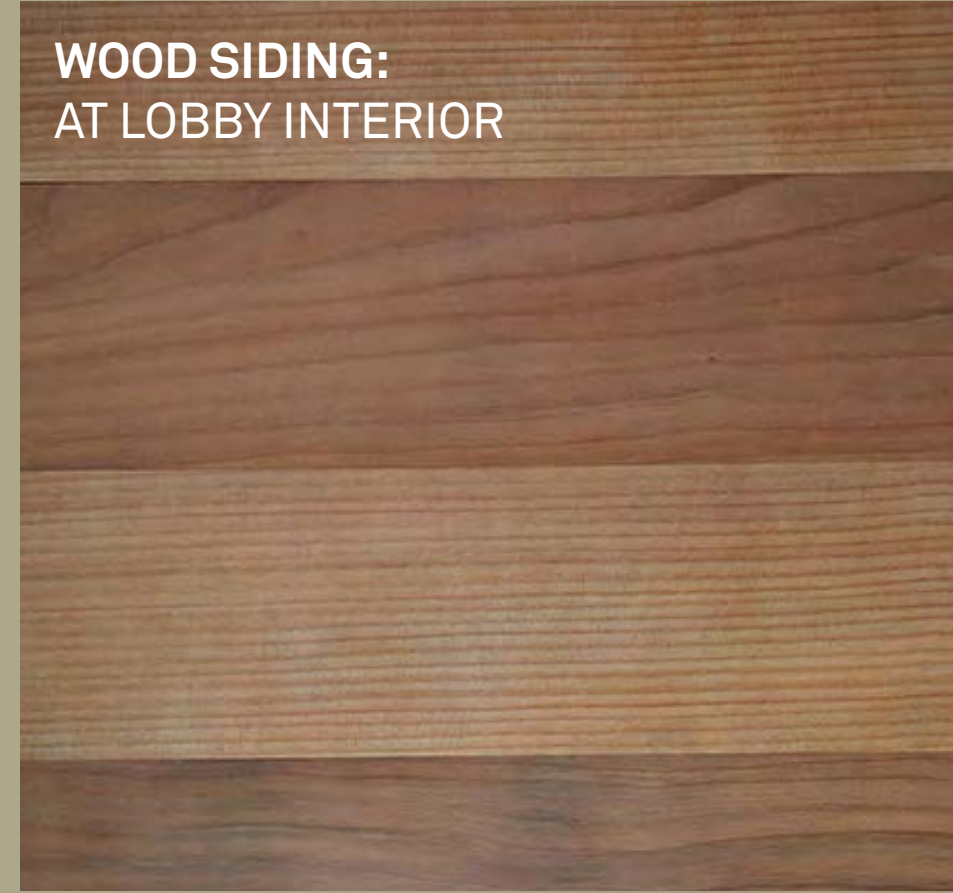

CUT SOFFITS:
LIMESTONE PLASTER



WINDOW SYSTEM: BLACK/BRONZE ANODIZED ALUMINUM,

Planter Understory

Gradient/Spectrum connecting planters

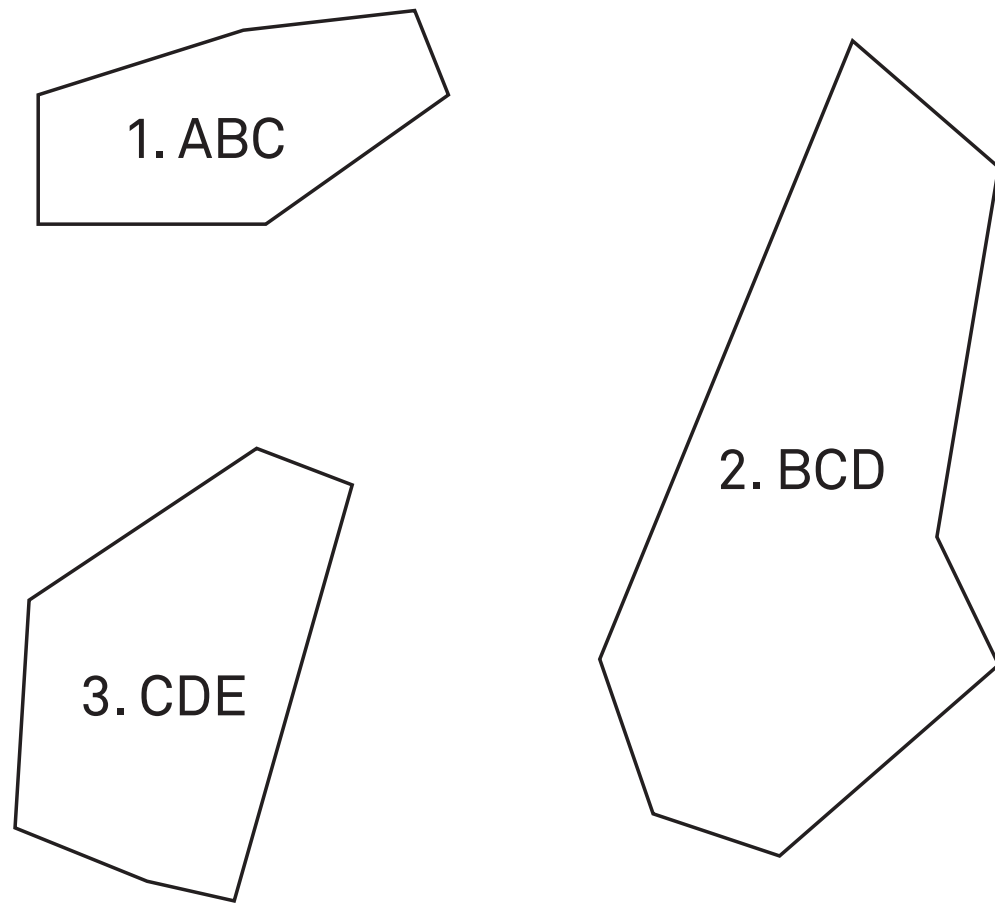

Material/Color Palette

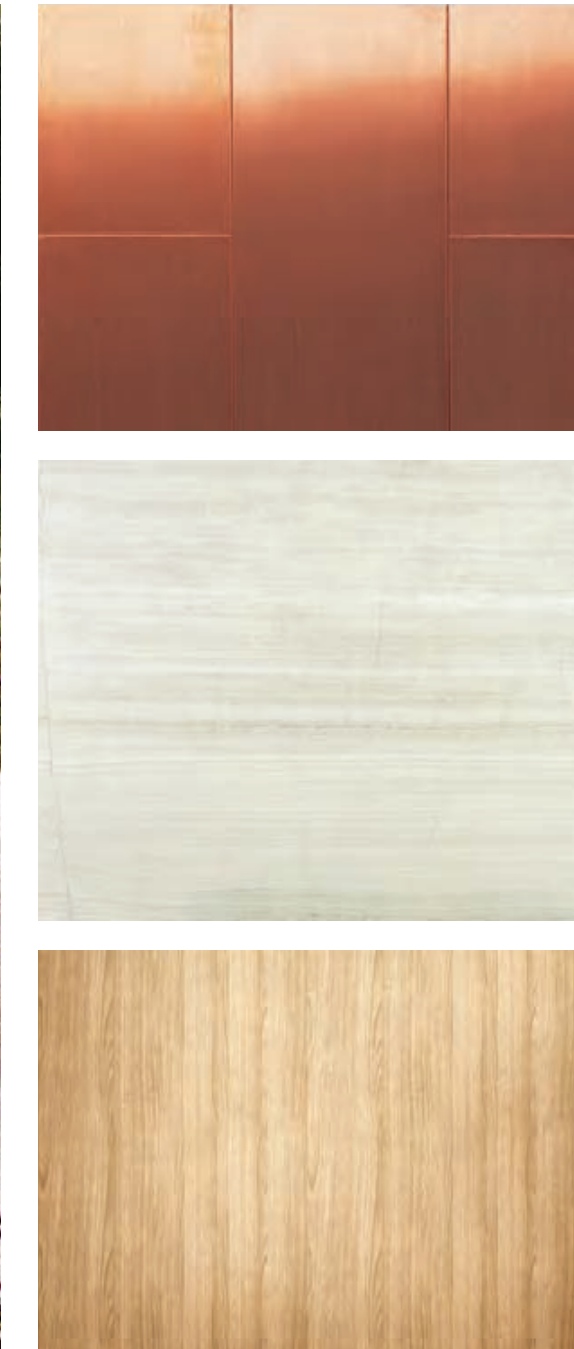

Landscaping pallet gave inspiration to our design

Species _mix of native grasses, perennials, and woody species



Gray Rush *Juncus patens* (N)



Fruit Sedge *Carex globosa* (N)



Bottlebrush Grass *Elymus californicus* (N)



Pacific Mist *Arctostaphylos manzanita* (N)



California angelica *Angelica californica* (N)



Meadow Rue *Thalictrum fendleri* (N)



Alum Root *Heuchera micrantha* (N)

(N) Native to CA region



UNDERSTORY PLANTING PALETTE

CA Chaparral-native grasses, perennials and woody species



Snøhetta

08/09/2016
Page 50 of 66

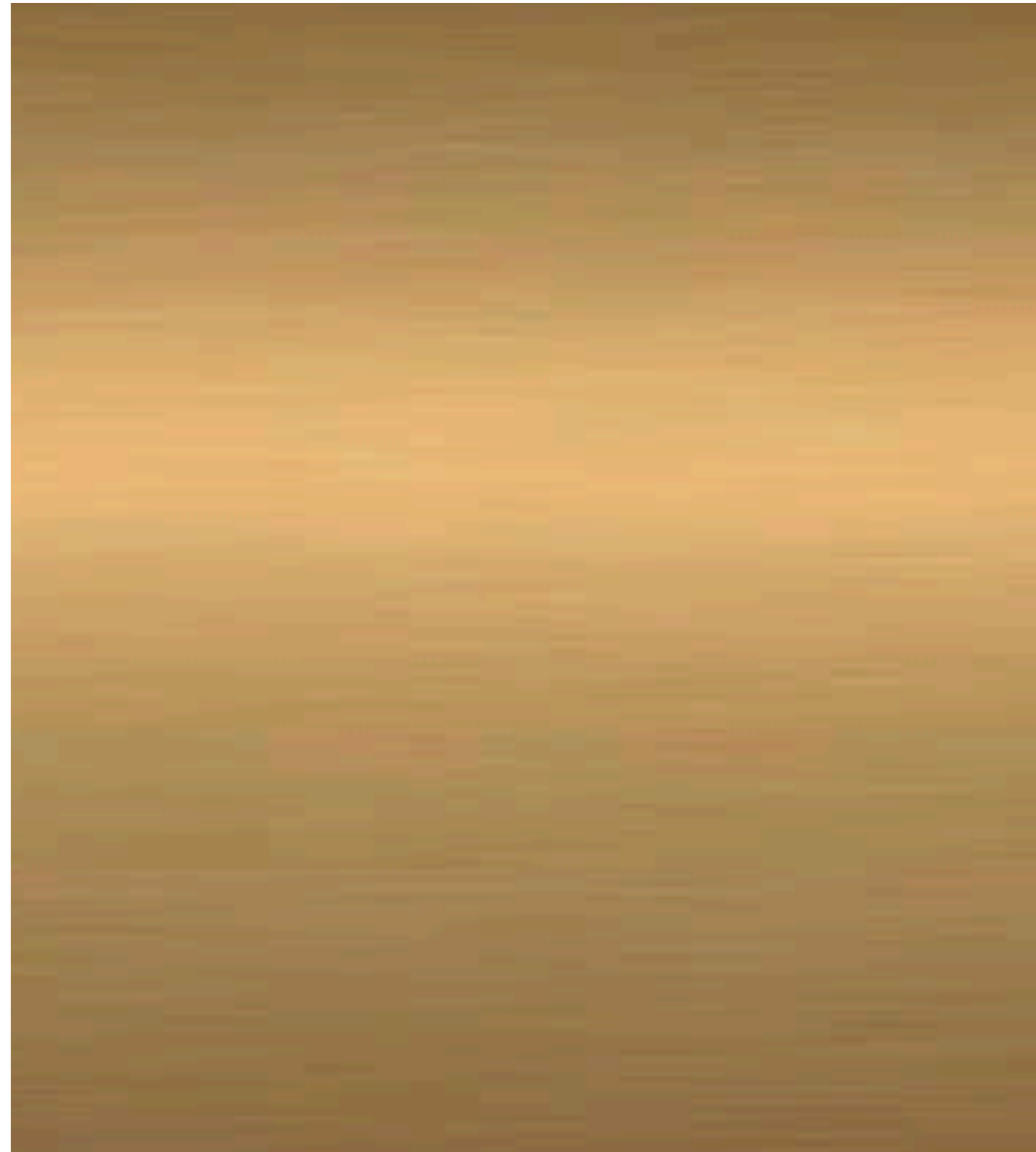

Exploring plating aluminum with a bronze or brass color and whether it should be textured or smooth

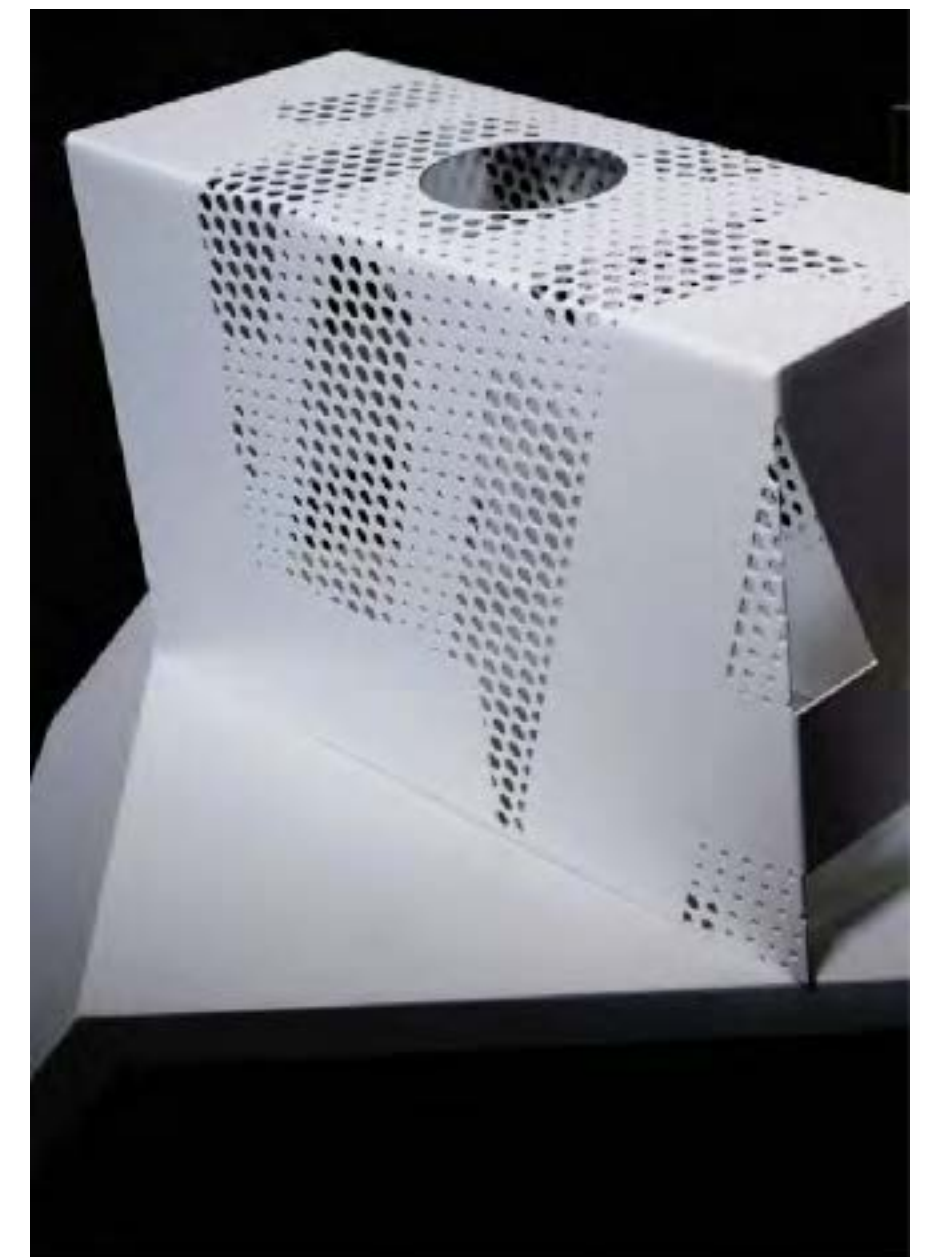
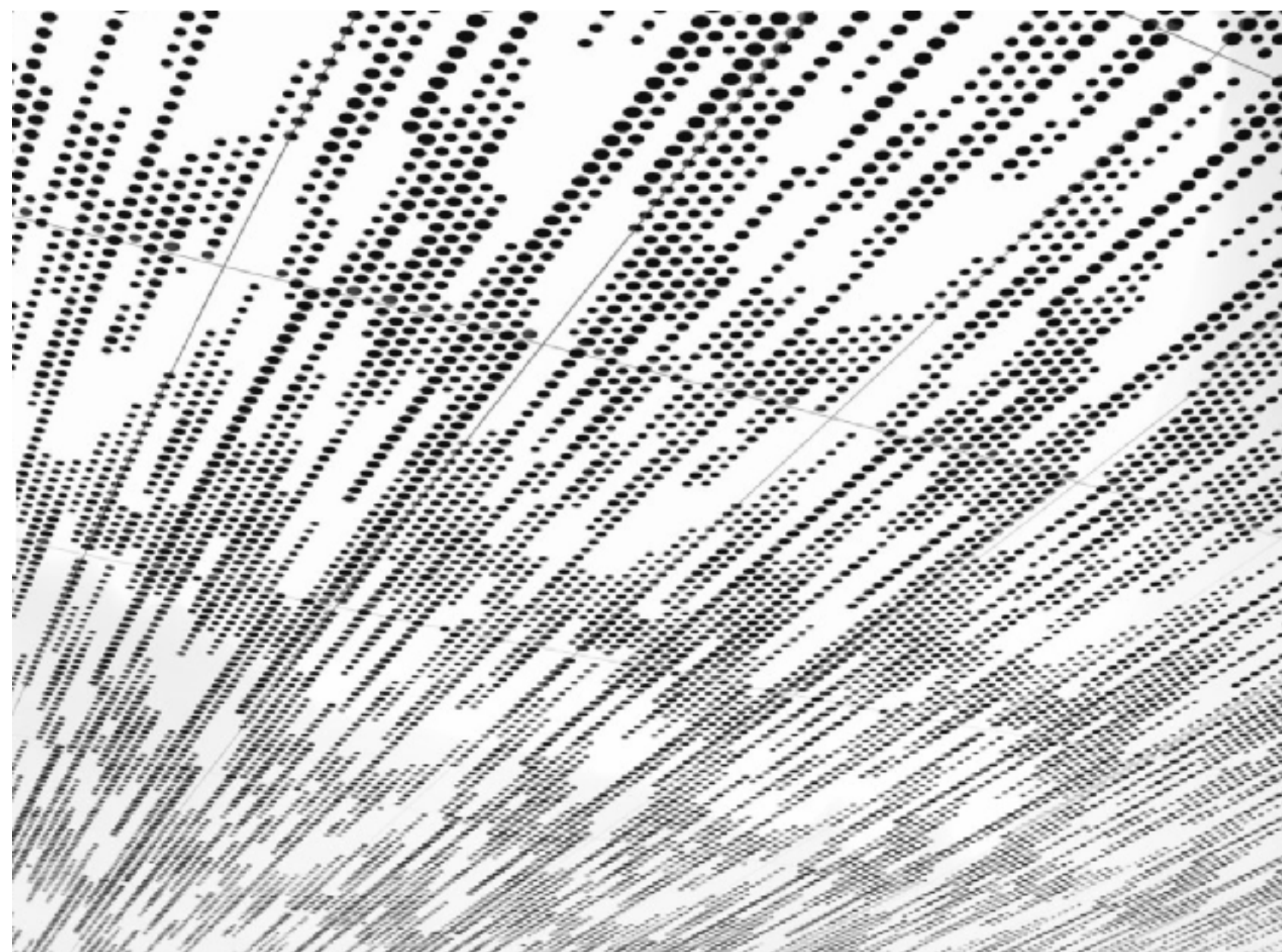
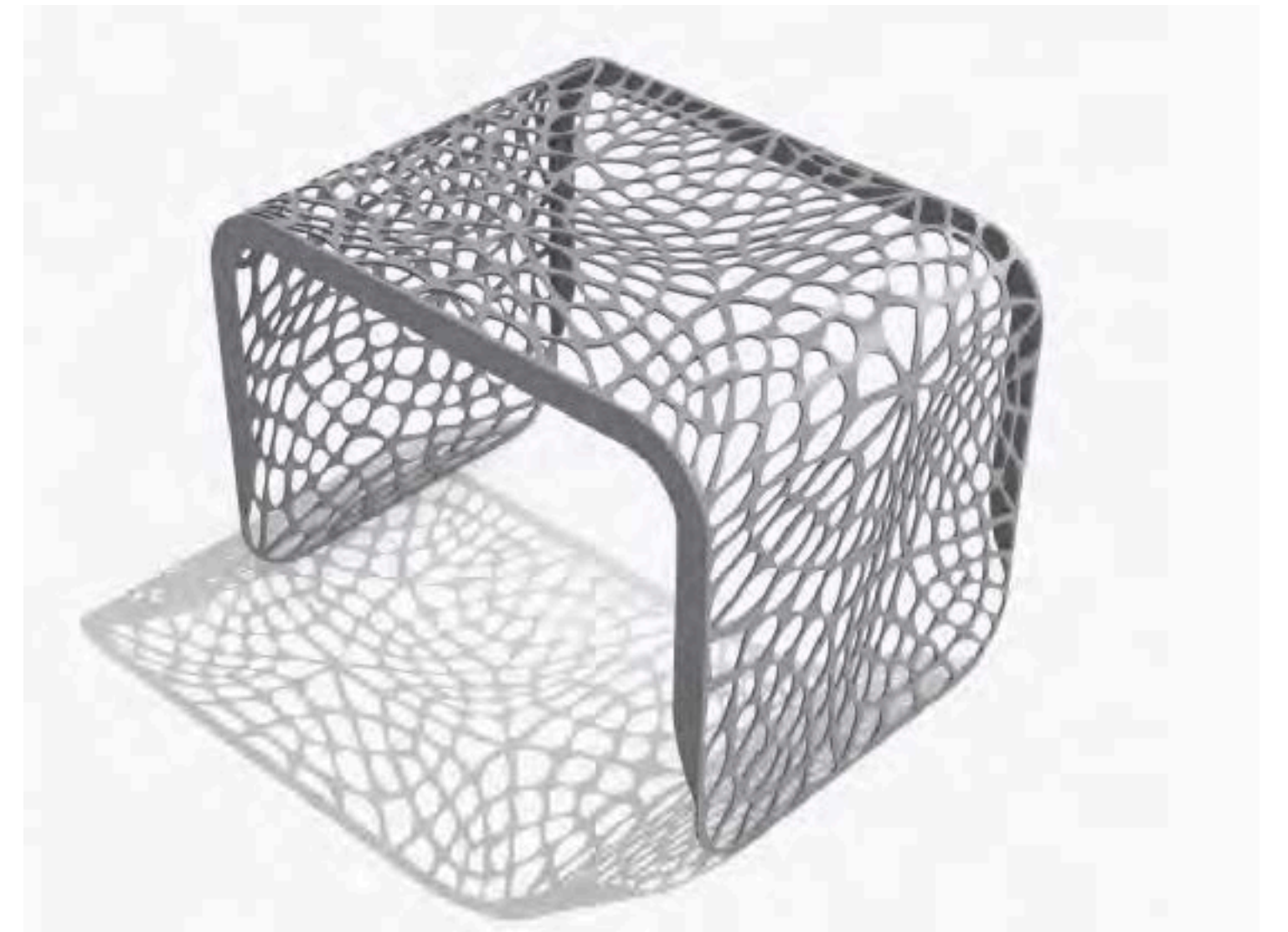
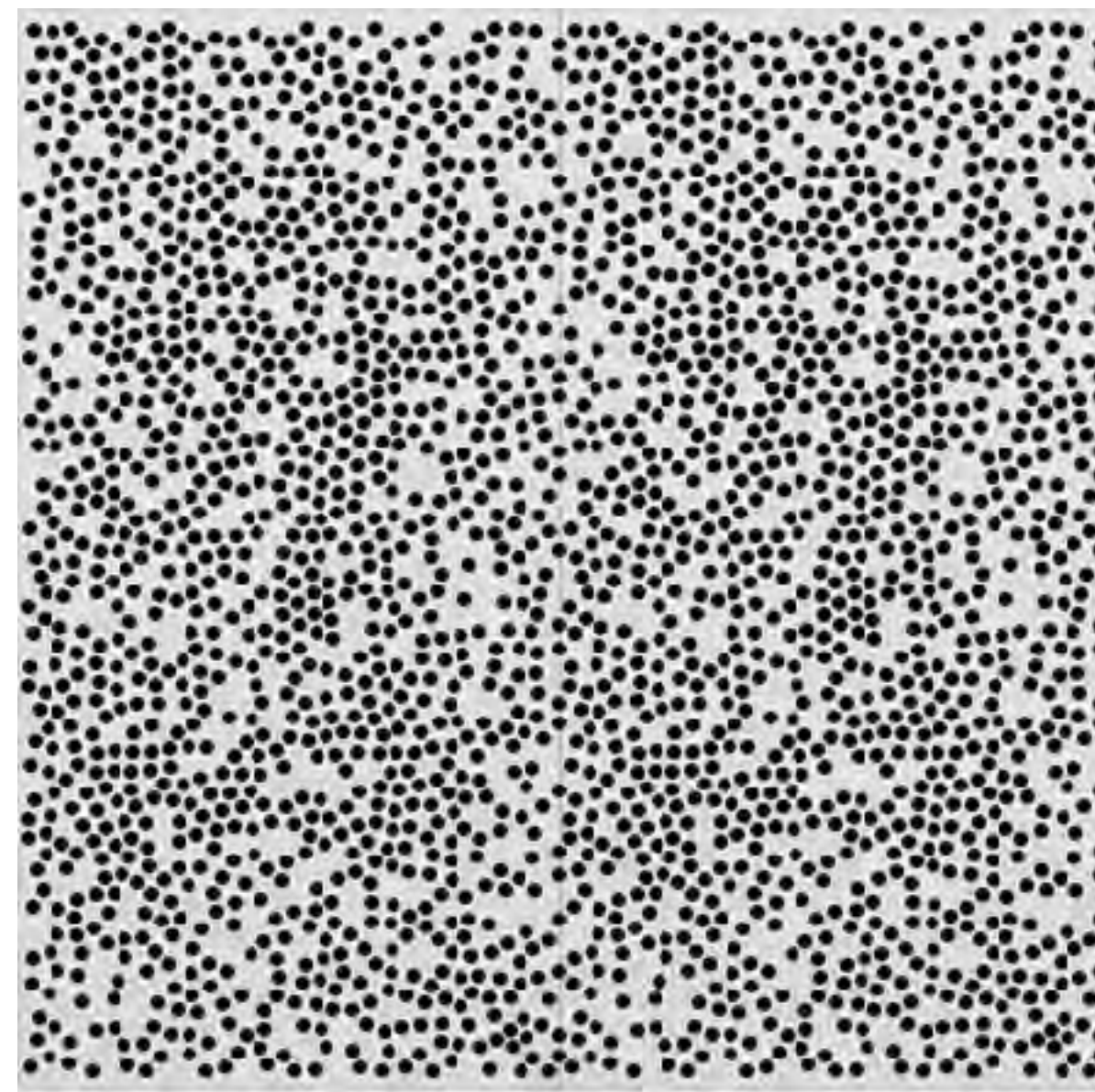

Perforations might add interest and help us achieve the required 50%-75% transparency in the design

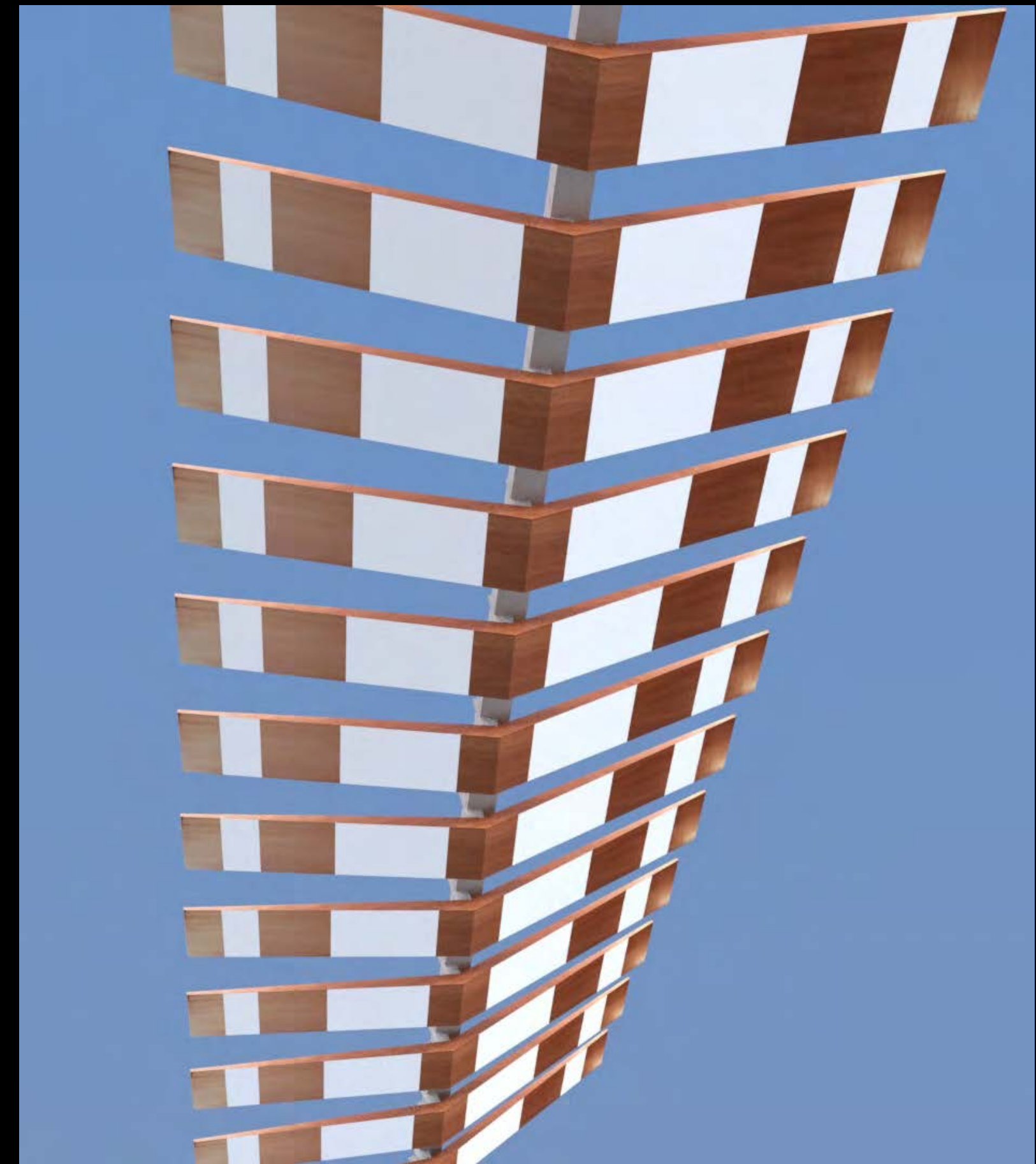
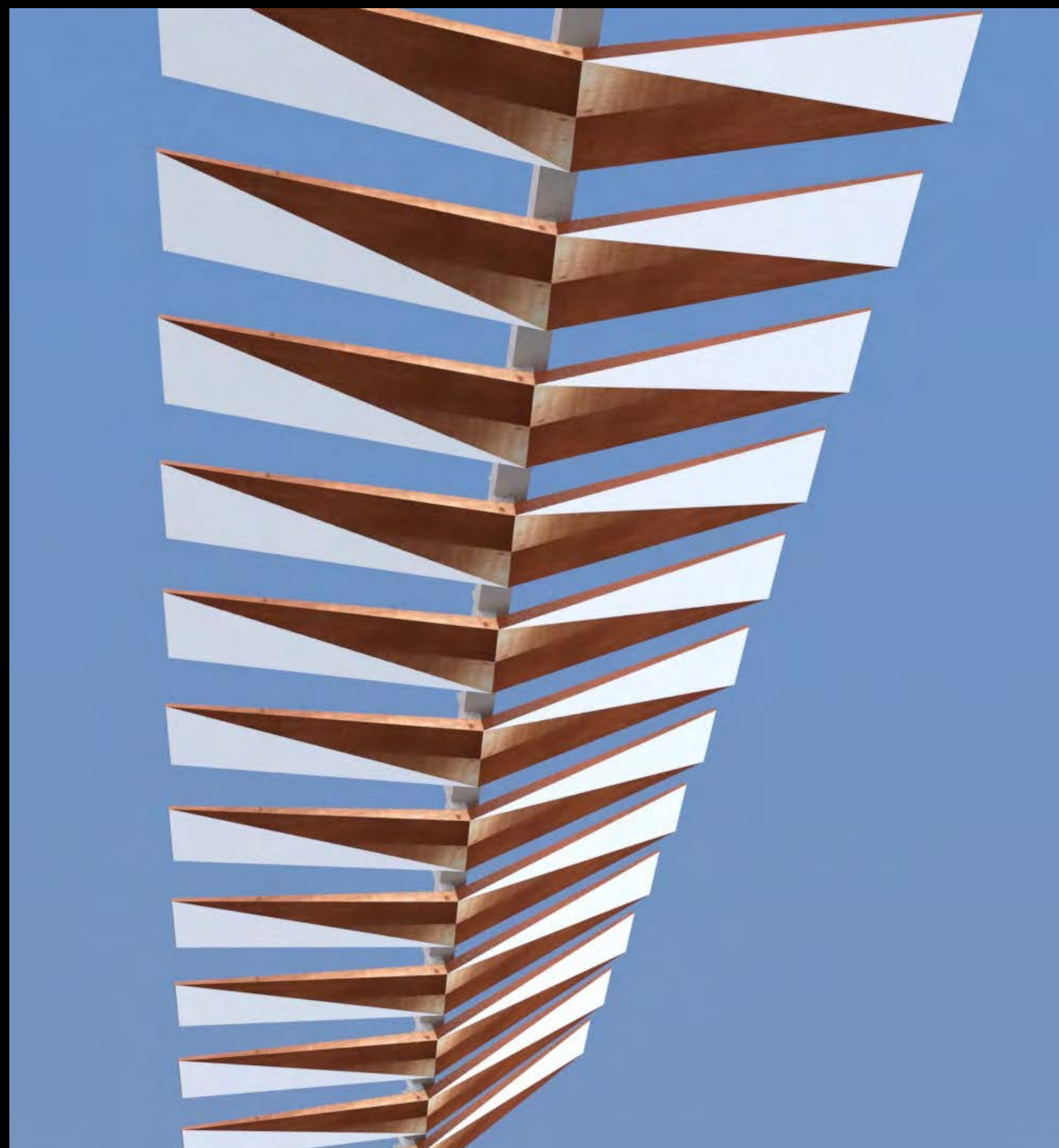
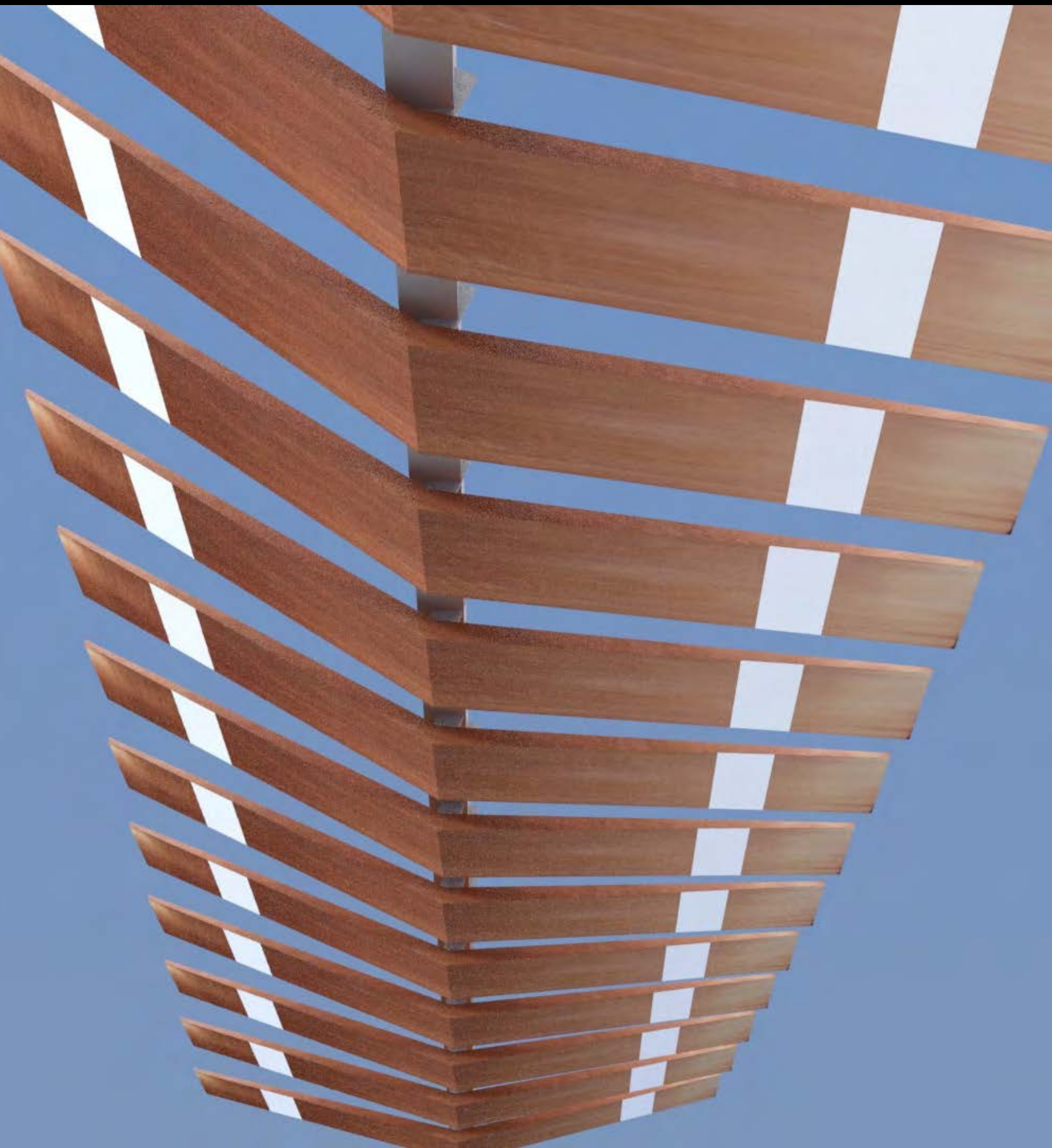

When moving, patterns on the blades can enhance the waves visual impact,
much like the dots on the end of the blades in the very first video

