

THE CENTAUR IN DOGPATCH ARTS PLAZA BY LAURA KIMPTON & ANTONIO RUPERTO

May 17, 2017 | Visual Arts Committee Presentation



1. Project Summary
2. Site Context
3. Dogpatch Arts Plaza
4. The Centaur
5. About the Artist

Dogpatch Arts Plaza will convert a dead-end street into an 8,000 square foot arts-focused public pedestrian plaza at 19th and Indiana Streets in San Francisco's Dogpatch neighborhood.



The plaza was inspired by and seeks to celebrate Dogpatch's artistic spirit, including the annual Burning Man Decompression event, and its industrial heritage by creating a public outdoor "art gallery" for large-scale installations and performances.

Project Summary

Build Public has partnered with **ArtSpan** to identify and install art in Dogpatch Arts Plaza. Build Public and ArtSpan are dedicated to bringing art to the plaza that reflects the community and neighborhood surrounding the development.

ArtSpan approached artist Laura Kimpton, of **She's Got Wings**, about displaying some of her monumental work in the plaza. This sculpture would be the first in a series showcased in the space, and would be in place for approximately one year.

Together, Build Public, ArtSpan, and She's Got Wings have collaborated to bring this proposal to the **San Francisco Arts Commission** to install the Centaur in Dogpatch Arts Plaza.



Dogpatch Arts Plaza Site Context

I-280



Site

Indiana Street

Esprit Park

19th Street

Minnesota Street

20th Street

18th Street

Tennessee Street

3rd Street

Illinois Street

Future
Crane
Cove
Park

Dogpatch Arts Plaza Site Context



SITE LIGHTING

- (A) Mast Light**
- (B) Tree Light**
- (C) Step Light**
- (D) Bleacher Security Light**

SITE ELEMENTS

- (1) Caltrans Embankment**
Landscape improvements- tree planting (within Caltrans R.O.W.)
- (2) Urban Bleacher**
Concrete bleacher with corten facing, wood seats and single specimen tree
- (3) ADA Accessible Seating Locations**
4 Spaces total
- (4) Security Fence and Gate**
- (5) Custom Moveable Seating & Planters**
- (6) Designated Area for Cafe Tables and Chairs**
Furnishings not in project scope, to be provided by cafe owner
- (7) Plaza Floor & Designated Area for Large Scale Art Installations**
High quality cast in place concrete with ground finish
- (8) Loading Zone**
Painted loading zone
- (9) Metal Planters at Cafe**
Provided by cafe owner
- (10) Curb Cut - Vehicle Access (10'-0" Wide)**
Limited access for Cresco Equipment Rental and plaza programs.
- (11) Bike Racks**
SF city standard bike racks
- (12) Removable Bollards**
Plaza bollards deployed during business hours to limit pedestrian access. Removed nights/weekends and during events.
- (13) Tree Planting**
Specimen tree and planting area
- (14) Gravel Apron**
- (15) Gallery Wall at Cresco Building**
- (16) Guardrail and Handrail**
Wire mesh infill and wood toprail
- (17) Permeable Paving/Tree Drainage Zone**

**DOGPATCH ARTS PLAZA
TYPICAL DAY SITE PLAN**

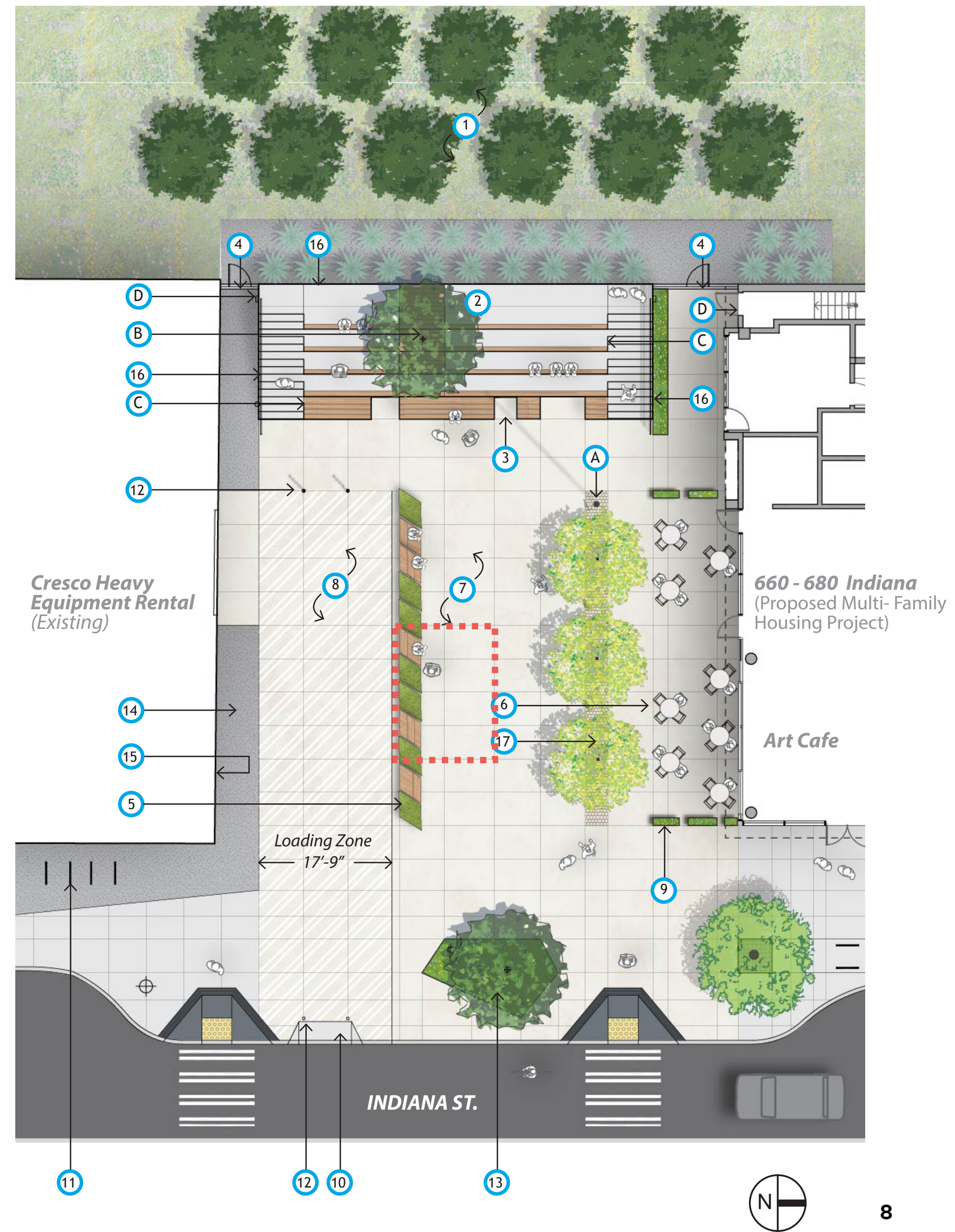

SITE LIGHTING

- A Mast Light**
- B Tree Light**
- C Step Light**
- D Bleacher Security Light**

SITE ELEMENTS

- 1 Caltrans Embankment**
Landscape improvements- tree planting (within Caltrans R.O.W.)
- 2 Urban Bleacher**
Concrete bleacher with corten facing, wood seats and single specimen tree
- 3 ADA Accessible Seating Locations**
4 Spaces total
- 4 Security Fence and Gate**
- 5 Custom Moveable Seating & Planters**
- 6 Designated Area for Cafe Tables and Chairs**
Furnishings not in project scope, to be provided by cafe owner
- 7 Plaza Floor & Designated Area for Large Scale Art Installations**
High quality cast in place concrete with ground finish
- 8 Loading Zone**
Painted loading zone
- 9 Metal Planters at Cafe**
Provided by cafe owner
- 10 Curb Cut - Vehicle Access (10'-0" Wide)**
Limited access for Cresco Equipment Rental and plaza programs.
- 11 Bike Racks**
SF city standard bike racks
- 12 Removable Bollards**
Plaza bollards deployed during business hours to limit pedestrian access. Removed nights/weekends and during events.
- 13 Tree Planting**
Specimen tree and planting area
- 14 Gravel Apron**
- 15 Gallery Wall at Cresco Building**
- 16 Guardrail and Handrail**
Wire mesh infill and wood toprail
- 17 Permeable Paving/Tree Drainage Zone**

DOGPATCH ARTS PLAZA EVENT DAY SITE PLAN

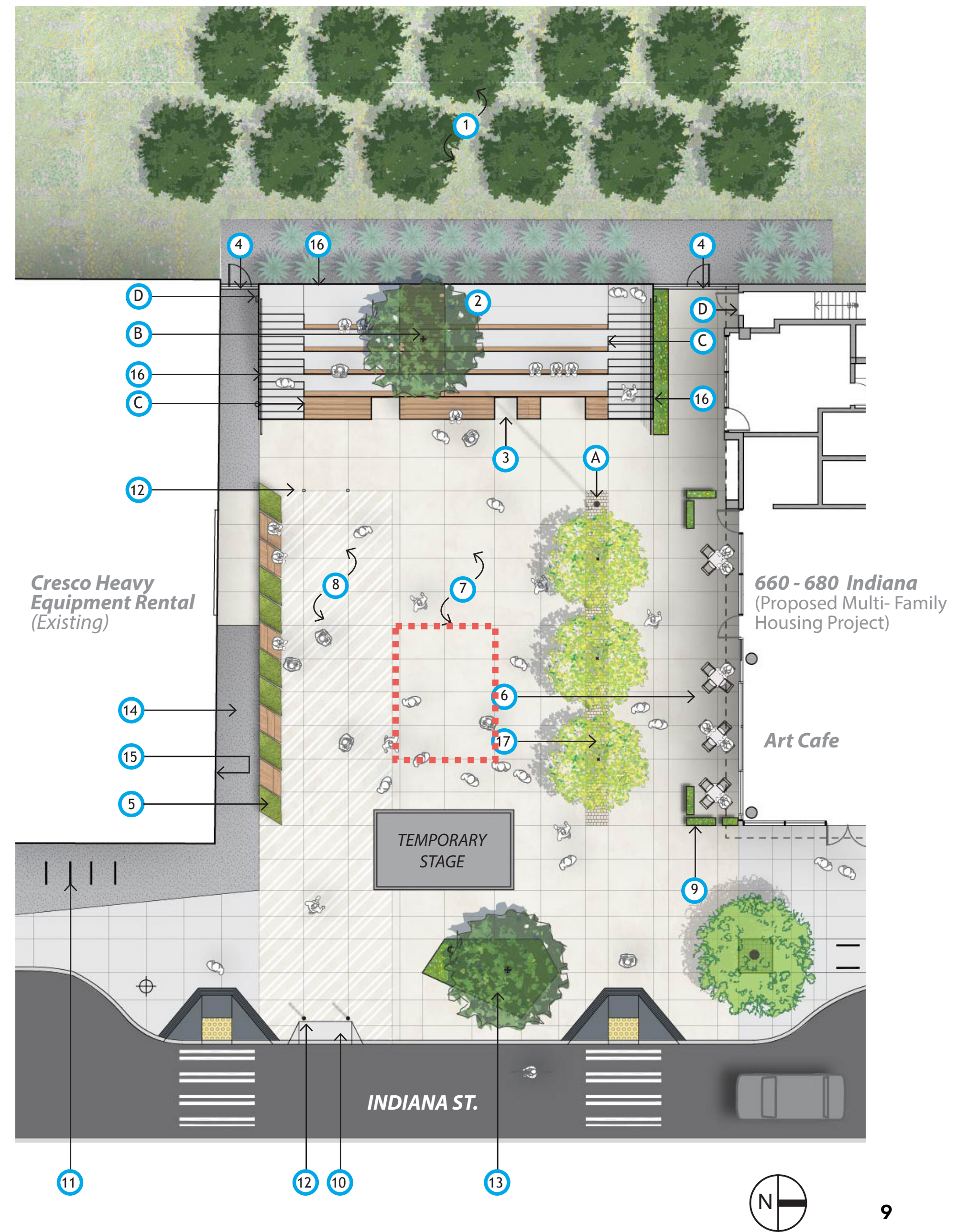

The Centaur

The Centaur was originally created as part of Celtic Forest, Kimpton's sculptural debut at Burning Man in 2007. Celtic Forest was an environment where the elements of nature, earth, wind, water and fire, literally and figuratively represented, are balanced with the human senses. Kimpton partnered with Antonio Ruperto to craft three sculptures of gods and goddesses representing the elements. The sculptures created are the Goddess of Air, Belissima; the Goddess of Water, the Mermaid Boann; and the God of the Earth, **the Centaur**. Each god was surrounded by steel moats with fire created with propane fire effects. Kimpton states "the sculptures are half-human animal and half-animal, symbolizing that we need to tune into the animal side of our nature. Humans are animals too." Kimpton and her crew won two honorarium grants from Burning Man for Celtic Forest.



Physical Specs

- The Centaur is created out of recycled steel toolboxes claimed from the dump in Petaluma, CA.
- Approximately 8' tall, 6' in diameter.
- Weighs approximately 400 lbs.



Installation

- The sculpture will be installed as soon as plaza construction is complete (late-July/early-August) and should take less than one day.
- The sculpture is stored in three parts, which allows for easy shipping and installation. The circular base of the piece is composed of steel and is designed to tether the sculpture to the foundation.
- The plaza has been designed with a 12'x18' reinforced cast-in-place concrete foundation specifically to support large scale installations such as this. The sculpture will be bolted directly into the concrete foundation with wedge anchors.



Operations & Maintenance

- The Centaur will be installed in August 2017 for up to one year.
- Friends of Dogpatch Arts Plaza, the nonprofit plaza steward, will maintain insurance for the duration of the Centaur's display.
- Dogpatch Arts Plaza is a public right-of-way and is under the jurisdiction of Public Works. The project sponsor has been issued a Major Encroachment Permit that authorizes artwork to be installed in the plaza pending Arts Commission approval.
- Maintenance of the Centaur should be minimal; the artist will be available to aid in any necessary maintenance.





About the Artist

Laura Kimpton's work consists of painting, mixed-media installations and sculpture. Her creativity stems from a desire to question traditional views on social interaction, invoking through her art a reaction and discussion from her viewers that ultimately complete her projects. Kimpton is always exploring new mediums in her search for invigorating means of communication. Kimpton lives in Fairfax, California.



Other Work

Kimpton is the conceptual force behind the Monumental Word Series that began at Burning Man in 2009. Jeff Schomberg has collaborated with Laura in building and installing her revolutionary conceptual designs. Viewers are encouraged to interact with each sculpture on their own terms. These sculptures often evoke varied emotions and interpretations, and can mean different things to different people.

Kimpton's sculptures have been purchased by civic municipalities and private collectors across the United States, as well as internationally in Puerto Rico and China. Articles on and images of Kimpton's work have been featured in Rolling Stone, Huffington Post, the Press Democrat, Town and Country, SF Magazine and Inc, to name a few.



Thank You.

