



**FIRESTATION #35 ARTIST SELECTION PANEL ONE
MEETING 2 SUMMARY**

MEETING DATE

January 25, 2019

VOTING SELECTION PANELISTS

Joseph Becker, Associate Curator of Architecture and Design, San Francisco Museum of Modern Art

Michele Carlson, Executive Director, Art Practical

Dan Hodapp, Senior Waterfront Designer, Port of San Francisco

Alan Kawaski, Principal, Shah Kawaski Architects

Jim Maxwell, Principal Architect, Architects II

**Jeanine R. Nicholson, Deputy Chief of Administration, San Francisco Fire Department

Barbara Sklar, Arts Commissioner

Weston Teruya, Artist

PROCESS

The following artists presented an overview of their practice and proposals for the Golden Gate Park Artist Selection Panel:

Lead Pencil Studio

Hood Design Studio Inc.

Mark Reigelman

Adrien Segal

The panelists were asked to discuss and evaluate each of the proposals on the following criteria:

- Aesthetic quality
- Appropriateness of the proposed artwork for the site and project goals
- Demonstrated feasibility of the preliminary proposal and the proposal budget
- Demonstrated maintainability and durability of the artwork's design, materials, fabrication and installation methods

The panelist then ranked the artists 1, 2, or 3 (1 = highest rank) accordingly.

RESULTS

Hood Design Studio LLC

Lead Pencil Studio

Mark Reigelman

Adrien Segal

ARTS COMMISSION APPROVAL

Motion: Motion to approve the selected artist Hood Design Studio LLC for Firestation #35 public art opportunity, as recommended by the artist selection panel.

Motion: Motion to authorize the Director of Cultural Affairs to enter into contracts with the selected artist Hood Design Studio LLC for an amount not to exceed \$560,000 for design, engineering, fabrication, transportation and installation of an artwork for Firestation #35.



Concept

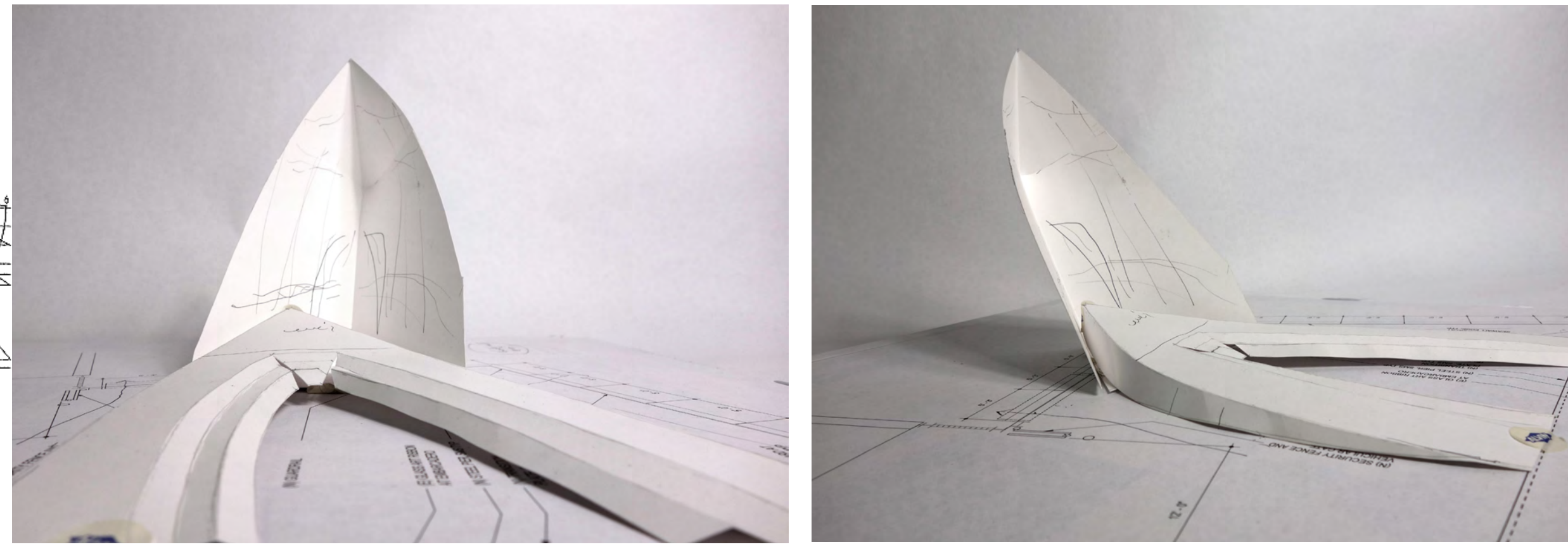

Concept Models

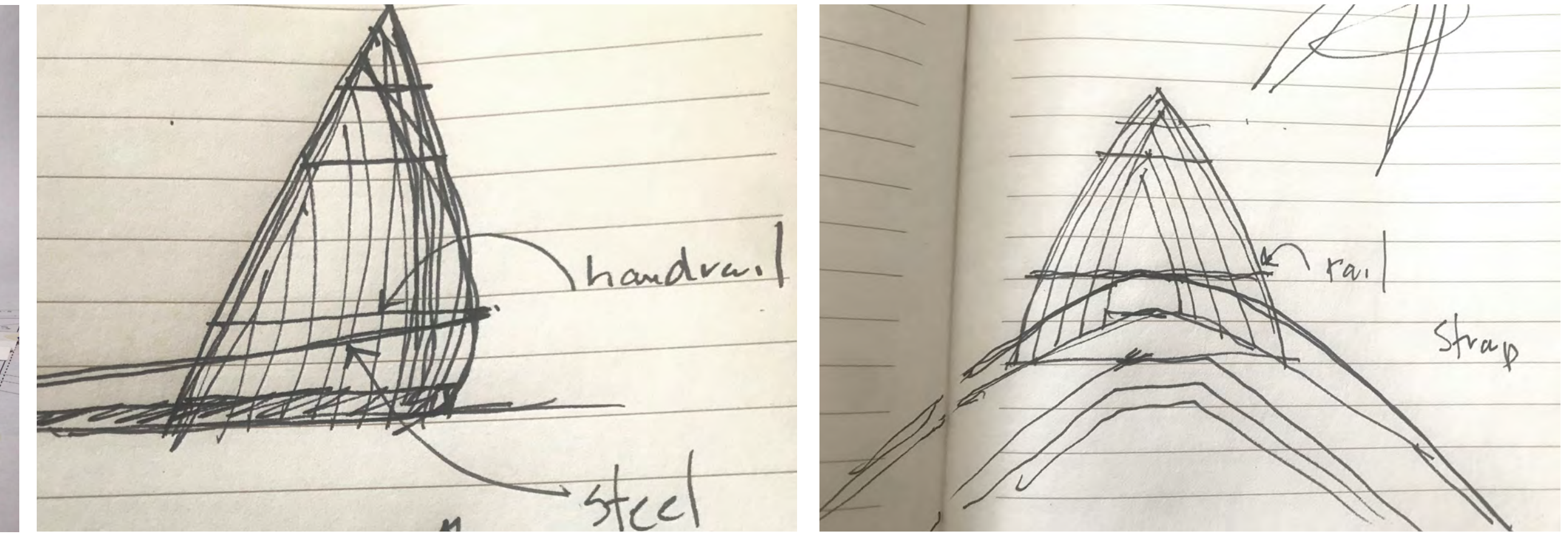

Concept Sketches

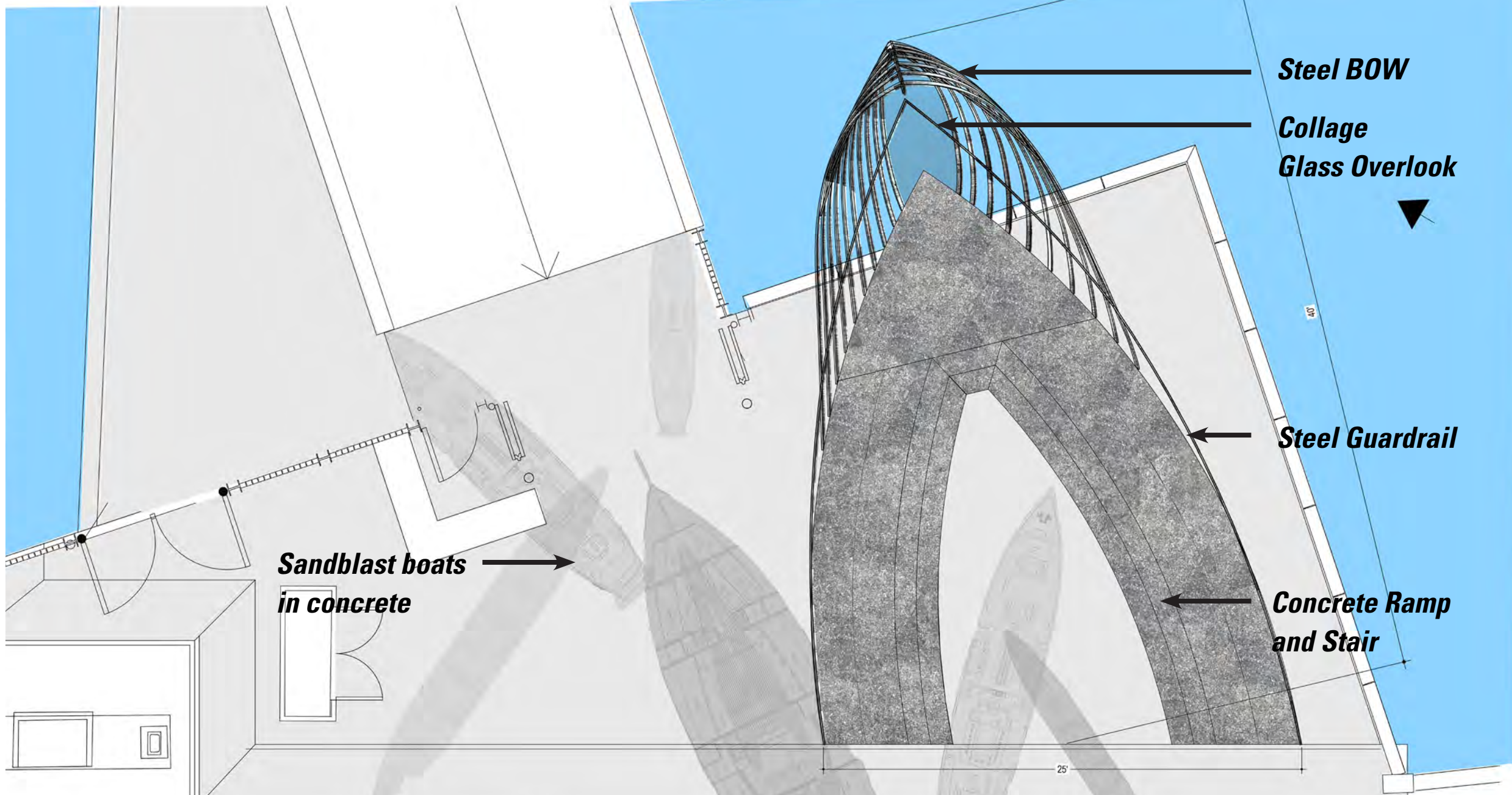

Site Plan



View From Bay



View Walking South East Down Embarcadero

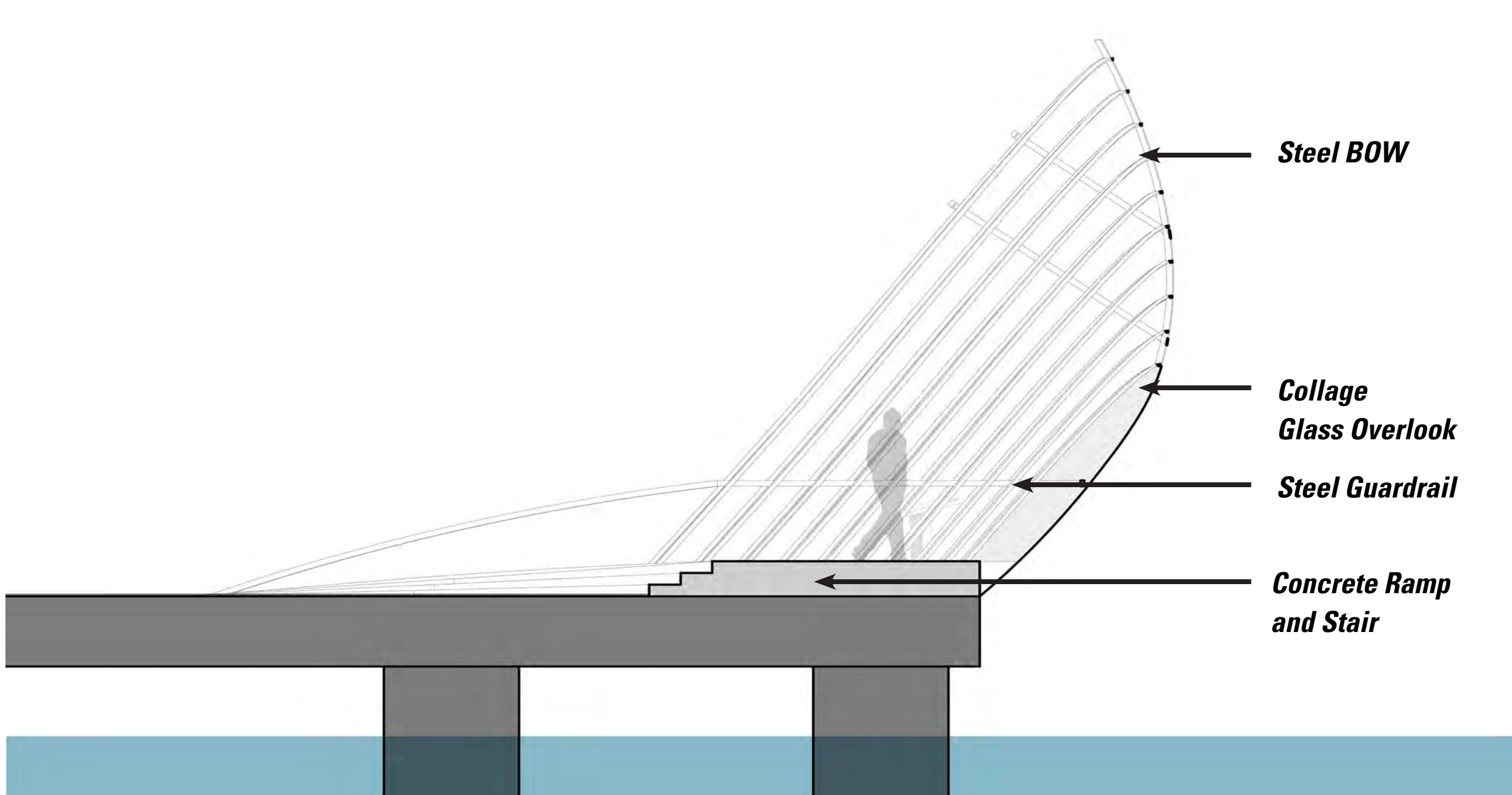

Site Section



View From Collage Overlook



View From Harrison Street

Inspiration for BOW came from the form and craft of the fire boats --their role in the cultural history of the City of San Francisco, especially the Loma Prieta Earthquake. Additional inspiration came from being out on the water with the crew of Fire Station #35 and the sunken and buried ships that shape the City has been built over. BOW is a sculpture to showcase and commemorate this unseen cultural history of the fireboats of the City of San Francisco. It serves as both a visually striking element along the Embarcadero and the Bay, an overlook and a resting place.

The sculpture itself 36' x 35' x 24' is the form of an abstracted hull of a boat. It is set on the edge of the pier deck oriented with the overlook towards the Bay. An accessible ramp and stair bring people from the sidewalk to a collaged overlook providing a place for people to sit and enjoy the spectacular bay views and the daily operations of the fireboats of Fire Station #35.

The glass panels at the overlook collage combine images and quotations to illuminate the cultural importance of Fire Station #35. The collage layers of images from the fireboats, historic maps and boats the Bay, quotes from the Loma Prieta Earthquake and the crew of Fire Station #35 over a background of the new Fire Station #35, the Bay and the Bridge creating a three dimensional, living collage that showcases Fire Station #35 and its role in the shaping the cultural landscape and history of the city.

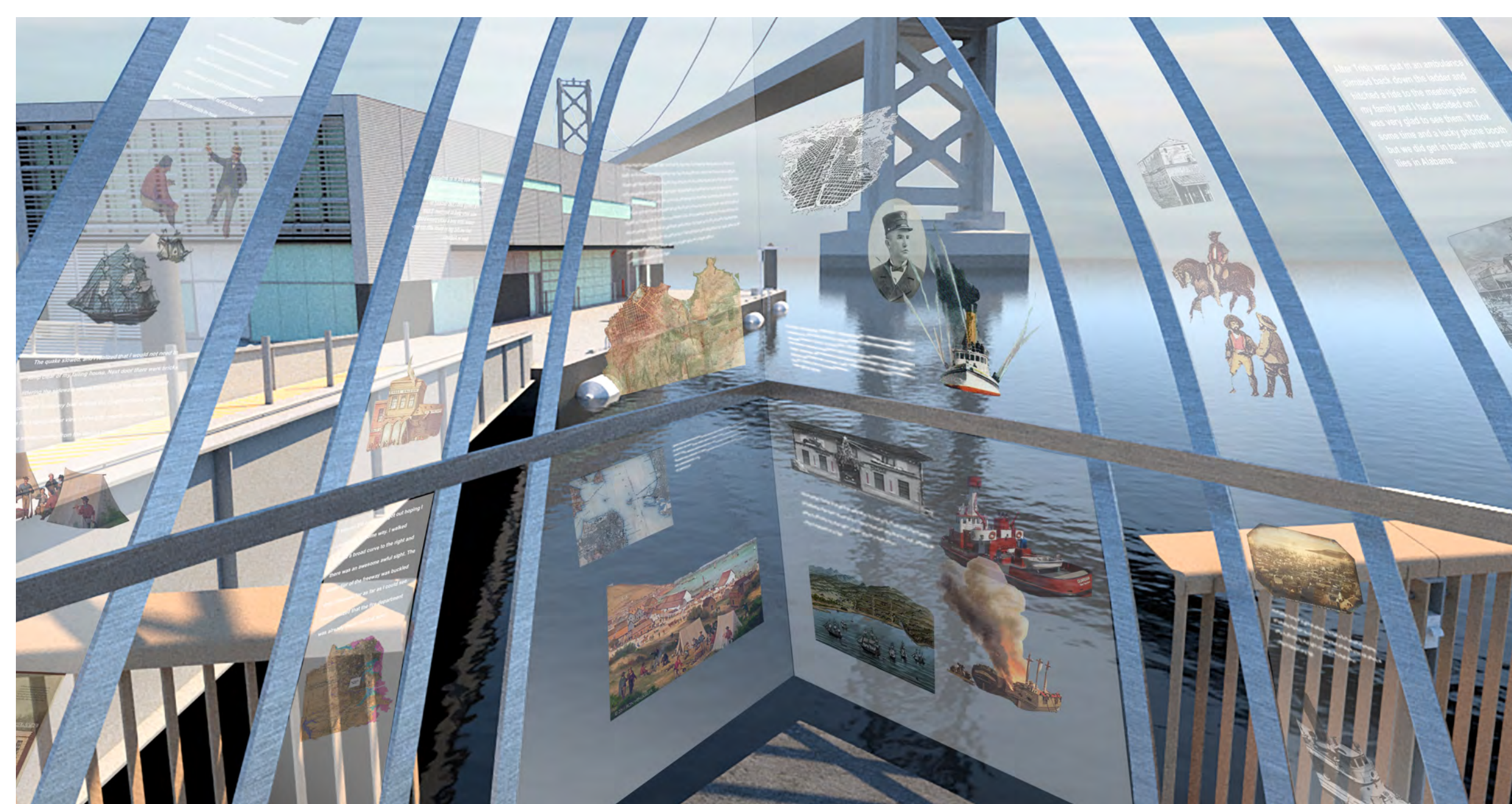

Commemoration

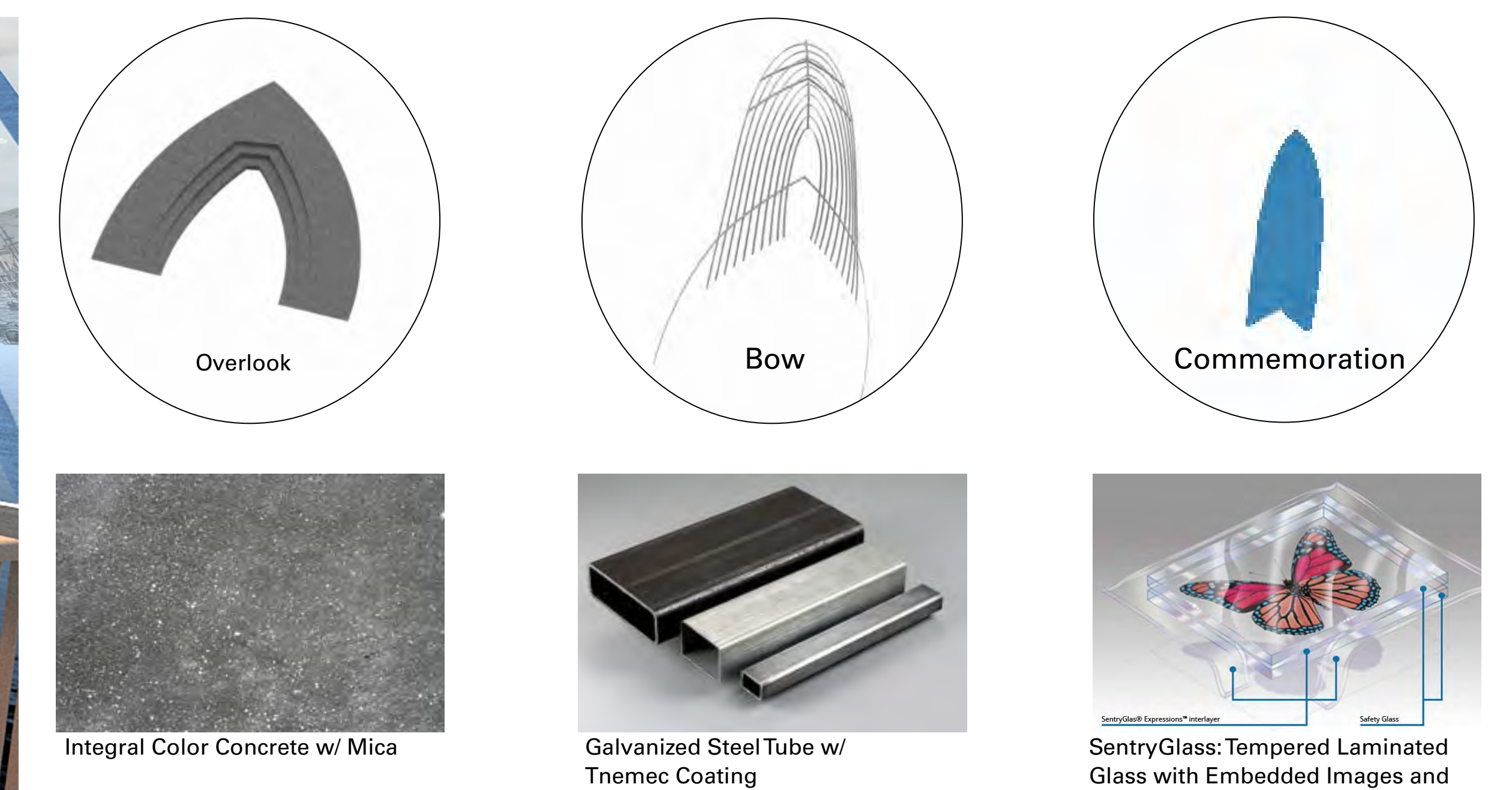

Material

BOW

Art Proposal for the Fire Station #35 Public Art Project

November 9, 2018



SentryGlass: Tempered Laminated Glass with Embedded Images and Quotations