



**POTRERO GATEWAY PARK PUBLIC ART PROJECT
ARTIST REVIEW PANEL TWO SUMMARY**

MEETING DATE

June 14, 2021

VOTING SELECTION PANELISTS

Jean Bogiages, Potrero Gateway Steering Committee
Jennifer Easton, Art Program Manager, BART Planning, Development + Construction
Jasmin Kaw, Landscape Architect, Building Design and Construction, SF Public Works
Michael Kerbow, Potrero Gateway Park Steering Committee
Janine Shiota, Arts Commissioner
Sheldon Trimble, Potrero Gateway Park Steering Committee
Patricia Cariño Valdez, Arts Professional

PROCESS

Three artist finalists presented their proposals for the Potrero Gateway Park Public Art Project. The Artist Review Panel discussed the finalists' proposals and scored each artist on the following criteria (1= low score):

Artistic Merit (1-5)
Assessed Ability to Meeting the Project Goals (1-5)
Appropriate to Site (1-3)
Feasibility and maintainability (1-10)

RESULTS

Machinic LLC (DBA Futureforms)	128
Aileen Barr and Colette Crutcher	110
Randy Colosky	94

ARTS COMMISSION APPROVAL

Discussion and Possible action: to approve artist Machinic LLC (DBA Futureforms) and proposal for the Potrero Gateway Park Public Art Project, as recommended by the artist review panel.

Discussion and Possible action: to authorize the Director of Cultural Affairs to enter into contract with artist Machinic LLC (DBA Futureforms) for an amount not to exceed \$217,000 for design, fabrication, transportation and installation of an artwork at Potrero Gateway Park.

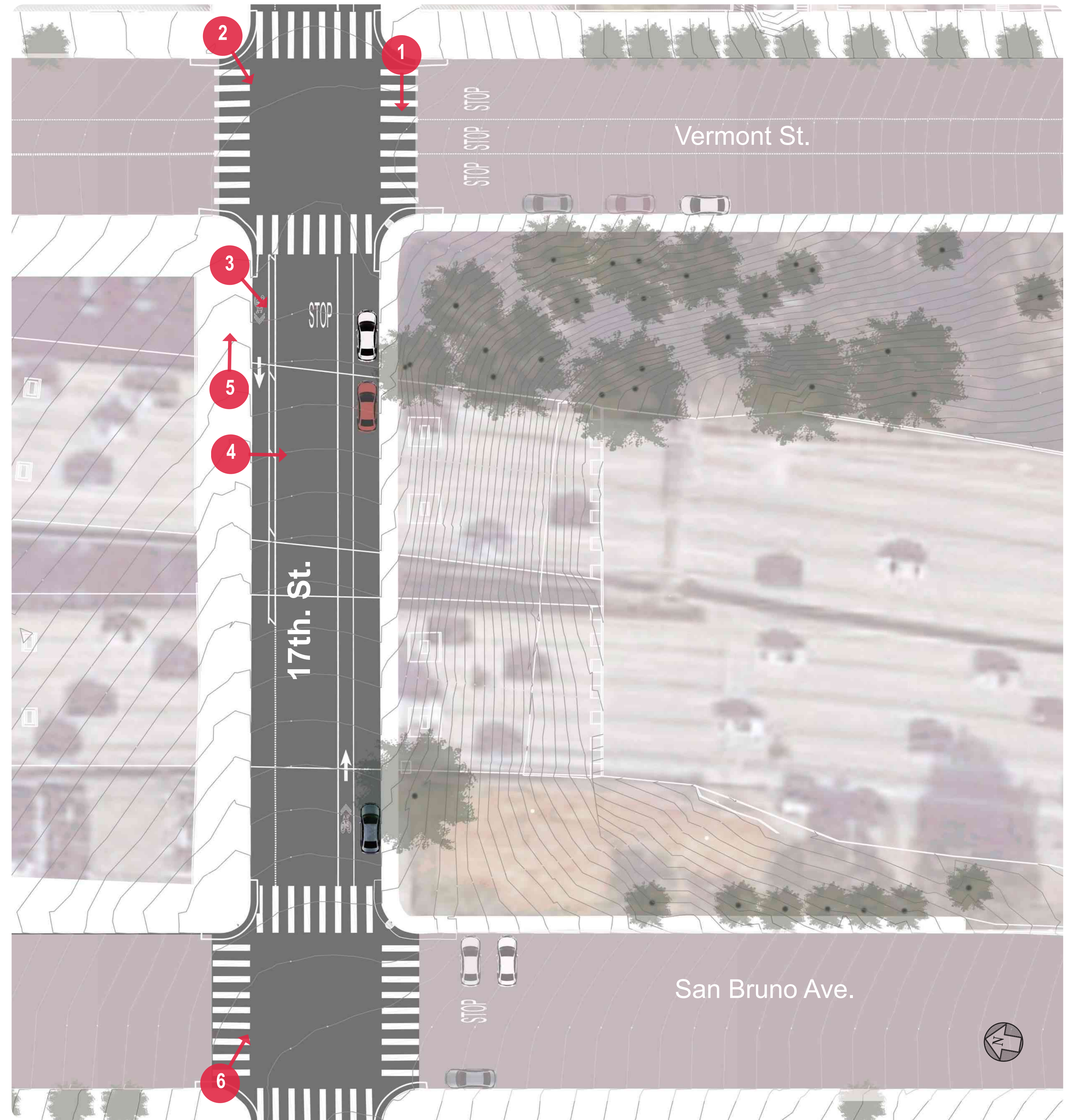
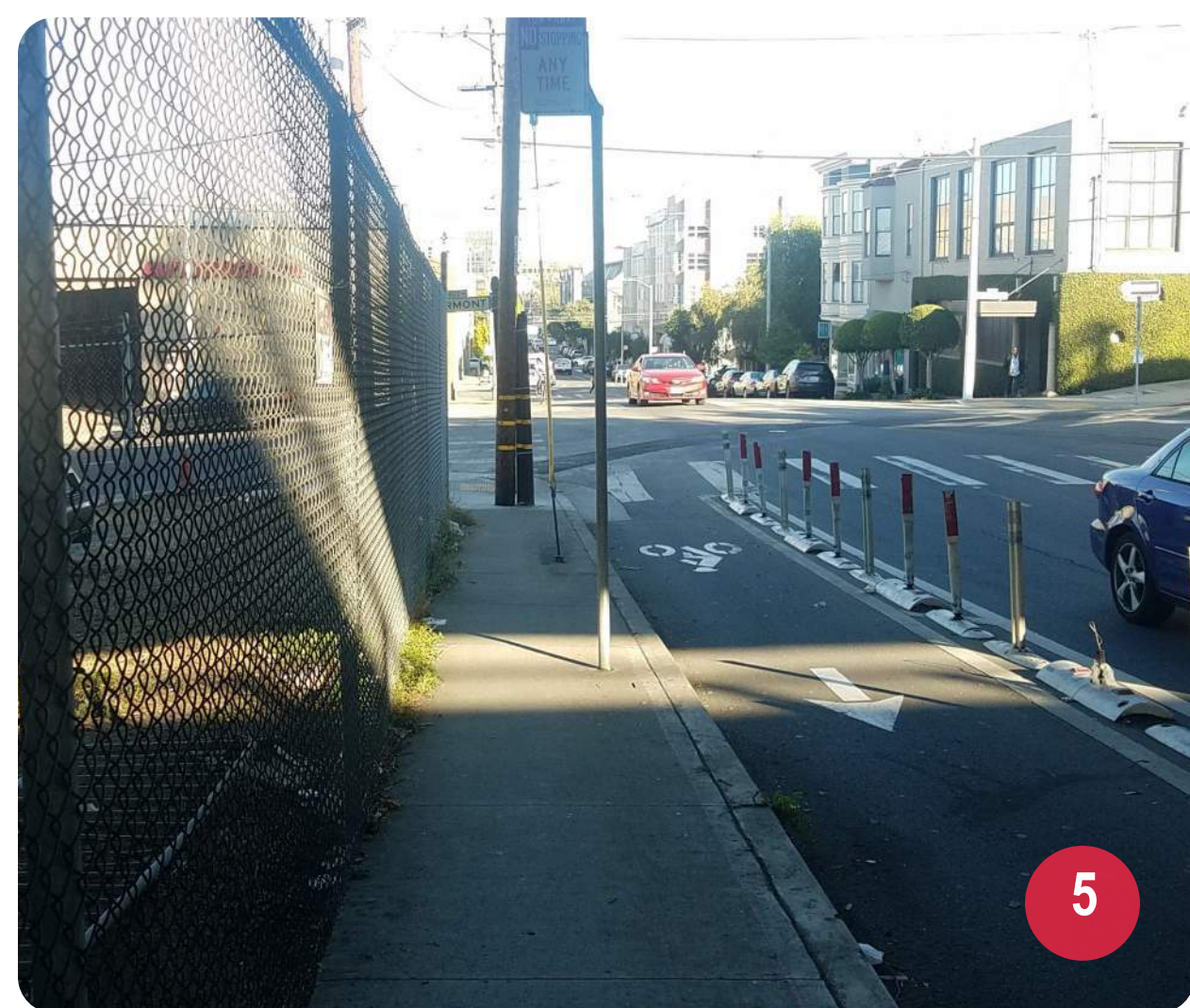
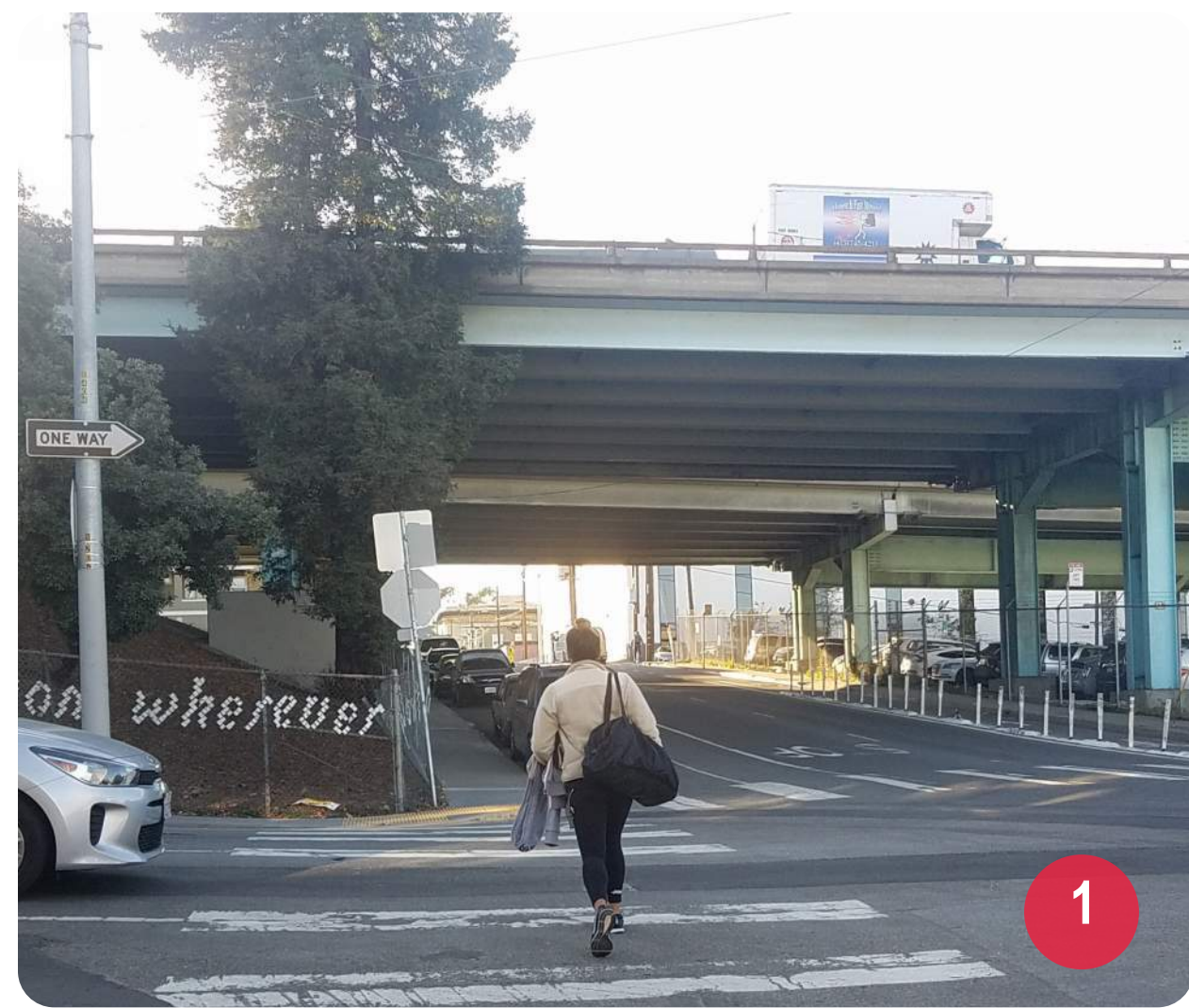

NO.	DATE	DESCRIPTION	BY	APP.
TABLE OF REVISIONS				
THIS DRAWING WAS LAST MODIFIED: 10/29/20 12:47, BY: CRodrig				

REFERENCE INFORMATION & FILE NO. OF SURVEYS



SAN FRANCISCO PUBLIC WORKS
 BUILDING, DESIGN AND CONSTRUCTION
 CITY & COUNTY OF SAN FRANCISCO
 49 SOUTH VAN NESS AVENUE, SUITE 1000
 SAN FRANCISCO, CA 94103

Bureau Mgr: JENNIFER COOPER	XX	Date: xxx/xxx/xx
Acting Deputy Director & City Architect RON ALAMEIDA	XX	xxx/xxx/xx
		xxx/xxx/xx

DESIGNED: JK	DATE:
DRAWN: CR	DATE:
CHECKED:	DATE:

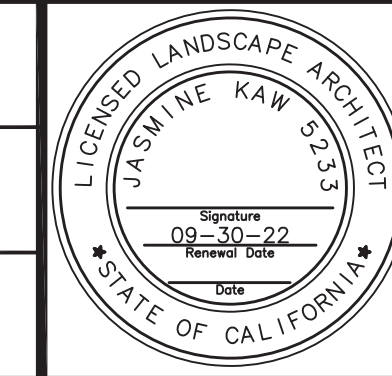

SCALE:
AS SHOWN
SHEET OF SHEETS

**POTRERO GATEWAY
 STREETSCAPE IMPROVEMENTS**

**EXISTING CONDITIONS - 17TH STREET
 35% SUBMITTAL - NOVEMBER 2020**

CONTRACT NO. 10032040
DRAWING NO. EX-0.0
FILE NO. XXXXX
REV. NO. 0

VERMONT ST.

VERMONT ST.

Art Opportunity 1

Freeway Overpass

Art Opportunity 3

Art Opportunity 2

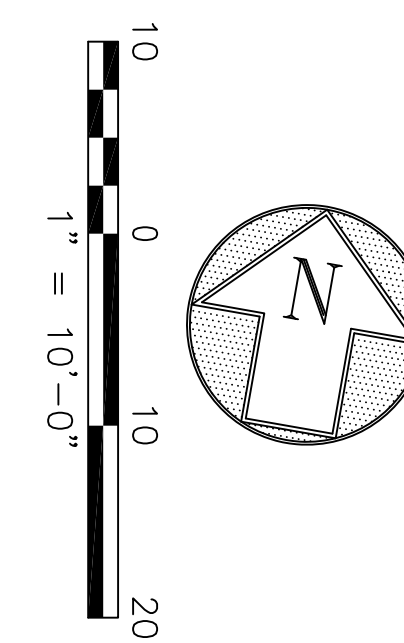

SAN BRUNO AVE

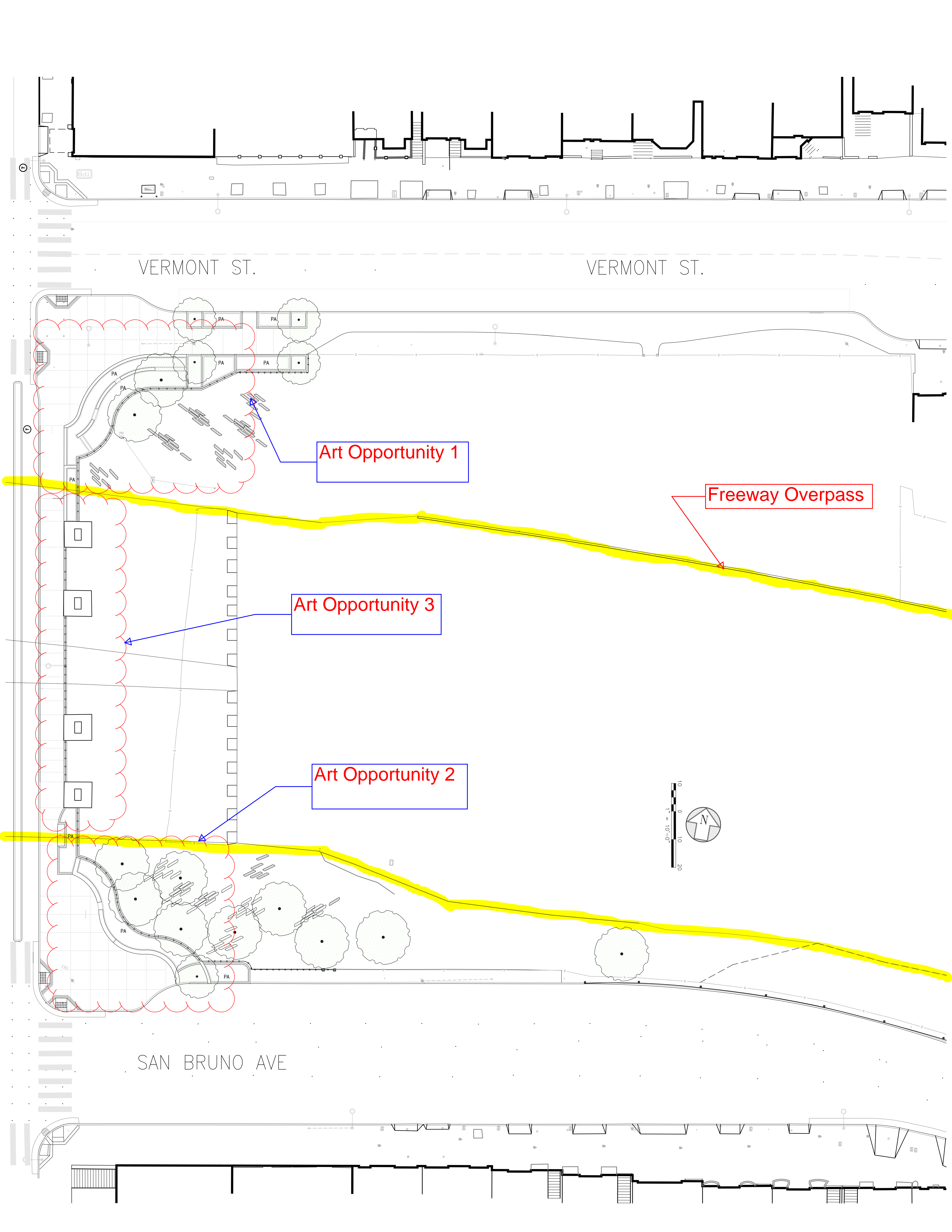

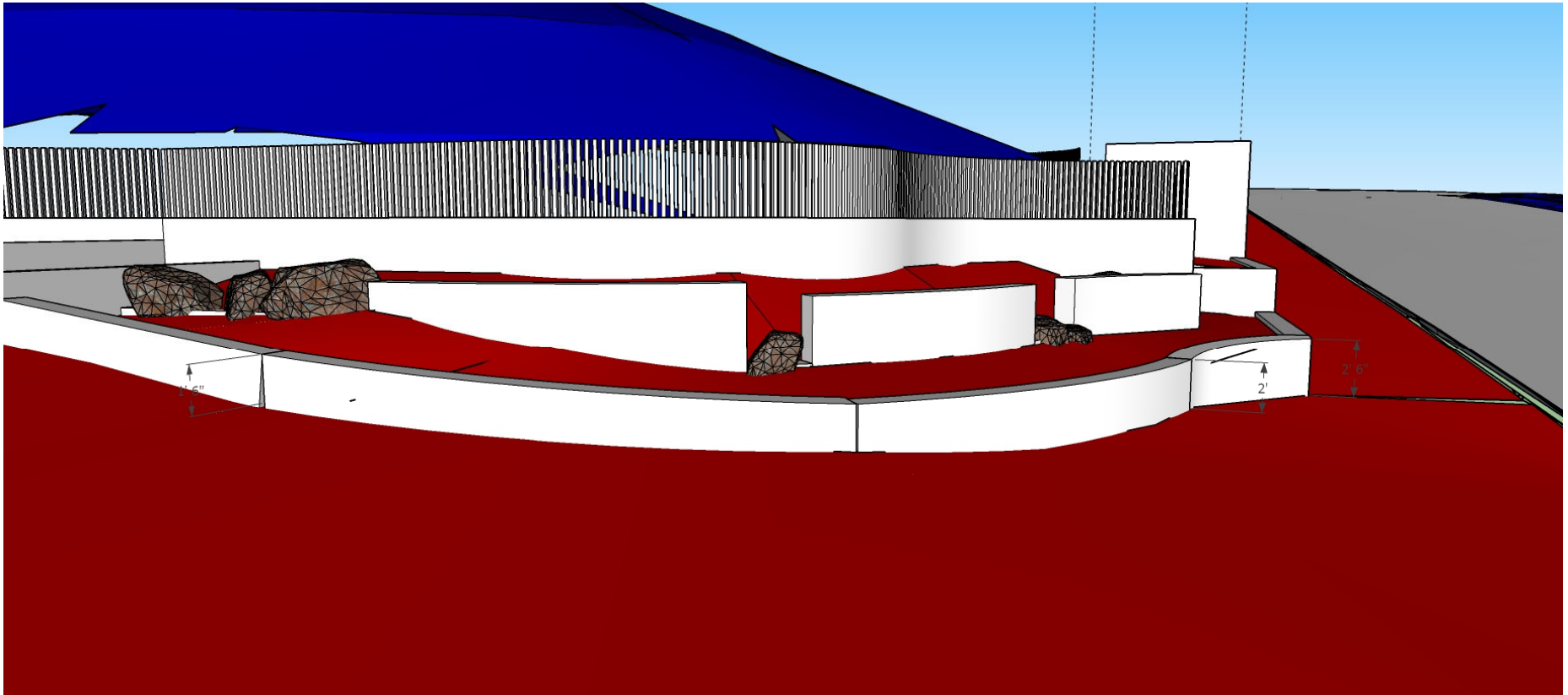

Vermont Street and 17th. Street Corner
3D Sketch Study in Progress, 3/10/2021

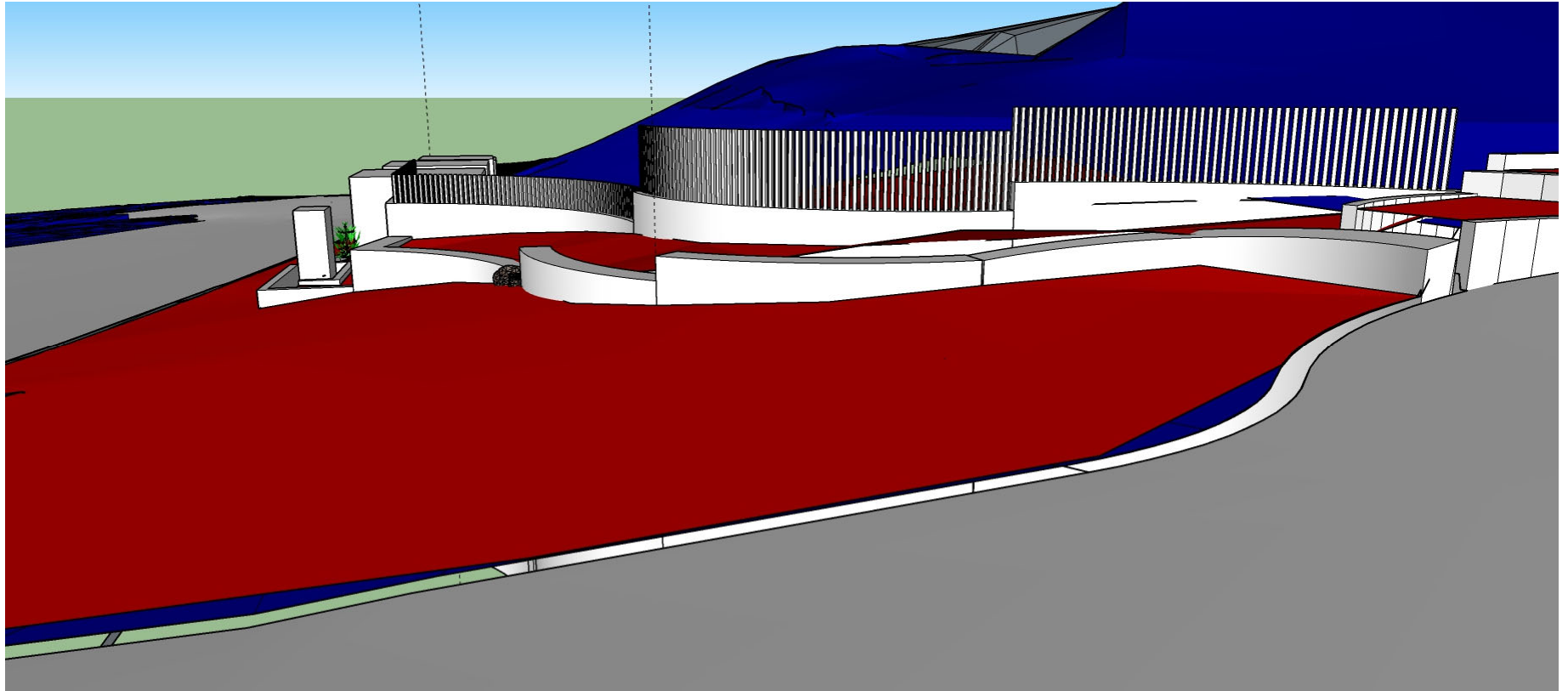

San Bruno Ave. and 17th. Street Corner
3D Sketch Study in Progress, 3/10/2021



POTRERO GATEWAY Public Art Proposal

Artists: Jason Kelly Johnson &
Nataly Gattegno (Futureforms)

6/14/2021



Rather than create a single monumental gateway, this collection of **sculptural planted objects** celebrate local habitat networks by placing them front and center.

The planted artworks help reinforce the neighborhood's desire to build community around **art, ecology and public space**. These sculptural objects are meant to promote the interaction of plants, insects, birds and humans.



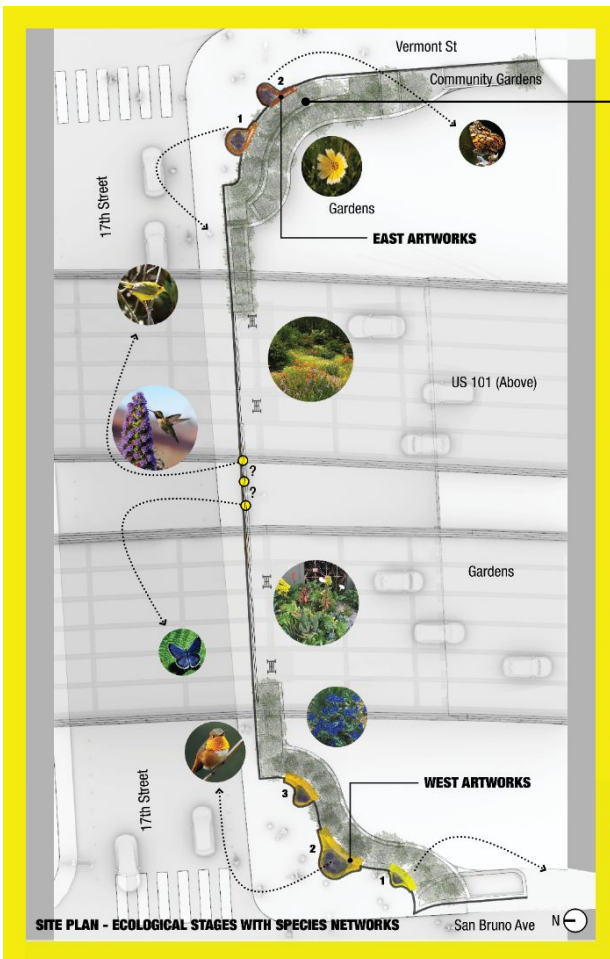

Each planter in this network creates a unique **“ecological stage”** for the interaction of **plants, insects, birds and humans**. Like pearls on a necklace, each woven stage is planted to create an attractive stepping stone for species populations.

These **curvaceous waystations** stitch the site together along and help complete the **Potrero Loop concept and biodiversity restoration**. They help tie together future community gardens along Vermont Street and the Potrero Gateway Eco-patch, Benches Park, Fallen Bridges Park, and future gardens along San Bruno.

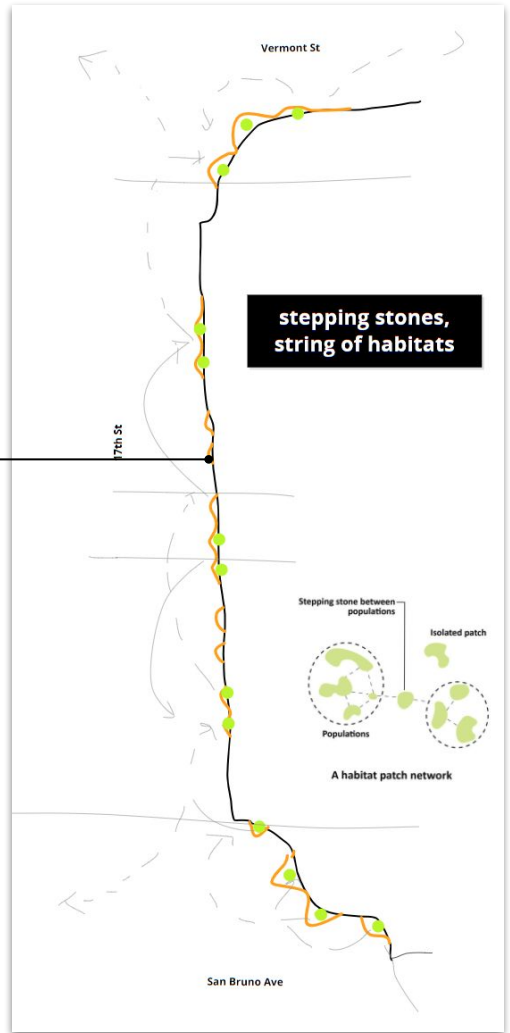

Concept | Ecological Stages



WEST

- W1 = 11' X 6' X 8'
- W2 = 17' X 11' X 9'
- W3 = 13' X 8' X 8'

EAST

- E1 = 7' X 13' X 9'
- E2 = 7' X 12' X 11'

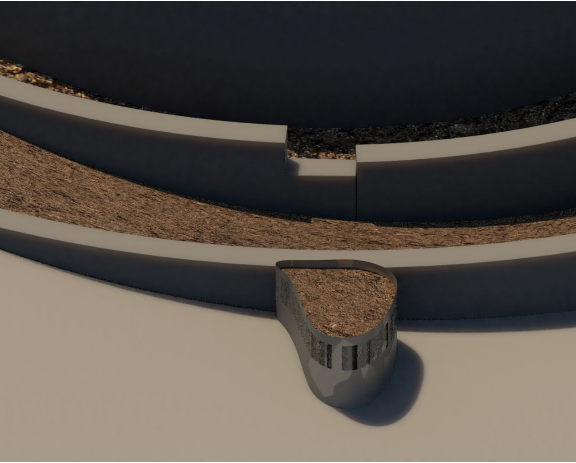

1. 1/4" Galvanized Steel Plant Wells allow roots to grow into the ground

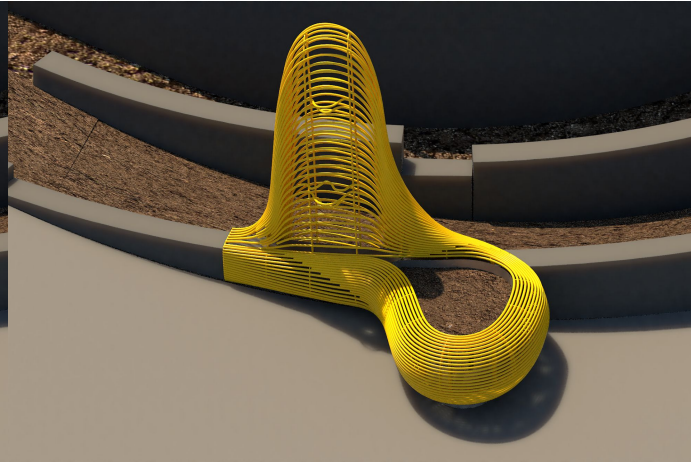

2. Sculptural elements are bolted to both the plant well and the retaining wall

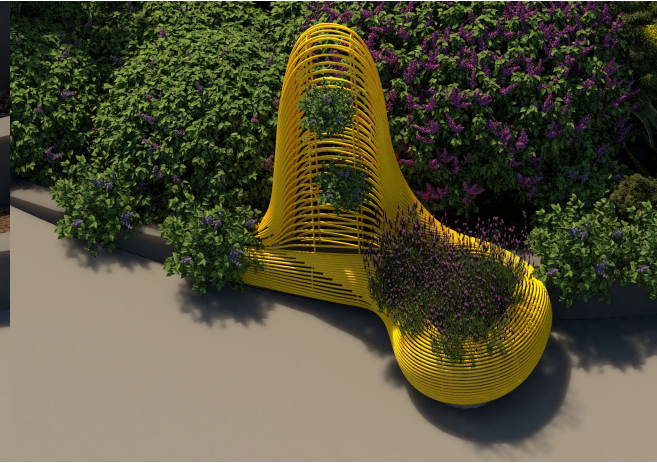

3. Soil, plantings, irrigation and lighting are incorporated by SFPW and the community

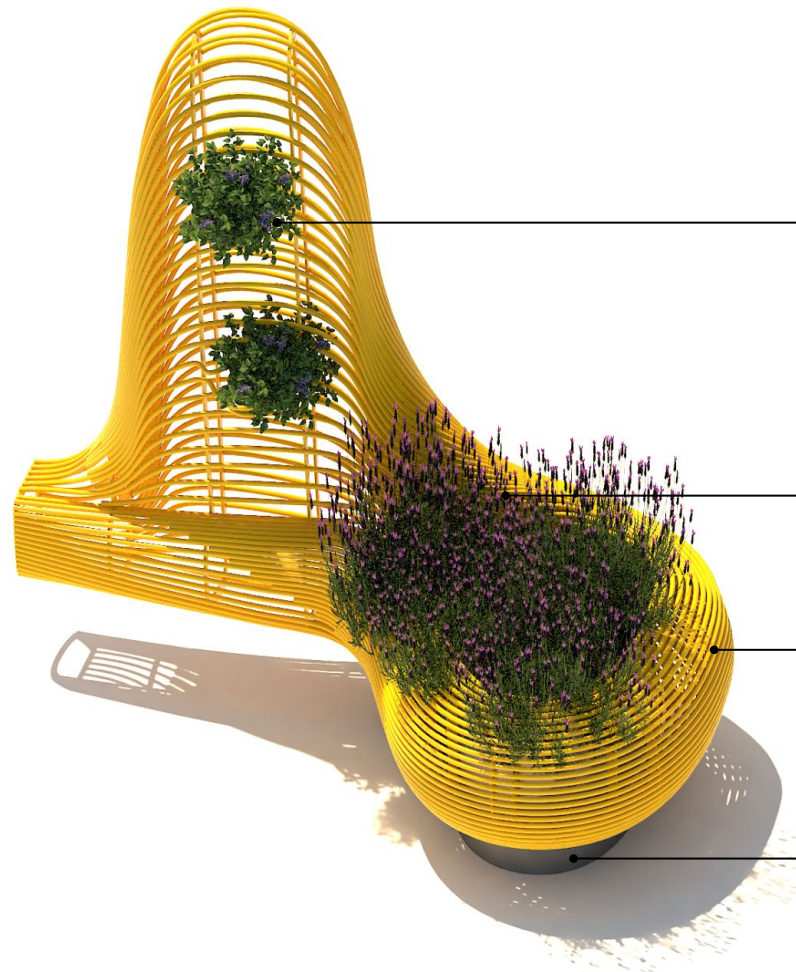

Pockets for succulents and flowering hanging plants.

Deep well planter “stages” for hummingbirds and butterflies

1” diameter steel tubing and 0.25” thick laser-cut ribs with 3-part Fluoropolymer “Tnemec” epoxy based paint system

¼” Galvanized Steel Plant Wells allow roots to grow into the ground

Sculptural Planters | Technical Concepts

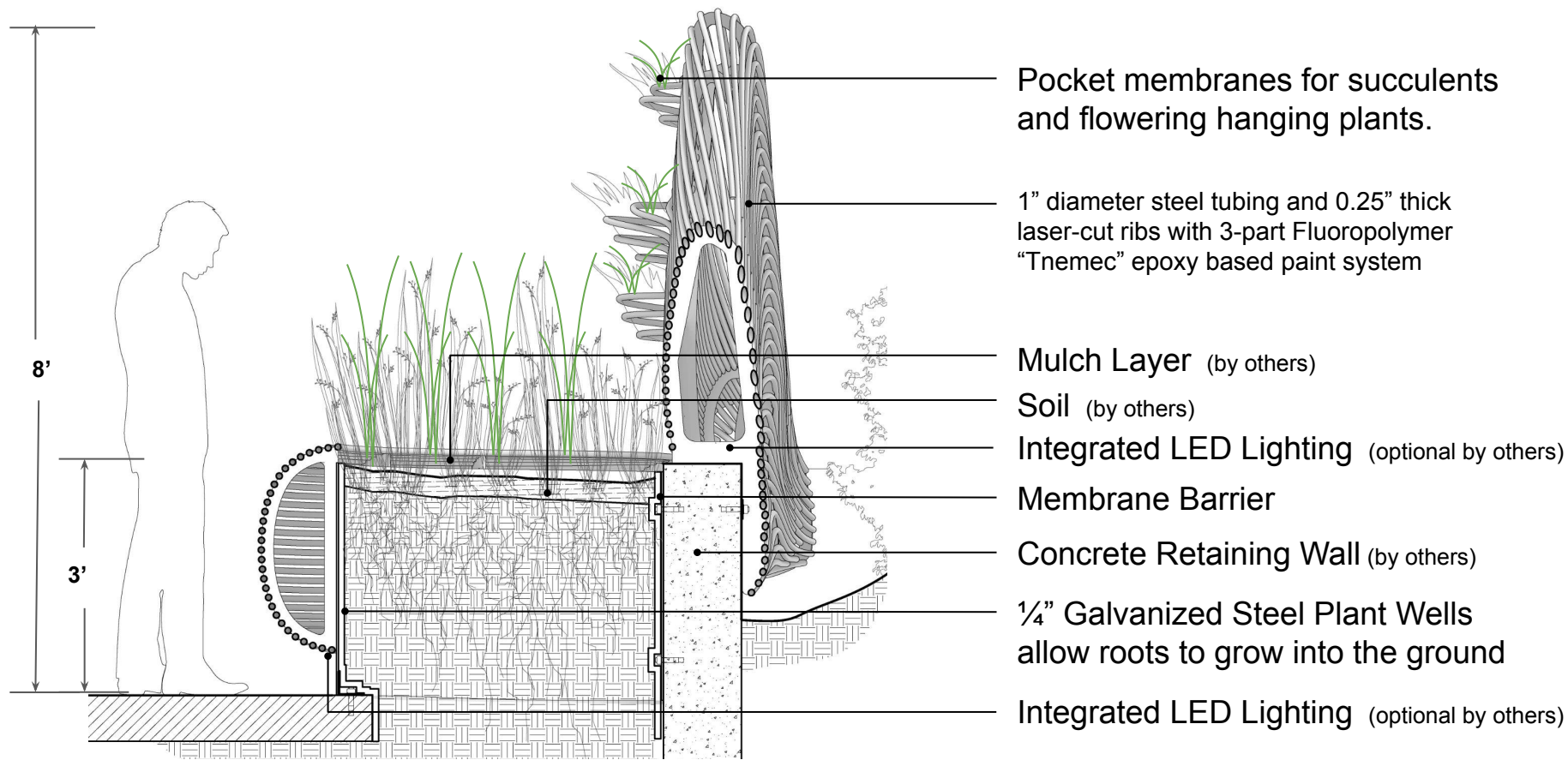

Typical Sectional | Concept

Note: Thanks to *Fletcher Studio Landscape Architects* for their initial consultation. We would work with SFPW, Community Partners, Maintenance and others to ensure design is functional and easy to maintain.

