

LADY BAYVIEW ART PROPOSAL for 900 INNES

Presented by Raylene Gorum

While the history of this site at the water's edge in Bayview is one that has been subjected to the turbulent tides of economics, racism, displacement and environmental abuse, it is also notably buoyed by the ingenuity, resilience and joy of the people who have lived, worked and built community here. This well situated bay port has a remarkable history. First home to an indigenous community, it has since supported each successive population in waves that mirror the story of America itself. It is my aim to create a work for this former shipwright's perch which speaks to this many layered maritime past in the context of a good spirited guardian figure who holds the tides of change in a gentle embrace.



SITE PLAN DRAWING



COMPUTER-GENERATED IMAGE OF THE SITE WITH PROPOSED ARTWORK BY RAYLENE GORUM

Lady Bayview is inspired by the strong female African-American leaders in the community, particularly those known as the **Bayview Five** who successfully advocated for better housing, health and labor issues, local theater and more. Lady Bayview is a tangible representation and reminder of that nurturing strength and serenity in the midst of storms.

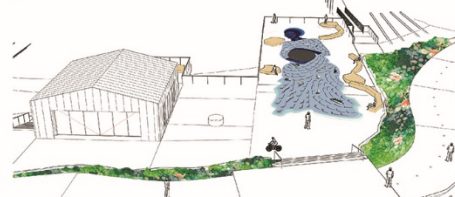

Every seafaring culture has looked to a benevolent guardian to protect them from the perils of the sea and to express gratitude for the bounty provided. As this site has a maritime history dating back thousands of years since the time of the Ohlone and has served as a modern boat yard for the last 150 years, it seems fitting to give India Basin and the surrounding BVHP community their own talisman, Lady Bayview, to tell the history of the people who built their lives, their ships and their community in India Basin. It is a story of displacement, collaboration, commerce and our water based connection to the rest of the globe.







3-D DRAWING OF THE SITE

LOCAL SHIP LEGEND

The unique history of Bayview is told in the artwork through the story of the ships built by each successive population that has lived and worked at the water's edge.

-  **OHLONE TULE CANOES:** Hunter's Point was one of the most popular settlements for indigenous Ohlone tribes.
-  **CHINESE SHRIMPING JUNK:** Chinese fishing villages thrived here.
-  **Immigrant boat builders designed scow schooners like ALMA** to deliver goods to the Delta.
-  **Tall BRIGANTINE** ships populated the Bay at the last turn of the century.
-  **Many African-Americans** moved from across the country to Bayview Hunter's Point during WWII to help build **NAVY LIBERTY SHIPS**.
-  **Locally designed wooden PELICAN SAILBOATS**
-  **SF BAY FERRY:** The first ferry crossed the bay in 1826, long before there were bridges!
-  **CARGO SHIP:** Everyday cargo ships can be seen delivering goods from around the world to the Bay.

WIND BARB LEGEND

- 5 knots 
 - 10 knots 
 - 15 knots 
 - 20 knots 
 - 30 knots 
- Sailors refer to wind maps to help them navigate. Wind barbs visually convey the direction and speed of the wind.

MATERIALS:

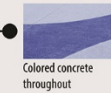

Colored concrete throughout

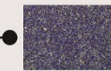

Mirror flecked lithocrete sky



Lithocrete ombre fade at shore edge





