



San Francisco  
Water  
Power  
Sewer

Services of the San Francisco  
Public Utilities Commission

**SEWER  
SYSTEM**

IMPROVEMENT PROGRAM  
**Grey. Green. Clean.**

# SEP Future CAMPUS VISION

September, 2016





# SEP campus identity

Confluence of:

- Technology (SEP + innovation)
- Community (learning + engagement)
- Environment (biophysical + built)

Opportunities:

- need to exchange information
- making the invisible visible



Sidwell Friends School, Washington, D.C.

# SEP campus

## client brief

### Brief:

- Timeless design vocabulary
- Recognizable and contextual
- Scalable, flexible, multi-purpose
- Adaptable - from subtle to bold

### Design approach:

- Integrated & multidisciplinary



Ashdod Port Offices, Israel



Barneveld Noord train station, Utrecht, NL



# SEP campus

making the invisible visible



# SEP campus site overview

An extension of the City grid is used to organize future program, suggest permeability, improve street views, and identify locations for employee focused buildings.

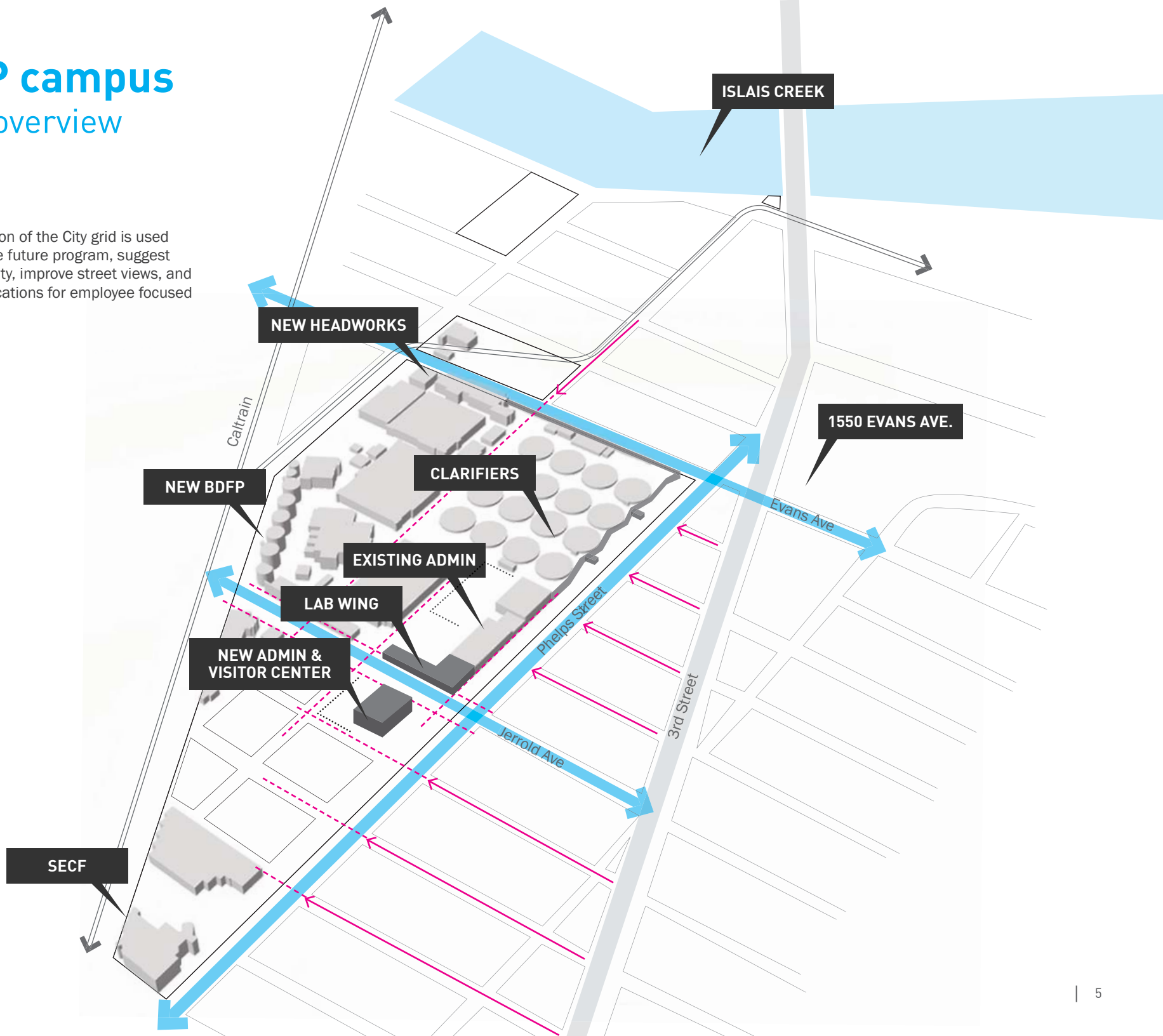

# SEP campus site overview

The design framework defines a site-wide stormwater management plan that includes innovative green infrastructure features such as a large constructed wetland next to the proposed visitor center.

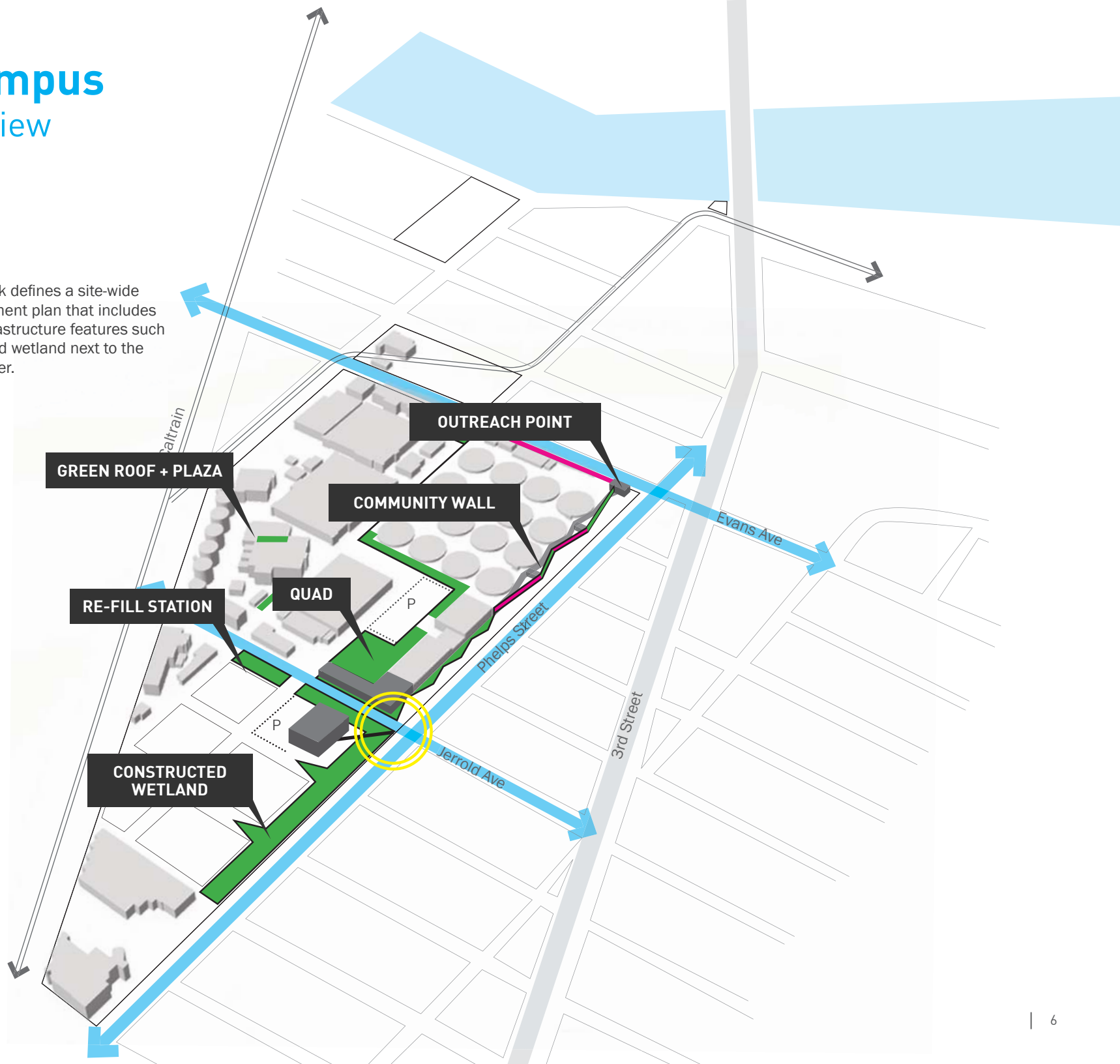



# SEP campus access + security

The design framework locates buildings to establish a relationship with surrounding streets, organizes gateways and identifies perimeter improvements.

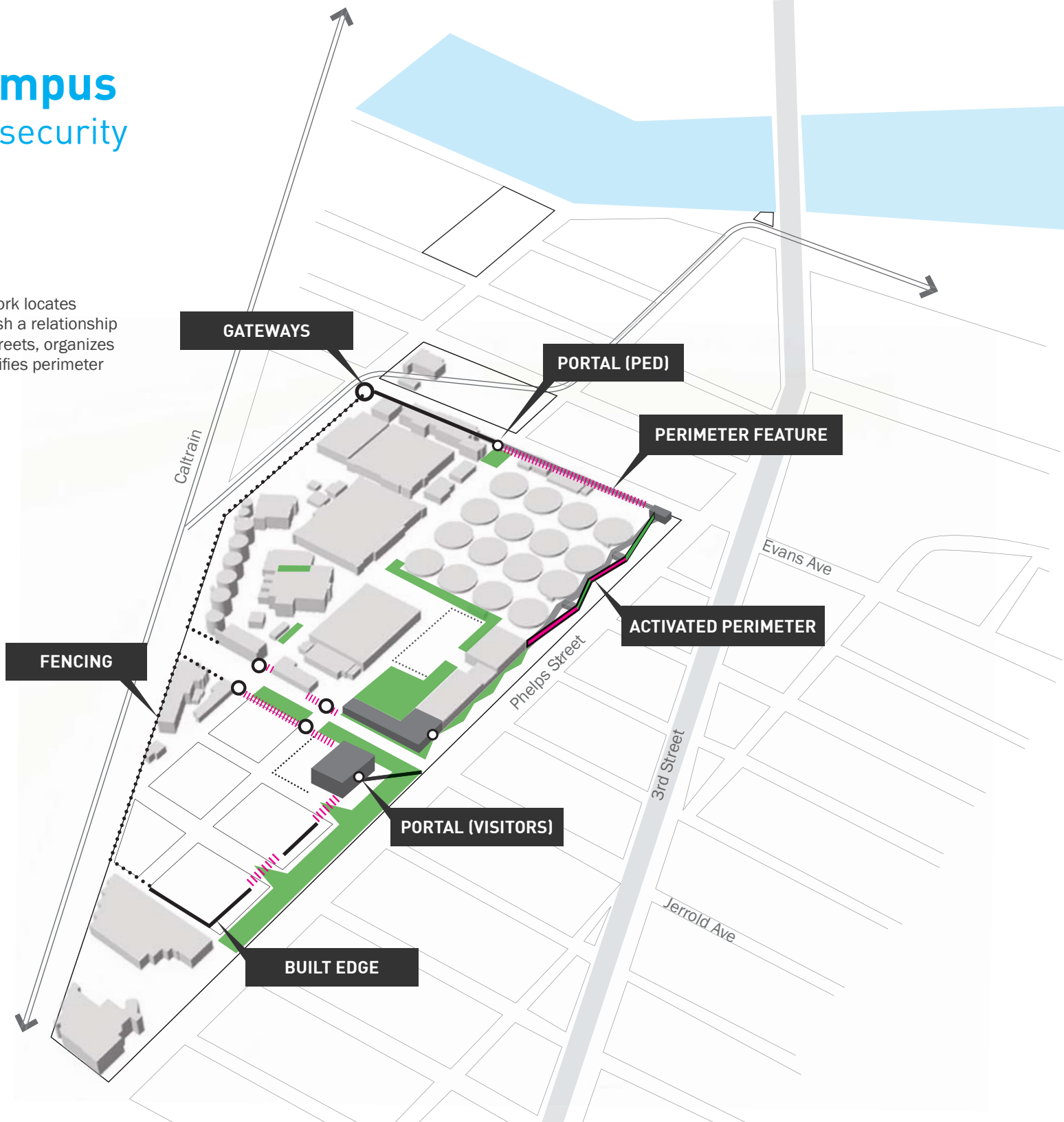

# SEP campus

integrated wayfinding

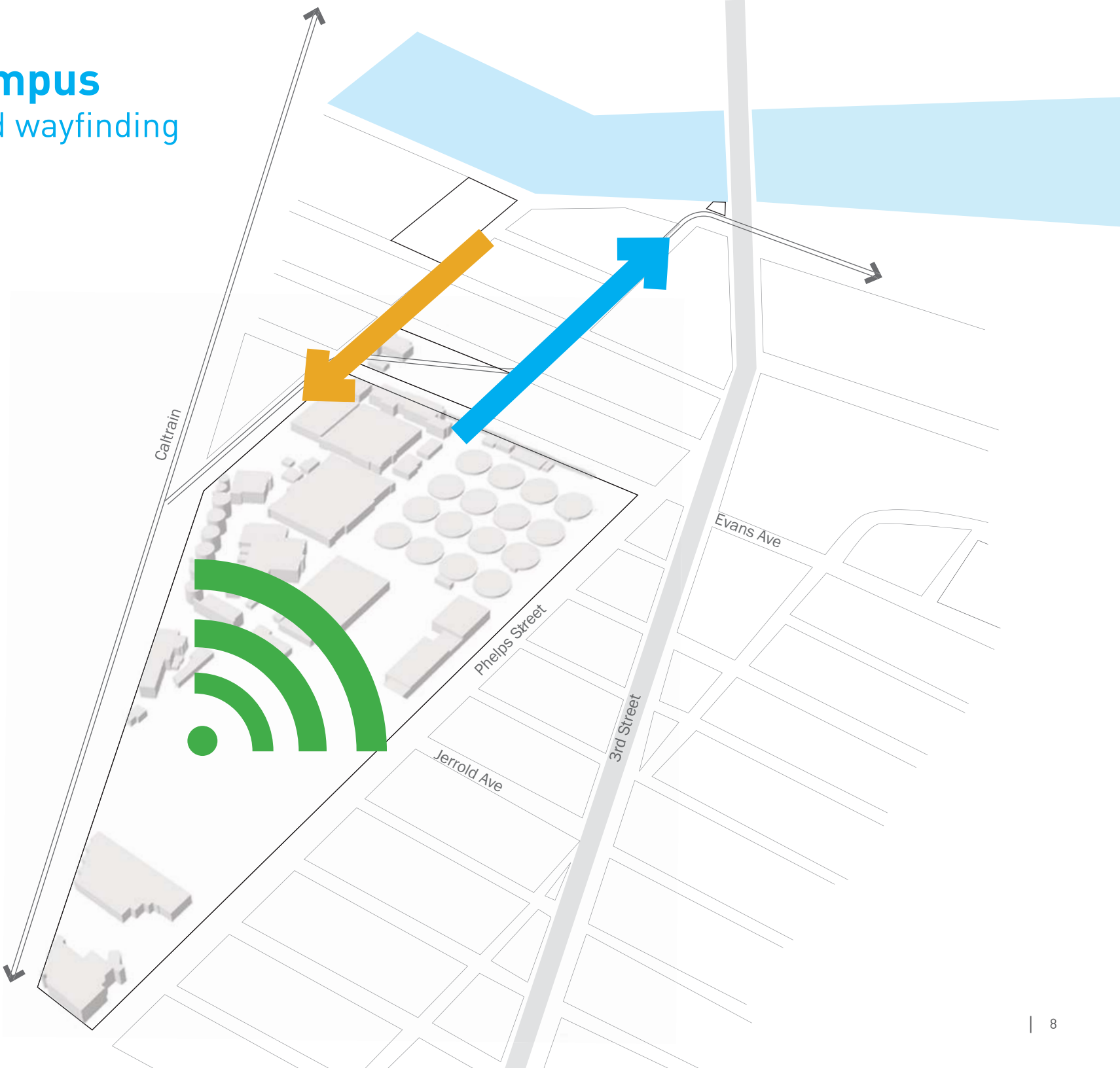



# SEP campus

integrated wayfinding

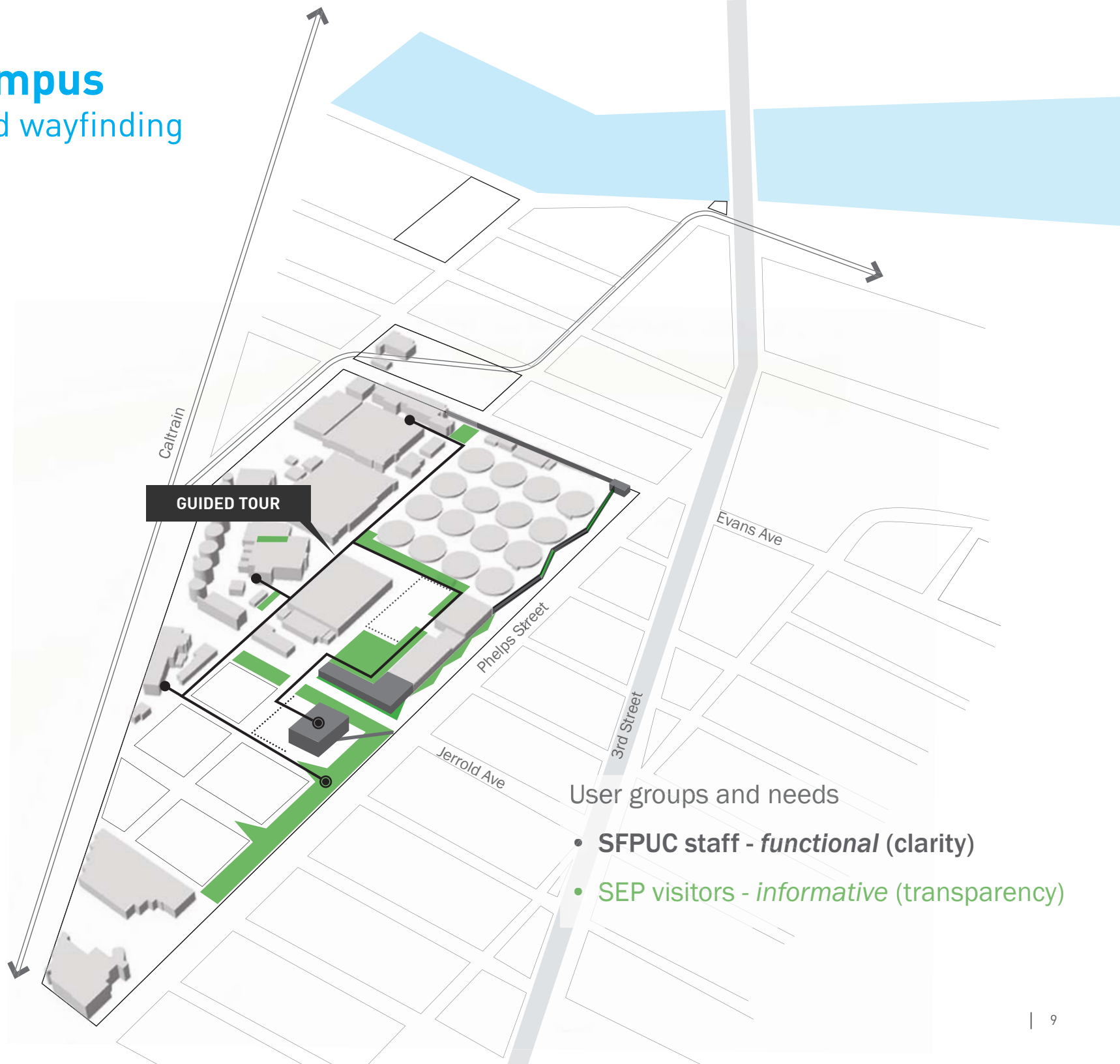

**GUIDED TOUR**

User groups and needs

- SFPUC staff - *functional* (clarity)
- SEP visitors - *informative* (transparency)

# SEP campus

integrated wayfinding

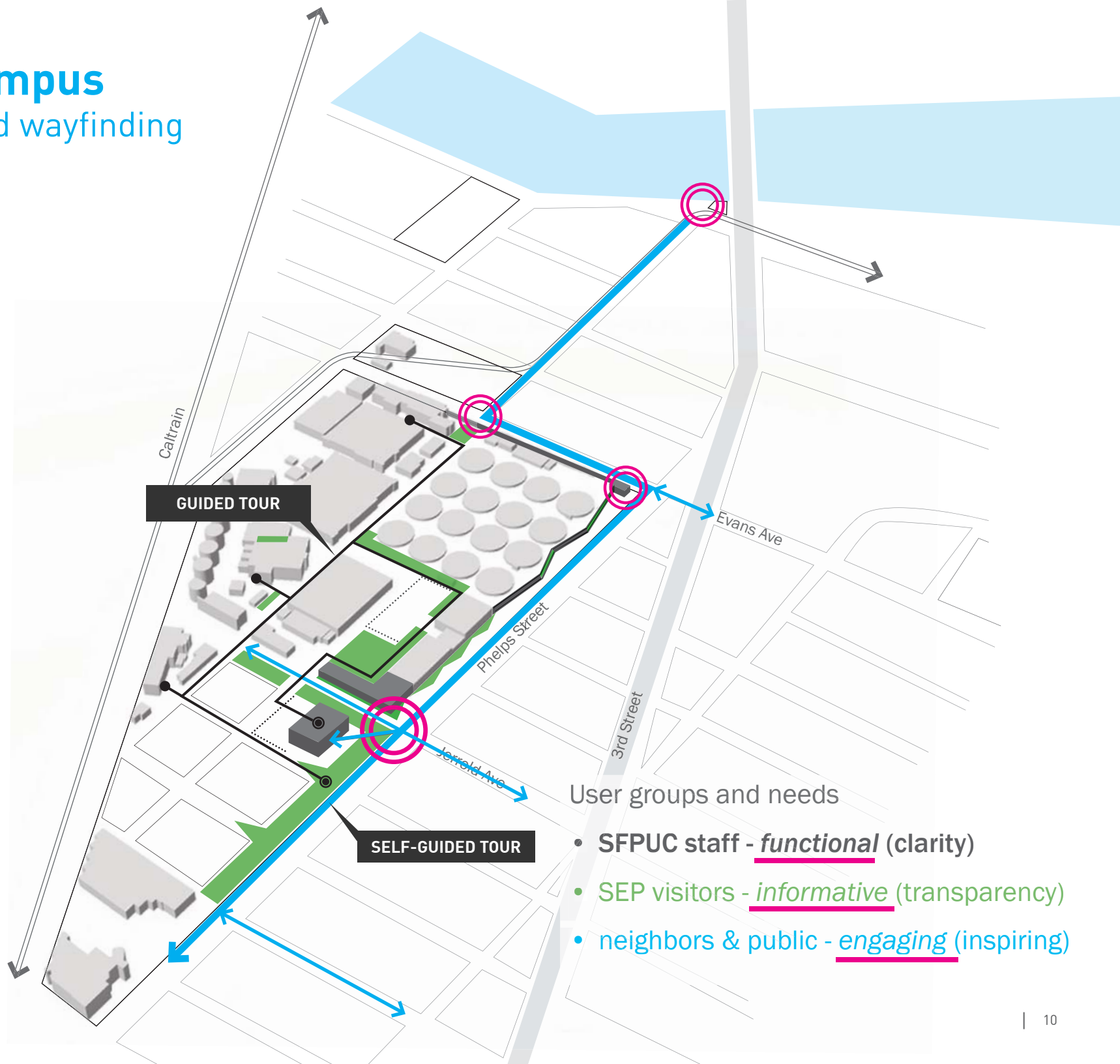

## User groups and needs

- SFPUC staff - functional (clarity)
- SEP visitors - informative (transparency)
- neighbors & public - engaging (inspiring)



# SEP campus overview

- Islais Creek (local destination)
- 1 Evans Ave at Quint St
- 2 Phelps St at Evans Ave
- 3 Phelps St at Galvez Ave
- 4 Phelps St at Hudson Ave
- 5 Jerrold Gateway
- 6 Constructed Wetland
- 7 Vehicular Gate 1
- 8 Vehicular Gate 2
- 9 SEP Quad
- 10 SEP Quad
- 11 SEP building #892
- 12 Evans Ave at Rankin St

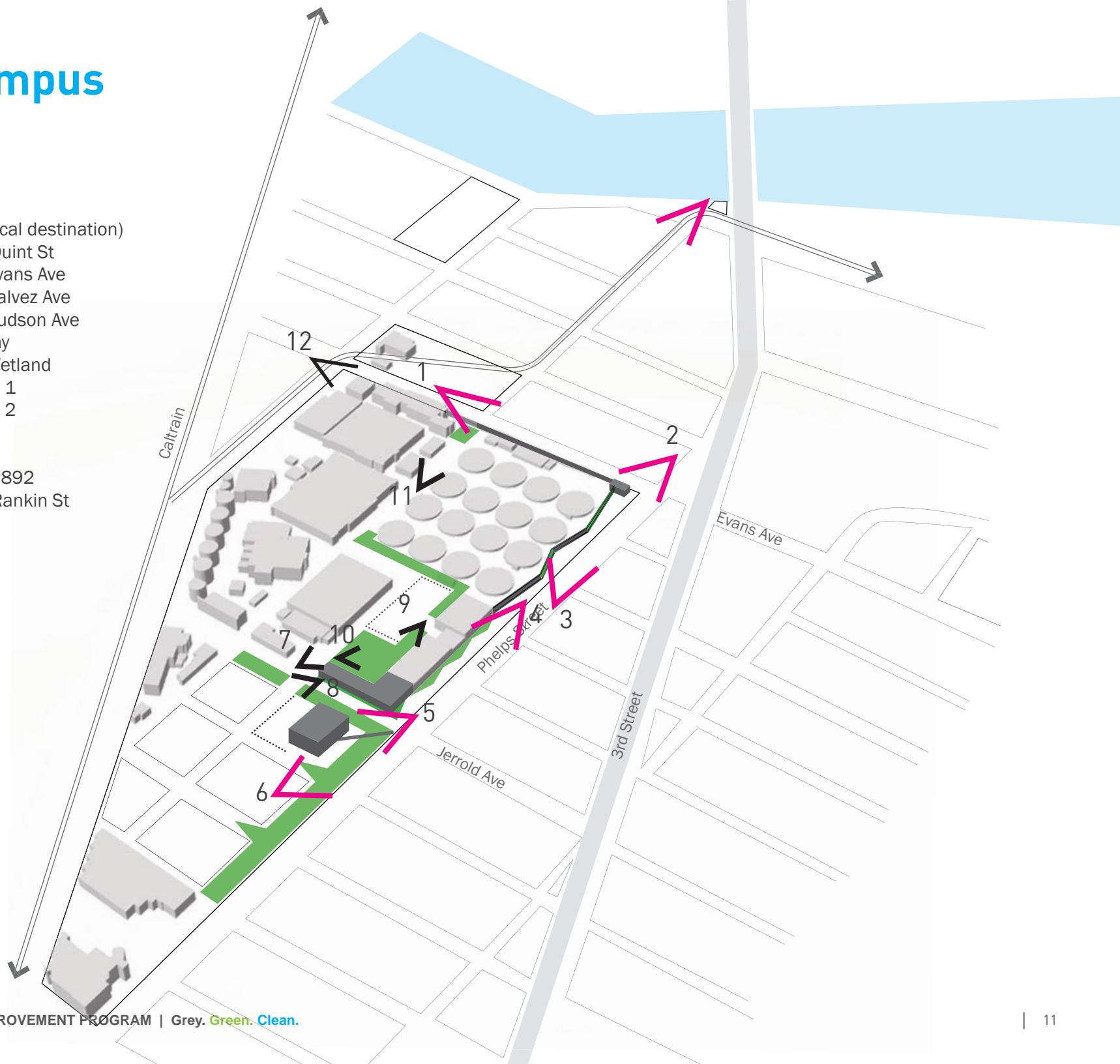

# SEP campus

Islais Creek (local destination)

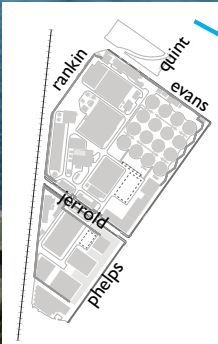



# SEP campus

Quint St at Custer Ave

What is that structure?

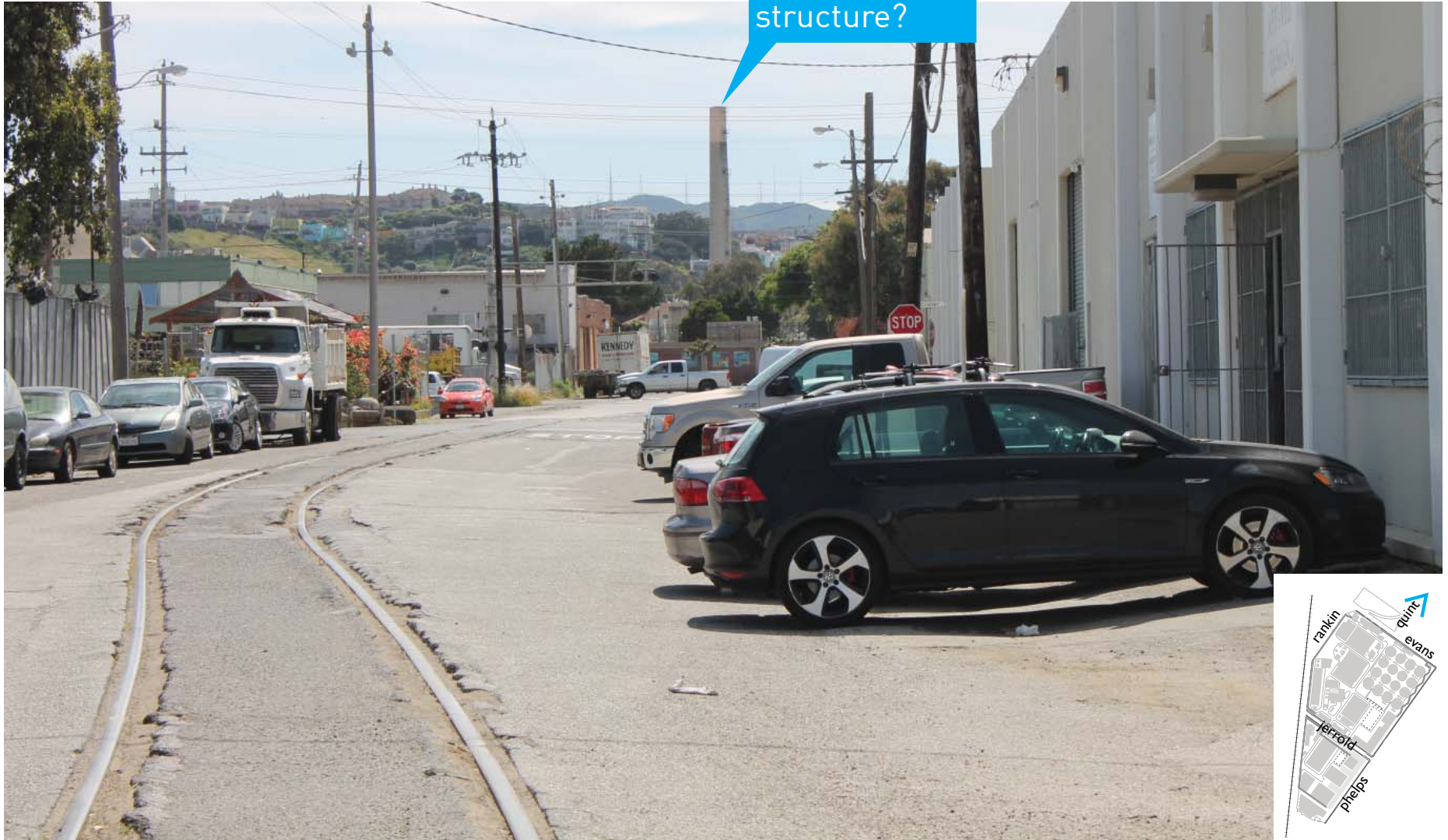

# SEP campus

Evans Ave at Quint St





# SEP campus

## Evans Ave at Quint St



# SEP campus

Evans Ave at Quint St

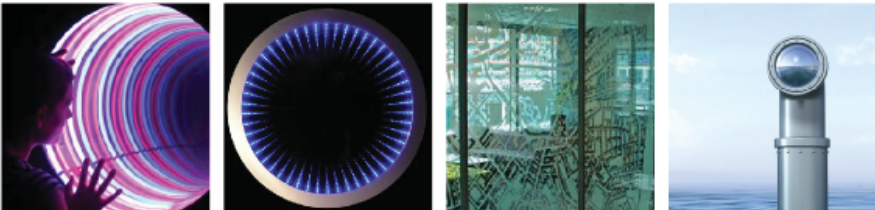



# SEP campus periscope

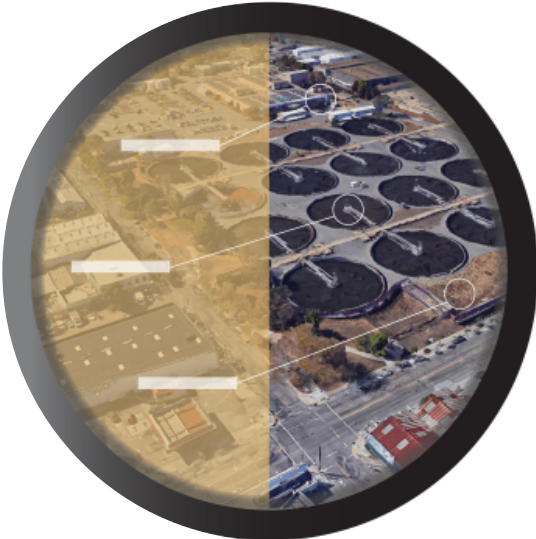

# SEP campus

Evans Ave at Phelps St

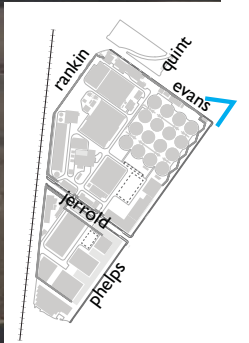



# SEP campus

Evans Ave at Phelps St



# SEP campus

Evans Ave at Phelps St

A neighborhood landmark  
at a highly visible location



Inspired by SEP functions

“Big Sweep” by Claes Oldenburg, Denver, CO  
31' x 25', Stainless steel + Aluminum + Fiber-reinforced plastic + Polyurethane enamel paint



Delights at different scales

“I See What You Mean” by Lawrence Argent, Denver, CO  
Denver Convention Center  
Made of composite materials, surface coated in a lapis lazuli blue, polymer concrete.



Fun and playful

“Bad Dog” by Richard Jackson, Orange County, CA  
Approx. 336 x 384 in, Fiber reinforced composite skin and steel



# SEP campus

Phelps St at Galvez Ave

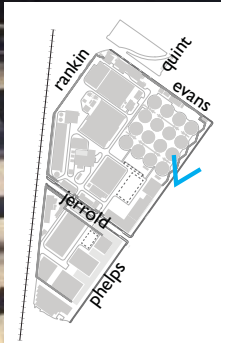



# SEP campus

Phelps St at Galvez Ave





# SEP campus

Phelps St at Hudson Ave

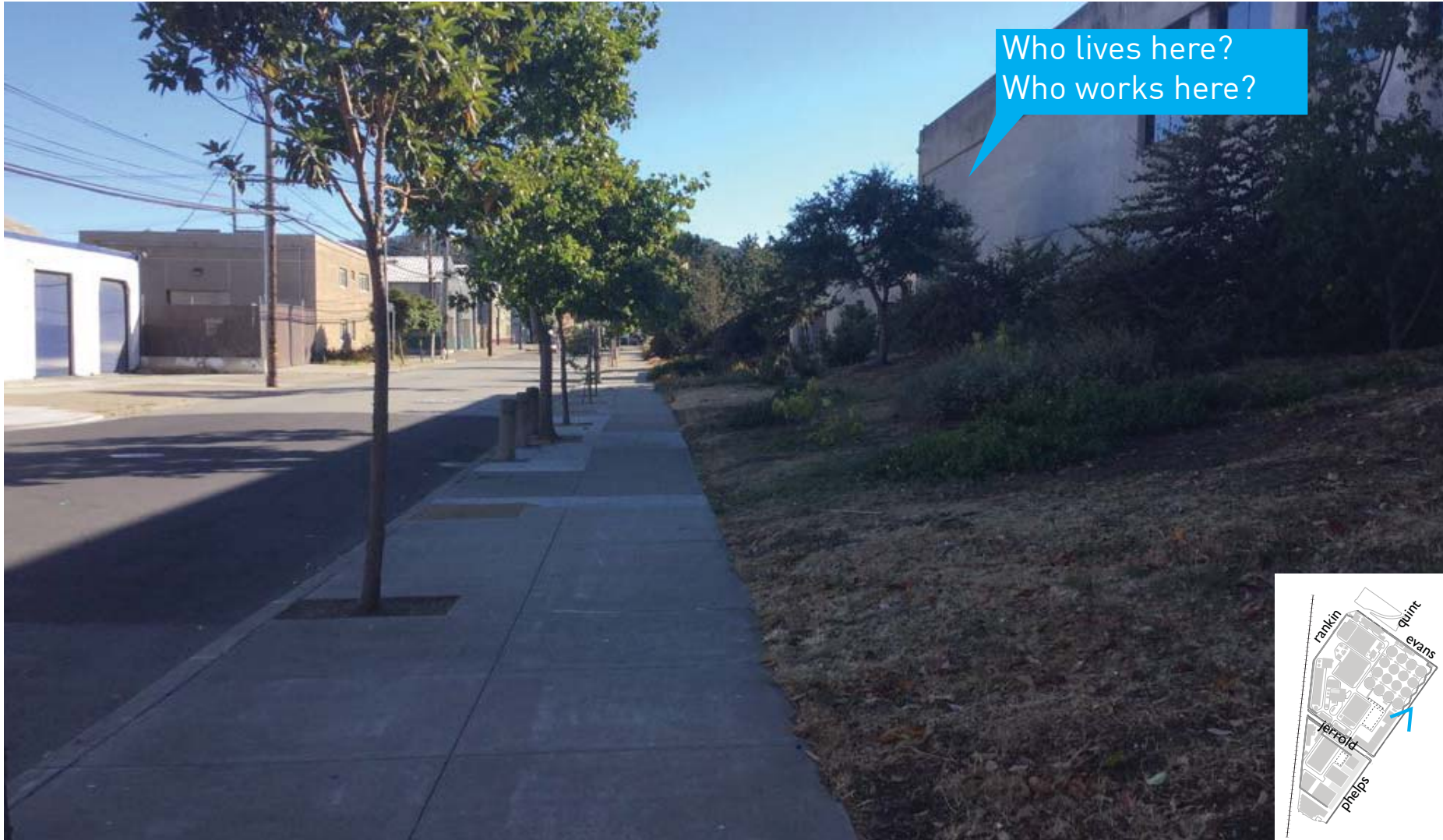

Who lives here?  
Who works here?

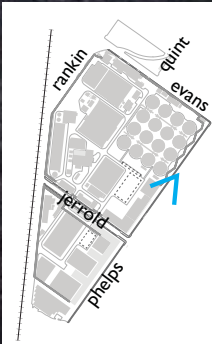

# SEP campus

Phelps St at Hudson Ave

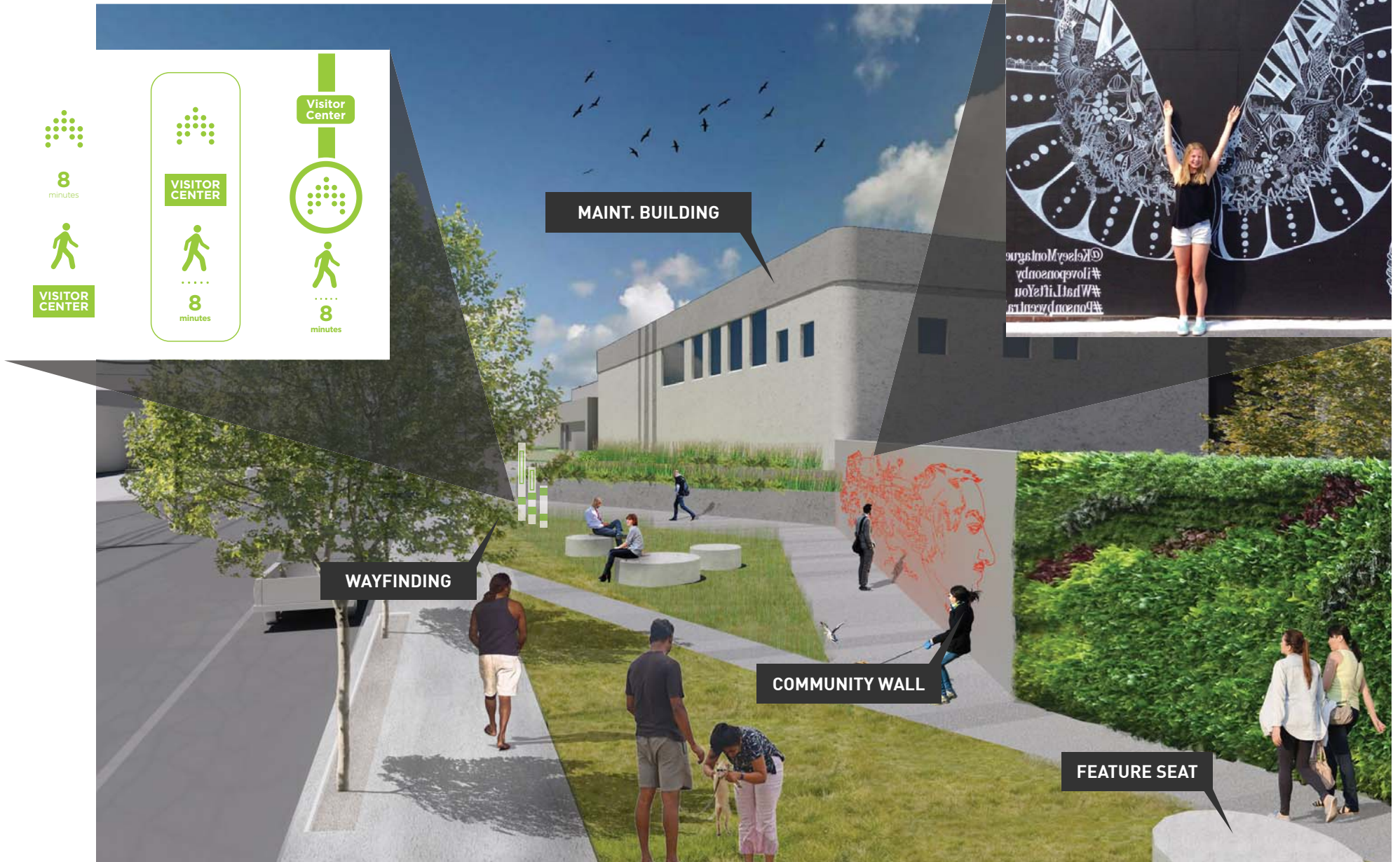



# SEP campus

## Jerrold Gateway



# SEP campus

## Jerrold Gateway





# SEP campus

## Jerrold Gateway



# SEP campus overview

- 1 Evans Ave at Quint St
- 2 Phelps St at Evans Ave
- 3 Phelps St at Galvez Ave
- 4 Phelps St at Hudson Ave
- 5 Jerrold Gateway
- 6 Constructed Wetland
- 7 Vehicular Gate 1
- 8 Vehicular Gate 2
- 9 SEP Quad
- 10 SEP Quad
- 11 SEP building #892
- 12 Evans Ave at Rankin St

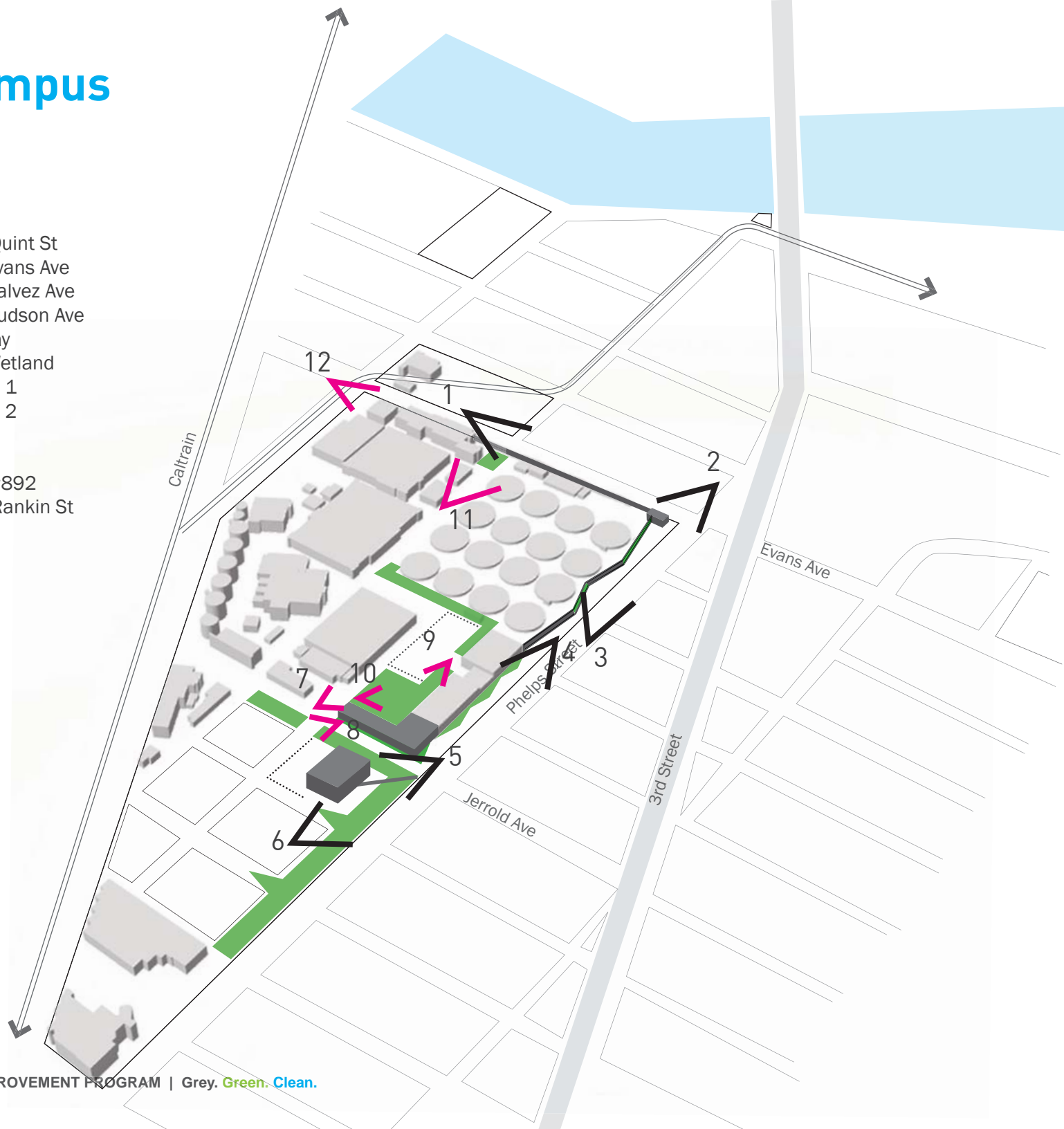



# SEP campus

## Jerrold gate 1

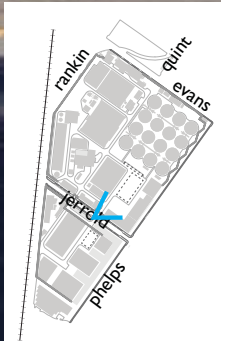

# SEP campus

## Jerrold gate 1

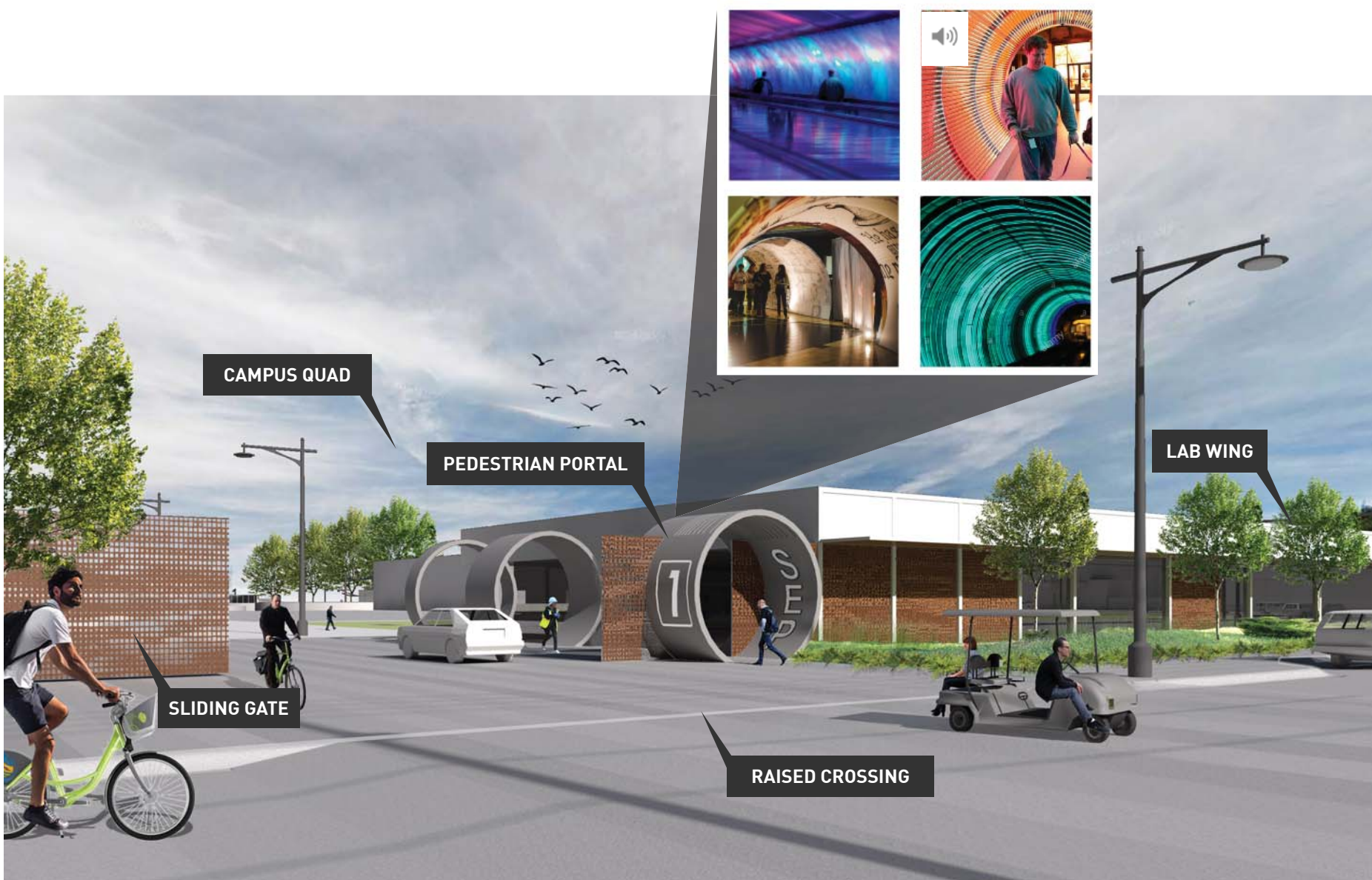



# SEP campus

Jerrold gate 2



How do I access this facility?

Where do I need to go?  
Gate number?

Where is the re-fill station?

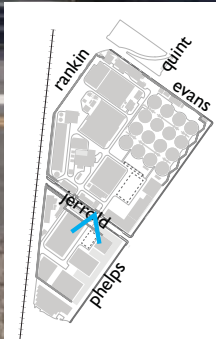



# SEP campus

## Jerrold gate 2





# SEP campus

Quad: engineering on display

Where is the entrance?

Where are the labs?

Where do I find employee facilities?

What is the building number?

Is this the guided tour route?





# SEP campus

Quad: engineering on display





# SEP campus

Quad: engineering on display



# SEP campus

building 892

What building number?

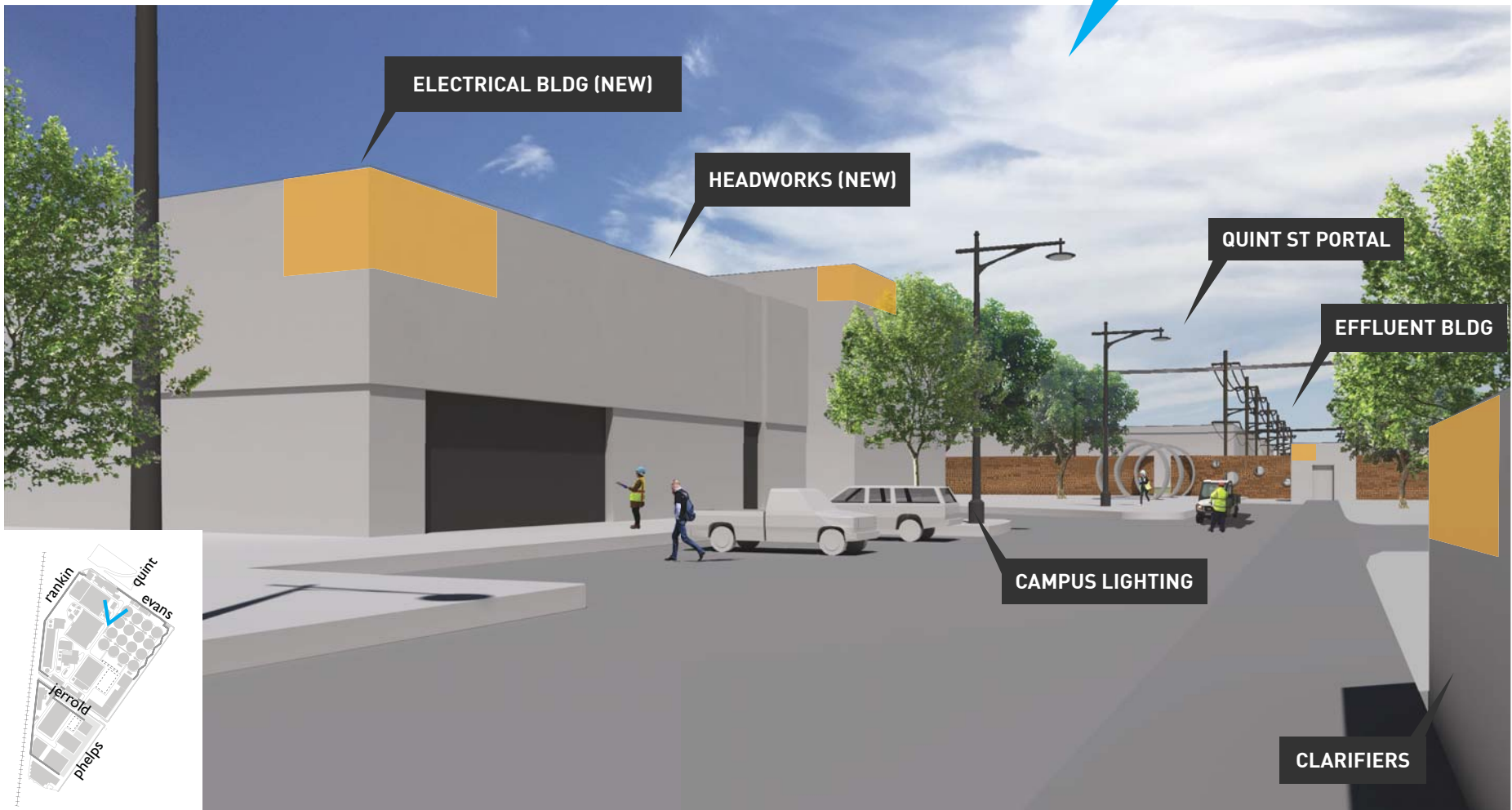



# SEP campus

Evans Ave at Rankin St

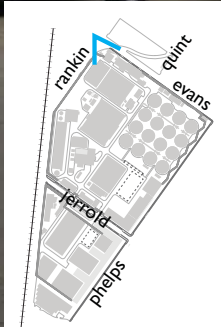
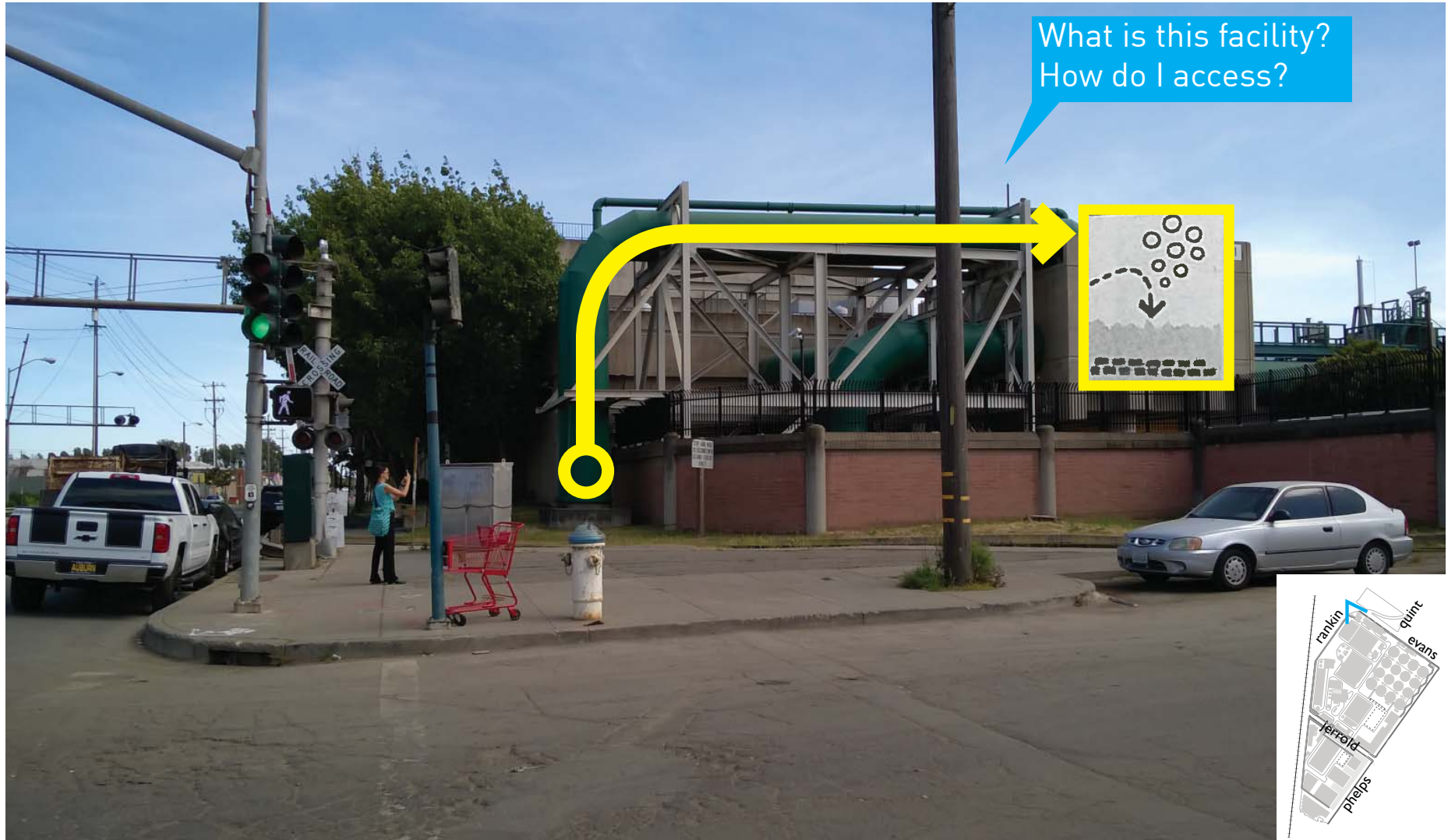

# SEP campus

Evans Ave at Rankin St

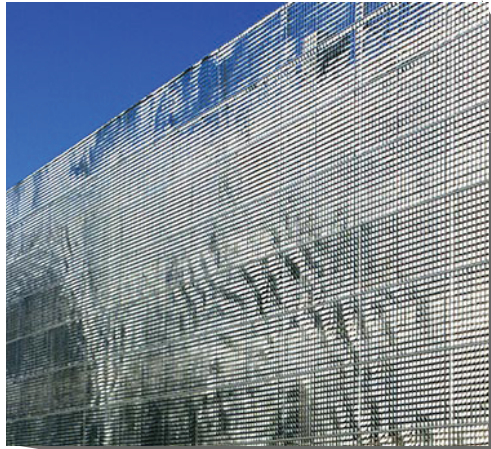

WAYFINDING FROM A DISTANCE

SOUTHEAST

INTEGRATED ART CELEBRATES FUNCTION

EVANS AVE

IMPROVED PAVED AREAS

RANKIN ST





# SEP Future

## CAMPUS VISION

September, 2016

