



**SFO LONG TERM PARKING GARAGE 2**  
**CIVIC DESIGN REVIEW PRESENTATION**

MARCH 15, 2017



# ARCHITECTURE

LONG TERM PARKING GARAGE 2

# SITE PLAN



SITE PLAN



PROJECT OVERVIEW

# LONG TERM PARKING ENTRY





VIEW TO PEDESTRIAN SIDE ENTRANCE

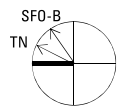
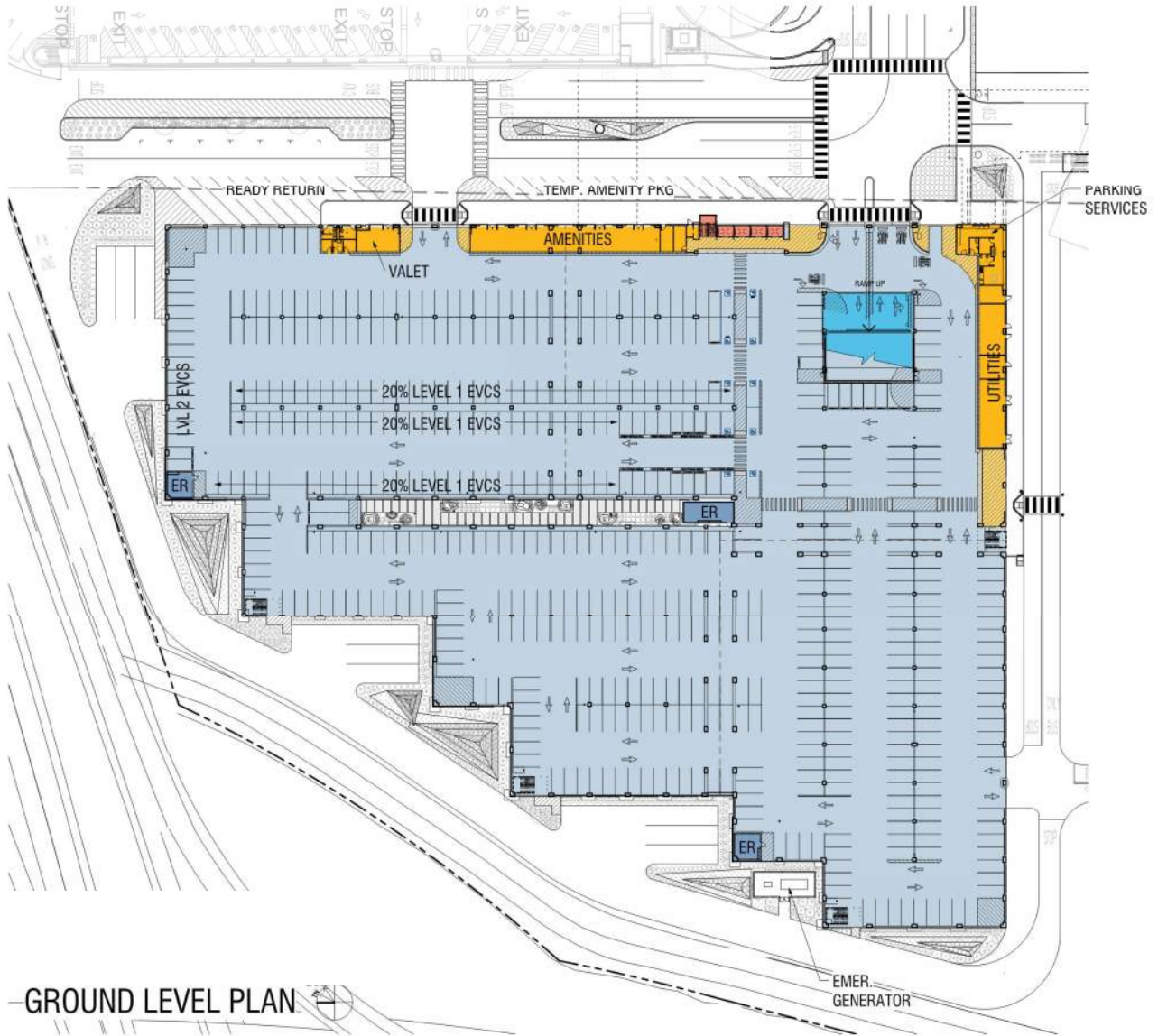

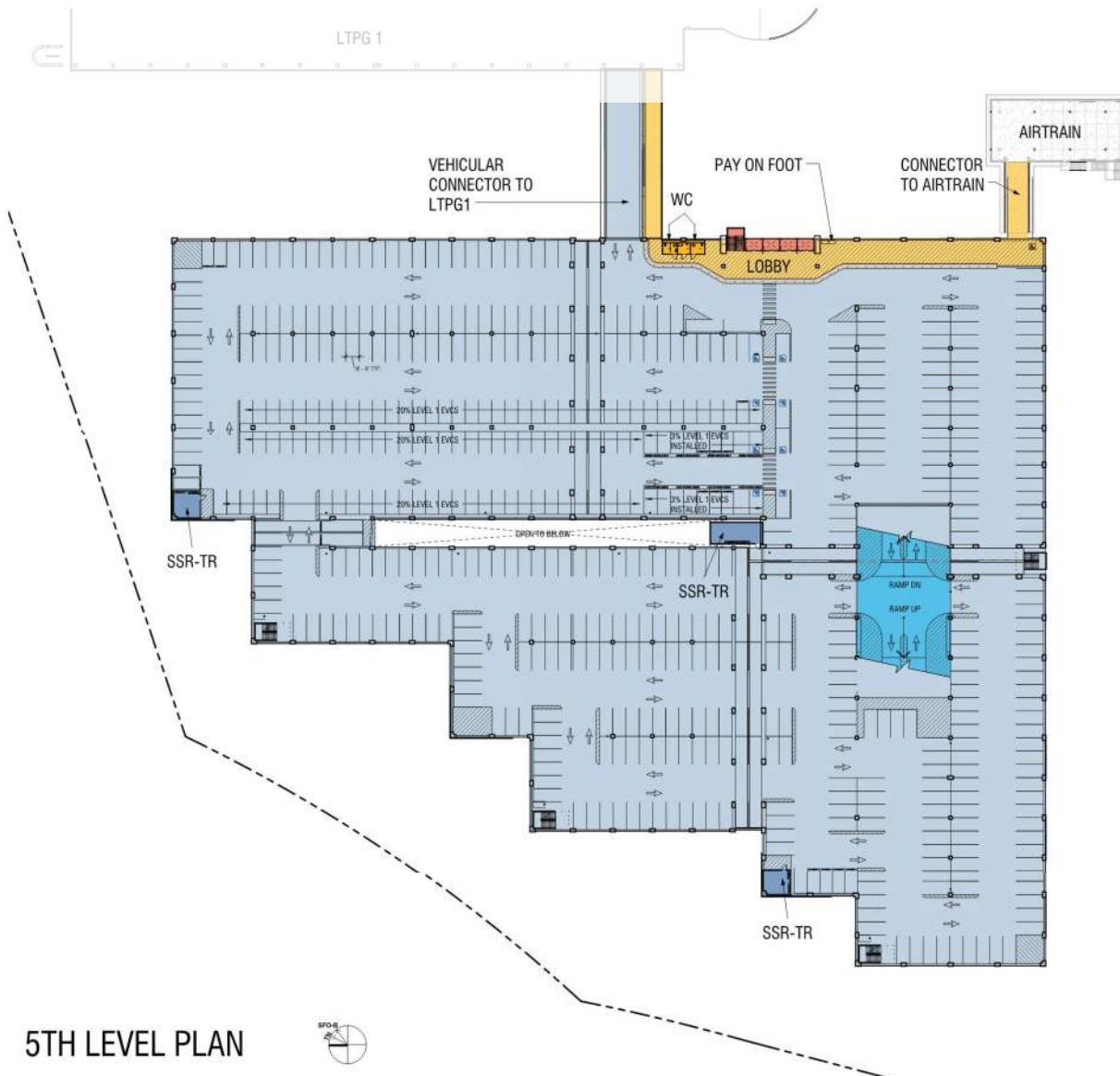

5TH LEVEL PLAN

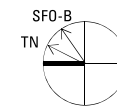





LOOKING BACK FROM THE PEDESTRIAN CONNECTOR



LOOKING OVER FUTURE BUILDING SITE (NOW SURFACE PARKING LOT DD)



SFO LONG TERM PARKING

**NORTH SIDE – BIRD'S EYE VIEW**



WEST SIDE – BIRD'S EYE VIEW

# LANDSCAPE

## LONG TERM PARKING GARAGE 2

<b>MATERIALS</b>	
<b>PAVING</b>	<b>LANDSCAPE CONT.</b>
<p><b>P1</b> DESCRIPTION: CAST-IN-PLACE CONCRETE FINISH: MEDIUM BROOM FINISH COLOR: INTEGRAL COLOR HAY FIELDS SG084-1 JOINTS: SAWCUT</p> <p><b>P2</b> DESCRIPTION: INTERLOCKING PAVERS FINISH: MATCH EXISTING COLOR: COLORS TBD JOINTS: SAND</p> <p><b>P3</b> DESCRIPTION: CAST-IN-PLACE CONCRETE IN LIGHTWELLS FINISH: WHITE BRUSH FINISH AND WHITE COLOR, SEEDED MEXICAN PEBBLES 1/4"-3/8" IN BLACK CONCRETE COLOR COLOR: 2 INTEGRAL COLORS, WHITE AND BLACK COLOR JOINTS: TWO COLD JOINTS BETWEEN WHITE CONCRETE AND BLACK CONCRETE POUR, TYP.</p>	<p><b>L7</b> STONE MULCH: IN LOCATION AS SHOWN FINISH: BLACK SLATE CHIPS STONE MULCH TO 4" MINIMUM DEPTH. DETAIL: 6/L4.1.00</p>
<b>LANDSCAPE</b>	<b>SITE FURNITURE</b>
<p><b>PIA</b> PLANTING AREA: IN LOCATION AS SHOWN</p> <p><b>L2</b> BOULDERS: IN LOCATION AS SHOWN, THREE (3) FINISH: RIVER WASHED BOULDERS, 3 - 8 TONS EACH, APPROXIMATELY 80 TONS TOTAL, YUBA BLUE, NO KNOWN EQUAL, WITH SURROUNDING PEBBLE ROCK, TYP. DETAIL: 3/L4.1.00</p> <p><b>L3</b> STONE MULCH: IN LOCATION AS SHOWN FINISH: LODI GOLD CRUSHED ROCK, 4" TYPICAL DETAIL: 2/L4.1.01</p> <p><b>L4</b> STONE MULCH ON RAISED BERM: IN LOCATION AS SHOWN FINISH: BLACK SLATE CHIPS STONE MULCH TO 4" MINIMUM FROM SOIL GRADE AND SURROUNDING PLANTS, TYP. DETAIL: 4/L4.1.00</p> <p><b>L5</b> BUTTERFLY BERM 1: IN LOCATION AS SHOWN FINISH: RAISED TOPOGRAPHY OF SOIL AND PLANTED WITH BLACK SLATE CHIPS STONE MULCH, TYPICAL. DETAIL: 4/L4.1.00</p> <p><b>L6</b> BIOSWALE: IN LOCATION AS SHOWN FINISH: DEPRESSED TOPOGRAPHY OF SOIL AND BIOSWALE PLANTS AND STONE MULCH TBD, TYPICAL DETAIL: 1/L4.1.01</p>	<p><b>SF1</b> DOG STATION: IN LOCATION AS SHOWN. MANUFACTURER: TBD FINISH: TBD, PROVIDE POLE WITH DOGGIE BAGS AND RELIEVING STATION, TO BE CONNECTED TO SEWER LINE, TYP. DETAIL: 6/L4.1.01</p> <p><b>SF2</b> SITE FURNISHING: IN LOCATION AS SHOWN. TBD DETAIL: MANUFACTURER, TBD FINISH: TBD DETAIL: XX/XX</p> <p>BIKE RACKS: SEE ARCHITECTURE DRAWINGS IN GARAGE ON GROUND FLOOR. DETAIL: SAD</p> <p><b>SF4</b> GREEN SCREEN: IN LOCATION AS SHOWN, NEXT TO SOUTHEAST CORNER OF LTPG1, MECHANICAL EQUIPMENT. DETAIL: 3,4,5/L4.1.01</p>

# LANDSCAPE "SENSE OF PLACE"



- 1. XERISCAPE: BLUE AGAVE GROUPING
- 2. GROUNDCOVER: ALLIUM CAERULEUM
- 3. GROUNDCOVER: SENECIO M. 'BLUE CHALK'
- 4. BLUE MISSION BUTTERFLY
- 5. LANDSCAPE: GRASSES + FLOWERING PLANT FOR OCCASIONAL BLUE BUTTERFLY
- 6. LANDSCAPE HARDENING: STONE MULCH, BLACK SLATE
- 7. LANDSCAPE BERMS WITH STONE
- 8. ARTEMESIA VERSICOLOR 'SEA FOAM'
- 9. SUCCULENT: DYCKIA ARIZONA
- 10. AGAPANTHUS 'BRILLIANT'

# WESTERN LANDSCAPE PLANT PALETTE



1. LANDSCAPE STONE MULCH  
CHILI BLACK SLATE CHIPS
2. GROUNDCOVER: AGAVE ATTENUATA
3. GROUNDCOVER: LOMANDRA  
'BREEZE' OR YUCCA LINARIFOLIA

4. SHRUB: LEUCADENDRON SALIGNUM
5. LANDSCAPE: ALOE 'HECULES' OR 'BARBERAE'
6. LANDSCAPE HARDENING: STONE MULCH,  
SUCH AS LODI GOLD CRUSHED GRAVEL
7. LANDSCAPE BERMS OF LOMANDRA GRASS

8. SHRUB: LEPTOSPERMUM 'SUNRISE'
9. SHRUB: LEUCADENDRON 'POM POM'
10. SHRUB: AGONIS 'AFTERSHOCK'

# SITE PLAN



SITE PLAN



# LANDSCAPE SECTION AT WEST FACADE

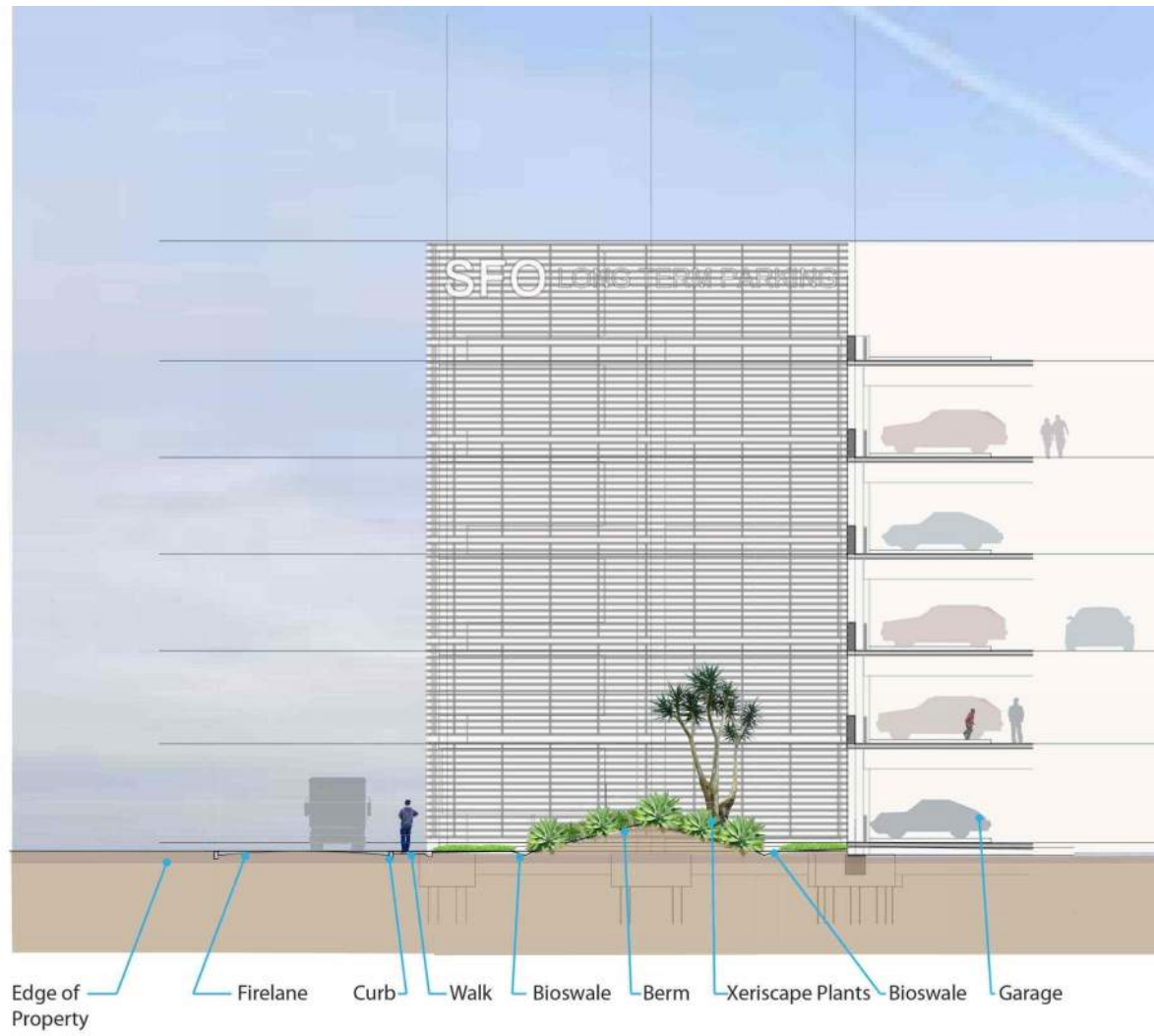
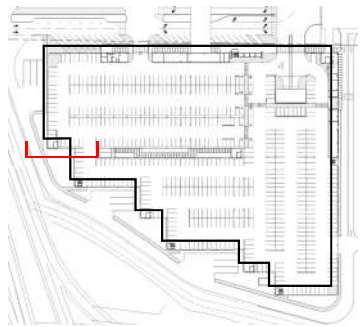

# LANDSCAPE SECTION AT WEST FACADE

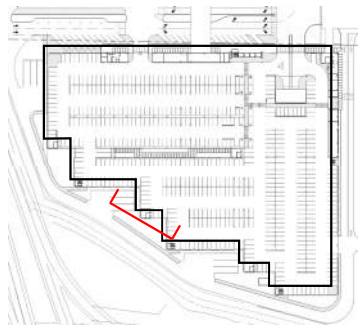

# NORTH-WEST

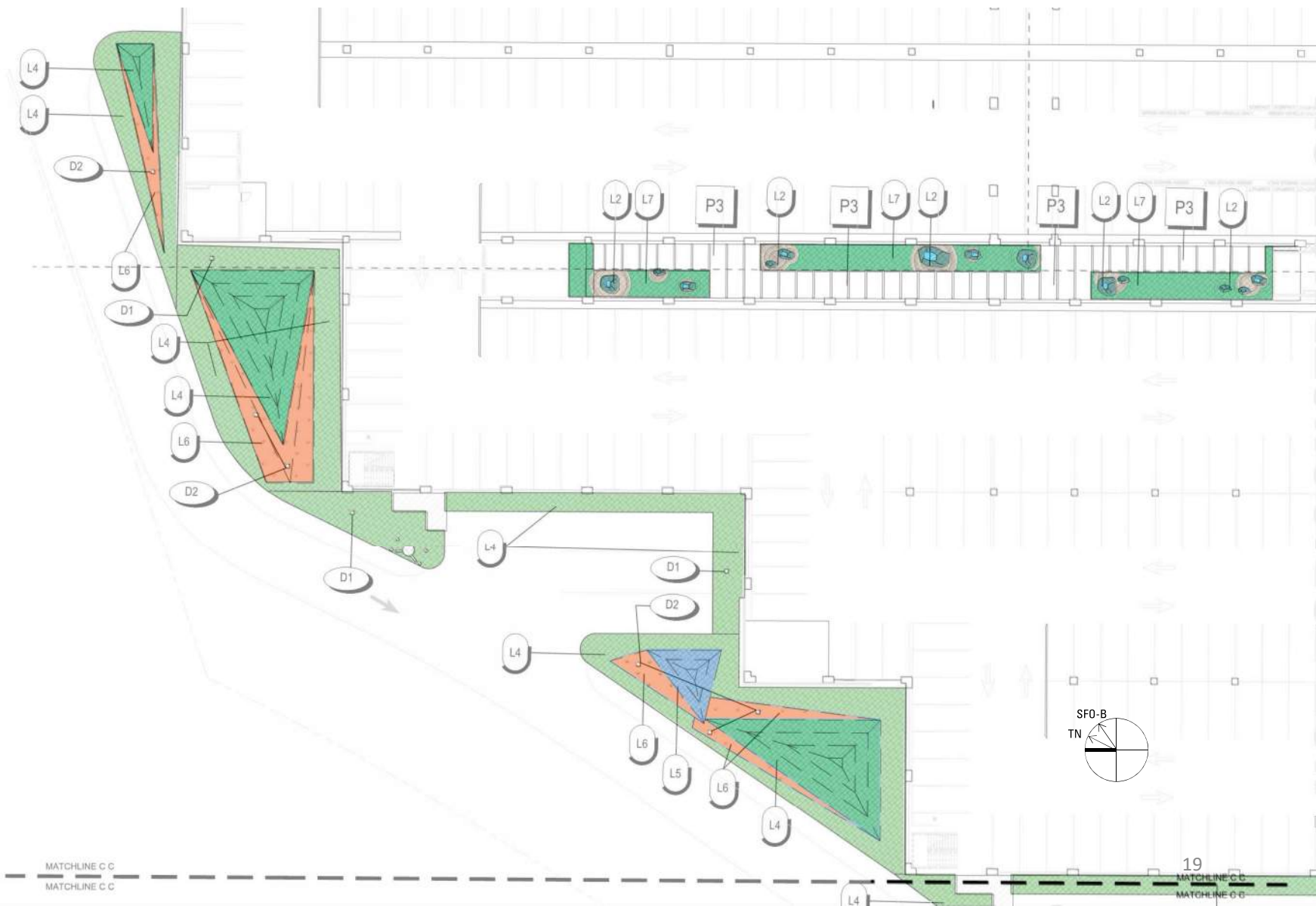

# SOUTH-WEST

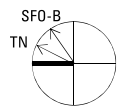
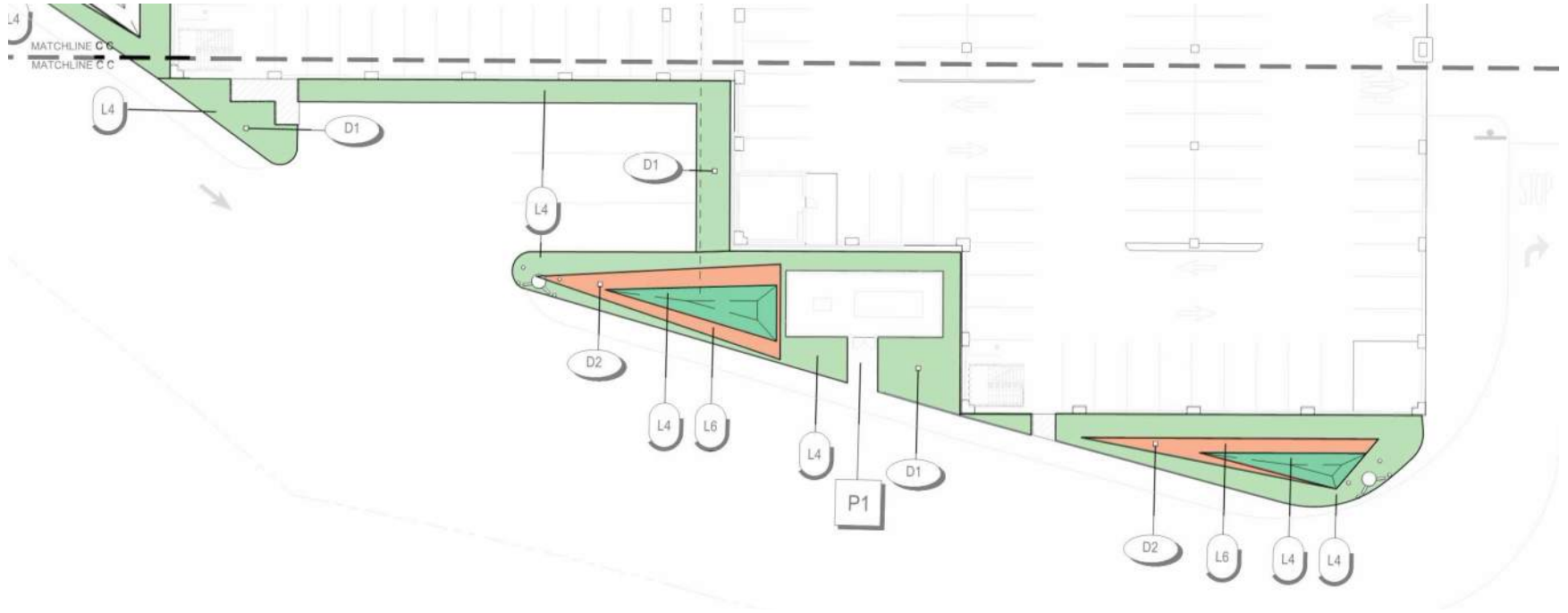

# BOULEVARD

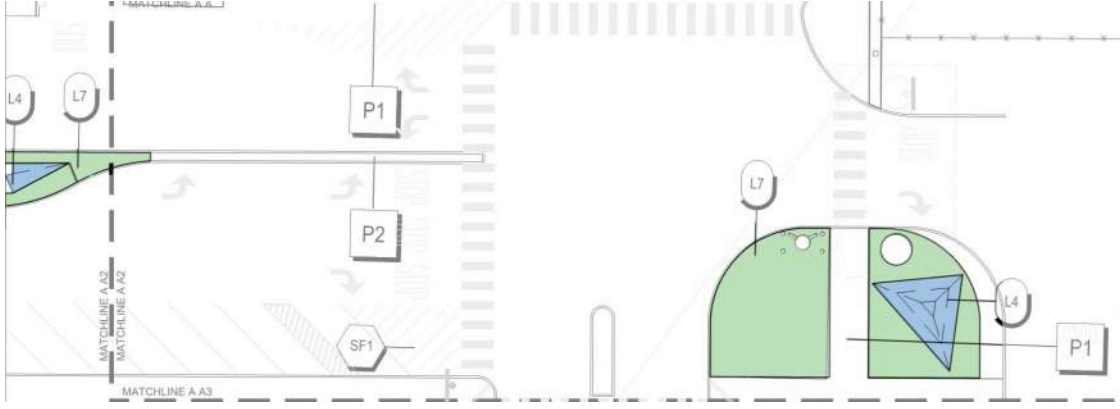
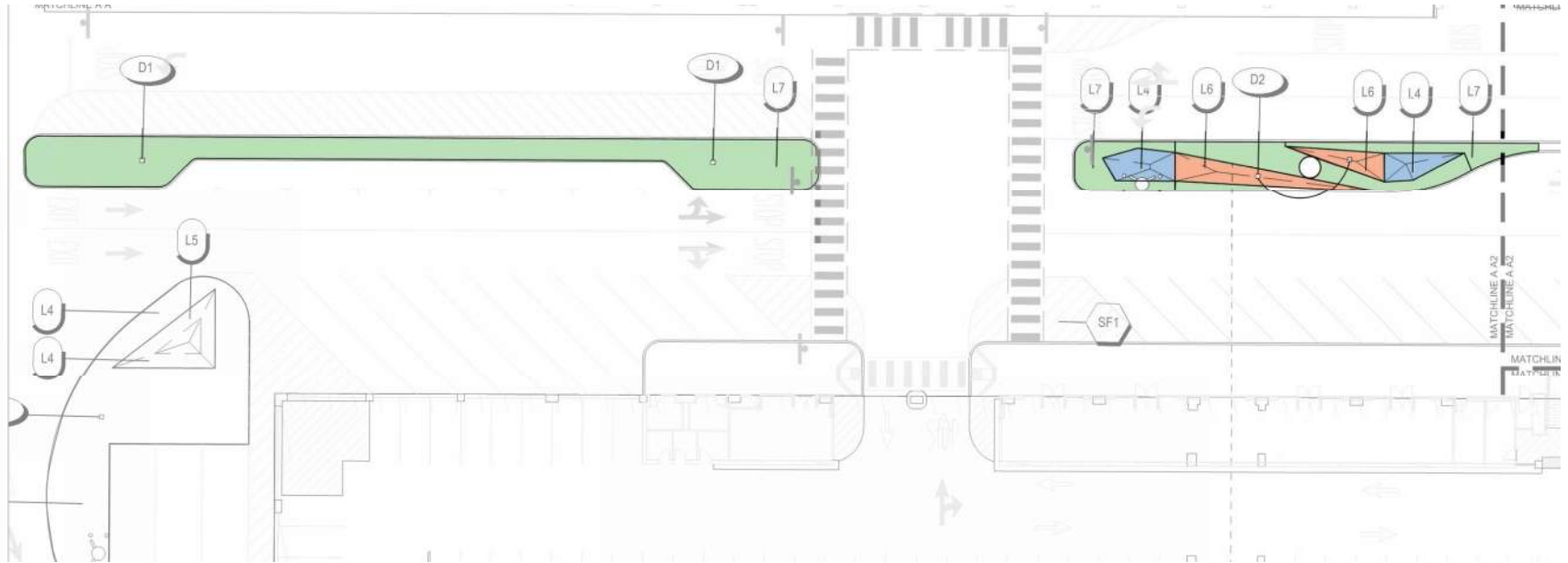

# ENTRANCE

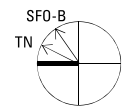
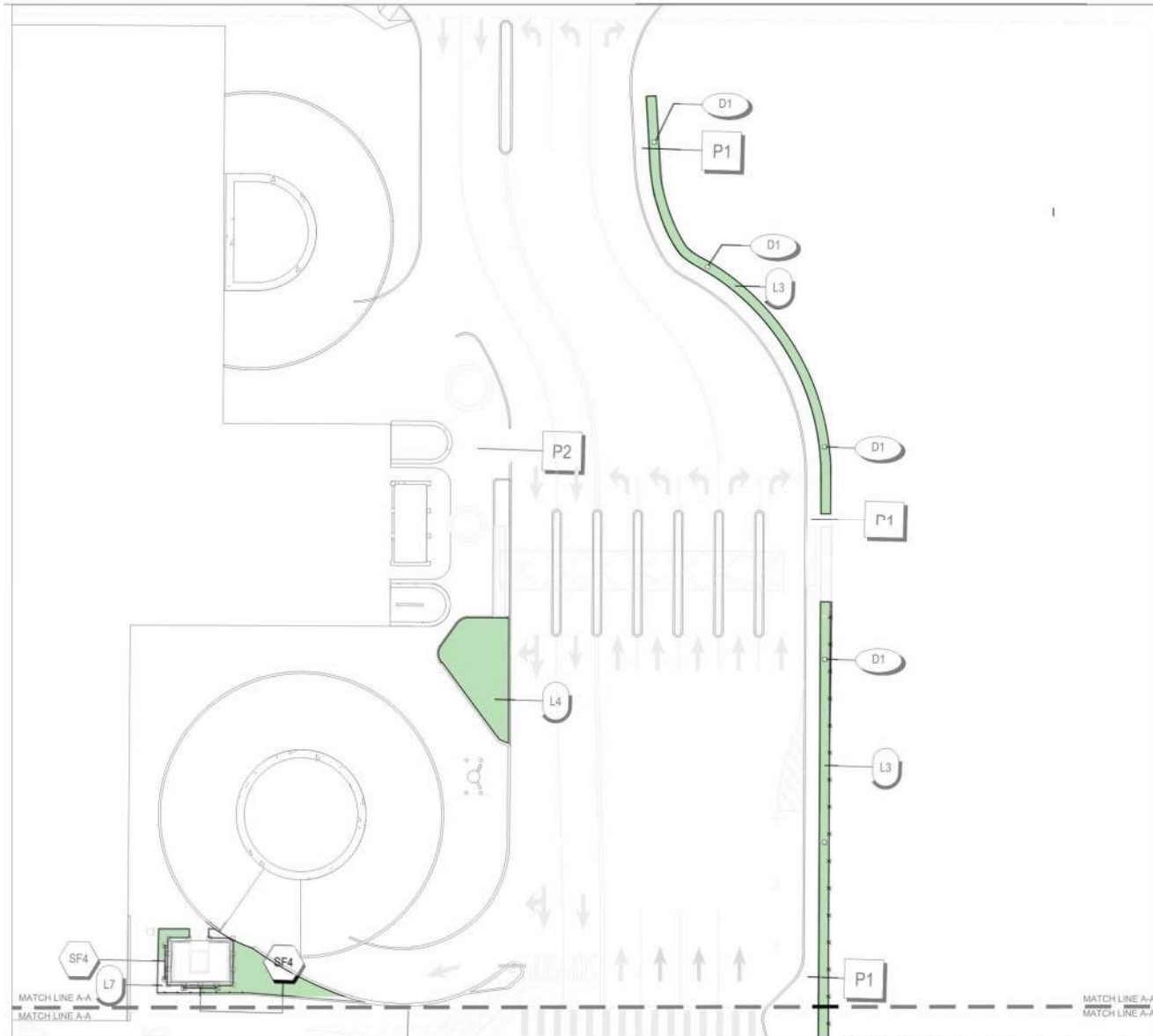



EAST SIDE – LOOKING TOWARD AMENITIES & AIRTRAIN

# SIGNAGE

LONG TERM PARKING GARAGE 2



# WAYFINDING DIAGRAM - SITE

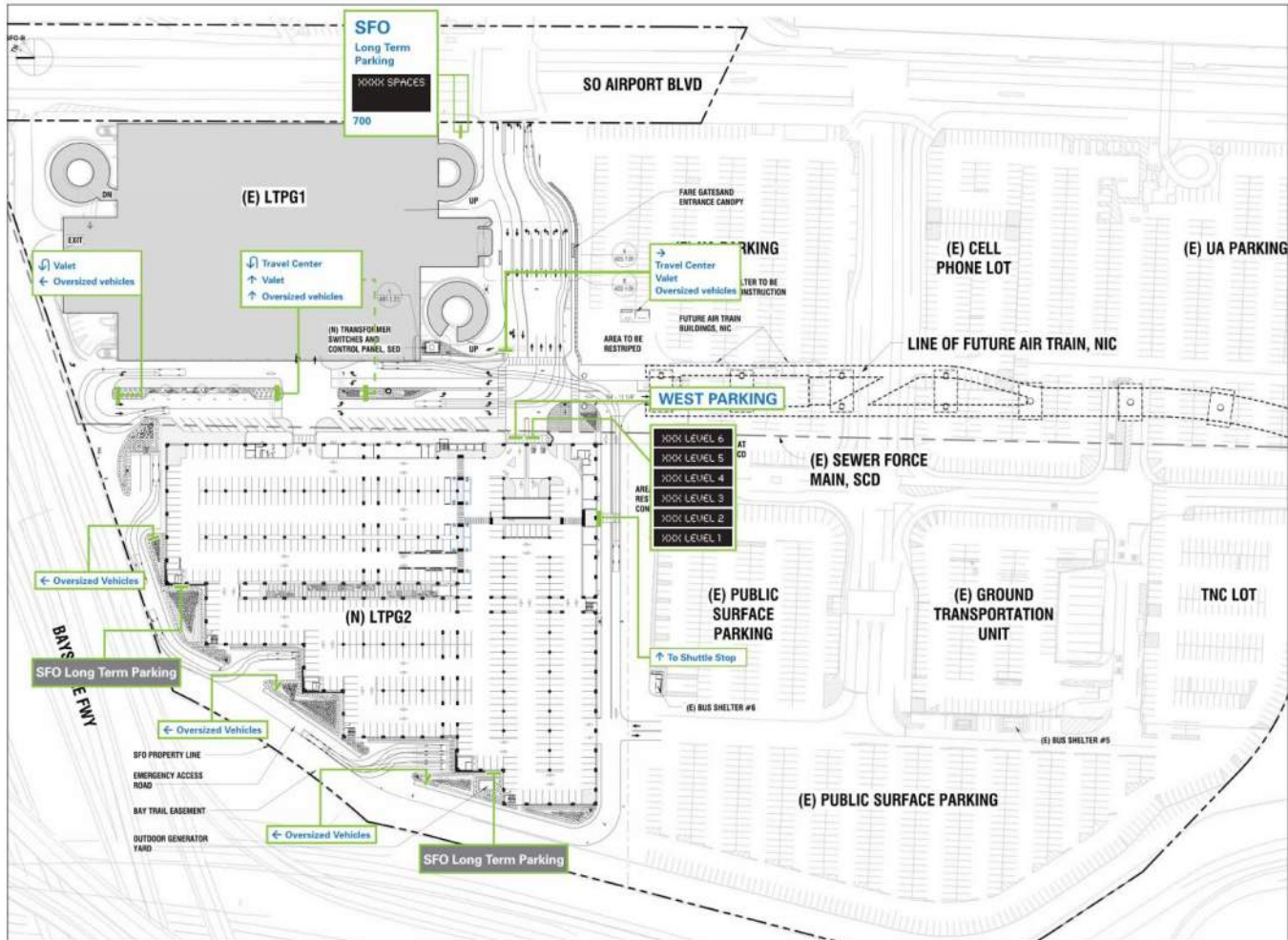

# ENTRANCE MONUMENT SIGN

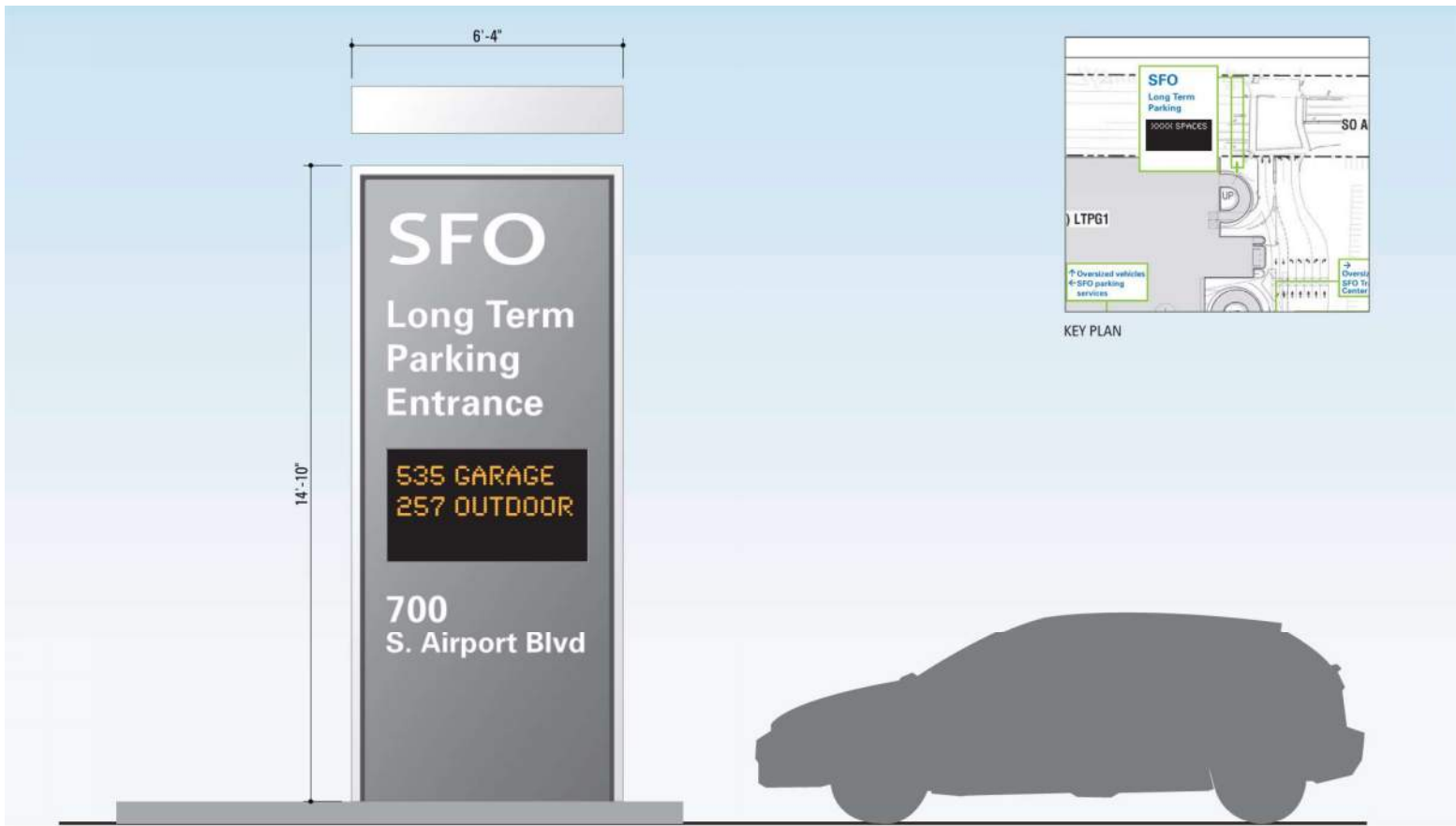

LONG TERM PARKING: ENTRANCE MONUMENT OPTION 2A

SFO LONG TERM PARKING GARAGE  
 Scale: 1/2"=1'-0"  
 February 28, 2017

Kate Keating Associates Inc.   
 1045 Sansome Street, Suite 202  
 San Francisco, CA 94111

# INTERIOR COLUMN GRAPHICS

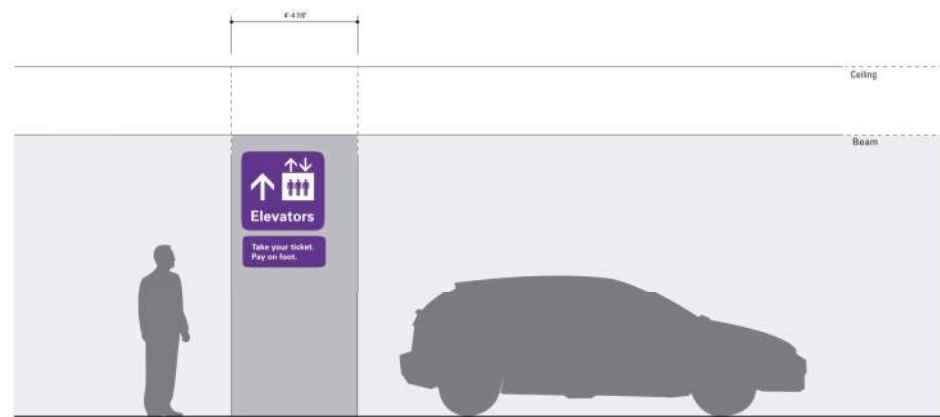
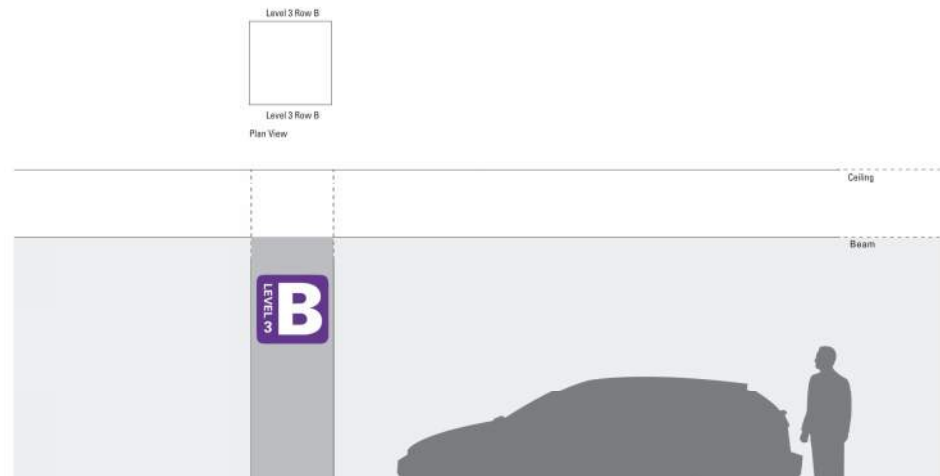

PEDESTRIAN DIRECTIONALS- OPTION 2  
SFO LONG TERM PARKING GARAGE  
Scale: 1/2" = 1'-0"  
February 28, 2017

Kate Keating Associates Inc.  
1045 Serrano Street, Suite 202  
San Francisco, CA 94111



GARAGE ENTRANCE SIGN (PLACEHOLDER)



THANK YOU!

