

EXHIBIT A



June 09, 2014

Lynn Fong, Manager
Department of Public Works Bureau of Street-Use and Mapping
1155 Market Street, 3rd Floor
San Francisco, CA 94103

Appeal No.: 14-113
Appeal Title: AT&T California vs. DPW-BSM
Subject Property: 996 Cayuga Avenue
Permit Type: UTILITY EXCAVATION PERMIT
Permit No.: 14EXC-3185

Dear Lynn Fong, Manager:

This is to notify you that an appeal has been filed with this office protesting the **DENIAL** of the above referenced **UTILITY EXCAVATION PERMIT**.

We are enclosing a copy of the **Preliminary Statement of Appeal** for your information.

The hearing regarding this matter has been scheduled for **August 13, 2014, at 5:00 p.m., City Hall, Room 416**, One Dr. Carlton B. Goodlett Place.

If you have any further questions, you may call this office at (415) 575-6880.

Sincerely,

BOARD STAFF

cc: DPW BSM

AT&T California, Appellant
c/o Foster Johnson, Attorney for Appellant
3000 El Camino Real, Two Palo Alto Square #300
Palo Alto, CA 94306



Date Filed:

BOARD OF APPEALS

JUN 09 2014

APPEAL # 14-113

**CITY & COUNTY OF SAN FRANCISCO
BOARD OF APPEALS**

PRELIMINARY STATEMENT OF APPEAL

I / We, **AT&T California**, hereby appeal the following departmental action: **DENIAL** of **UTILITY EXCAVATION PERMIT 14EXC-3185** by the **Department of Public Works Bureau of Street Use and Mapping** which was issued or became effective on: **May 28, 2014**, for the property located at: **996 Cayuga Avenue**.

BRIEFING SCHEDULE:

The Appellant may, but is not required to, submit a one page (double-spaced) supplementary statement with this Preliminary Statement of Appeal. No exhibits or other submissions are allowed at this time.

Appellant's Brief is due on or before: **July 24, 2014, (no later than three (3) Thursdays prior to the hearing date)**, up to 12 pages in length, double-spaced, with unlimited exhibits, with an original and 10 copies delivered to the Board office by 4:30 p.m., and with additional copies delivered to the other parties the same day.

O-DPW
Respondent's and Other Parties' Briefs are due on or before: **August 07, 2014, (no later than one (1) Thursday prior to hearing date)**, up to 12 pages in length, doubled-spaced, with unlimited exhibits, with an original and 10 copies delivered to the Board office by 4:30 p.m., and with additional copies delivered to the other parties the same day.

Only photographs and drawings may be submitted by the parties at hearing.

Hearing Date: **Wednesday, August 13, 2014, 5:00 p.m., City Hall, Room 416, One Dr. Carlton B. Goodlett Place.**

All parties to this appeal must adhere to the briefing schedule above, however if the hearing date is changed, the briefing schedule MAY also be changed. Written notice will be provided of any change to the briefing schedule.

In order to have their documents sent to the Board members prior to hearing, **members of the public** should submit an original and 10 copies of all documents of support/opposition no later than one (1) Thursday prior to hearing date by 4:30 p.m. Please note that names and contact information included in submittals from members of the public will become part of the public record. Submittals from members of the public may be made anonymously.

Please note that in addition to the parties' briefs, any materials that the Board receives relevant to this appeal, including letters of support/opposition from members of the public, are distributed to Board members prior to hearing. All such materials are available for inspection at the Board's office. You may also request a copy of the packet of materials that are provided to Board members at a cost of 10 cents per page, per S.F. Admin. Code Ch. 67.28.

If you have any questions please call the Board of Appeals at 415-575-6880

The reasons for this appeal are as follows:

see attached.

Appellant or Agent (Circle One):

Signature: _____

Print Name: _____

[Handwritten signature and name: Foster J. ...]

AT&T's Supplementary Statement Regarding Appeal From Denial of Permit Application
14EXC-3185

AT&T is in the process of upgrading its network within the City to enable the provision of high-speed communications services, including its U-verse video service. In 2005, the Department of Public Works ("DPW") issued its Order No. 175,566 (the "SMF Order"), which requires that, before AT&T can even apply for an excavation permit, it must obtain DPW approval of the proposed location through a "pre-application" process. In Order 182608, DPW denied such approval for placement of facilities near 996 Cayuga Avenue. DPW's action was improper because:

- (1) Order 182608 violates the SMF Order. Among other things, under the SMF Order, DPW is not permitted to disapprove AT&T's pre-application request, but may only (1) approve the proposed location, (2) approve a feasible alternative location identified through the specified notice and public hearing process, and/or (3) recommend reasonable changes to the installation at one of the locations. Order 182458, however, did none of these things. Instead, the Order found that an alternative location had been identified as potentially feasible by the community and AT&T, but did not approve any of the proposed locations as required by the SMF Order.
- (2) Order 182608 violates AT&T's rights under Sections 7901 and 5885 of the California Public Utilities Code, which grant AT&T, as a telephone company and as a franchised video provider, the right to construct its facilities in the public rights-of-way.
- (3) Order 182608 also violates Section 5885 because DPW has failed to act on requests to place facilities subject to that Section within 60 days.

AT&T subsequently filed an application for an excavation permit for 996 Cayuga Avenue numbered 14EXC-3185, which was denied because the site had not been approved pursuant to the SMF Order. AT&T requests that the denial of the excavation permit be reversed.

BOARD OF APPEALS

JUN 09 2014
APPEAL # 14-113

City and County of San Francisco



Edwin M. Lee, Mayor
Mohammed Nuru, Director

San Francisco Department of Public Works
Office of the Deputy Director for Capital Programs
Bureau of Street-Use and Mapping
875 Stevenson St., Rm. 480
San Francisco, CA 94103
(415) 554-5810 ■ www.sfdpw.org



Jerry Sanguinetti, Bureau Manager

May 28, 2014

AT&T California
795 Folsom Street, Suite 426
San Francisco, CA 94107

Subject: Denial of Utility Excavation Permit Application 14EXC-3185 – AT&T

Dear AT&T,

On May 28, 2014, Department of Public Works (DPW) received AT&T's permit application 14EXC-3185 for excavation in the public right-of-way related to installing a surface-mounted facility in the vicinity of 996 Cayuga Avenue (13SMF-0376).

DPW denies the excavation permit per Director's Decision disapproving the placement of a surface-mounted facility at this location (DPW Order 182,608).

If you have any questions, please email smf@sfdpw.org, or call me at (415) 554-5810.

Sincerely,

Gene Chan

Gene Chan
Department of Public Works
Bureau of Street-Use and Mapping

BOARD OF APPEALS

JUN 09 2014

APPEAL #

14-113



Making San Francisco a beautiful, livable, vibrant, and sustainable city.



(415) 554-5810
FAX (415) 554-6161
http://www.sfdpw.org

Department of Public Works
Bureau of Street-Use and Mapping
1155 Market St, 3rd Floor
San Francisco, CA 94103

14EXC-3185

Utility Excavation Permit

Address : CAYUGA AVE;
VALERTON CT to ONONDAGA
AVE (952 - 999)

Block: Lot: Zip:

Pursuant to Article 2.4 of the Public Works Code in conjunction to DPW Order 178,940 permission, revocable at the will of the Director of Public Works, to excavate and restore the public right-of-way is granted to Permittee.

Name: SBC - Pacific Bell Engineering
Address: 795 Folsom Street, Room 426 San Francisco, CA 94107-1243
Contact: Bob Rickard Phone: (415) 644-7057

Conditions	Denied per DPW Order 182608
Emergency Confirmation Number	
24 Hour / 7 Day Contact:	Lynn Schussel (415) 644-7057
Service Address/Project:	996 Cayuga Ave at Onondaga Ave LSMF JU 9354808 65G (13SMF-0376)
Start Date	06/02/2014
Permit expires on:	7/16/2014
Purpose	Telephone
Excavation Reason	Install New Cabinet
Excavation Reason Description	
Method:	Open Cut: Sawcut
Tracking Number 1	9354808 R401 4C
Tracking Number 2	13SMF-0376 SF06-410202
Project Size	24
Inspection	

The undersigned Permittee hereby agrees to comply with all requirements and conditions noted on this permit

****When drilling/excavating in sidewalk area, entire flag(s) must be replaced.****

Applicant/Permittee

Date

Distribution:
Inside BSM: Utility Inspection

Printed : 5/28/2014 1:40:16 PM

Plan Checker

Geoffrey Schneider

STREET EXCAVATION REQUIREMENTS:

1. The permittee shall call Underground Service Alert (USA); telephone number 1-800-227-2600, 48 hours prior to any excavation.
2. All work including sidewalk and pavement cutting and removal, lagging, excavation, backfill, and sidewalk and pavement restoration shall be done by a licensed paving contractor and in accordance with the requirements of the Standard Specifications of the Bureau of Engineering, Department of Public Works, July 1986 Edition and Department of Public Works Order Nos. 176,707, copy attached.
3.
 - a. DPW Order 181,305, dated 6/17/12, Reinforced Concrete Bus pads, shall be constructed in accordance with SFPDW Standard Plan, File No. 96,607 and SFPDW Standard Specification Section 210 except that the concrete bus pad shall have a minimum compressive strength of 5,000 psi. Concrete bus pads shall be constructed at a minimum thickness of 10 to 12 inches and shall be approximately 10-feet wide.
 - b. DPW Order 181,306 dated 9/26/10; Reinforced concrete sidewalk, shall be constructed in accordance with the SFPDW Standard Plan File No. 96,608 and SFPDW Standard Specification Section 204 with #3 steel reinforced bars at mid-depth of the concrete sidewalk slab.
4. Sidewalk and pavement restoration shall include the replacement of traffic lane and crosswalk striping, parking stall markings, and curb painting that might have been obliterated during street excavation. The permittee shall perform their work under on the following options:
 - a. Have the City forces do the striping and painting work at the permittee's expense. The permittee shall make a deposit with the Department of Parking & Traffic for this purpose in an amount estimated by the Municipal Transportation Agency (MTA) 7th Floor 1 South Van Ness Ave telephone 701-4500, and notify the MTA at least 48 hours in advance of the time the work is to be done.
 - b. Perform the work themselves following instructions available at the Department of Parking & Traffic.
5. The permittee shall submit a non-refundable fee to Bureau of Street-Use and Mapping to pay for City inspection of the backfill and pavement restoration. At least 48 hours in advance, the permittee shall make arrangements with the Street Improvement Section Inspectors, 554-7149, for an inspection schedule.
6. The permittee shall file and maintain an excavation bond in the sum of \$25,000.00 with the Department of Public Works, to guarantee the maintenance of the pavement in the excavation area for a period of 3 years following the completion of the backfill and pavement restoration pursuant to Article 2.4.40 of the Public Works Code.
7. The permittee shall conduct construction operations in accordance with the requirements of Article 11 of the Traffic Code. The permittee shall contact the MTA 7th Floor 1 South Van Ness Ave telephone 701-4500, for specific restrictions before starting work.
8. The permittee shall obtain the required permits, if any, from regulating agencies of the State of California.
9. The permittee shall verify the locations of any City or public service utility company facilities that may be affected by the work authorized by this permit and shall assume all responsibility for any damage to such facilities. The permittee shall make satisfactory arrangements and payments for any necessary temporary relocation of City or public utility company facilities.
10. The permittee shall pay the required fee for sewer installation permit at the Plumbing Inspection Division, Department of Building Inspection, 1660 Mission Street and arrange for inspection of this work, telephone 558-8054.
11. Concrete form work, planting of trees and pouring of sidewalk and/or curb shall not be performed prior to obtaining a permit from Bureau of Urban Forestry (BUF), telephone: 554-6700.
12. Per DPW Order 178,806, the recycling of Cobble Stones and Granite Curb shall follow as:
 - a. Cobblestones shall be clean of dirt prior to transporting. Extreme care shall be taken during the transporting the cobblestones to minimize damage before delivery to City. The cobblestones shall be neatly and securely placed on pallets so they can be moved about safely after the delivery. The Minimum size of cobblestone shall be 4 inches square (16 square inches). The cobblestones shall be delivered, including off loading, to the lower lot at the Cesar Chavez Street Yard located at 2323 Cesar Chavez Street or at alternative location directed by the Department within the City of San Francisco. Contact the Department forty-eight hours (48 hours) prior to delivery. The Department can be reached at (415) 641-2627.
 - b. Granite Curb shall be neatly and securely placed on pallets so they can be moved about safely after delivery. The Contractor shall exercise care in transporting the granite curb to minimize damage. The length limit of recyclable granite curbs shall be no less than four feet. The granite curb shall be delivered, including off loading, to the back lot at the Griffith Pump Station located at 1105 Thomas Street or at an alternative location directed by the Department within the City of San Francisco. Contact Bureau of Street and Sewer Repair (BSSR) at least forty-eight hours (48 hours) prior to delivery. BSSR can be reached at (415) 695-2087.
13. In consideration of this Permit being issued for the work described in the application, Permittee on its behalf and that of any successor or assign, and on behalf of any lessee, promises and agrees to perform all the terms of this Permit and to comply with all applicable laws, ordinances and regulations.
14. Permittee agrees on its behalf and that of any successor or assign to hold harmless, defend, and indemnify the City and County of San Francisco, including, without limitation, each of its commissions, departments, officers, agents and employees (hereinafter collectively referred to as the "City") from and against any and all losses, liabilities, expenses, claims, demands, injuries, damages, fines, penalties, costs or judgments including, without limitation, attorneys' fees and costs (collectively, "claims") of any kind allegedly arising directly or indirectly from (i) any act by, omission by, or negligence of, Permittee or its subcontractors, or the officers, agents, or employees of either, while engaged in the performance of the work authorized by this Permit, or while in or about the property subject to this Permit for any reason connected in any way whatsoever with the performance of the work authorized by this Permit; or allegedly resulting directly or indirectly from the maintenance or installation of any equipment, facilities or structures authorized under this Permit, (ii) any accident or injury to any contractor or subcontractor, or any officer, agent, or employee of either of them, while engaged in the performance of the work authorized by this Permit, or while in or about the property, for any reason connected with the performance of the work authorized by this Permit, or arising from liens or claims for services rendered or labor or materials furnished in or for the performance of the work authorized by this Permit, (iii) injuries or damages to real or personal property, good will, and persons in, upon or in any way allegedly connected with the work authorized by this Permit from any cause or claims arising at any time, and (iv) any release or discharge, or threatened release or discharge, of any hazardous material caused or allowed by Permittee in, under, on or about the property subject to this Permit or into the environment. As used herein, "hazardous material" means any substance, waste or material which, because of its quantity, concentration of physical or chemical characteristics is deemed by any federal, state, or local governmental authority to pose a present or potential hazard to human health or safety or to the environment.
15. Permittee must hold harmless, indemnify and defend the City regardless of the alleged negligence of the City or any other party, except only for claims resulting directly from the sole negligence or willful misconduct of the City. Permittee specifically acknowledges and agrees that it has an immediate and independent obligation to defend the City from any claim which actually or potentially falls within this indemnity provision, even if the allegations are or may be groundless, false or fraudulent, which obligation arises at the time such claim is tendered to Permittee by the City and continues at all times thereafter. Permittee agrees that the indemnification obligations assumed under this Permit shall survive expiration of the Permit or completion of work.
16. Permittee shall obtain and maintain through the terms of this Permit general liability, automobile liability or workers' compensation insurance as the City deems necessary to protect the City against claims for damages for personal injury, accidental death and property damage allegedly arising from any work done under this Permit. Such insurance shall in no way limit Permittee's indemnity hereunder. Certificates of insurance, in form and with insurers satisfactory to the City, evidencing all coverages above shall be furnished to the City before commencing any operations under this Permit, with complete copies of policies furnished promptly upon City request.
17. The permittee and any permitted successor or assign recognize and understand that this permit may create a possessory interest.

"IMPROVING THE QUALITY OF LIFE IN SAN FRANCISCO" We are dedicated individuals committed to teamwork, customer service and continuous improvement in partnership with the community.

Customer Service

Teamwork

Continuous Improvement

Permit Addresses

*RW = RockWheel, SMC = Surface Mounted Cabinets, S/W = Sidewalk Work, DB = Directional Boring,
 BP= Reinforced Concrete Bus Pad, UB = Reinforced Concrete for Utility Pull Boxes and Curb Ramps

Number of blocks: 1 Total repair size:24 sqft Total Streetspace: Total Sidewalk: sqft

ID	Street Name	From St	To St	Sides	*Other	Asphalt	Concrete	Street Space Feet	Sidewalk Feet
1	CAYUGA AVÉ	VALERTON CT	ONONDAGA AVE	West	RW : False SMC : True S/W Only : True DB: False BP: False UB: True	0	24		

This is NOT a Permit

Exceptions

From St	To St	Message	Job	Contact	Dates
VALERTON CT	ONONDAGA AVE -	Proposed Excavation	AT&T - Construction and Engineering	Paul Lucq -	Oct 14 2014-Jan 11 2015

Permit

No Diagram submitted

City and County of San Francisco



Edwin M. Lee, Mayor
Mohammed Nuru, Director

San Francisco Department of Public Works
Office of the Deputy Director & City Engineer, Fuad Sweiss
Bureau of Street-Use & Mapping
1155 Market Street, 3rd Floor
San Francisco Ca 94103
(415) 554-5810 • www.sfdpw.org



Jerry Sangulnetti, Bureau Manager

DPW Order No: 182608

DIRECTOR'S DECISION REGARDING AT&T CALIFORNIA'S REQUEST TO INSTALL A SURFACE MOUNTED FACILITY IN THE VICINITY OF 996 Cayuga Avenue (13SMF-0376)

APPLICANT: AT&T CALIFORNIA
795 Folsom Street, #426
San Francisco, Ca 94107

DESCRIPTION OF REQUEST: Surface Mounted Facility Installation

BACKGROUND:

1. On **October 18, 2013**, the Applicant (AT&T California) filed an application with the Department of Public Works (DPW) to install a Surface-Mounted Facility (SMF) at **996 Cayuga Avenue**.
2. On **March 13, 2014**, the applicant mailed and posted Notices of Intent (NOI) to all businesses and residences within a 300-foot radius of the subject location.
3. DPW received **one (1)** objection to the application during the 20-day notification period. DPW subsequently scheduled a public hearing to consider testimony received for this site. The objections and comments included:
 - Cabinet will lower property values.
 - There is already a cabinet across the street.
 - Cabinet will be visible and an eyesore.
 - Neighbors are trying to plant trees in the area.
4. On **April 28, 2014**, DPW Hearing Officer **Janet Ng** conducted a hearing on the application to consider testimony regarding the subject SMF.
5. At the hearing, Arianna Urban of DPW presented a summary of the permit applications stating that the Applicant was in compliance with DPW's technical requirements and state and federal regulations.
6. At the hearing, **Ms. Tedi Vriheas** of AT&T stated a box walk was conducted on **April 16, 2014** and two (2) members of the community attended. During the box walk, community members and AT&T located the following potentially feasible alternate location(s):
 - Adjacent to Balboa High School: not feasible due to school's historic status.
 - 97 Onondaga St.: ~114 feet from SAI; complies with AT&T's technical requirements.



San Francisco Department of Public Works
Making San Francisco a beautiful, livable, vibrant, and sustainable city.

7. At the hearing, two members of the community testified at the hearing in opposition to the proposed installation of the SMF cabinet in the vicinity of **996 Cayuga Avenue**. Testimony included:

- Alternate location at 97 Onondaga Street is preferred.

RECOMMENDATION: **DISAPPROVE** the request by AT&T to locate Surface Mounted Facility **13SMF-0376**, in the vicinity of **996 Cayuga Avenue**.

FINDINGS:

1. The Hearing Officer reviewed the application, materials from DPW's files, the objections, additional materials submitted by the applicant and persons protesting the application, and the testimony at the hearing.
2. There is potential for the applicant, AT&T, to install the surface-mounted facility in other acceptable locations that may have less of an impact on the convenience and necessities of the property owners and occupants in the immediate vicinity of the surface-mounted facility.
3. It remains unclear if there may be other locations that may cause the least inconvenience to tenants, property owners, and users of the public right-of-way.
4. Applicant is suggested to submit an application for the alternate location(s) and any other acceptable locations for review by DPW and the community.
5. The Director of Public Works has reviewed the Hearing Officer's recommendation. The Director of Public Works hereby adopts the hearing officer's recommendation.

APPEAL PROCESS: This decision may then be appealed to the Board of Appeals within fifteen (15) calendar days of DPW's approval or denial of an Excavation Permit to install surface mounted facilities **13SMF-0376 in the vicinity of 996 Cayuga Avenue**. The Board of Appeals is located at 1650 Mission Street, Suite 304. To obtain further information regarding the appeal process, you can contact the Board of Appeals at 415-575-6880. You can also visit the Board of Appeals website at: <http://www.sfgov.org/index.aspx?page=755>.

5/27/2014

5/27/2014

X

Sanguinetti, Jerry
Bureau Manager

X

Swells, Fuad
Deputy Director and City Engineer

5/27/2014

X

Mohammed Nuru

Nuru, Mohammed
Director, DPW



EXHIBIT B



June 09, 2014

Lynn Fong, Manager
Department of Public Works Bureau of Street-Use and Mapping
1155 Market Street, 3rd Floor
San Francisco, CA 94103

Appeal No.: 14-111
Appeal Title: AT&T California vs. DPW-BSM
Subject Property: 326 Craut Street
Permit Type: UTILITY EXCAVATION PERMIT
Permit No.: 14EXC-3134

Dear Lynn Fong, Manager:

This is to notify you that an appeal has been filed with this office protesting the **DENIAL** of the above referenced **UTILITY EXCAVATION PERMIT**.

We are enclosing a copy of the **Preliminary Statement of Appeal** for your information.

The hearing regarding this matter has been scheduled for **August 13, 2014, at 5:00 p.m., City Hall, Room 416**, One Dr. Carlton B. Goodlett Place.

If you have any further questions, you may call this office at (415) 575-6880.

Sincerely,

BOARD STAFF

cc: DPW BSM

AT&T California, Appellant
c/o Foster Johnson, Attorney for Appellant
3000 El Camino Real, Two Palo Alto Square #300
Palo Alto, CA 94306



BOARD OF APPEALS

Date Filed:

JUN 09 2014

APPEAL # 14-111

**CITY & COUNTY OF SAN FRANCISCO
BOARD OF APPEALS**

PRELIMINARY STATEMENT OF APPEAL

I / We, **AT&T California**, hereby appeal the following departmental action: **DENIAL** of **UTILITY EXCAVATION PERMIT 14EXC-3134** by the **Department of Public Works Bureau of Street Use and Mapping** which was issued or became effective on: **May 23, 2014**, for the property located at: **326 Craut Street**.

BRIEFING SCHEDULE:

The Appellant may, but is not required to, submit a one page (double-spaced) supplementary statement with this Preliminary Statement of Appeal. No exhibits or other submissions are allowed at this time.

Appellant's Brief is due on or before: **July 24, 2014, (no later than three (3) Thursdays prior to the hearing date)**, up to 12 pages in length, double-spaced, with unlimited exhibits, with an original and 10 copies delivered to the Board office by 4:30 p.m., and with additional copies delivered to the other parties the same day.

Dpw
Respondent's and Other Parties' Briefs are due on or before: **August 07, 2014, (no later than one (1) Thursday prior to hearing date)**, up to 12 pages in length, doubled-spaced, with unlimited exhibits, with an original and 10 copies delivered to the Board office by 4:30 p.m., and with additional copies delivered to the other parties the same day.

Only photographs and drawings may be submitted by the parties at hearing.

Hearing Date: **Wednesday, August 13, 2014, 5:00 p.m., City Hall, Room 416, One Dr. Carlton B. Goodlett Place.**

All parties to this appeal must adhere to the briefing schedule above, however if the hearing date is changed, the briefing schedule MAY also be changed. Written notice will be provided of any change to the briefing schedule.

In order to have their documents sent to the Board members prior to hearing, **members of the public** should submit an original and 10 copies of all documents of support/opposition no later than one (1) Thursday prior to hearing date by 4:30 p.m. Please note that names and contact information included in submittals from members of the public will become part of the public record. Submittals from members of the public may be made anonymously.

Please note that in addition to the parties' briefs, any materials that the Board receives relevant to this appeal, including letters of support/opposition from members of the public, are distributed to Board members prior to hearing. All such materials are available for inspection at the Board's office. You may also request a copy of the packet of materials that are provided to Board members at a cost of 10 cents per page, per S.F. Admin. Code Ch. 67.28.

If you have any questions please call the Board of Appeals at 415-575-6880

The reasons for this appeal are as follows:

see attached.

Appellant or Agent (Circle One):

Signature: _____

Print Name: _____

Foster Johnson

AT&T's Supplementary Statement Regarding Appeal From Denial of Permit Application
14EXC-3134

AT&T is in the process of upgrading its network within the City to enable the provision of high-speed communications services, including its U-verse video service. In 2005, the Department of Public Works ("DPW") issued its Order No. 175,566 (the "SMF Order"), which requires that, before AT&T can even apply for an excavation permit, it must obtain DPW approval of the proposed location through a "pre-application" process. In Order 182589, DPW denied such approval for placement of facilities near 326 Craut Street. DPW's action was improper because:

- (1) Order 182589 violates the SMF Order. Among other things, under the SMF Order, DPW is not permitted to disapprove AT&T's pre-application request, but may only (1) approve the proposed location, (2) approve a feasible alternative location identified through the specified notice and public hearing process, and/or (3) recommend reasonable changes to the installation at one of the locations. Order 182589, however, did none of these things. Instead, the Order found that an alternative location had been identified as potentially feasible by the community and AT&T, but did not approve any of the proposed locations as required by the SMF Order.
- (2) Order 182589 violates AT&T's rights under Sections 7901 and 5885 of the California Public Utilities Code, which grant AT&T, as a telephone company and as a franchised video provider, the right to construct its facilities in the public rights-of-way.
- (3) Order 182589 also violates Section 5885 because DPW has failed to act on requests to place facilities subject to that Section within 60 days.

AT&T subsequently filed an application for an excavation permit for 326 Craut Street numbered 14EXC-3134, which was denied because the site had not been approved pursuant to the SMF Order. AT&T requests that the denial of the excavation permit be reversed.

BOARD OF APPEALS
JUN 09 2014
APPEAL # 14-111

City and County of San Francisco



Edwin M. Lee, Mayor
Mohammed Nuru, Director

San Francisco Department of Public Works

Office of the Deputy Director for Capital Programs
Bureau of Street-Use and Mapping
875 Stevenson St., Rm. 460
San Francisco, CA 94103
(415) 554-5810 or www.sfdpw.org



Jerry Sanguinetti, Bureau Manager

May 23, 2014

AT&T California
795 Folsom Street, Suite 426
San Francisco, CA 94107

Subject: Denial of Utility Excavation Permit Application 14EXC-3134 – AT&T

Dear AT&T,

On May 22, 2014, Department of Public Works (DPW) received AT&T's permit application 14EXC-3134 for excavation in the public right-of-way related to installing a surface-mounted facility in the vicinity of 326 Craut Street (13SMF-0407).

DPW denies the excavation permit per Director's Decision disapproving the placement of a surface-mounted facility at this location (DPW Order 182,589).

If you have any questions, please email smf@sfdpw.org, or call me at (415) 554-5810.

Sincerely,

Gene Chan

Gene Chan
Department of Public Works
Bureau of Street-Use and Mapping

BOARD OF APPEALS

JUN 09 2014

APPEAL # 14-111



San Francisco Department of Public Works
Making San Francisco a beautiful, livable, vibrant, and sustainable city.



(415) 554-5810
FAX (415) 554-6161
http://www.sfdpw.org

Department of Public Works
Bureau of Street-Use and Mapping
1155 Market St, 3rd Floor
San Francisco, CA 94103

14EXC-3134

Utility Excavation Permit

**Address : CRAUT ST: MAYNARD
ST to SILVER AVE (300 - 399)**

Block: Lot: Zip:

Pursuant to Article 2.4 of the Public Works Code in conjunction to DPW Order 178,940 permission, revocable at the will of the Director of Public Works, to excavate and restore the public right-of-way is granted to Permittee.

Name: SBC - Pacific Bell Engineering
Address: 795 Folsom Street, Room 426 San Francisco, CA 94107-1243
Contact: Bob Pickard **Phone:** (415) 644-7057

Conditions	Denied per DPW Order 182589.
Emergency Confirmation Number	
24 Hour / 7 Day Contact:	Lynn Schussel (415) 644-7043
Service Address/Project:	326 Craut St at Silver Ave LSMF JU 9390985 70F (13SMF-0407)
Start Date	05/30/2014
Permit expires on:	7/13/2014
Purpose	Telephone
Excavation Reason	Install New Cabinet
Excavation Reason Description	
Method:	Open Cut: Sawcut
TrackingNumber1	9390985 R401 4C
TrackingNumber2	13SMF-0407 SF06-280301
Project Size	24
Inspection	This permit is invalid until the permittee contacts DPW at 554-5870 to activate the permit and schedule an inspection at least 72 hours prior to work. Failure to comply with the stated conditions will render this permit null and void.

The undersigned Permittee hereby agrees to comply with all requirements and conditions noted on this permit

****When drilling/excavating in sidewalk area, entire flag(s) must be replaced.****

Applicant/Permittee

Date

Distribution:
Inside BSM: Utility Inspection

Printed : 5/23/2014 2:17:47 PM Plan Checker

STREET EXCAVATION REQUIREMENTS:

1. The permittee shall call Underground Service Alert (U.S.A.), telephone number 1-800-227-2600, 48 hours prior to any excavation.
2. All work including sidewalk and pavement cutting and removal, lagging, excavation, backfill, and sidewalk and pavement restoration shall be done by a licensed paving contractor and in accordance with the requirements of the Standard Specifications of the Bureau of Engineering, Department of Public Works, July 1986 Edition and Department of Public Works Order Nos. 176,707, copy attached.
3.
 - a. DPW Order 181,305, dated 6/17/13, Reinforced Concrete Bus pads, shall be constructed in accordance with SFPDW Standard Plan, File No. 96,607 and SFPDW Standard Specification Section 210 except that the concrete bus pad shall have a minimum compressive strength of 5,000 psi. Concrete bus pads shall be constructed at a minimum thickness of 10 to 12 inches and shall be approximately 10-feet wide.
 - b. DPW Order 181,308 dated 9/26/13, Reinforced concrete sidewalk, shall be constructed in accordance with the SFPDW Standard Plan File No. 96,608 and SFPDW Standard Specification Section 204 with #3 steel reinforced bars at mid-depth of the concrete sidewalk slab.
4. Sidewalk and pavement restoration shall include the replacement of traffic lane and crosswalk striping, parking stall markings, and curb painting that might have been obliterated during street excavation. The permittee shall perform their work under on the following options:
 - a. Have the City forces do the striping and painting work at the permittee's expense. The permittee shall make a deposit with the Department of Parking & Traffic for this purpose in an amount estimated by the Municipal Transportation Agency (MTA) 7th Floor 1 South Van Ness Ave telephone 701-4500, and notify the MTA at least 48 hours in advance of the time the work is to be done.
 - b. Perform the work themselves following instructions available at the Department of Parking & Traffic.
5. The permittee shall submit a non-refundable fee to Bureau of Street-Use and Mapping to pay for City Inspection of the backfill and pavement restoration. At least 48 hours in advance, the permittee shall make arrangements with the Street Improvement Section Inspectors, 554-7149, for an inspection schedule.
6. The permittee shall file and maintain an excavation bond in the sum of \$25,000.00 with the Department of Public Works, to guarantee the maintenance of the pavement in the excavation area for a period of 3 years following the completion of the backfill and pavement restoration pursuant to Article 2.4.40 of the Public Works Code.
7. The permittee shall conduct construction operations in accordance with the requirements of Article 11 of the Traffic Code. The permittee shall contact the MTA 7th Floor 1 South Van Ness Ave telephone 701-4500, for specific restrictions before starting work.
8. The permittee shall obtain the required permits, if any, from regulating agencies of the State of California.
9. The permittee shall verify the locations of any City or public service utility company facilities that may be affected by the work authorized by this permit and shall assume all responsibility for any damage to such facilities. The permittee shall make satisfactory arrangements and payments for any necessary temporary relocation of City or public utility company facilities.
10. The permittee shall pay the required fee for sewer installation permit at the Plumbing Inspection Division, Department of Building Inspection, 1660 Mission Street and arrange for inspection of this work, telephone 558-6054.
11. Concrete form work, planting of trees and pouring of sidewalk and/or curb shall not be performed prior to obtaining a permit from Bureau of Urban Forestry (BUF), telephone: 554-6700.
12. Per DPW Order 178,806, the recycling of Cobble Stones and Granit Curb shall follow as:
 - a. Cobblestones shall be clean of dirt prior to transporting. Extreme care shall be taken during the transporting the cobblestones to minimize damage before delivery to City. The cobblestones shall be neatly and securely placed on pallets so they can be moved about safely after the delivery. The Minimum size of cobblestone shall be 4 inches square (16 square inches). The cobblestones shall be delivered, including off loading, to the lower lot at the Cesar Chavez Street Yard located at 2323 Cesar Chavez Street or at alternative location directed by the Department within the City of San Francisco. Contact the Department forty-eight hours (48 hours) prior to delivery. The Department can be reached at (415) 641-2627.
 - b. Granite Curb shall be neatly and securely placed on pallets so they can be moved about safely after delivery. The Contractor shall exercise care in transporting the granite curb to minimize damage. The length limit of recyclable granite curbs shall be no less than four feet. The granite curb shall be delivered, including off loading, to the back lot at the Griffith Pump Station located at 1105 Thomas Street or at an alternative location directed by the Department within the City of San Francisco. Contact Bureau of Street and Sewer Repair (BSSR) at least forty-eight hours (48 hours) prior to delivery. BSSR can be reached at (415) 695-2087.
13. In consideration of this Permit being issued for the work described in the application, Permittee on its behalf and that of any successor or assign, and on behalf of any lessee, promises and agrees to perform all the terms of this Permit and to comply with all applicable laws, ordinances and regulations.
14. Permittee agrees on its behalf and that of any successor or assign to hold harmless, defend, and indemnify the City and County of San Francisco, including, without limitation, each of its commissions, departments, officers, agents and employees (hereinafter collectively referred to as the "City") from and against any and all losses, liabilities, expenses, claims, demands, injuries, damages, fines, penalties, costs or judgments including, without limitation, attorneys' fees and costs (collectively, "claims") of any kind allegedly arising directly or indirectly from (i) any act by, omission by, or negligence of, Permittee or its subcontractors, or the officers, agents, or employees of either, while engaged in the performance of the work authorized by this Permit, or while in or about the property subject to this Permit for any reason connected in any way whatsoever with the performance of the work authorized by this Permit, or allegedly resulting directly or indirectly from the maintenance or installation of any equipment, facilities or structures authorized under this Permit, (ii) any accident or injury to any contractor or subcontractor, or any officer, agent, or employee of either of them, while engaged in the performance of the work authorized by this Permit, or while in or about the property, for any reason connected with the performance of the work authorized by this Permit, or arising from liens or claims for services rendered or labor or materials furnished in or for the performance of the work authorized by this Permit, (iii) injuries or damages to real or personal property, good will, and persons in, upon or in any way allegedly connected with the work authorized by this Permit from any cause or claims arising at any time, and (iv) any release or discharge, or threatened release or discharge, of any hazardous material caused or allowed by Permittee in, under, on or about the property subject to this Permit or into the environment. As used herein, "hazardous material" means any substance, waste or material which, because of its quantity, concentration of physical or chemical characteristics is deemed by any federal, state, or local governmental authority to pose a present or potential hazard to human health or safety or to the environment.
15. Permittee must hold harmless, indemnify and defend the City regardless of the alleged negligence of the City or any other party, except only for claims resulting directly from the sole negligence or willful misconduct of the City. Permittee specifically acknowledges and agrees that it has an immediate and independent obligation to defend the City from any claim which actually or potentially falls within this indemnity provision, even if the allegations are or may be groundless, false or fraudulent, which obligation arises at the time such claim is tendered to Permittee by the City and continues at all times thereafter. Permittee agrees that the indemnification obligations assumed under this Permit shall survive expiration of the Permit or completion of work.
16. Permittee shall obtain and maintain through the terms of this Permit general liability, automobile liability or workers' compensation insurance as the City deems necessary to protect the City against claims for damages for personal injury, accidental death and property damage allegedly arising from any work done under this Permit. Such insurance shall in no way limit Permittee's indemnity hereunder. Certificates of insurance, in form and with insurers satisfactory to the City, evidencing all coverages above shall be furnished to the City before commencing any operations under this Permit, with complete copies of policies furnished promptly upon City request.
17. The permittee and any permitted successor or assign recognize and understand that this permit may create a possessory interest.

"IMPROVING THE QUALITY OF LIFE IN SAN FRANCISCO" We are dedicated individuals committed to teamwork, customer service and continuous improvement in partnership with the community.

Customer Service

Teamwork

Continuous Improvement

This is NOT a Permit

Permit Addresses

*RW = RockWheel, SMC = Surface Mounted Cabinets, S/W = Sidewalk Work, DB = Directional Boring,
BP= Reinforced Concrete Bus Pad, UB = Reinforced Concrete for Utility Pull Boxes and Curb Ramps

Number of blocks: 1 Total repair size:24 sqft Total Streetspace: Total Sidewalk: sqft

ID	Street Name	From St	To St	Sides	*Other	Asphalt	Concrete	Street Space Feet	Sidewalk Feet
1	CRAUT ST	MAYNARD ST	SILVER AVE	West	RW : False SMC : True S/W Only : True DB: False BP: False UB: True	0	24		

This is NOT a Permit

Exceptions

#554-5827

Street Name	From St	To St	Message	Job	Contact	Dates
-------------	---------	-------	---------	-----	---------	-------

MAYNARD ST	SILVER AVE -	Proposed Excavation.	AT&T - Construction and Engineering	Dana Nell -	Sep 9 2014-Dec 7 2014
------------	--------------	----------------------	-------------------------------------	-------------	-----------------------

MAYNARD ST	SILVER AVE -	Prior to performing any construction all CCSF survey monuments shall be referenced by a licensed Land Surveyor, on a Corner Record or a Record of Survey, if any construction will take place within 10ft of the monument. For any questions, please call Mapping at #554-5827	Stone or Concrete Monument		
------------	--------------	--------------------------------------------------------------------------------------------------------------------------------------------------------------------------------------------------------------------------------------------------------------------------------	----------------------------	--	--

THIS IS NOT A RECORD

"IMPROVING THE QUALITY OF LIFE IN SAN FRANCISCO" We are dedicated individuals committed to teamwork, customer service and continuous improvement in partnership with the community.

Customer Service

Teamwork

Continuous Improvement

No Diagram submitted

City and County of San Francisco



Edwin M. Lee, Mayor
Mohammed Nuru, Director

San Francisco Department of Public Works
Office of the Deputy Director & City Engineer, Fuad Swells
Bureau of Street-Use & Mapping
1155 Market Street, 3rd Floor
San Francisco Ca 94103
(415) 554-5810 www.sfdpw.org



Jerry Sanguinetti, Bureau Manager

DPW Order No: 182589

DIRECTOR'S DECISION REGARDING AT&T CALIFORNIA'S REQUEST TO INSTALL A SURFACE MOUNTED FACILITY IN THE VICINITY OF **326 Craut Street (13SMF-0407)**

APPLICANT: AT&T CALIFORNIA
795 Folsom Street, #426
San Francisco, Ca 94107

DESCRIPTION OF REQUEST: Surface Mounted Facility Installation

BACKGROUND:

1. On **November 15, 2013**, the Applicant (AT&T California) filed an application with the Department of Public Works (DPW) to install a Surface-Mounted Facility (SMF) at **326 Craut Street**.
2. On **March 10, 2014**, the applicant mailed and posted Notices of Intent (NOI) to all businesses and residences within a 300-foot radius of the subject location.
3. DPW received **three (3)** objections to the application during the 20-day notification period. DPW subsequently scheduled a public hearing to consider testimony received for this site. The objections and comments included:
 - Additional cabinet would not be in best interest of neighborhood.
 - Existing cabinets attract garbage, urine, and used clothing.
 - It is an eyesore and would lower property values.
 - Small children may be harmed.
 - Attracts unruly people who drink alcohol and do drugs.
4. On **April 21, 2014**, DPW Hearing Officer **Frank Lee** conducted a hearing on the application to consider testimony regarding the subject SMF.
5. At the hearing, Arianna Urban of DPW presented a summary of the permit applications stating that the Applicant was in compliance with DPW's technical requirements and state and federal regulations.
6. At the hearing, **Ms. Tedi Vriheas** of AT&T stated a box walk was conducted on **April 10, 2014** and two (2) members of the community attended. During the box walk, community members and AT&T located the following potentially feasible alternate location(s):
 - 432 Silver Avenue: complies with AT&T's technical requirements.
 - 2 Lisbon Street: does not comply with AT&T's technical requirements.
 - 8 Lisbon Street: does not comply with AT&T's technical requirements.



San Francisco Department of Public Works

Making San Francisco a beautiful, livable, vibrant, and sustainable city.

7. At the hearing, no members of the community testified at the hearing in opposition to the proposed installation of the SMF cabinet in the vicinity of **326 Craut Street**.

RECOMMENDATION: DISAPPROVE the request by AT&T to locate Surface Mounted Facility **13SMF-0407**, in the vicinity of **326 Craut Street**.

FINDINGS:

1. The Hearing Officer reviewed the application, materials from DPW's files, the objections, additional materials submitted by the applicant and persons protesting the application, and the testimony at the hearing.
2. There is potential for the applicant, AT&T, to install the surface-mounted facility in other acceptable locations that may have less of an impact on the convenience and necessities of the property owners and occupants in the immediate vicinity of the surface-mounted facility.
3. It remains unclear if there may be other locations that may cause the least inconvenience to tenants, property owners, and users of the public right-of-way.
4. Applicant is suggested to submit an application for the alternate location(s) and any other acceptable locations for review by DPW and the community.
5. The Director of Public Works has reviewed the Hearing Officer's recommendation. The Director of Public Works hereby adopts the hearing officer's recommendation.

APPEAL PROCESS: This decision may then be appealed to the Board of Appeals within fifteen (15) calendar days of DPW's approval or denial of an Excavation Permit to install surface mounted facilities **13SMF-0407 in the vicinity of 326 Craut Street**. The Board of Appeals is located at 1650 Mission Street, Suite 304. To obtain further information regarding the appeal process, you can contact the Board of Appeals at 415-575-6880. You can also visit the Board of Appeals website at:

<http://www.sfdpw.org/In/Out.asp?Case=1728>

5/21/2014

5/21/2014

X

Sanguinetti, Jerry
Bureau Manager

5/22/2014

X

Swells, Fuad
Deputy Director and City Engineer

X

Mohammed Nuru

Nuru, Mohammed
Director, DPW



San Francisco Department of Public Works

Making San Francisco a beautiful, livable, vibrant, and sustainable city.

EXHIBIT C



Public Works Coordinator
AT&T California
795 Folsom Street, Suite 426
San Francisco CA 94107-1243

T: 415.644.7043 or
T: 415.644.7054
F: 415.957.5973
www.att.com

October 18, 2013

EXHIBIT F - a

René Lopez, Utility Permit Coordinator
City and County of San Francisco
Department of Public Works, Bureau of Street-Use and Mapping
1155 Market Street, 3rd Floor
San Francisco, CA 94103-1555

Location: 996 Cayuga Avenue, north side, east of Onondaga Avenue
DPW File: **13SMF-0376**

LETTER OF TRANSMITTAL
PROPOSED SURFACE MOUNTED FACILITY

Enclosed are:

- Exhibit A Pre-site visit checklist
- Exhibit A-2a Five-year plan documentation for this site
updated October 14, 2013
- Exhibit A-2b Cabinet size plan (footprint and clearance plans)
448S photo and specifications
- Exhibit A-2c Private property mailing letter to property owners mailing list
- Exhibit A-2d1 Private property mailing sample letter seeking easements to property owners
- Exhibit A-2d2 Private property mailing date verification, date mailed:
3 property owners notified, mailed September 30, 2013
- Exhibit A-2e Responses from Property Owners
- Exhibit MOU-1 Mailing list of owners and residents within 300 feet
Date mailed:
- Exhibits A-2f-B Verification of policy compliance (undergrounding, collocation, etc.)
- Exhibit C-1b Directory of Neighborhood Organizations list
- Exhibit C-1c City Department Notices for special districts
N/A
- Exhibit E Neighborhood Notice (per sec C-2)
- Exhibit F-b Site Drawing
- Exhibit F-c Photos of site
- Exhibit F-c1 Assessors Parcel Map, Grade Map, and vicinity map
- Exhibit F-d Location of SMF to be removed
N/A
- Exhibit G Approval or denial of site Notice to Applicant
- Exhibit H Application Deficiency Notice

Comments: Request approval to post and mail public notification (Exhibit E)

File: SF06-410202; 9354808; Group: **65G**

EXHIBIT A
Pre-Site Visit Checklist

City and County of San Francisco

Department of Public Works

Bureau of Street-use and Mapping



**SURFACE-MOUNTED FACILITY
PRE-SITE VISIT CHECKLIST**

APPLICANT NAME:	AT&T California	ADDRESS:	795 Folsom St., Rm 426
CONTACT NAME:	PAUL LUCQ	TEL. NO.:	644-7164
DATE:	October 18, 2013	PROPOSED LOCATION:	996 Cayuga Avenue
DPW REF #	13SMF-0376	APPLICANT REF #	SF06-410202, 9354808, 65G

- 1. Five-year plan or letter indicating no additional work is planned for the next five years is on file.
- 2. Verification that cabinet size is consistent with the plans on file.
- 3. Verification of attempts to place Surface-Mounted Facility on private property (at least 3 locations). Please attach the following:
 - a. Copy of letter mailed to property owners
 - b. Copy of mailing list
 - c. Statement verifying date of mailing
 - d. Copy of responses from property owners
 - e. Verification of attempted to enter into an agreement with any interested property owners
- 4. Verification of attempts to place Surface-Mounted Facility underground.
- 5. Verification of attempts to collocate the Surface-Mounted Facility.
- 6. Verification of special requirements that limit the possible locations for the Surface-Mounted Facility.
- 7. Verification that proposed locations conforms to the placement guidelines.
- 8. Verification that an existing Surface-Mounted Facility could/could not be removed.

ITEM NOS. _____ not required.

Request for site visit is accepted AND Site visit is scheduled
for: _____, 2011 with: _____ Tel. No.: _____

Request for site visit is denied

Site visit not required because : _____

Reviewed By: _____ Tel. No.: _____

Welcome Paul Lucc

At

Projects Events Conflicts Documents Tasks Mailbox

View: LSMF JU 9354808 65G

Project Information

Name: LSMF JU 9354808 65G
 Description: Project Litespeed
 Id: 65G
 Owner: AT&T - Construction and Engineering
 Facility Type: Communication
 Asset Type:
 Group Code:
 Contact: [Paul Lucc](#) 415-644-7164

Paving Type: Paving - Not Curb to Curb
 Status: Planned
 Facility Indicator: Fiber Optic
 Activity Type: Installation



Schedule

Start Date: 10/14/2014 12:00 AM
 Duration: 90.0 days
 End Date: 01/11/2015 11:59 PM

Additional Information

Location

Location: Onondaga Ave & Cayuga Ave to 966 Cayuga Ave, San Francisco, California, 94112
 Location Type: Line
 Location Size: 154 ft

Positions

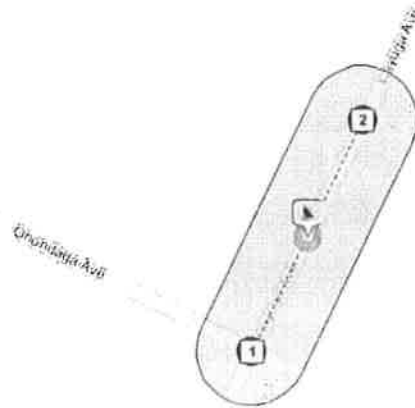

©2013 Envista Corporation, Data - ©2012 NAVTEQ

Conflicts

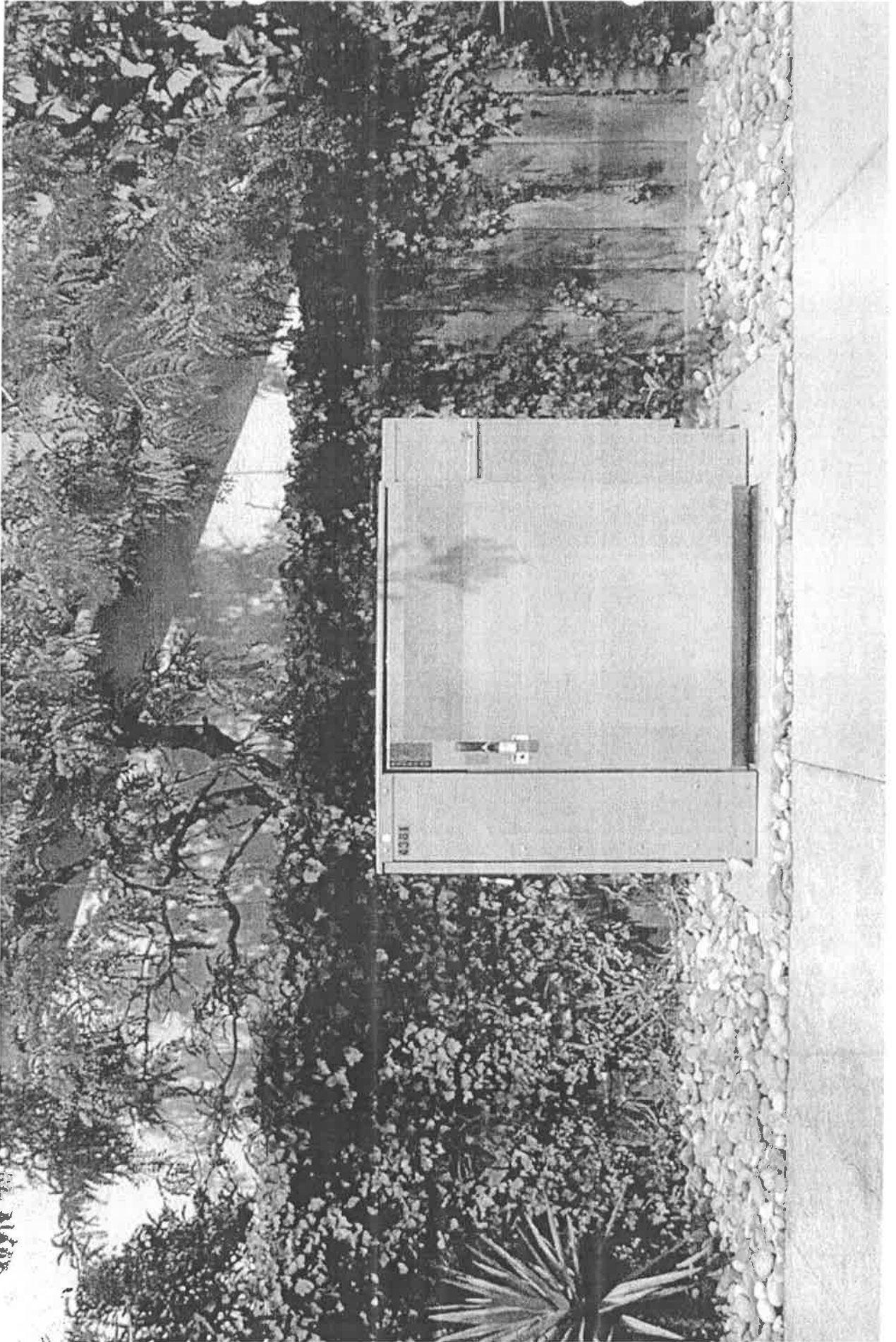

4381



TYPICAL 448S CABINET WITH POWER PEDESTAL SPECIFICATIONS

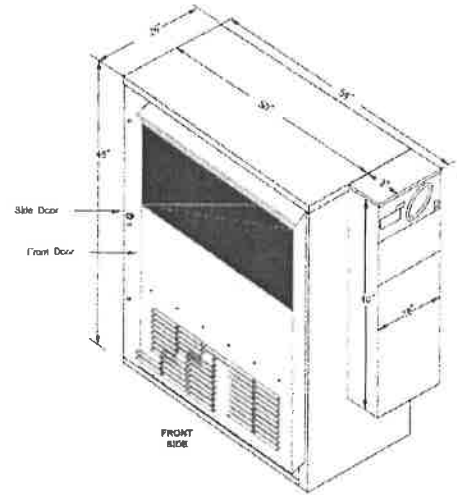
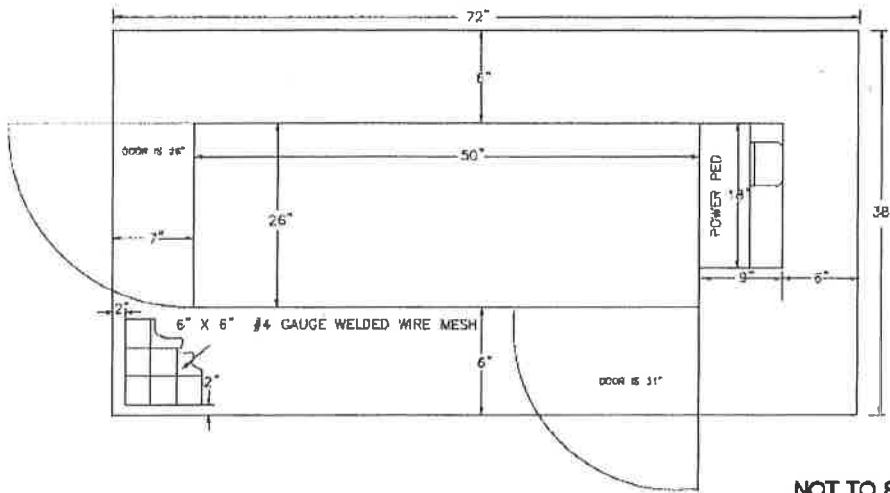

NOT TO SCALE

NOTES:

1. CONCRETE TO BE 4000 PSI AT 28 DAYS IN ACCORDANCE WITH ACI STANDARD.
2. PAD TO BE 6" THICK. TOP OF PAD SHOULD BE 2" ABOVE GRADE, UNLESS NOTED ON PERMIT APPLICATION.

448S CABINET DIMENSIONS		POWER PEDESTAL DIMENSIONS	
HEIGHT	48"	HEIGHT	40"
WIDTH	50"	WIDTH	9"
DEPTH	26"	DEPTH	18"

Easement Mailing List
Group 65

AT&T FILE	GROUP	NAMES	MAILING ADDRESS	PROPERTY ADDRESS	DATE SENT
SF13-120801, 9284204	65A	David A. Pesce	152 Oak Springs Drive, San Anselmo, CA 94960-1327	6230-6232 California Street	September 30, 2013
SF13-120801, 9284204	65A	Kathleen M. F. Yan	6228 California Street, San Francisco, CA 94121-1902	6228 California Street	September 30, 2013
SF05-310605, 9298321	65B	Elpidio D. Casanas Patricia Casanas	11 30th Street, San Francisco, CA 94110-5401	11 30th Street	September 30, 2013
SF05-310605, 9298321	65B	Mary K. Cusack Mary K. Cusack 1991 Trust	167 South Park Street, San Francisco, CA 94107-1808	793-795 San Jose Avenue	September 30, 2013
SF05-310605, 9298321	65B	Michael Deiner Suling Wang	345 Rolph Street, San Francisco, CA 94112-4405	22 30th Street	September 30, 2013
SF06-430803, 9085626	65C	Gan Ming Zhao Leung Mei Ling	620 Niagara Avenue, San Francisco, CA 94112-2428	183 Granada Avenue	September 30, 2013
SF06-430803, 9085626	65C	Ngoc Mai Pham	401 Holloway Avenue, San Francisco, CA 94112-2247	401 Holloway Avenue	September 30, 2013
SF06-430803, 9085626	65C	Patricia Marie Curr Patricia Marie Durr Trust	338 Holloway Avenue, San Francisco, CA 94112-2246	338 Holloway Avenue	September 30, 2013
SF06-431502, 9085639	65D	Shan-Ran Wu	60 Elmhurst Drive, San Francisco, CA 94132-2015	60 Elmhurst Drive	September 30, 2013
SF06-431502, 9085639	65D	Tony J. F. Lee M. S. Carol	1320 Woods Farm Lane, Springfield, IL 62704-6545	40 Elmhurst Drive	September 30, 2013
SF06-431502, 9085639	65D	Joyce L. Zimmerman Joyce L. Zimmerman 2008 Rev.LT	30 Elmhurst Drive, San Francisco, CA 94132-2015	30 Elmhurst Drive	September 30, 2013
SF06-431601, 9085650	65E	SFCC	25 Van Ness Avenue, San Francisco, CA 94102-6033	1298 Ocean Avenue, Ingleside Public Library, APN 3199-017	September 30, 2013
SF06-410205, 9085663	65F	Virgilio S. Estacio Dana S. Estacio	142 Onondaga Avenue, San Francisco, CA 94112-3223	142 Onondaga Avenue	September 30, 2013
SF06-410205, 9085663	65F	Charles Z. Chou Ken J. Chou	201 Onondaga Avenue, #4, San Francisco, CA 94112-3257	201 Onondaga	September 30, 2013
SF06-410205, 9085663	65F	Guillermo & Maria Canjura	217 Onondaga Avenue, San Francisco, CA 94112-3231	217 Onondaga Avenue	September 30, 2013
SF06-413202, 9085740	65G	Douglas J. Re Duk Lee Soon	1896 San Jose Avenue, San Francisco, CA 94112-2459	1896 San Jose Avenue	September 30, 2013
SF06-413202, 9085740	65G	Bulos S. Tannous Basma K. Tannous	1218 Park Pacifica Avenue, Pacifica, CA 94044-3713	541-543 San Juan Avenue	September 30, 2013
SF06-413202, 9085740	65G	Korean Evangelical Church of SF	542 San Juan Avenue, San Francisco, CA 94112-2541	540 San Juan Avenue	September 30, 2013



Public Works Coordinator
AT&T California
795 Folsom Street, Suite 426
San Francisco CA 94107-1243

T: 415.644.7054 or
T: 415.644.7043
F: 415.957.5973
www.att.com

«Date_Mailed»

«First_Name» «Last_Name»
«Company_Name»
«Address_Line_1»
«City», «State» «ZIP_Code»

Dear Property Owner:

AT&T California would like to upgrade the services it provides to our customers in your neighborhood by installing fiber optic cable to a neighborhood hub. To do so, we must install an above ground electronic equipment cabinet with an attached electric power panel.

The City and County of San Francisco prefers that these facilities be placed on private property, instead of on the public sidewalk. We need a place to locate the cabinet, and would like to discuss obtaining an easement on your property at «Property_Addr», San Francisco. An easement grants a permanent right to use a portion of your land, and attaches to your property land title.

The fiber optic equipment cabinet is 59" wide, 26" deep, and 48" high. The cabinet is weatherproof and intended for outdoor locations. A space about 6 feet by 10 feet is needed to provide clearances to open the cabinet doors.

Access to the equipment by our technicians is required at all times.

If you are not interested in granting AT&T an easement, you do not need to take any action.

If you have an area on your property that is accessible at all times, and are interested in granting a permanent easement, I would appreciate a few moments of your time to discuss this matter.

Please contact me on (415) 644-7164, or by e-mail at pl8353@att.com, at your convenience.

Thank you for your time and consideration.

Best regards,

Paul Lucq
Right of Way Agent

file: «DA_Job_Group», «Group»

Exhibit A-2f

Statements regarding AT&T placing facilities underground

It is not technologically feasible to place AT&T cross-connect boxes (Serving Area Interfaces) underground at this time. No manufacturer has been successful in developing a cross-connect that works underground. An attempt was made in the 1970's to place 3 locations underground in San Francisco. Even though stainless steel components were used, the corrosion that occurred caused the diving-bell type of enclosure to fail. Service issues involving moisture and corrosion at the wire connectors led to the underground facilities being removed and placed above ground. An ongoing attempt by a coalition of major manufacturers and telecom companies to develop an underground cross-connect continue, and AT&T staff is involved in the project. AT&T will use the product in San Francisco at such time that it is approved for use. These issues were discussed at the SMF Committee meetings held in 2004 and 2005.

Cabinets housing electronics used for the conversion of fiber-optic signal to electrical signal have components that cannot be subjected to the moisture and potential flooding of an underground environment.

Exhibit A-2g

Statement regarding the need to site the facility at this location

This location has been selected because of its proximity to existing AT&T facilities, including conduit and cable, cross-connect cabinets, and its central location within the "Distribution Area" being served. This site will minimize excavation and the resultant disruption to the public, it will also reduce construction impact on City streets and sidewalks.

Exhibit A-2h

Statement regarding the collocation of AT&T facilities

AT&T is attempting to combine functions of cabinets to optimize their use and minimize the space required to provide the latest technologies to the public. As more compact facilities become available for use, AT&T will deploy them in San Francisco. No other street furniture exists at this site that permits the possibility of collocation.

Exhibit A-2i

Statements regarding the removal of existing Surface-Mounted Facilities

- This will be a new cross-connect facility, improving the service and installation possibilities for this serving area. No similar facility exists in this serving area, therefore none can be removed.
- The existing cross-connect facility at this location is being upgraded in-place to provide ultimate service capacity for the serving area, and will increase slightly in size to provide for increased capacity and the capability to accept the latest technology improvements when they become available to the neighborhood.
- This facility combines existing facilities and will result in the removal of a cabinet located at: See Exhibit F-d, as well.
- This facility brings new electronic equipment to the serving area. This facility provides the latest fiber-optic served equipment and offers advanced services to serving area residents. No similar facility exists in this neighborhood, therefore none can be removed.
- It is not possible to remove any other SMF with this project.
-

Exhibit B

Statement regarding compliance with placement guidelines

This site complies with the DPW placement guidelines for Surface-Mounted Facilities stipulated in Exhibit B of DPW Order 175, 566, dated August 17th, 2005.



795 Folsom Street, Room 426
San Francisco CA 94107-1243

OFFICIAL NOTICE—DO NOT REMOVE DPW Order 175,566

IMPORTANT NOTICE CONCERNING YOUR RIGHTS

SF06-410202

9354808

65G

Dear San Francisco Resident:

Posting Date

AT&T California is filing an application with the San Francisco Department of Public Works (DPW) for a permit to install an **electronics cabinet with attached electric power panel** at the following proposed location: **996 Cayuga Avenue**. A mock-up of the Surface Mounted Facilities (SMF) in the proposed location is shown below. The cabinet dimensions are: 59 inches wide, 48 inches tall, and 26 inches deep.

This cabinet will provide the latest telecommunications technology offering high-speed internet access and advanced digital television and entertainment services, which will be fed by fiber-optic cable to this new neighborhood hub.

All objections to the installation of the SMF must be submitted in writing via:

E-mail to:	smf@sfdpw.org	US Mail to:	Department of Public Works
Fax to:	(415) 554-6161		Bureau of Street-Use and Mapping
Refer to Permit Appl #:	13SMF-0376		1155 Market Street, 3 rd Floor
Last date to object:			San Francisco, CA 94103-1555

Please reference Permit Application # 13SMF-0376 with all correspondence

You have **20 days** from the date of this notice to send written notice of your objection to DPW. DPW will not consider any objection unless it is made within this 20-day period.

If you submit an objection, DPW may convene a hearing to determine whether the permit for placement of the SMF should be issued. DPW will commence any such hearing within 40 days after the receipt of any objections. You will have the opportunity to express your concerns about the SMF at the hearing should you choose to attend.

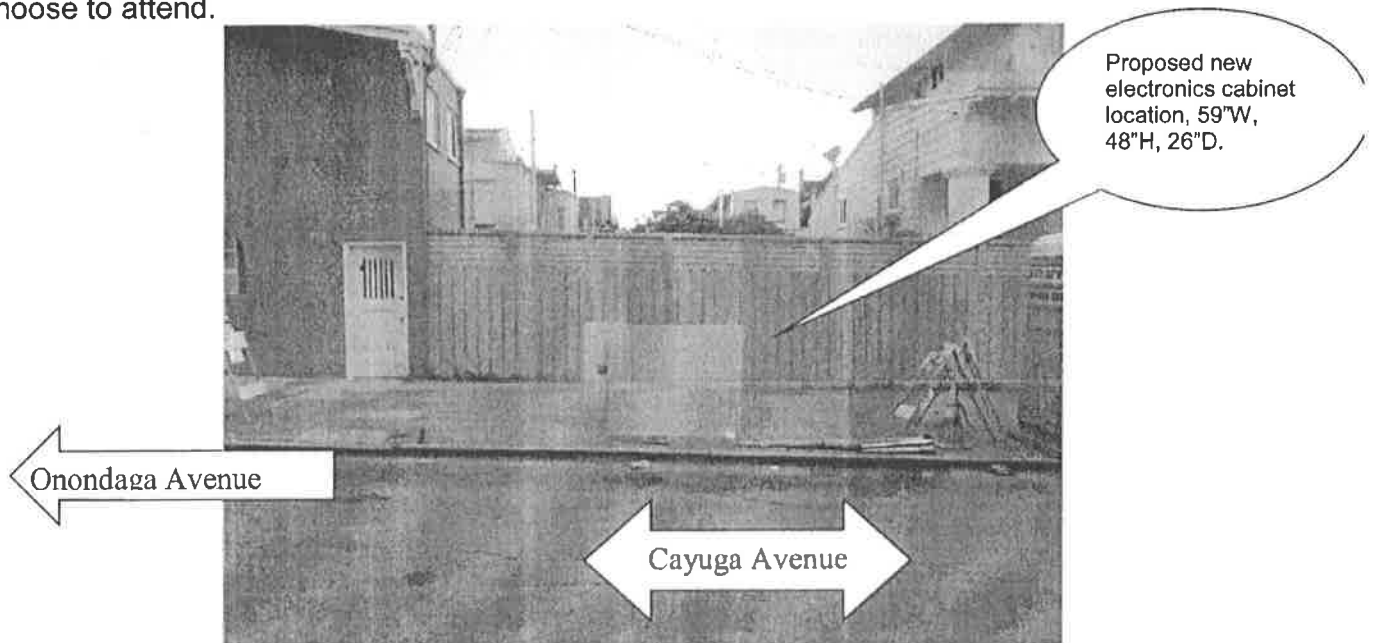

For more information, please visit: www.att.com/ipnetwork4sf



ISSUE	DATE
1	10/13

CONSTRUCTION NOTES:

- POUR IN PLACE 1-72"x38"x6" CONCRETE PAD FOR LOW PROFILE 448S VRAD CABINET (GREEN).
- PLACE LOW PROFILE 448S VRAD CABINET E/W 1-2 SLOT SHELF CABLES FOR (2) SHELVES. PLACE AC POWER PEDESTAL MILBANK SERIES WITH MOUNTING BRACKET KIT, FLUSH MOUNTED ON THE RIGHT SIDE OF THE CABINET. VRAD TO FACE SIDEWALK.
- POSSIBLE POWER SOURCE..
- VRAD CABINET EQUIPPED W/ INTEGRATED AC POWER PEDESTAL SHALL BE GROUNDED AS PER NEC CODE, SECTION 250.
- EXISTING SAI PED 999X CAYUGA AV.

LEGEND

- = NEW STANCHIONS
- = PARKING SIGN
- = STOP SIGN
- ⊙ = STREET SIGN
- ⊕ = UTILITY POLE
- = SEWER VENT
- ⊞ = SFWD (6"x12")
- ⊞ = ATT X-CONNECT BOX
- ⊞ = PROPOSED VRAD
- = TREE

APPROVAL NOTES:

DUE TO CITY RESTRICTIONS, A 448S VRAD BEING PROPOSED AT THIS TIME IN LIEU OF A 448Q WHICH THIS DA ULTIMATELY REQUIRES

FIELD NOTES:

SAI - DOUBLE SIDED
6X300X

VACANTS:
SW SIDE
F2,1001-100

STR SIDE
F2, 1601-1700, 2101-2300
1001-1200

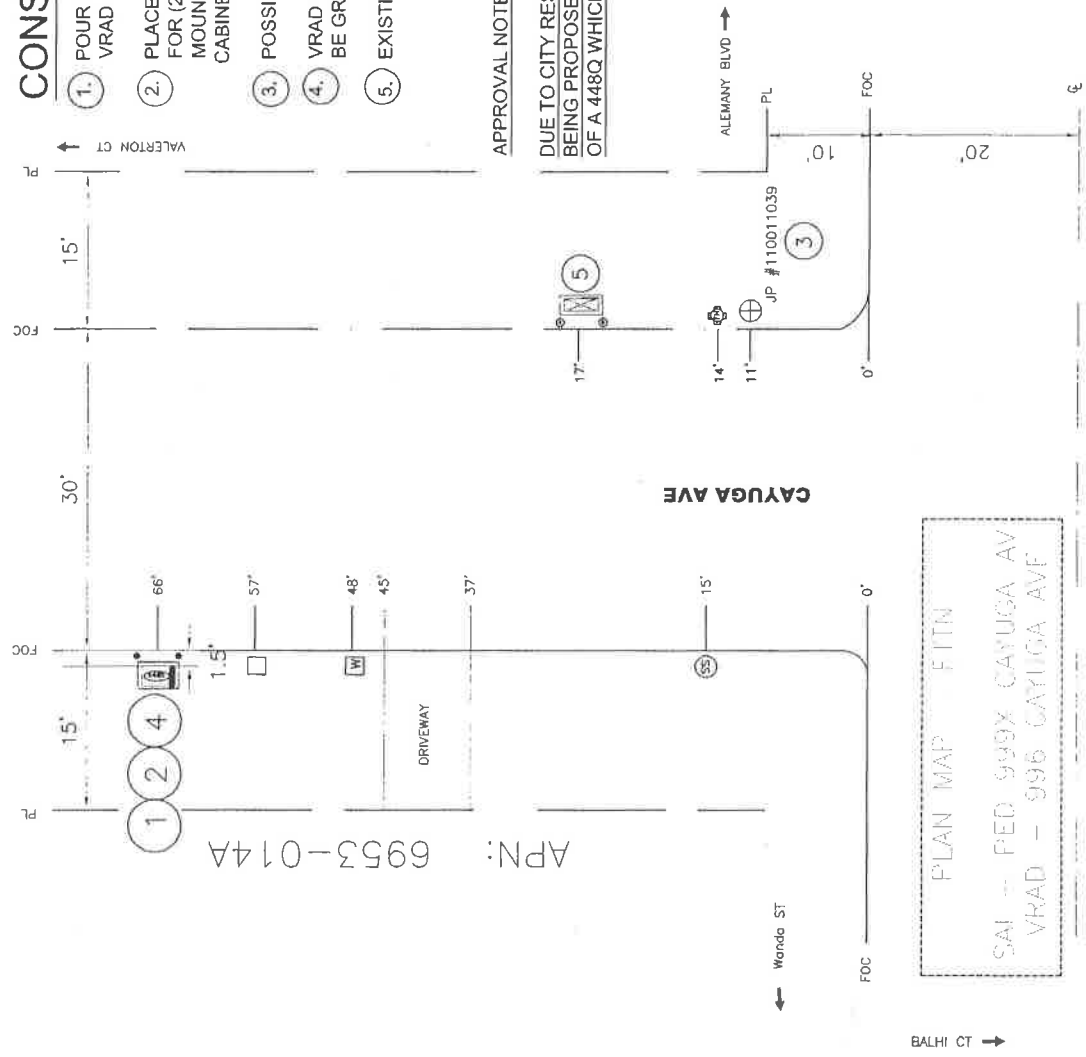

NTS

DA: 410202

CONST ARC: _____
DATE: _____
COMP: _____

GEO/CO	R4-01
EXCH	SNFCCA06
ENGR.	TEL.
ENGR. ARC	
FIELDER:	PARAS
TYPE OF CONST.:	
RO/EST NO	9354808
DWG	1 OF 1 DC# 0

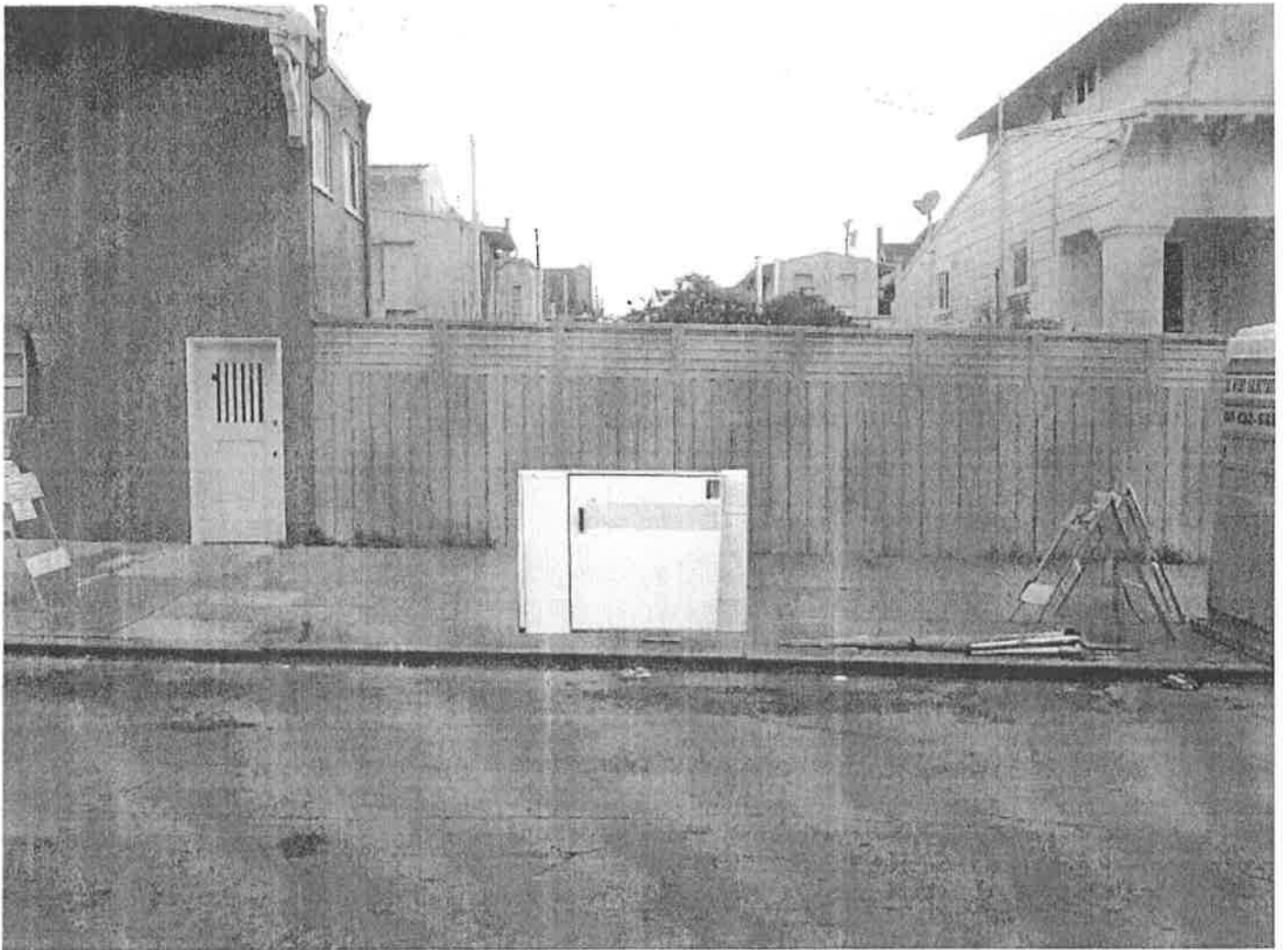

Looking north across Cayuga Avenue, toward the proposed location Onondaga Avenue is on the left, to the west.



Looking west along the north sidewalk of Cayuga Avenue, toward Onondaga Avenue.



Looking east along the north sidewalk of Cayuga Avenue, toward Valerton Court.



Looking south across Cayuga Avenue from the proposed site. Onondaga Avenue is on the right, to the west.

City of San Francisco
Department of Public Works
Engineering Division



Scale: 1" = 50 feet
1:50 feet

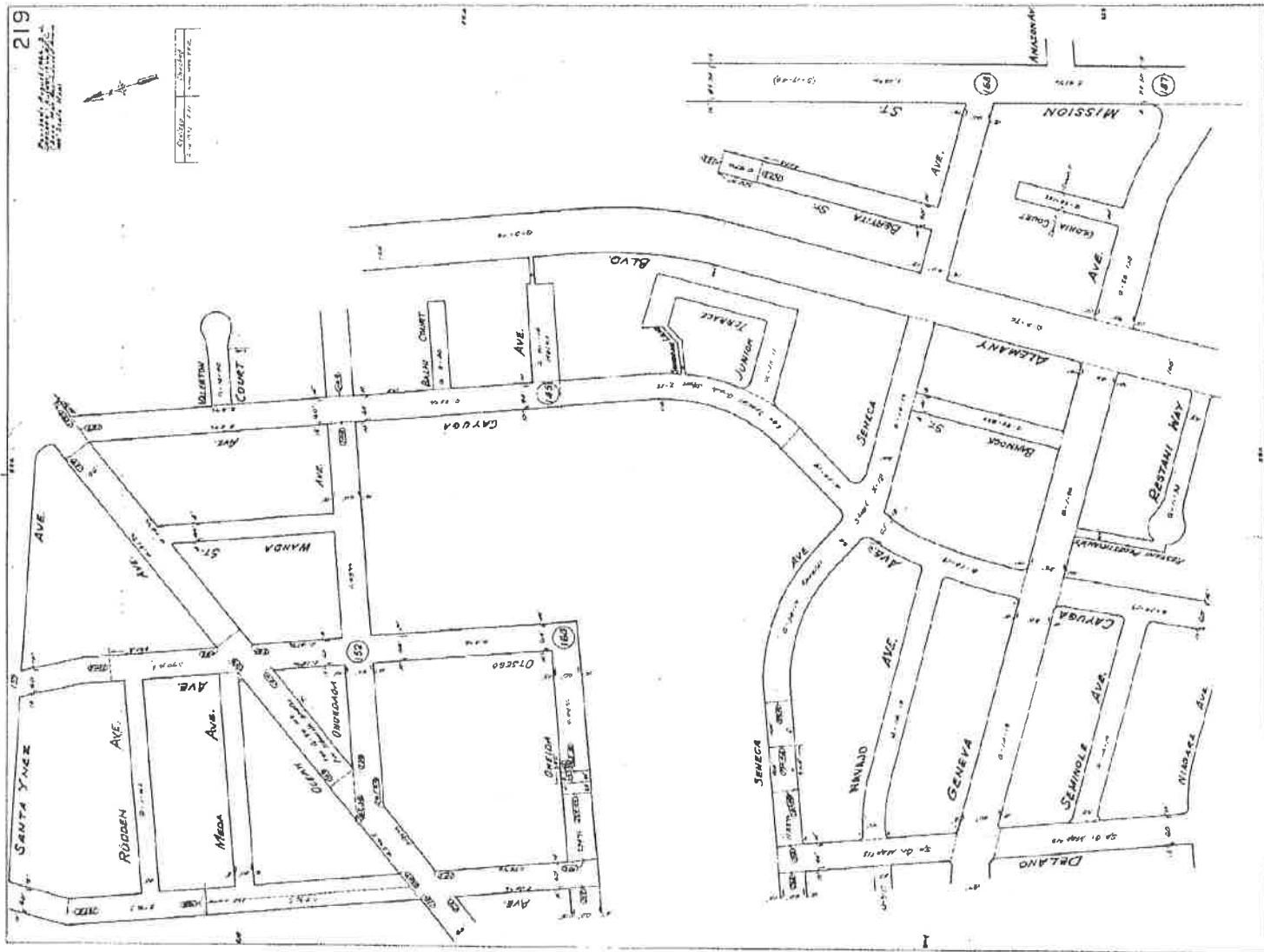

City and County of San Francisco



Department of Public Works

Bureau of Street-use and Mapping

Paul Lucq, Public Works Coordinator
AT&T California
Construction and Engineering
795 Folsom Street, Room 426
San Francisco, CA 94107-1243

**STATUS OF SURFACE MOUNTED FACILITY
PRE-APPROVAL APPLICATION**

Location: **996 Cayuga Avenue**

Cross Streets: Onondaga Avenue and Valerton Ct

Your file or job number: **SF06-410202, 9354808, 65G**

Your application for pre-approval to construct a surface mounted facility at the location above has been reviewed by the Department, under the terms of DPW Order 175,566.

- Your application is approved, as submitted, with no additional requirements. You may apply for an excavation permit.
- Your application is approved, subject to the following **mitigation requirements**:
You may apply for an excavation permit.
- Refer to this number in your Excavation Permit application: **13SMF-0376**
- You may **not** apply for a permit at this site, your application is **denied** for the following reason(s):

Date: _____

René Lopez
Utility Permit Coordinator

EXHIBIT H
Application Deficiency Checklist

City and County of San Francisco

Department of Public Works

Bureau of Street-use and Mapping



SURFACE-MOUNTED FACILITY APPLICATION
DEFICIENCY NOTICE

Applicant Name: AT&T California Contact Name: Paul Lucq Tel. No: 415 644-7164

Proposed Location: 996 Cayuga Avenue (Group 65G) 13SMF-0376

The application package is deficient for the reasons indicated below and is returned to: _____

On: _____ By: _____ Tel No. _____

1. **Transmittal letter** is missing the following information:
 - a. Identification of proposed location of Surface Mounted Facility (SMF)
 - b. Type of cabinet (include specification if not on file with the Department of Public Works)
 - c. Date of site visit
 - d. Name, address, telephone number, facsimile number and e-mail address for contact person.
 - e. Other: _____

2. **Detailed Drawing** is missing the following information:
 - a. Street name
 - b. Name of cross streets
 - c. Face of curb (FOC)
 - d. Property lines (PLs)
 - e. Distance from FOC to face of the SMF
 - f. Distance from FOC to PLs
 - g. Distance from FOC to back of the SMF
 - h. Locations of existing above-ground street furniture (utility poles, bus shelters, fire hydrants, garbage receptacles, parking meters, etc) and distance from the proposed location of the SMF.
 - i. Locations of existing underground utility facilities (vaults, manholes, handholds, meters, etc.) and distance from the proposed location of the SMF.
 - j. Distance from nearest cross street to the SMF.
 - k. Other: _____

3. **Photographs of the SMF** in the proposed location is missing the following:
 - a. Front view of the SMF
 - b. Side view of the SMF
 - c. View of the SMF in relation to the nearest building or other structure
 - d. Other: _____

4. **Location of SMF is incorrect.** Explain:

EXHIBIT D



Public Works Coordinator
AT&T California
795 Folsom Street, Suite 426
San Francisco CA 94107-1243

T: 415.644.7043 or
T: 415.644.7054
F: 415.957.5973
www.att.com

November 15, 2013

EXHIBIT F - a

René Lopez, Utility Permit Coordinator
City and County of San Francisco
Department of Public Works, Bureau of Street-Use and Mapping
1155 Market Street, 3rd floor
San Francisco, CA 94103-1522

Location: 326 Craut Street, west side, north of Silver Avenue
DPW File: **13SMF-0407**

**LETTER OF TRANSMITTAL
PROPOSED SURFACE MOUNTED FACILITY**

Enclosed are:

- Exhibit A Pre-site visit checklist
- Exhibit A-2a Five-year plan documentation for this site
Updated: November 7, 2013
- Exhibit A-2b Cabinet size plan (footprint and clearance plans)
448S photo and specifications
- Exhibit A-2c Private property mailing letter to property owners mailing list
3 of 3 provided on private property owners list.
- Exhibit A-2d1 Private property mailing sample letter seeking easements to property owners
- Exhibit A-2d2 Private property mailing date verification, date mailed:
November 5, 2013
- Exhibit A-2e Responses from Property Owners
- Exhibit MOU-1 Mailing list of owners and residents within 300 feet
Date mailed:
- Exhibits A-2f-B Verification of policy compliance (undergrounding, collocation, etc.)
- Exhibit C-1b Directory of Neighborhood Organizations list
- Exhibit C-1c City Department Notices for special districts
N/A
- Exhibit E Neighborhood Notice (per sec C-2)
- Exhibit F-b Site Drawing
- Exhibit F-c Photos of site
- Exhibit F-c1 Assessors Parcel Map, Grade Map, and vicinity map
- Exhibit F-d Location of SMF to be removed
N/A
- Exhibit G Approval or denial of site Notice to Applicant
- Exhibit H Application Deficiency Notice

Comments: Request approval to post and mail public notification (Exhibit E).

File: SF06-280301; 9390985; Group: **70F**

EXHIBIT A
Pre-Site Visit Checklist

City and County of San Francisco

Department of Public Works

Bureau of Street-use and Mapping



**SURFACE-MOUNTED FACILITY
PRE-SITE VISIT CHECKLIST**

APPLICANT NAME:	AT&T California	ADDRESS:	795 Folsom St., Rm 426
CONTACT NAME:	Dana Neil	TEL. NO.:	644-7027
DATE:	November 15, 2013	PROPOSED LOCATION:	326 Craut Street
DPW REF #	13SMF-0407	APPLICANT REF #	SF06-280301, 9390985, 70F

- 1. Five-year plan or letter indicating no additional work is planned for the next five years is on file.
- 2. Verification that cabinet size is consistent with the plans on file.
- 3. Verification of attempts to place Surface-Mounted Facility on private property (at least 3 locations). Please attach the following:
 - a. Copy of letter mailed to property owners
 - b. Copy of mailing list
 - c. Statement verifying date of mailing
 - d. Copy of responses from property owners
 - e. Verification of attempted to enter into an agreement with any interested property owners
- 4. Verification of attempts to place Surface-Mounted Facility underground.
- 5. Verification of attempts to collocate the Surface-Mounted Facility.
- 6. Verification of special requirements that limit the possible locations for the Surface-Mounted Facility.
- 7. Verification that proposed locations conforms to the placement guidelines.
- 8. Verification that an existing Surface-Mounted Facility could/could not be removed.

ITEM NOS. _____ not required.
Request for site visit is accepted AND Site visit is scheduled
for: _____, 2011 with: _____ Tel. No.: _____
<input type="checkbox"/> Request for site visit is denied
<input type="checkbox"/> Site visit not required because : _____
Reviewed By: _____ Tel. No.: _____

Welcome Dana Neil

At

Projects Events Conflicts Documents Tasks Mailbox

Projects Maintenance Opportunities View: LSMF JU 9390935 70F

Project Information

Name: LSMF JU 9390935 70F
Description: PROJECT LIGHTSPEED
Id: 70F
Owner: AT&T - Construction and Engineering
Facility Type: Communication
Asset Type: Terminal
Group Code:
Contact: Dana Neil 415-644-7027

Paving Type: Paving - Not Curb to Curb
Status: Planned

Facility Indicator: Fiber Optic
Activity Type: Installation



Schedule

Start Date: 09/09/2014 12:00 AM
Duration: 90.0 days
End Date: 12/07/2014 11:59 PM

Additional Information

Location

Location: Crut St from Silver Ave to Maynard St, San Francisco, California, 94112
Location Type: Line
Location Size: 269 ft

Positions

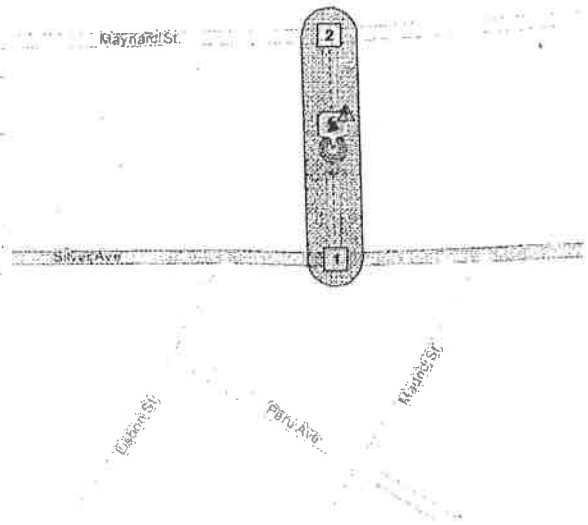

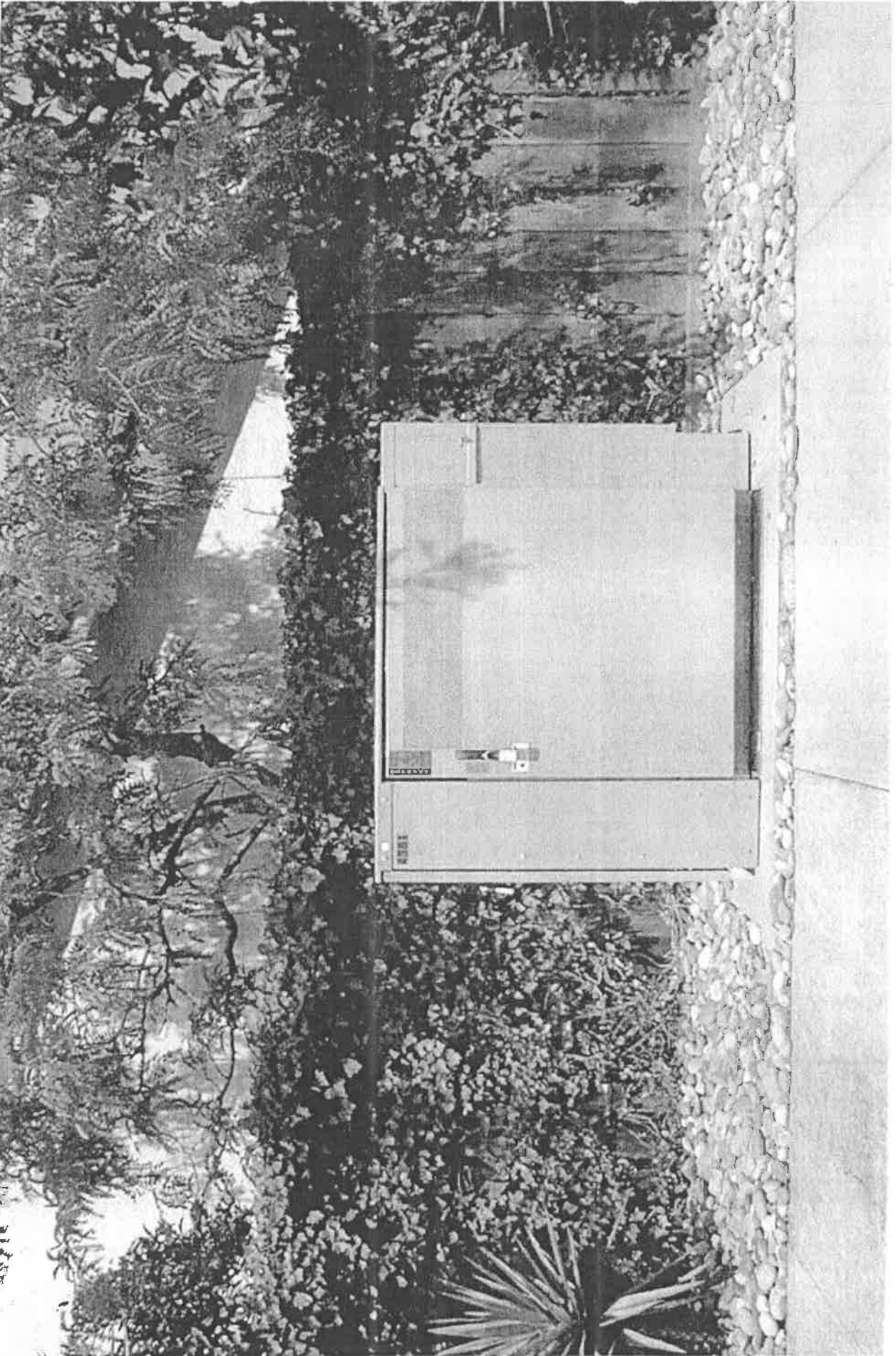

100-214-888

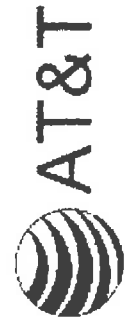

TYPICAL 448S CABINET WITH POWER PEDESTAL SPECIFICATIONS

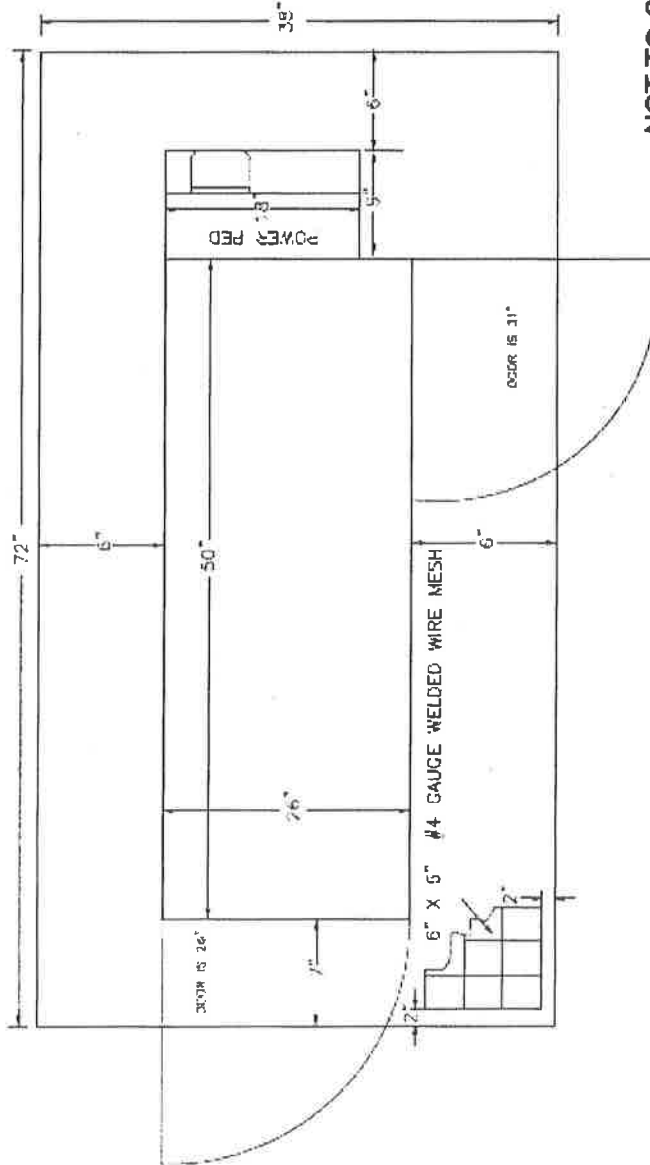
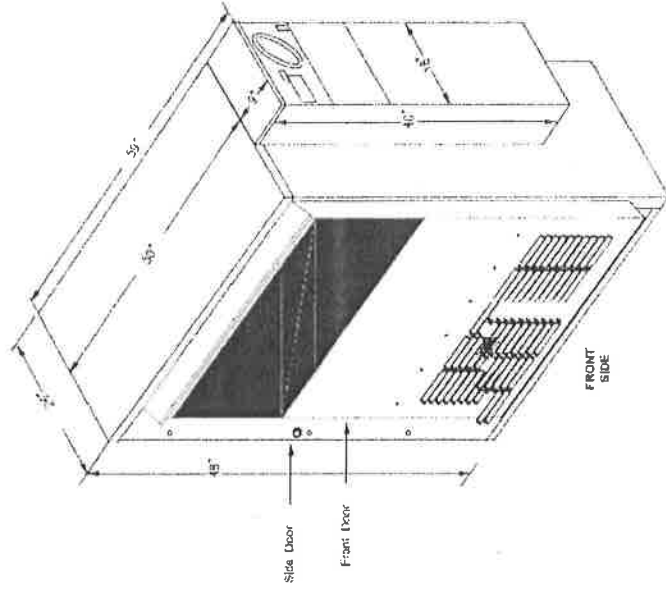

NOT TO SCALE

NOTES:

1. CONCRETE TO BE 4000 PSI AT 28 DAYS IN ACCORDANCE WITH ACI STANDARD.
2. PAD TO BE 6" THICK. TOP OF PAD SHOULD BE 2" ABOVE GRADE, UNLESS NOTED ON PERMIT APPLICATION.

448S CABINET DIMENSIONS		POWER PEDESTAL DIMENSIONS	
HEIGHT	48"	HEIGHT	40"
WIDTH	50"	WIDTH	9"
DEPTH	26"	DEPTH	18"

Easement Mailing List
Group 70F

AT&T FILE	GROUP	NAMES	MAILING ADDRESS	PROPERTY ADDRESS	DATE SENT
SF06-280301, 9390985	70F	Michael A. Taylor Katherine F. Taylor	102 Maynard Street, San Francisco, CA 94112-1637	102 Maynard Street	November 5, 2013
SF06-280301, 9390985	70F	Alfred A. Petrini Irene M. Petrini	4220 Blackhawk Meadow Court, Danville, CA 94506-5862	397 Silver Avenue	November 5, 2013
SF06-280301, 9390985	70F	Veneracion Zamora	401 Silver Avenue, San Francisco, CA 94112-1620	401 Silver Avenue	November 5, 2013



Public Works Coordinator
AT&T California
795 Folsom Street, Suite 426
San Francisco CA 94107-1243

T: 415.644.7054 or
T: 415.644.7043
F: 415.957.5973
www.att.com

«Date_Mailed»

«First_Name» «Last_Name»
«Company_Name»
«Address_Line_1»
«City», «State» «ZIP_Code»

Dear Property Owner:

AT&T California would like to upgrade the services it provides to our customers in your neighborhood by installing fiber optic cable to a neighborhood hub. To do so, we must install an above ground electronic equipment cabinet with an attached electric power panel.

The City and County of San Francisco prefers that these facilities be placed on private property, instead of on the public sidewalk. We need a place to locate the cabinet, and would like to discuss obtaining an easement on your property at «Property_Addr», San Francisco. An easement grants a permanent right to use a portion of your land, and attaches to your property land title.

The fiber optic equipment cabinet is 59" wide, 26" deep, and 48" high. The cabinet is weatherproof and intended for outdoor locations. A space about 6 feet by 10 feet is needed to provide clearances to open the cabinet doors.

Access to the equipment by our technicians is required at all times.

If you are not interested in granting AT&T an easement, you do not need to take any action.

If you have an area on your property that is accessible at all times, and are interested in granting a permanent easement, I would appreciate a few moments of your time to discuss this matter.

Please contact me on (415) 644-7027, or by e-mail at dn1281@att.com, at your convenience.

Thank you for your time and consideration.

Best regards,

Dana Neil
Right of Way Agent

file: «DA_Job_Group», «Group»

Exhibit A-2f

Statements regarding AT&T placing facilities underground

It is not technologically feasible to place AT&T cross-connect boxes (Serving Area Interfaces) underground at this time. No manufacturer has been successful in developing a cross-connect that works underground. An attempt was made in the 1970's to place 3 locations underground in San Francisco. Even though stainless steel components were used, the corrosion that occurred caused the diving-bell type of enclosure to fail. Service issues involving moisture and corrosion at the wire connectors led to the underground facilities being removed and placed above ground. An ongoing attempt by a coalition of major manufacturers and telecom companies to develop an underground cross-connect continue, and AT&T staff is involved in the project. AT&T will use the product in San Francisco at such time that it is approved for use. These issues were discussed at the SMF Committee meetings held in 2004 and 2005.

Cabinets housing electronics used for the conversion of fiber-optic signal to electrical signal have components that cannot be subjected to the moisture and potential flooding of an underground environment.

Exhibit A-2g

Statement regarding the need to site the facility at this location

This location has been selected because of its proximity to existing AT&T facilities, including conduit and cable, cross-connect cabinets, and its central location within the "Distribution Area" being served. This site will minimize excavation and the resultant disruption to the public, it will also reduce construction impact on City streets and sidewalks.

Exhibit A-2h

Statement regarding the collocation of AT&T facilities

AT&T is attempting to combine functions of cabinets to optimize their use and minimize the space required to provide the latest technologies to the public. As more compact facilities become available for use, AT&T will deploy them in San Francisco. No other street furniture exists at this site that permits the possibility of collocation.

Exhibit A-2i

Statements regarding the removal of existing Surface-Mounted Facilities

- This will be a new cross-connect facility, improving the service and installation possibilities for this serving area. No similar facility exists in this serving area, therefore none can be removed.
- The existing cross-connect facility at this location is being upgraded in-place to provide ultimate service capacity for the serving area, and will increase slightly in size to provide for increased capacity and the capability to accept the latest technology improvements when they become available to the neighborhood.
- This facility combines existing facilities and will result in the removal of a cabinet located at: See Exhibit F-d, as well.
- This facility brings new electronic equipment to the serving area. This facility provides the latest fiber-optic served equipment and offers advanced services to serving area residents. No similar facility exists in this neighborhood, therefore none can be removed.
- It is not possible to remove any other SMF with this project.
-

Exhibit B

Statement regarding compliance with placement guidelines

This site complies with the DPW placement guidelines for Surface-Mounted Facilities stipulated in Exhibit B of DPW Order 175, 566, dated August 17th, 2005.



795 Folsom Street, Room 426
San Francisco CA 94107-1243

SF06-280301 9390985

70F

IMPORTANT NOTICE CONCERNING YOUR RIGHTS

Dear San Francisco Resident:

Posting Date

AT&T California is filing an application with the San Francisco Department of Public Works (DPW) for a permit to install an **electronics cabinet with attached electric power panel** at the following proposed location: **326 Craut Street**. A mock-up of the Surface Mounted Facilities (SMF) in the proposed location is shown below. The cabinet dimensions are: 59 inches wide, 48 inches tall, and 26 inches deep.

This cabinet will provide the latest telecommunications technology offering high-speed internet access and advanced digital television and entertainment services, which will be fed by fiber-optic cable to this new neighborhood hub.

All objections to the installation of the SMF must be submitted in writing via:

E-mail to:	smf@sfdpw.org	US Mail to:	Department of Public Works
Fax to:	(415) 554-6161		Bureau of Street-Use and Mapping
Refer to Permit Appl #:	13SMF-0407		1155 Market Street, 3 rd Floor
Last date to object:			San Francisco, CA 94103-1555

Please reference Permit Application # 13SMF-0407 with all correspondence

You have **20 days** from the date of this notice to send written notice of your objection to DPW. DPW will not consider any objection unless it is made within this 20-day period.

If you submit an objection, DPW may convene a hearing to determine whether the permit for placement of the SMF should be issued. DPW will commence any such hearing within 40 days after the receipt of any objections. You will have the opportunity to express your concerns about the SMF at the hearing should you choose to attend.

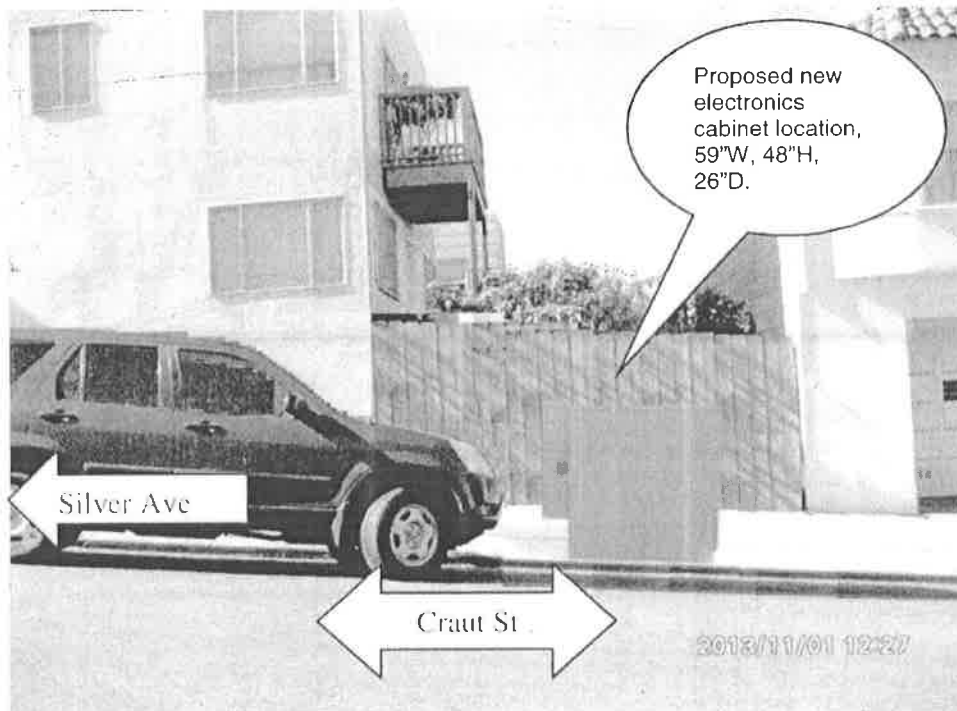

For more information, please visit: www.att.com/ipnetwork4sf

ISSUE	DATE
1	11/13

PLAN MAP - FTTN
SAI - PED 330X CRAUT
VRAD - 326 CRAUT ST

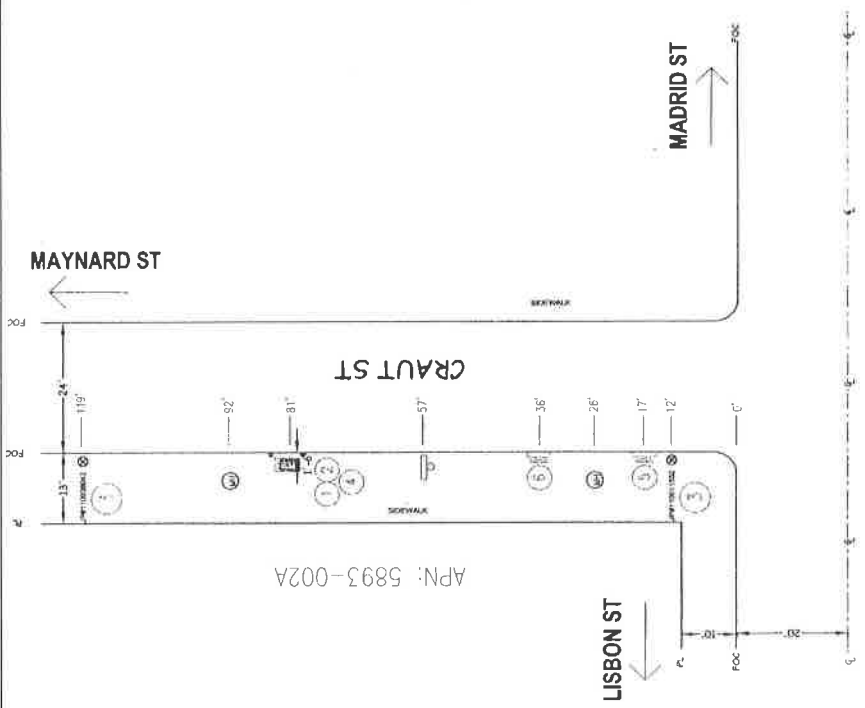

APN: 5893-002A

LEGEND

- PROPOSED WAD
- PROPOSED CHAOUT
- FIRE HYDRANT
- SEWER MAINS/POLES/BOXES
- CENTER LINE
- PROPERTY LINE
- JOINT POLE
- FACE OF CURB
- BACK OF SIDEWALK
- TREE
- POLE BOX
- SEWER MAIN INTERFACE
- ADJACENT TO SERVICE BOX
- STATION
- CABLE SERVICE BOX
- STREET SIGN
- EMERGENCY LIGHT
- STREET LIGHT
- STOP SIGN
- HEXES
- S'40
- STOP SIGN
- SEWER VENT
- MANHOLE

CONSTRUCTION NOTES:

1. POUR IN PLACE 1-72"x38"x6" CONCRETE PAD FOR LOW PROFILE 448S VRAD CABINET (59"WX26"D X48"H -GREEN).
2. PLACE LOW PROFILE 448S VRAD CABINET EW 2-4 SLOT SHELF, CABLES WIRED FOR 2 SHELVES. PLACE AC POWER PEDESTAL MILBANK SERIES WITH MOUNTING BRACKET KIT, FLUSH MOUNTED ON THE RIGHT SIDE OF THE CABINET.
3. POSSIBLE POWER SOURCE
4. VRAD CABINET EQUIPPED W/ INTEGRATED AC POWER PEDESTAL SHALL BE GROUNDED AS PER NEC CODE, SECTION 250.
5. ABANDONED SAI - REMOVE
6. EXISTING SAI - PED 330X CRAUT.

APPROVAL NOTES:

1. THIS DESIGN DETAIL PROVIDES THE FIBER DROP, COPPER CABLE AND SPLICING FOR PLACEMENT OF NEW VRAD.
2. DUE TO CITY CONSTRAINTS, A 448S CABINET IS BEING PLACED AT THIS TIME EVEN THOUGH LU TOTAL FOR THIS DA CALLS FOR A 448Q CABINET.

SILVER AVE

FIELDER'S NOTES:

SAI - PED 330X CRAUT
 3X600X DOUBLE SIDED LAYOUT

VACANTS:
 SIDEWALK SIDE
 F1, 701-900, F2, 1201-1800
 ROOM FOR 9X100X BLOCKS



SCALE = NTS

DA: 280301
 TOTAL LU = 422

CONSTR. ARC	DATE
R4-D1	
SNECCA06	
PARAS	
TYPE OF CONST.	
NO. OF PLACEMENT - PERMITS PLAN	
9390985	

CAUTION!!!
 48 HRS BEFORE YOU DIG
 CALL
USA
 1-800-227-2600

U.T.S. ASSUMES NO RESPONSIBILITY FOR THE ACCURACY OF THE SUBSTRUCTURE INFORMATION PROVIDED HEREIN. THE USER SHALL BE RESPONSIBLE FOR VERIFYING THE SUBSTRUCTURE LOCATION BEFORE EXCAVATING AND ASSUMES ALL LIABILITY AS A RESULT OF SUCH EXCAVATION. CALL UNDERGROUND SERVICE ALERT (800) 877-ROAD FOR MORE INFORMATION. (800) 877-ROAD TELEPHONE PLANT.

USE EXTREME CAUTION
 LOCATION AND DEPTH OF EXISTING SUBSURFACE STRUCTURES ARE NOT GUARANTEED. OTHER SUBSURFACE STRUCTURES NOT SHOWN MAY EXIST.



Looking west across Craut Street towards the proposed location, Silver Avenue is on the left, to the south.



Looking south along the west sidewalk of Craut Street towards Silver Avenue.



Looking north along the west sidewalk of Craut Street towards Maynard Street.

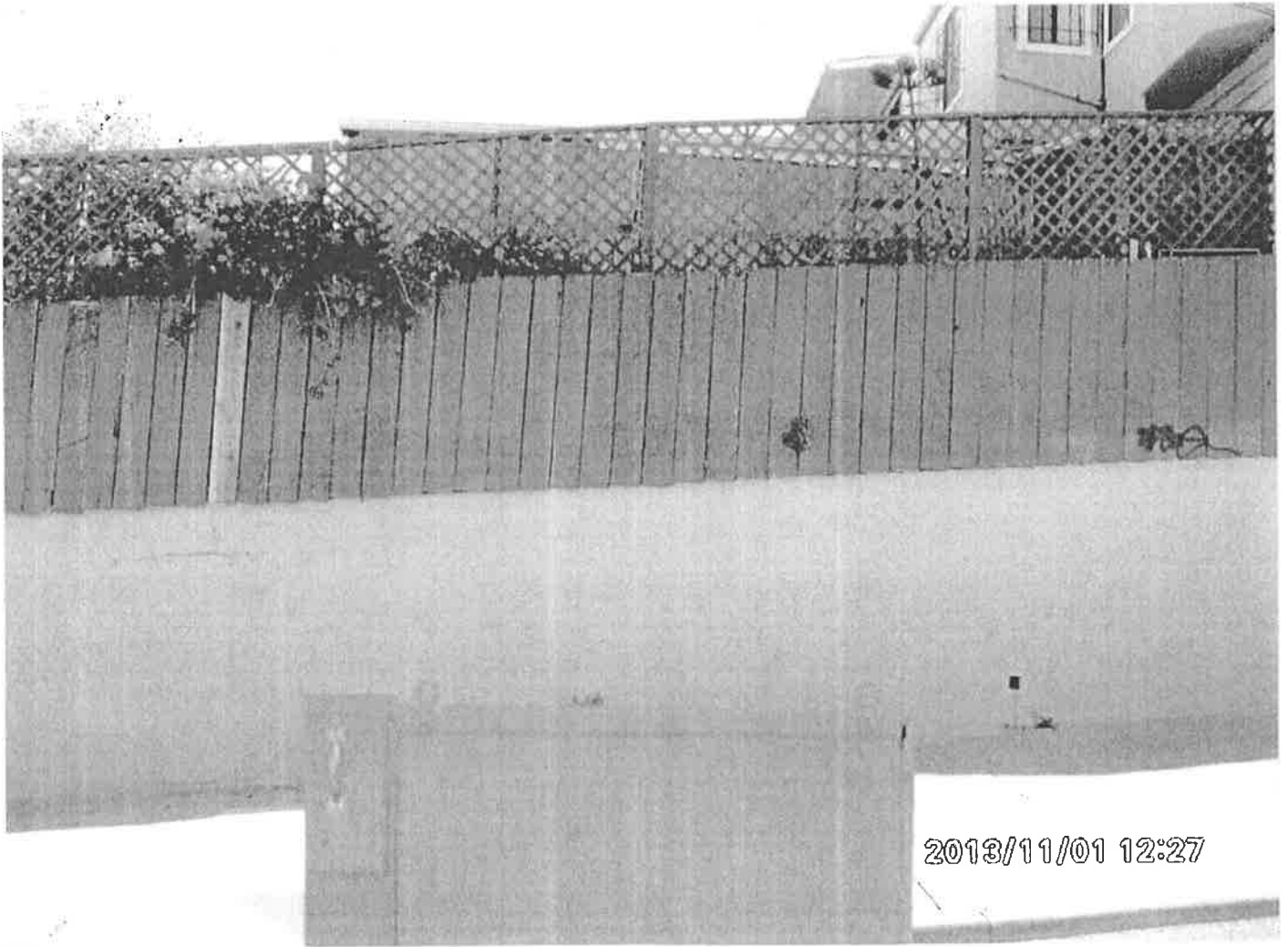

Looking east across Craut Street from the proposed site. Silver Avenue is on the right to the south.



MAYNARD

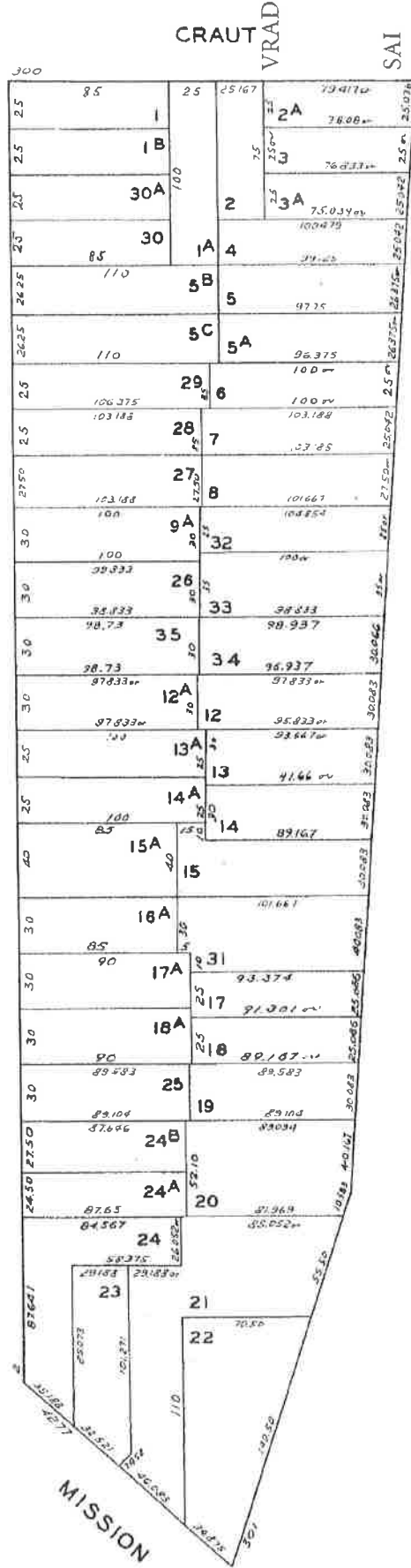

5893

COLLEGE HD ASSN BLK 4

REVISED	'64
"	'68
"	'79

Revised	Checked
Master Map 3.0	May, 1988, WEC
June 1979 TO	July, 1980, W.E.C.
MXG 1988 NPJr	Sept 1988, TTD

Revised: June, 1988, 2nd
Checked: June, 1988, WEC

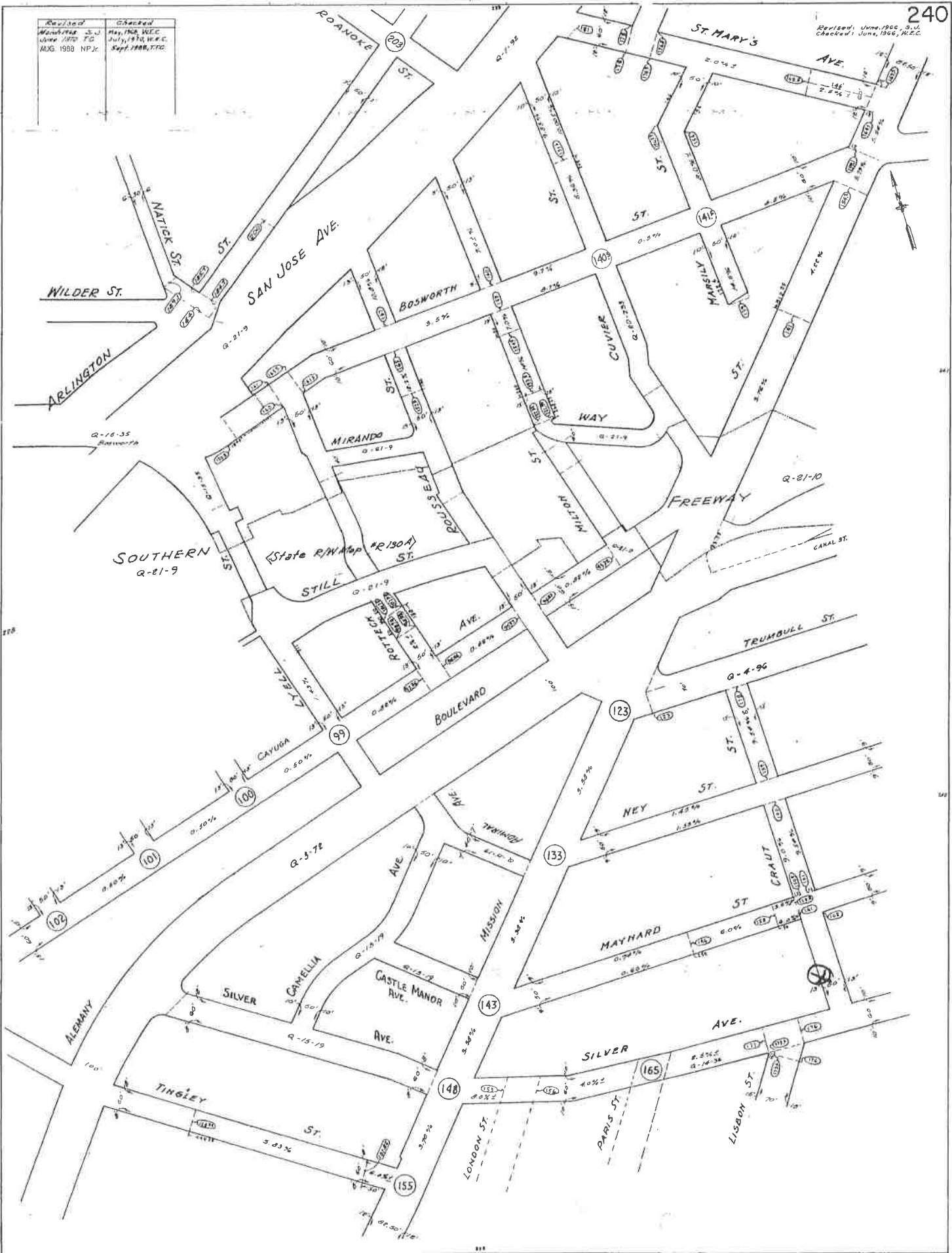

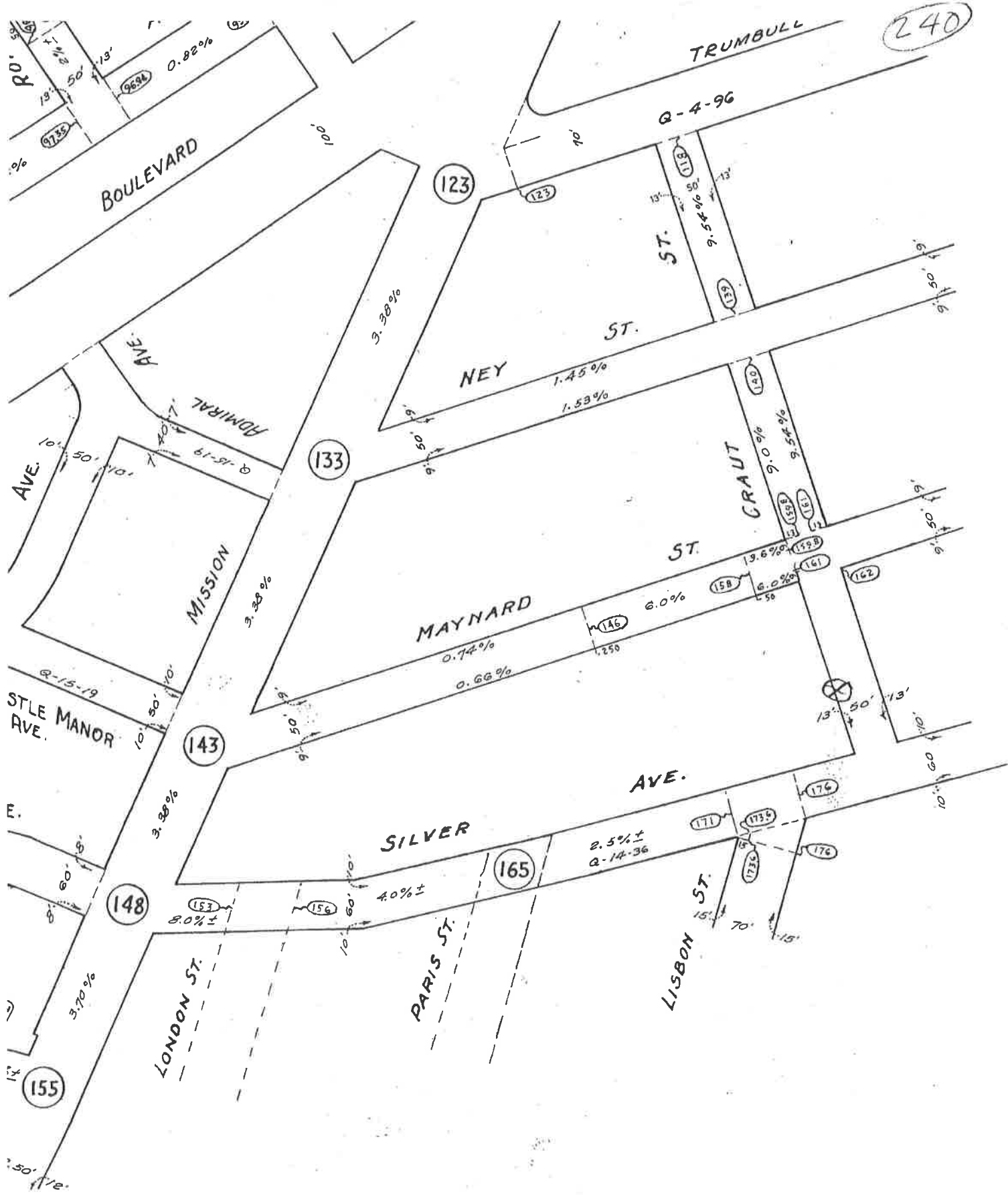

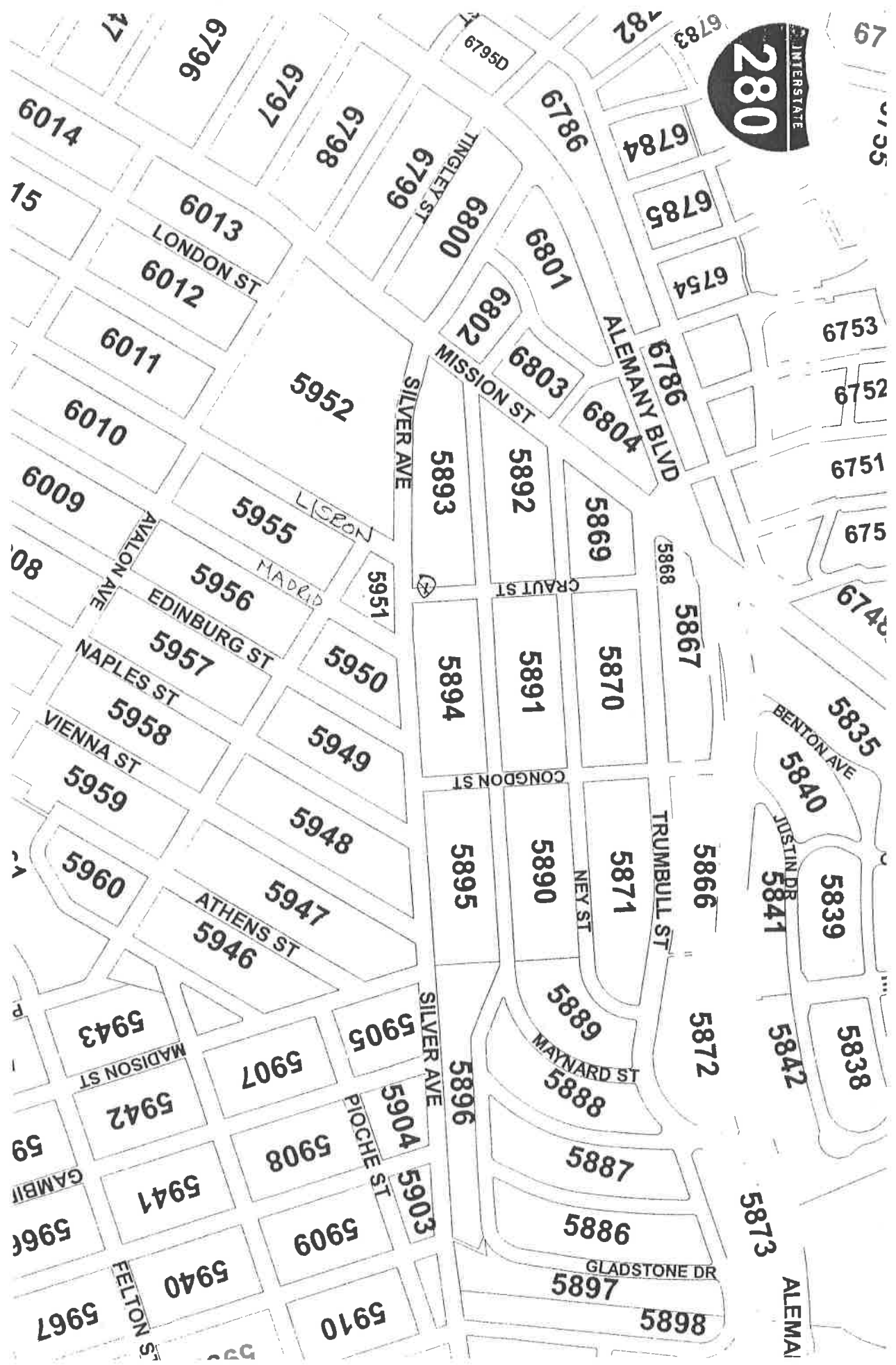

6755

6753
6752
6751
675

6740

5835

BENTON AVE
5840

JUSTIN DR
5841

5842

5839

5838

5873

ALEMANY

6783

6784

6785

6754

6786

ALEMANY BLVD
6804

6795D

6786

6800

1089

MISSION ST
6802

6803

SILVER AVE

5893

5892

5869

5868

5867

CRAUT ST

5894

5891

5870

CONGON ST

5894

5890

5871

5866

BENTON AVE
5840

JUSTIN DR
5841

5841

5842

5839

5838

5872

TRUMBULL ST

5895

5890

5871

NEY ST

MAYNARD ST
5889

5896

5888

5887

5886

GLADSTONE DR

5897

5898

SILVER AVE

5905

5904

5903

5907

5908

5909

5910

5904

5905

5907

5908

5909

5910

6796

6797

6798

6799

6013

LONDON ST
6012

6011

6010

6009

LISEON

5955

MADRID

5956

EDINBURG ST
5957

NAPLES ST
5958

VIENNA ST
5959

5960

ATHENS ST
5946

5947

5949

5948

5943

MADISON ST
5942

5941

5940

59

GAMBIT

5966

5967

FELTON ST



Address **326 Craut St**
San Francisco, CA 94112

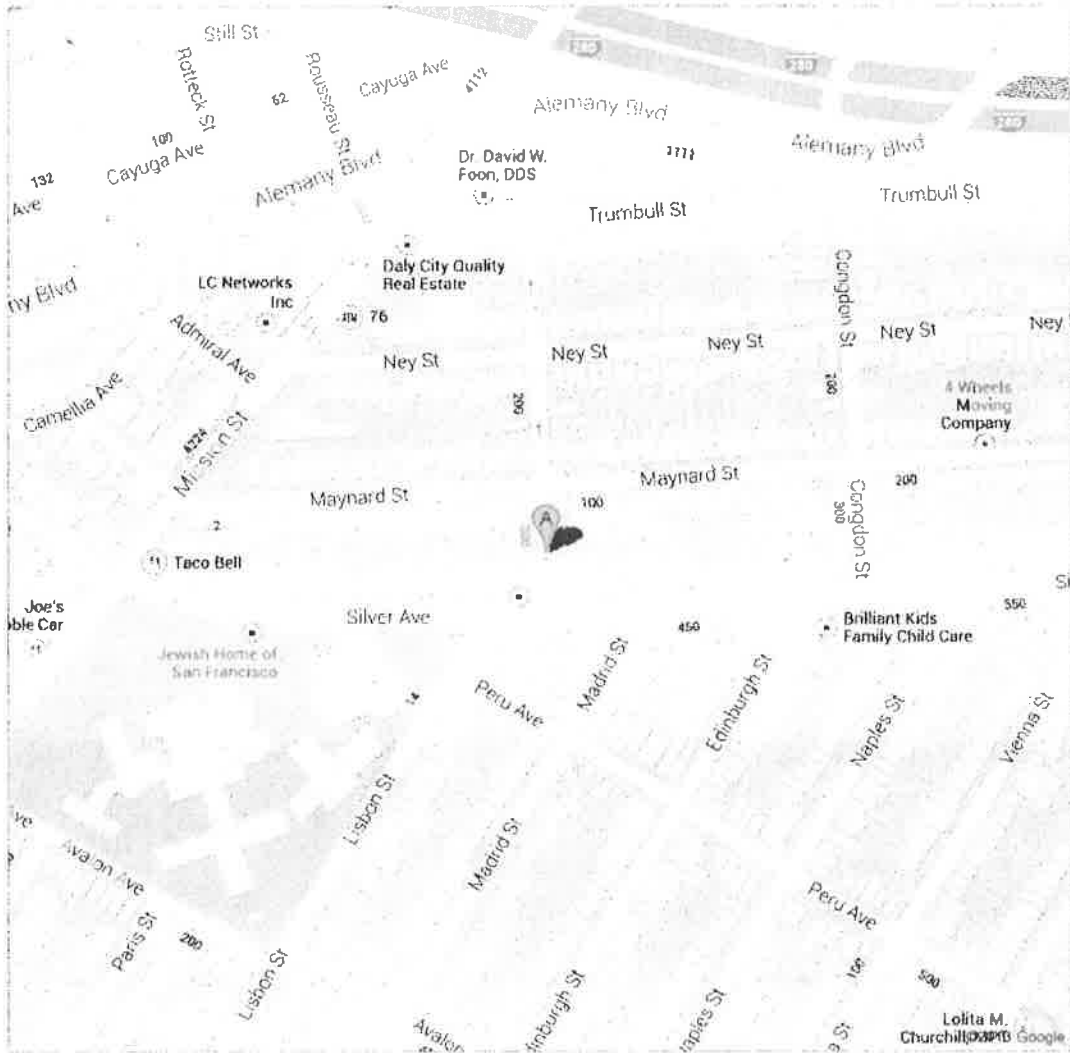

City and County of San Francisco



Department of Public Works

Bureau of Street-use and Mapping

Dana Neil, Public Works Coordinator
AT&T California
Construction and Engineering
795 Folsom Street, Room 426
San Francisco, CA 94107-1243

**STATUS OF SURFACE MOUNTED FACILITY
PRE-APPROVAL APPLICATION**

Location: **326 Craut Street**

Cross Streets: Silver Avenue and Maynard Street

Your file or job number: **SF06-280301, 9390985, 70F**

Your application for pre-approval to construct a surface mounted facility at the location above has been reviewed by the Department, under the terms of DPW Order 175,566.

- Your application is approved, as submitted, with no additional requirements. You may apply for an excavation permit.
- Your application is approved, subject to the following **mitigation requirements**:
You may apply for an excavation permit.
- Refer to this number in your Excavation Permit application: **13SMF-0407**
- You may **not** apply for a permit at this site, your application is **denied** for the following reason(s):

Date: _____

René Lopez
Utility Permit Coordinator

EXHIBIT H
Application Deficiency Checklist

City and County of San Francisco

Department of Public Works

Bureau of Street-use and Mapping



SURFACE-MOUNTED FACILITY APPLICATION
DEFICIENCY NOTICE

Applicant Name: AT&T California Contact Name: Dana Neil Tel. No: 415 644-7027

Proposed Location: 326 Craut Street (Group 70F) 13SMF-0407

The application package is deficient for the reasons indicated below and is returned to: _____

On: _____ By: _____ Tel No. _____

- 1. **Transmittal letter** is missing the following information:
 - a. Identification of proposed location of Surface Mounted Facility (SMF)
 - b. Type of cabinet (include specification if not on file with the Department of Public Works)
 - c. Date of site visit
 - d. Name, address, telephone number, facsimile number and e-mail address for contact person.
 - e. Other:

- 2. **Detailed Drawing** is missing the following information:
 - a. Street name
 - b. Name of cross streets
 - c. Face of curb (FOC)
 - d. Property lines (PLs)
 - e. Distance from FOC to face of the SMF
 - f. Distance from FOC to PLs
 - g. Distance from FOC to back of the SMF
 - h. Locations of existing above-ground street furniture (utility poles, bus shelters, fire hydrants, garbage receptacles, parking meters, etc) and distance from the proposed location of the SMF.
 - i. Locations of existing underground utility facilities (vaults, manholes, handholds, meters, etc.) and distance from the proposed location of the SMF.
 - j. Distance from nearest cross street to the SMF.
 - k. Other:

- 3. **Photographs of the SMF** in the proposed location is missing the following:
 - a. Front view of the SMF
 - b. Side view of the SMF
 - c. View of the SMF in relation to the nearest building or other structure
 - d. Other:

- 4. **Location of SMF is incorrect.** Explain:
- _____



Public Works Coordinator
AT&T California
795 Folsom Street, Suite 426
San Francisco CA 94107-1243

T: 415.644.7043 or
T: 415.644.7054
F: 415.957.5973
www.att.com

June 9, 2014

EXHIBIT F - a

René Lopez, Utility Permit Coordinator
City and County of San Francisco
Department of Public Works, Bureau of Street-Use and Mapping
1155 Market Street, 3rd floor
San Francisco, CA 94103-1522

Location: 326 Craut Street, west side, north of Silver Avenue

DPW File: **13SMF-0407**

LETTER OF TRANSMITTAL
PROPOSED SURFACE MOUNTED FACILITY

Enclosed are:

- Exhibit A Pre-site visit checklist
- Exhibit A-2a Five-year plan documentation for this site
- Exhibit A-2b Cabinet size plan (footprint and clearance plans)
Updated:
448S photo and specifications
- Exhibit A-2c Private property mailing letter to property owners mailing list
- Exhibit A-2d1 Private property mailing sample letter seeking easements to property owners
- Exhibit A-2d2 Private property mailing date verification, date mailed:
- Exhibit A-2e Responses from Property Owners
- Exhibit MOU-1 Mailing list of owners and residents within 300 feet
Date mailed:
- Exhibits A-2f-B Verification of policy compliance (undergrounding, collocation, etc.)
page 2
- Exhibit C-1b Directory of Neighborhood Organizations list
- Exhibit C-1c City Department Notices for special districts
N/A
- Exhibit E Neighborhood Notice (per sec C-2)
- Exhibit F-b Site Drawing
- Exhibit F-c Photos of site
- Exhibit F-c1 Assessors Parcel Map, Grade Map, and vicinity map
- Exhibit F-d Location of SMF to be removed
N/A
- Exhibit G Approval or denial of site Notice to Applicant
- Exhibit H Application Deficiency Notice

Comments: Revisions

File: SF06-280301; 9390985; Group: **70F**

Exhibit A-2i

Statements regarding the removal of existing Surface-Mounted Facilities

- This will be a new cross-connect facility, improving the service and installation possibilities for this serving area. No similar facility exists in this serving area, therefore none can be removed.
- The existing cross-connect facility at this location is being upgraded in-place to provide ultimate service capacity for the serving area, and will increase slightly in size to provide for increased capacity and the capability to accept the latest technology improvements when they become available to the neighborhood.
- This facility combines existing facilities and will result in the removal of a cabinet located at: See Exhibit F-d, as well.
- This facility brings new electronic equipment to the serving area. This facility provides the latest fiber-optic served equipment and offers advanced services to serving area residents. No similar facility exists in this neighborhood, therefore none can be removed.
- It is not possible to remove any other SMF with this project.
-

Exhibit B

Statement regarding compliance with placement guidelines

This site complies with the DPW placement guidelines for Surface-Mounted Facilities stipulated in Exhibit B of DPW Order 175, 566, dated August 17th, 2005.

EXHIBIT F

Permit_Number	Applicant	status	LocationDescription
14SMF-0051	Department of Public Works - Infrastructure Divisi	APPROVED	NE corner of Geary Blvd and Powell St
12SMF-0016	HV Partners I, LP	APPROVED	Middle Point Rd. between Evans Ave./ Jennings St. to Acacia Ave. (west side)
13SMF-0052	MTA/ DPT	APPROVED	south side of market 181' west of 9th & market intersection
13SMF-0082	Pacific Gas & Electric	APPROVED	North side of Flood Ave. between Congo St. to Detroit St. (west of Congo St.)
13SMF-0301	San Francisco Municipal Transportation Agency	APPROVED	Cesar Chavez St. (north side) between Guerrero St. and Dolores St.
13SMF-0297	San Francisco Municipal Transportation Agency	APPROVED	Gough St (east side) between Ellis St and Geary St; near the intersection of Ellis St and Gough St.
13SMF-0298	San Francisco Municipal Transportation Agency	APPROVED	Irving St (south side) between Sunset Blvd and 37th Ave; near the intersection of Irving St and Sunset Blvd.
13SMF-0299	San Francisco Municipal Transportation Agency	APPROVED	Ocean Ave (north side) between Gellert Dr and Sunset Blvd; near the intersection of Ocean Ave and Sunset Blvd.
13SMF-0300	San Francisco Municipal Transportation Agency	APPROVED	Scott St (west side) between Turk St and Eddy St; near the intersection of Scott St and Turk St.
13SMF-0013	San Francisco Municipal Transportation Agency	APPROVED	Southeast corner of Rivera St. and Sunset Blvd.
13smf-0443	San Francisco Municipal Transportation Agency	APPROVED	Alemany Blvd (east side) between Onondaga Ave and Leo St; near the intersection of Alemany Blvd and Onondaga Ave.

13SMF-0234	San Francisco Municipal Transportation Agency	APPROVED	Gough St. (east side) between Turk St. and Eddy St.
13SMF-0186	San Francisco Municipal Transportation Agency	APPROVED	Franklin St. (west side) between Fern St. and Sutter St.
13SMF-0187	San Francisco Municipal Transportation Agency	APPROVED	Post St. (south side) between Franklin St. and Van Ness Ave.
13SMF-0188	San Francisco Municipal Transportation Agency	APPROVED	Franklin St. (east side) between Pine St. and California St.
13SMF-0189	San Francisco Municipal Transportation Agency	APPROVED	Franklin St. (east side) between Turk St. and Larch St.
13SMF-0190	San Francisco Municipal Transportation Agency	APPROVED	California St. (north side) between Franklin St. to Van Ness Ave.
13SMF-0191	San Francisco Municipal Transportation Agency	APPROVED	Eddy St. (north side) between Franklin St. and Van Ness Ave.
13SMF-0192	San Francisco Municipal Transportation Agency	APPROVED	Franklin St. (east side) between Sacramento St. and Clay St.
13SMF-0193	San Francisco Municipal Transportation Agency	APPROVED	Ellis St. (north side) between Franklin St. and Van Ness Ave.
13SMF-0194	San Francisco Municipal Transportation Agency	APPROVED	Geary Blvd. (south side) between Franklin St. and Van Ness Ave.
13SMF-0195	San Francisco Municipal Transportation Agency	APPROVED	
13SMF-0197	San Francisco Municipal Transportation Agency	APPROVED	
13SMF-0198	San Francisco Municipal Transportation Agency	APPROVED	
13SMF-0199	San Francisco Municipal Transportation Agency	APPROVED	
13SMF-0201	San Francisco Municipal Transportation Agency	APPROVED	
13SMF-0202	San Francisco Municipal Transportation Agency	APPROVED	
13SMF-0203	San Francisco Municipal Transportation Agency	APPROVED	
13SMF-0204	San Francisco Municipal Transportation Agency	APPROVED	
13SMF-0205	San Francisco Municipal Transportation Agency	APPROVED	
13SMF-0207	San Francisco Municipal Transportation Agency	APPROVED	
13SMF-0208	San Francisco Municipal Transportation Agency	APPROVED	
13SMF-0209	San Francisco Municipal Transportation Agency	APPROVED	
13SMF-0211	San Francisco Municipal Transportation Agency	APPROVED	
13SMF-0212	San Francisco Municipal Transportation Agency	APPROVED	
13SMF-0213	San Francisco Municipal Transportation Agency	APPROVED	
13SMF-0214	San Francisco Municipal Transportation Agency	APPROVED	

13SMF-0215	San Francisco Municipal Transportation Agency	APPROVED	Franklin St. (east side) between Sacramento St. and California St. Union St. (south side) between Gough St. and Franklin St. Franklin St. (east side) between Vallejo St. and Green St. Franklin St. (east side) between Vallejo St. and Broadway
13SMF-0226	San Francisco Municipal Transportation Agency	APPROVED	Jackson St. (south side) between Franklin St. and Van Ness Ave.
13SMF-0228	San Francisco Municipal Transportation Agency	APPROVED	Franklin St between Union St and Green St (near the intersection of Franklin St and Union St). Palm Ave (east side) between Geary Blvd and Euclid Ave; near the intersection of Geary Blvd and Euclid Ave.
13SMF-0229	San Francisco Municipal Transportation Agency	APPROVED	Sloat Blvd (north side) between 46th Ave and 47th Ave; near the intersection of 47th Ave and Sloat Blvd.
13SMF-0230	San Francisco Municipal Transportation Agency	APPROVED	Lake Merced Blvd (west side) between John Muir Dr and Lake Merced Hill; near the intersection of Lake Merced Blvd and John Muir Dr.
13SMF-0438	San Francisco Municipal Transportation Agency	APPROVED	Sansome St (west side) between Pacific Ave and Broadway St; near the intersection of Broadway St and Sansome St.
13SMF-0356	San Francisco Municipal Transportation Agency	APPROVED	Circular Ave (east side) between Monterey Blvd and Hearst Ave; near the intersection of Circular Ave and Monterey Blvd.
13SMF-0357	San Francisco Municipal Transportation Agency	APPROVED	
13SMF-0358	San Francisco Municipal Transportation Agency	APPROVED	
13SMF-0283	San Francisco Municipal Transportation Agency	APPROVED	
13SMF-0284	San Francisco Municipal Transportation Agency	APPROVED	

13SMF-0200	San Francisco Municipal Transportation Agency	APPROVED	SE corner of Broadway and Battery St.
13SMF-0206	San Francisco Municipal Transportation Agency	APPROVED	Steuart St. between Market St. and Don Chee Wy.
13SMF-0257	San Francisco Municipal Transportation Agency	APPROVED	02nd St. between Folsom St. to Dow Pl.
13SMF-0258	San Francisco Municipal Transportation Agency	APPROVED	02nd St. between Folsom St. to Dow Pl.
13SMF-0259	San Francisco Municipal Transportation Agency	APPROVED	02nd St. between Folsom St. to Dow Pl.
13SMF-0260	San Francisco Municipal Transportation Agency	APPROVED	02nd St. between Folsom St. to Dow Pl.
13SMF-0261	San Francisco Municipal Transportation Agency	APPROVED	02nd St. between Folsom St. to Dow Pl.
13SMF-0262	San Francisco Municipal Transportation Agency	APPROVED	Market St. between 09th St. to 10th St. (south side)
13SMF-0263	San Francisco Municipal Transportation Agency	APPROVED	Kearny St. between Pine St. to California St.
13SMF-0308	San Francisco Municipal Transportation Agency	APPROVED	Washington St. (west side) between Powell St. and Stone St. 22nd St (north side) between Bryant St and York St; near the intersection of 22nd St and Bryant St.
13SMF-0309	San Francisco Municipal Transportation Agency	APPROVED	Geneva Ave. (north side) between Howth St. and Ocean Ave.
13SMF-0275	San Francisco Municipal Transportation Agency	APPROVED	Ulloa St. (north side) between 36th Ave. and Sunset Blvd.
13SMF-0272	San Francisco Municipal Transportation Agency	APPROVED	Kirkham St. (north side) between 36th Ave. and Sunset Blvd.
13SMF-0273	San Francisco Municipal Transportation Agency	APPROVED	Santiago St. (north side) between 36th Ave. and Sunset Blvd.
13SMF-0274	San Francisco Municipal Transportation Agency	APPROVED	Golden Gate Ave. between Polk St. to Larkin St.
13SMF-0264	San Francisco Municipal Transportation Agency	APPROVED	

14SMF-0020	San Francisco Municipal Transportation Agency	APPROVED	Post St between Franklin St and Gough St (near the intersection of Franklin St and Post St)
13SMF-0411	San Francisco Municipal Transportation Agency	APPROVED	Third St between Perry and Harrison
13SMF-0011	San Francisco Municipal Transportation Agency	APPROVED	Northeast corner Lawton St. and Sunset Blvd.
13SMF-0196	San Francisco Municipal Transportation Agency	APPROVED	
14SMF-0038	San Francisco Municipal Transportation Agency	APPROVED	Fronting 495 Castro St property
13SMF-0433	San Francisco Municipal Transportation Agency	APPROVED	2nd St
13SMF-0434	San Francisco Municipal Transportation Agency	APPROVED	Broadway St
13SMF-0435	San Francisco Municipal Transportation Agency	APPROVED	Market St
13SMF-0436	San Francisco Municipal Transportation Agency	APPROVED	Steuart St
14SMF-0022	San Francisco Municipal Transportation Agency	APPROVED	Yorba St between Sunset Blvd and 36th Ave (near the intersection of Sunset Blvd and Yorba St)
14SMF-0026	San Francisco Municipal Transportation Agency	APPROVED	1) Turk St (south side) between Masonic Ave and Nido Ave; near the intersection of Turk St and Masonic Ave. Masonic Ave (east side) between Golden Gate Ave and Turk St; near the intersection of Masonic Ave and Golden Gate Ave Masonic Ave (east side) between Hayes St and Fell St; near the intersection of Masonic Ave and Hayes St Northeast corner of Vicente St. and Sunset Blvd. Southeast corner of Pacheco St. and Sunset Blvd. Franklin St. (west side) between O'Farrell St. and Olive St.
14SMF-0027	San Francisco Municipal Transportation Agency	APPROVED	
14SMF-0028	San Francisco Municipal Transportation Agency	APPROVED	
13SMF-0014	San Francisco Municipal Transportation Agency	APPROVED	
13SMF-0012	San Francisco Municipal Transportation Agency	APPROVED	
13SMF-0216	San Francisco Municipal Transportation Agency	APPROVED	
13SMF-0210	San Francisco Municipal Transportation Agency	APPROVED	

13SMF-0218	San Francisco Municipal Transportation Agency	APPROVED	Hayes St. (south side) between Franklin St. and Van Ness Ave. Capp St (west side) between Adair St and 16th St; near the intersection of 16th St and Capp St.
13SMF-0354	San Francisco Municipal Transportation Agency	APPROVED	6th St(west side) between Mission St and Minna St; near the intersection of 6th St and Minna St. Franklin St. (east side) between Hayes St. and Linden St. Franklin St. (east side) between Filbert St. and Greenwich St. Washington St. (south side) between Franklin St. and Van Ness Ave.
13SMF-0355	San Francisco Municipal Transportation Agency	APPROVED	Franklin St. (east side) between Union St. and Filbert St.
13SMF-0219	San Francisco Municipal Transportation Agency	APPROVED	Pacific Ave. (north side) between Franklin St. and Van Ness Ave.
13SMF-0221	San Francisco Municipal Transportation Agency	APPROVED	Union St. (south side) between Franklin St. and Van Ness Ave.
13SMF-0222	San Francisco Municipal Transportation Agency	APPROVED	21st St. (north side) between Shotwell St. and South Van Ness Ave.
13SMF-0223	San Francisco Municipal Transportation Agency	APPROVED	California St. (north side) between 25th Ave. and 26th Ave.
13SMF-0224	San Francisco Municipal Transportation Agency	APPROVED	California St. (south side) between Walnut St. and Laurel St.
13SMF-0225	San Francisco Municipal Transportation Agency	APPROVED	Turk St. (south side) between Fillmore St. and Steiner St.
13SMF-0175	San Francisco Municipal Transportation Agency	APPROVED	Jones St. (west side) between Sutter St. and Cosmo Pl.
13SMF-0176	San Francisco Municipal Transportation Agency	APPROVED	O'Farrell St. (north side) between Larkin St. and Polk St.
13SMF-0177	San Francisco Municipal Transportation Agency	APPROVED	
13SMF-0178	San Francisco Municipal Transportation Agency	APPROVED	
13SMF-0179	San Francisco Municipal Transportation Agency	APPROVED	
13SMF-0180	San Francisco Municipal Transportation Agency	APPROVED	

13SMF-0181	San Francisco Municipal Transportation Agency	APPROVED	Polk St. (east side) between O'Farrell St. and Alice B. Toklas Pl./ Myrtle St.
13SMF-0182	San Francisco Municipal Transportation Agency	APPROVED	Franklin St. (east side) between Grove St. and Ivy St.
13SMF-0183	San Francisco Municipal Transportation Agency	APPROVED	Gough St. (east side) between Grove St. and Fulton St.
13SMF-0184	San Francisco Municipal Transportation Agency	APPROVED	Ellis St. (north side) between Franklin St. and Van Ness Ave.
13SMF-0173	San Francisco Municipal Transportation Agency	APPROVED	Church St. (east side) between 16th St. and Chula Ln.
13SMF-0185	San Francisco Municipal Transportation Agency	APPROVED	Franklin St. (west side) between McAllister St. and Redwood St.
13SMF-0276	San Francisco Municipal Transportation Agency	APPROVED	Bayshore Blvd. (east side) between Paul Ave. and Wheat St.
13SMF-0277	San Francisco Municipal Transportation Agency	APPROVED	13th St (south side) between Bryant St and Harrison St; near the intersection of 13th St and Harrison St.
13SMF-0278	San Francisco Municipal Transportation Agency	APPROVED	Fulton St (south side) between 24th Ave and 25th Ave; near the intersection of 25th Ave
13SMF-0279	San Francisco Municipal Transportation Agency	APPROVED	O'Farrell St (north side) between Anza Vista Ave and Masonic Ave; near the intersection of Anza St and Broadway St (north side) between Front St and Battery St; near the intersection of Battery St and Broadway St.
13SMF-0280	San Francisco Municipal Transportation Agency	APPROVED	Broadway St (south side) between Kearny St and Romolo St; near the intersection of Broadway St and Kearny St.
13SMF-0281	San Francisco Municipal Transportation Agency	APPROVED	

13SMF-0282	San Francisco Municipal Transportation Agency	APPROVED	Montgomery St (west side) between Verdi Place and Broadway St; near the intersection of Broadway St and Montgomery St
13SMF-0286	San Francisco Municipal Transportation Agency	APPROVED	Masonic Ave (east side) between Anza St and Ewing Terrace; near the intersection of Ewing Terrace and Masonic Ave.
13SMF-0287	San Francisco Municipal Transportation Agency	APPROVED	Gough St (east side) between Hayes St and Ivy St; near the intersection of Gough St and Hayes St.
13SMF-0288	San Francisco Municipal Transportation Agency	APPROVED	Powell St (east side) between Sutter St and Anson Place; near the intersection of Powell St and Sutter St.
14SMF-0006	Tutor Perini Corporation	APPROVED	Ellis St. between 04th St. \ Market St. \ Stockton St. to Powell St. (south side).
14SMF-0007	Tutor Perini Corporation	APPROVED	O'Farrell St. between Security Pacific Pl. to Stockton St. (north side)
14SMF-0008	Tutor Perini Corporation	APPROVED	Geary St. between Stockton St. to Powell St. (north side).
14SMF-0009	Tutor Perini Corporation	APPROVED	Washington St. between Stockton St. to Trenton St. (north side).
14SMF-0011	Tutor Perini Corporation	APPROVED	04th St. between Townsend St. to Bluxome St. (west side)
14SMF-0012	Tutor Perini Corporation	APPROVED	Townsend St. between 04th St. to 05th St. (north side)
14SMF-0013	Tutor Perini Corporation	APPROVED	King St. between 04th St. and 05th St. (north side)
14SMF-0014	Tutor Perini Corporation	APPROVED	King St. between 03rd St. to 04th St. (south side)

14SMF-0015	Tutor Perini Corporation	APPROVED	04th St. between Brannan St. to Freelon St. (east side)
14SMF-0016	Tutor Perini Corporation	APPROVED	04th St. between Brannan St. to Freelon St. (east side)
14SMF-0017	Tutor Perini Corporation	APPROVED	Brannan St. between 04th St. to Zoe St. (north side)
14SMF-0018	Tutor Perini Corporation	APPROVED	Brannan St. between 04th St. to Zoe St. (north side)
14SMF-0010	Tutor Perini Corporation	APPROVED	Intersection of 04th St. and Bluxome St. (east side).